

21 DETAILS - 211 GENERAL PATTON MANDEVILLE, LA - 24091 DATE: 03-16-2020  
 211 GENERAL PATTON MANDEVILLE, LA - 24091 DATE: 03-16-2020  
 211 GENERAL PATTON MANDEVILLE, LA - 24091 DATE: 03-16-2020

SOD, SEEDING AND PLANTS SHALL HAVE A ONE YEAR WARRANTY FROM INSTALLATION DATE.

NO DUMPSTER WILL BE ALLOWED ON THIS SITE.

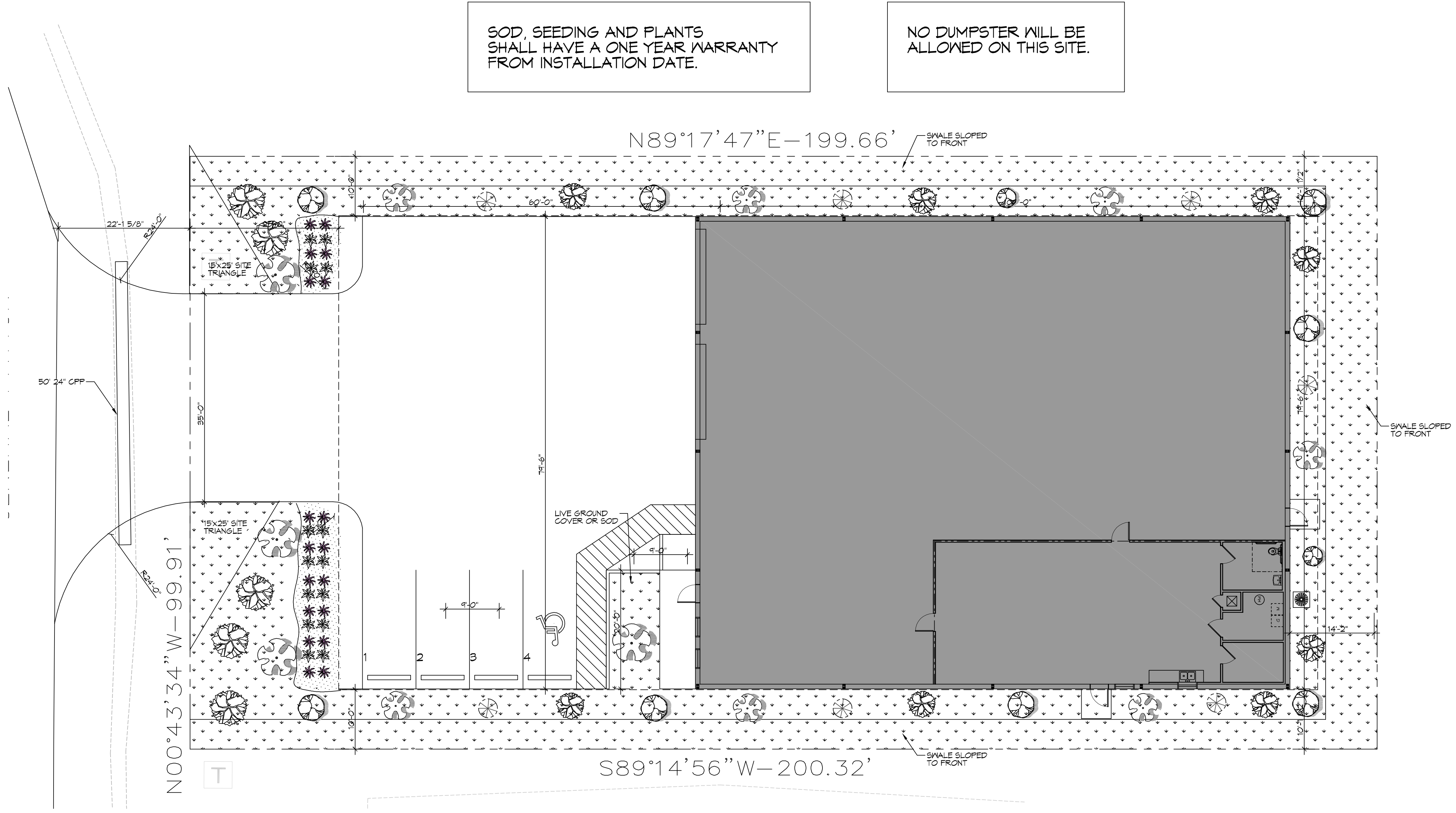

**20 LANDSCAPING PLAN**  
SCALE: 1" = 10'-0"

**LANDSCAPING NOTES**

- ALL LANDSCAPING INDICATED ON THIS SHEET ARE SHOWN FOR COORDINATION AND PERMITTING PURPOSES ONLY.
- ALL LANDSCAPING SHALL BE DRAWN AND STAMPED BY A LICENSED LOUISIANA HORTICULTURIST OR A LICENSED LANDSCAPE ARCHITECT.
- CONTACT LOCAL UNDERGROUND UTILITY SERVICES FOR UTILITY LOCATION AND IDENTIFICATION PRIOR TO COMMENCING WORK.
- PERFORM EXCAVATIONS IN THE VICINITY OF UNDERGROUND UTILITIES WITH CARE AND BY HAND. IF NECESSARY, THE CONTRACTOR BEARS FULL RESPONSIBILITY FOR THIS WORK AND DISRUPTION OR DAMAGE TO UTILITIES AND SHALL BE IMMEDIATELY REPAIRED AND AT NO EXPENSE TO THE OWNER.
- CONTACT THE LOCAL UNDERGROUND SERVICE UPDATE FOR UTILITY LOCATION AND IDENTIFICATION PRIOR TO DEMOLITION.

**LEGEND**

- DD BLANCHARD MAGNOLIA  
ALL CLASS 'A' TREES, AT THE TIME OF PLANTING, SHALL HAVE A MINIMUM CALIPER OF AT LEAST 2" TO 2 1/2", MEASURED SIX (6") INCHES ABOVE THE ROOT BALL. MINIMUM HEIGHT OF 10' TO 12' AT TIME OF PLANTING AND A MATURE AVERAGE CROWN SPREAD OF 20 FEET.
  - SOUTHERN LIVE OAK - CLASS A (NATIVE)  
ALL CLASS 'A' TREES, AT THE TIME OF PLANTING, SHALL HAVE A MINIMUM CALIPER OF AT LEAST 2" TO 2 1/2", MEASURED SIX (6") INCHES ABOVE THE ROOT BALL. MINIMUM HEIGHT OF 10' TO 12' AT TIME OF PLANTING AND A MATURE AVERAGE CROWN SPREAD OF 20 FEET.
  - RIVER BIRCH (NATIVE)  
ALL CLASS 'B' TREES, AT THE TIME OF PLANTING, SHALL HAVE A MINIMUM CALIPER OF AT LEAST 1" TO 1.5", MEASURED SIX (6") INCHES ABOVE THE ROOT BALL, AND A MINIMUM HEIGHT OF 8' TO 10' AT TIME OF PLANTING AND A MATURE AVERAGE CROWN SPREAD OF 20 FEET.
  - WAX MYRTLE (NATIVE)  
ALL CLASS 'B' TREES, AT THE TIME OF PLANTING, SHALL HAVE A MINIMUM CALIPER OF AT LEAST 1" TO 1.5", MEASURED SIX (6") INCHES ABOVE THE ROOT BALL, AND A MINIMUM HEIGHT OF 8' TO 10' AT TIME OF PLANTING AND A MATURE AVERAGE CROWN SPREAD OF 20 FEET.
  - AFRICAN IRIS  
SHRUB: A RELATIVELY LOW-GROWING BUSHY PLANT. FOR THE PURPOSE OF THIS DEFINITION, GROUND COVER, TREES AND ANNUALS ARE NOT CONSIDERED SHRUBS.
  - AZALEA (NATIVE)  
SHRUB: A RELATIVELY LOW-GROWING BUSHY PLANT, USUALLY WITH WOODY STEMS. FOR THE PURPOSE OF THIS DEFINITION, GROUND COVER, TREES AND ANNUALS ARE NOT CONSIDERED SHRUBS. ALL SHRUBS, AT THE TIME OF PLANTING, SHALL HAVE A MINIMUM HEIGHT OF TWO (2) FEET.
  - GRASS
  - PINE MULCH
- NOTE: ALL TREES & SHRUBS TO BE MULCHED 1/3" DEPTH, ALL OTHER AREAS TO BE COVERED IN LIVE GROUND COVER OR SOD.

**PLANNING**

LOT 2  
ZONED I-2  
INDUSTRIAL DISTRICT NORTHSHORE COMMERCIAL PARK

**PARKING REQUIREMENTS**

1 SPACE PER 350 SQ. FT. OF OFFICE AREA: 1500/350 = 4  
1 SPACE PER 1000 SQ. FT. OF WAREHOUSE: 6500/1000 = 7  
REQUIRED = 11  
1 PARKING SPACES BE PROVIDED ON OWNERS ADJACENT PROPERTY.

**LICENSED LANDSCAPER**

NAME \_\_\_\_\_  
LICENSE# \_\_\_\_\_

**DAMMON ENGINEERING, INC.**  
LOUISIANA & MISSISSIPPI  
www.dammonengineering.com  
info@dammonengineering.com  
PH: 985.671.1824

Chief Engineer: Brian Mitchell, PE  
356 Old Spanish Trail  
Bossier City, LA 70604

REVISIONS	DATE	DESCRIPTION

SEAL:

**NEW OFFICE WAREHOUSE**

**MIKE SCHWARTZ**

211 GENERAL PATTON  
MANDEVILLE, LA

JOB No: 24091 DATE: 03-16-2020  
DRAWN BY: RLD CHECKED BY: CJD

SHEET TITLE:  
LANDSCAPING PLAN

DRAWING NUMBER:

**L101**

SHEET No: 8 of 12

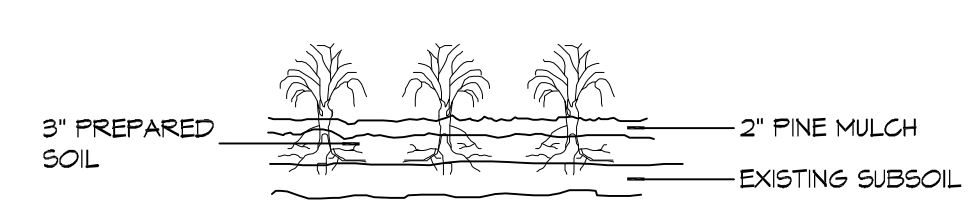

**A GROUND COVER**

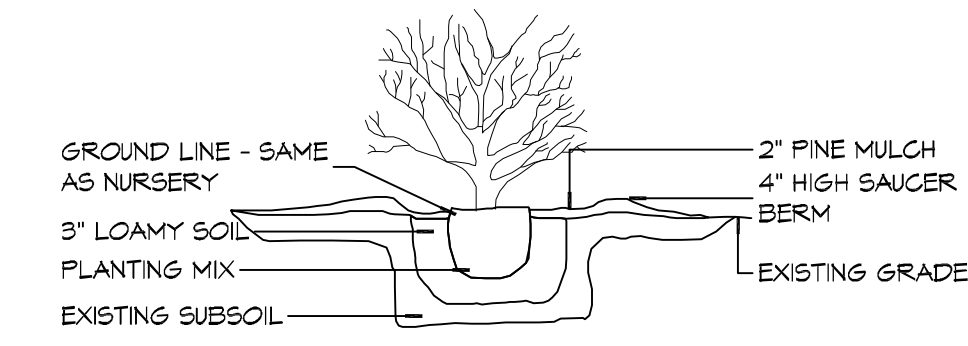

**B TYPICAL SHRUB PLANTING**

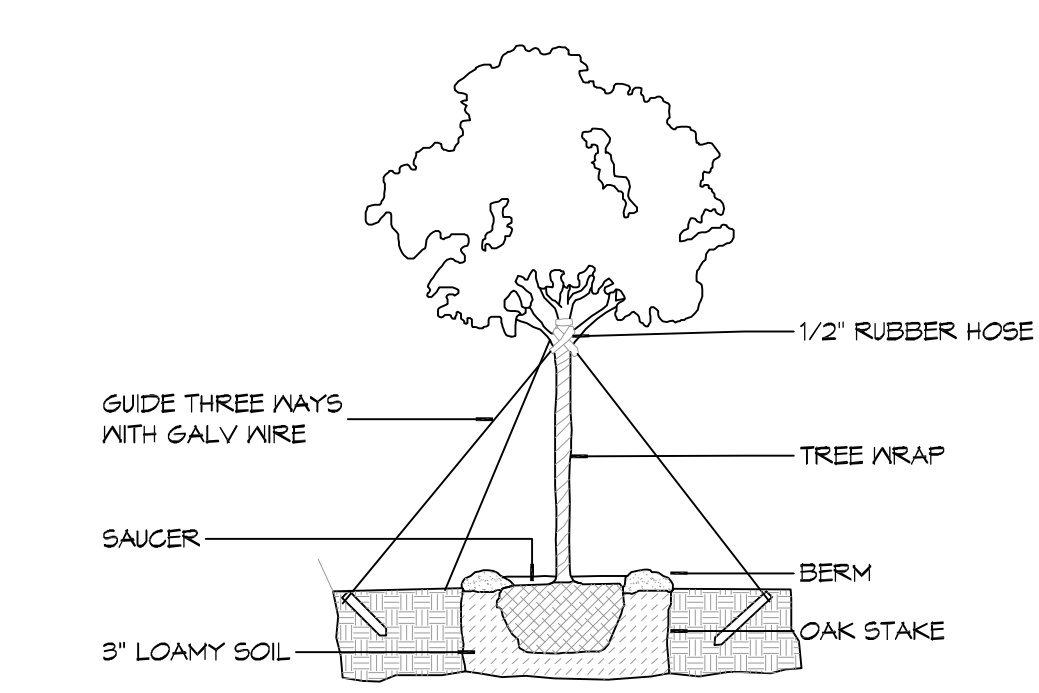

**C TYPICAL TREE PLANTING**

NOTE: ALWAYS PLANT EQUAL TO OR 1" - 2" ABOVE GROUND.

**21 DETAILS**  
SCALE: NTS