

- LEGEND**
- PROPERTY LINE
  - SETBACK LINE
  - NEW BUILDING
  - PARKING
  - TRASH RECEPTACLE

- LANDSCAPE LEGEND**
- SHRUB
  - GRAPE MYRTLE TREE - 1" CALIPER 5W FOOT HIGH MEASURED AT 2 FT. ABOVE THE GROUND
  - RED OAK TREE - MINIMUM OF 12" HIGH CALIPER OF 2-1/2" MEASURED AT 2 FT. ABOVE THE GROUND

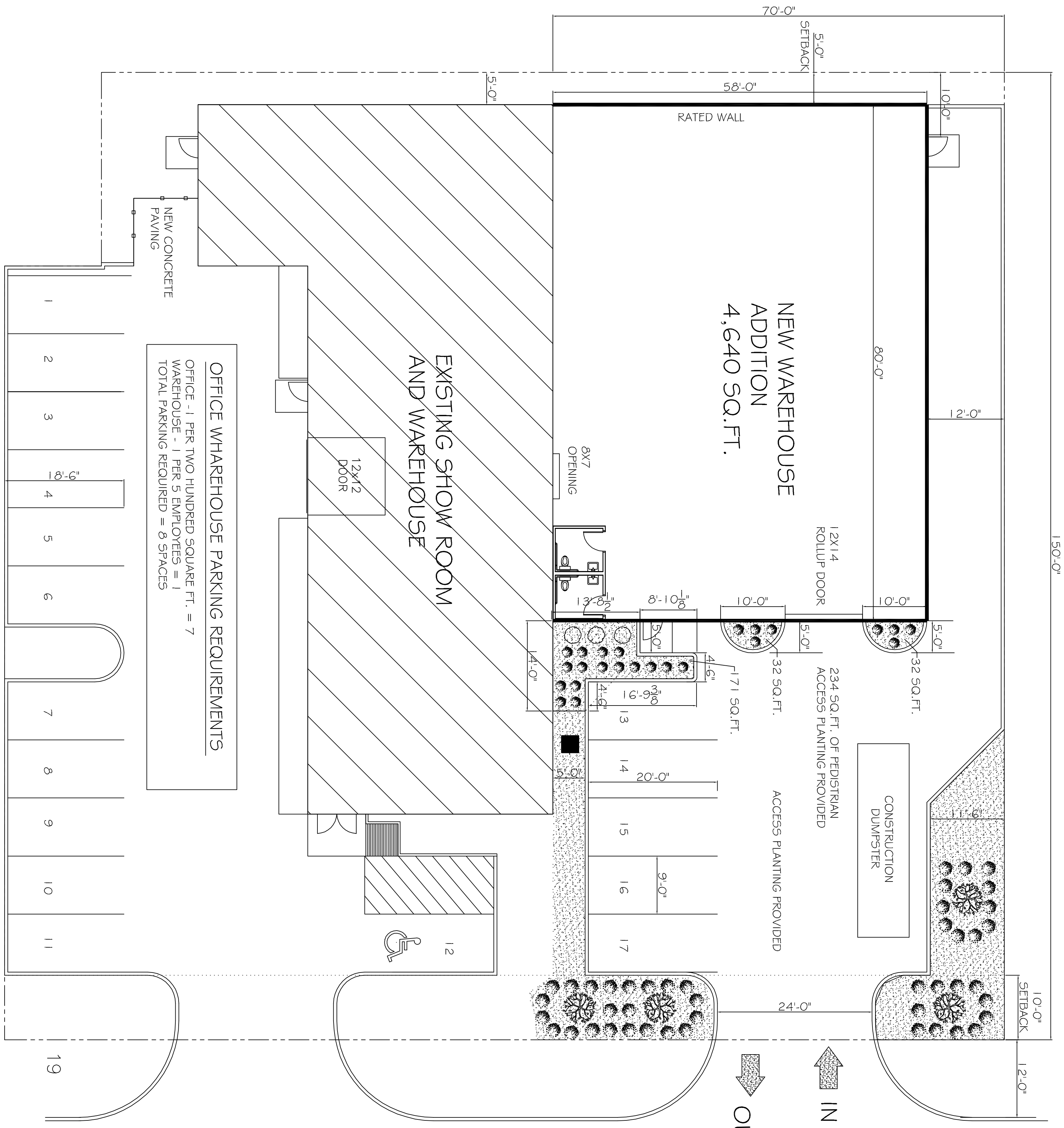

**SITE PLAN**  
SCALE: 1" = 10'

**OFFICE WAREHOUSE PARKING REQUIREMENTS**  
OFFICE - 1 PER TWO HUNDRED SQUARE FT. = 7  
WAREHOUSE - 1 PER 5 EMPLOYEES = 1  
TOTAL PARKING REQUIRED = 8 SPACES

**TAOS STREET**

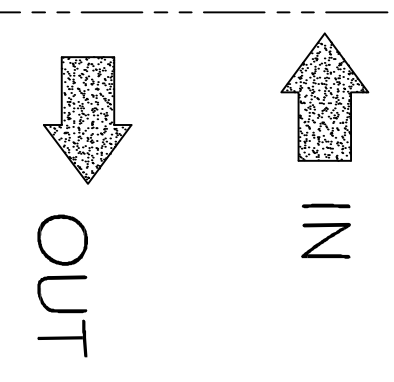

**MOTEL**

**MOTEL**

**LANDSCAPE REQUIREMENTS:**

PERIMETER PLANTING AREA - A PERIMETER PLANTING AREA AT LEAST TEN (10) FEET IN WIDTH MUST BE PROVIDED OFF THE PUBLIC RIGHT-OF-WAY BETWEEN THE RIGHT-OF-WAY AND PARKING AREA OR STRUCTURES. PLANTING MATERIALS SHOULD ACHIEVE A BALANCE OF LOW-LYING HORIZONTAL SHRUBBERY AND VERTICAL TREES. TREES SHALL BE PLACED NO MORE THAN 20-25 FEET ON CENTER WITH A COMPLIMENT OF NO LESS THAN 10 SHRUBS PER TREE.

PARKING LOT PLANTING - PARKING LOT INTERIORS SHOULD BE DESIGNED TO PROVIDE AT LEAST ONE (1) TREE FOR EVERY TWELVE (12) PARKING SPACES. EACH TREE SHOULD BE LOCATED IN A LANDSCAPED ISLAND OF AT LEAST 200 S.F. TREES MUST BE DISTRIBUTED UNIFORMLY SO AS TO PROVIDE A CANOPY EFFECT.

PEDESTRIAN ACCESS PLANTING - LANDSCAPED AREAS MUST BE PROVIDED BETWEEN THE BUILDING FACES HAVING ACCESS AND THE PARKING LOT. FOUR (4) S.F. OF LANDSCAPED AREA SHOULD BE PROVIDED FOR EVERY LINEAR FOOT OF BUILDING FACE. NO PLANTING AREA SHOULD BE LESS THAN FIVE (5) FEET WIDE AND PLANTING MATERIALS SHOULD ACHIEVE A BALANCE BETWEEN LOW-LYING SHRUBBERY AND VERTICAL TREES.

**GENERAL NOTES:**

- 1) NO EXTERIOR LIGHTING PROVIDED ON THIS BUILDING.
- 2) EXTERIOR OF BUILDING SHALL BE STUCCO, CINDER BLOCK AND R-PANEL.
- 3) THIS AN EXISTING SITE AND NO TRAFFIC STUDY IS REQUIRED AS A NO INCREASE IN TRAFFIC WILL OCCUR. DOTT ONLY REQUIRES A STUDY ON STATE ROADS.
- 4) NO SIDEWALK REQUIRED AS NO OTHER BUSINESSES HAVE ONE ON THIS STREET.
- 5) TRASH CANS SHALL BE STORED IN WAREHOUSE.

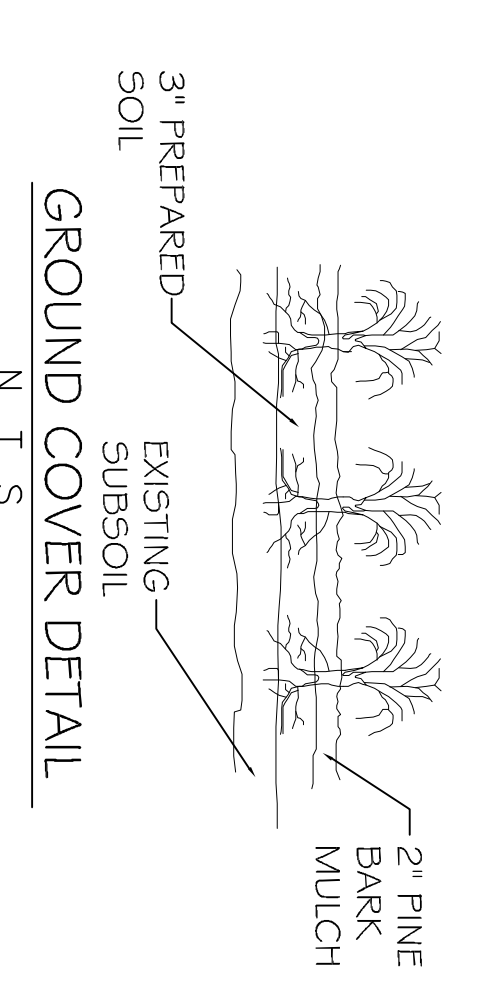
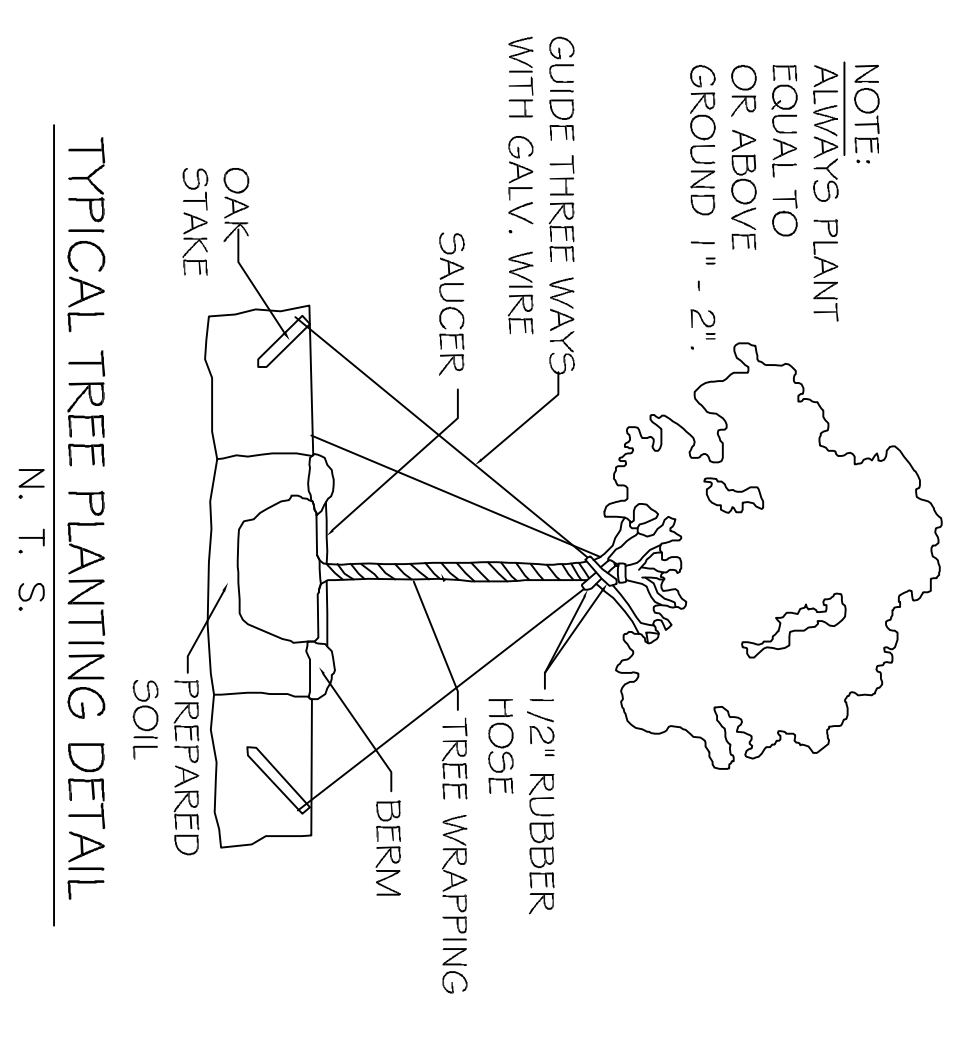
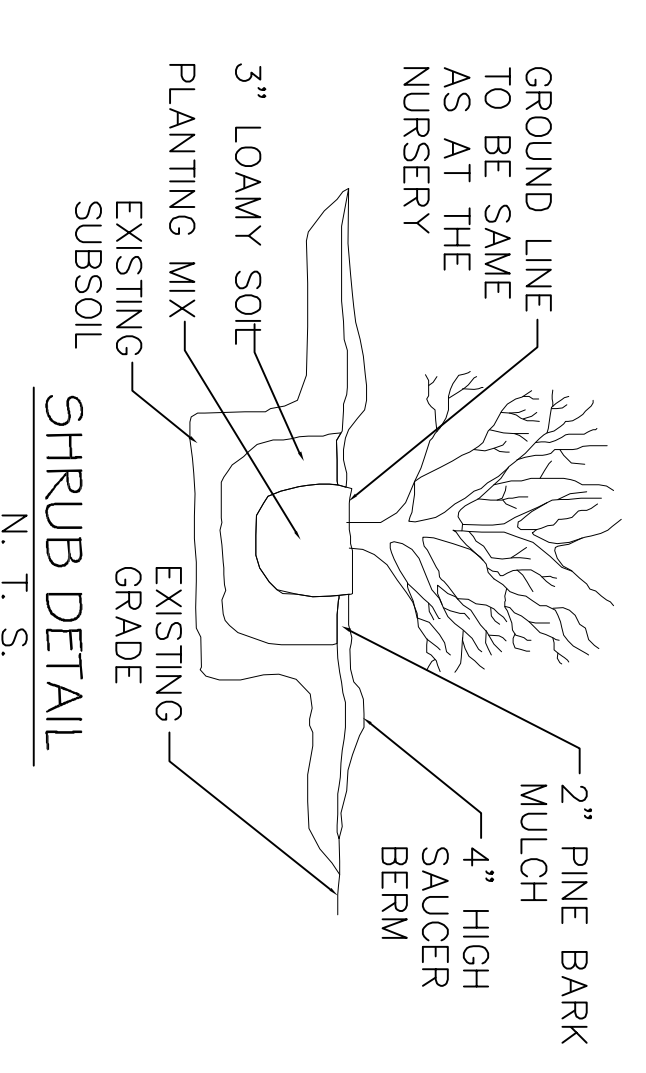

**NOTE:**  
ALL CONCRETE PAVEMENT SHALL BE 5" THICK CONCRETE EXCEPT FROM PROPERTY LINE TO STREET SHALL BE 6" THICK CONCRETE.

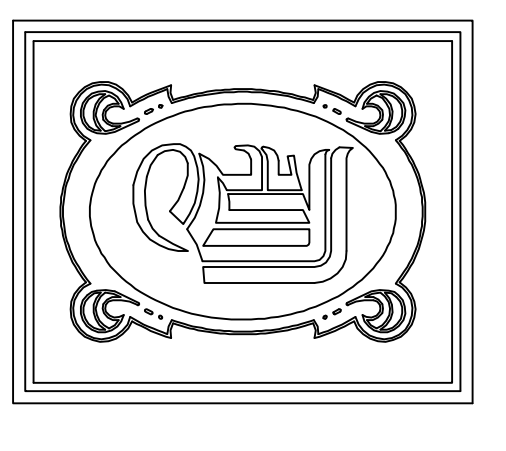

**DAMMON ENGINEERING, INC.**  
CHIEF ENGINEER  
EMMETT DAMMON, P.E.  
CHIEF ARCHITECT  
ROBERT WILTSE

554 OLD SPANISH TRAIL  
SLIDELL, LA. 70458  
OFFICE: 985-649-5832  
FAX: 985-641-5950

WEBSITE: WWW.DAMMONENGINEERING.COM  
EMAIL: DAMMONENG@BELSOUTH.NET

ARCHITECTURE  
ENGINEERING  
STUDIES  
PLANNING  
INVESTIGATION  
EXPERT WITNESS

**NEW ADDITION**

**FEAST CATERING**

109 TAOS  
SLIDELL  
LA

**SITE PLAN**

REV: 06-12-12

SCALE: AS NOTED

JOB#: 2140

DATE: 04-20-12

SHEET

**C-1**

OF