

TYPICAL CROSS SECTION
SCALE: 1/4" = 1'

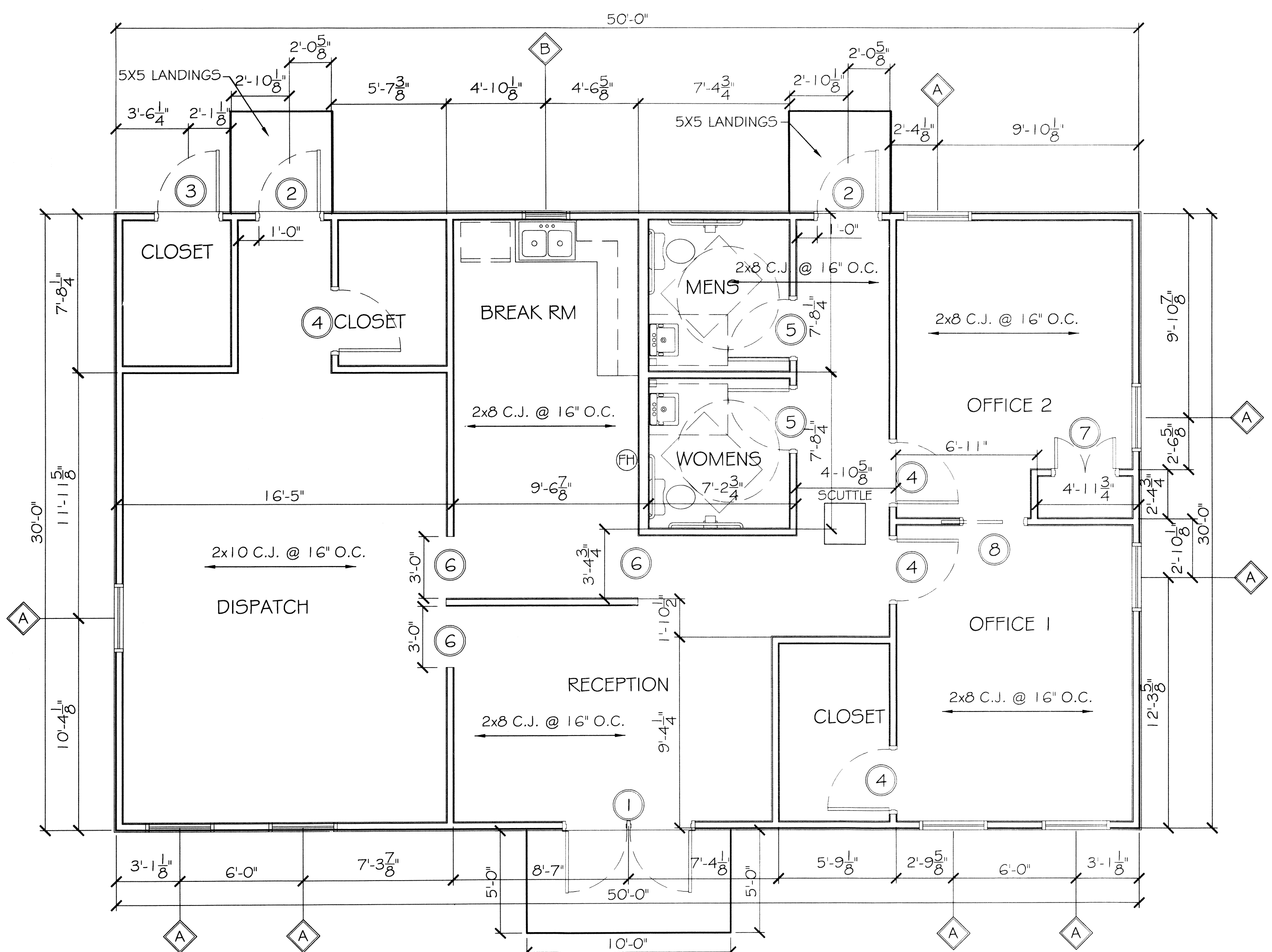

FLOOR PLAN
SCALE: 1/4" = 1'

| FINISH SCHEDULE | | | | | | | |
|-----------------|--------------|-------|-----------|-----|---------|----------|------------|
| ROOM NAME | WALLS | FLOOR | WALL BASE | CLG | CLG HGT | COMMENTS | |
| TOILETS | 5/8" PTD GWB | - | PT | RB | PTD GWB | 11' | GREEN ROCK |
| OFFICE 1 | 5/8" PTD GWB | - | CPT | RB | PTD GWB | 11' | |
| OFFICE 2 | 5/8" PTD GWB | - | CPT | RB | PTD GWB | 11' | |
| OFFICE CLOSET | 5/8" PTD GWB | - | CPT | RB | PTD GWB | 11' | |
| RECEPTION | 5/8" PTD GWB | - | PT | RB | PTD GWB | 11' | |
| HALL | 5/8" PTD GWB | - | PT | RB | PTD GWB | 11' | |
| BREAK ROOM | 5/8" PTD GWB | - | PT | RB | PTD GWB | 11' | |
| DISPATCH | 5/8" PTD GWB | - | CPT | RB | PTD GWB | 11' | |
| DISPATCH CLOSET | 5/8" PTD GWB | - | PT | RB | PTD GWB | 11' | |
| STORAGE | 5/8" PTD GWB | - | CONC | RB | PTD GWB | 11' | |

| LEGEND: | |
|---------|-----------------------------|
| PTD | GYP. WALL BOARD |
| RB | PAINTED RUBBER BASE 4" HIGH |
| PT | PORCELIN TILE |
| CPT | 20 YEAR CARPET |
| CONC | CONCRETE |

FINISH SCHEDULE NOTES:
1. ALL FINISH MATERIALS TO BE SELECTED BY OWNER. VERIFY MANUFACTURER, STYLE, AND COLOR, WITH OWNER.

| DOOR & HARDWARE SCHEDULE | | | | | | |
|--------------------------|-------------|------------------------------------|----------------------|-----------|-----|-----------------------|
| MARK | SIZE | DOOR TYPE | FRAME | HWDR. NO. | STC | REMARKS |
| EXTERIOR DOORS | | | | | | |
| 1 | PR. 3/0x8/0 | STORE FRONT | TO MATCH DOOR | 1 | NA | SELECTED BY OWNER |
| 2 | 3/0x7/0 | FLUSH GALV. HOL. MET. STEEL INSUL. | GALV. PTD. HOL. MET. | 2 | NA | GALVANIZING TO BE G90 |
| 3 | 3/0x7/0 | FLUSH GALV. HOL. MET. STEEL INSUL. | STEEL FRAME | 4 | NA | GALVANIZING TO BE G90 |
| INTERIOR DOORS | | | | | | |
| 4 | 3/0x8/0 | SELECTED BY OWNER. | PTD. HOL. MET. | 4 | NA | |
| 5 | 3/0x8/0 | SELECTED BY OWNER. | TO MATCH WALL | 4 | NA | |
| 6 | 3/0x8/0 | CASED OPENING | TO MATCH WALL | NA | NA | |
| 7 | 3/0x8/0 | SELECTED BY OWNER. | TO MATCH WALL | 4 | NA | BY-FOLD DOOR |
| 8 | 3/0x8/0 | SELECTED BY OWNER. | TO MATCH WALL | NA | NA | SLIDING DOOR |

- DOOR HARDWARE SCHEDULE:
- AUTO CLOSER, AIR RESISTANT METAL THRESHOLD, WEATHERSTRIP, DOOR STOP, EXTERIOR CYLINDER LOCK (ENTRANCE), BALL BEARING U532D HINGES.
 - AUTO CLOSER, DOOR STOP, CYLINDER LOCK (OFFICE/ENTRANCE), BALL BEARING U532D HINGES.
 - PASSAGE LOCK, DOOR STOP, U526D HINGES.
 - KEYED HANDLE, DOOR STOP, U526D HINGES.
 - AUTO CLOSER, PRIVACY LOCK, BALL BEARING U526D HINGES.

| WINDOW SCHEDULE | | | | | |
|-----------------|-----------------|-------------|----------|-------|-------------------------|
| MARK | SIZE | WINDOW TYPE | FRAME | GLASS | REMARKS |
| A | 3'-0"W x 6'-0"H | ALUMINUM | ALUMINUM | LOW E | SEE EXTERIOR ELEVATIONS |
| B | 2'-0"W x 4'-0"H | ALUMINUM | ALUMINUM | LOW E | SEE EXTERIOR ELEVATIONS |

- WINDOW SCHEDULE NOTES:
- GLAZING TO BE DBL. GLAZED LAMINATED LOW E.
 - EXTERIOR WINDOW SYSTEM SHALL BE CAPABLE OF RESISTING 130 MPH WIND LOAD.

- GENERAL NOTES**
- INSULATION AND INSULATION ASSEMBLIES SHALL MEET THE REQUIREMENTS OF SECTION 719.
 - CONCEALED INSULATION SHALL HAVE A FLAME SPREAD OF 0-25 AND SMOKE DEVELOPED INDEX OF 0-450. EXCEPT THAT IN COMBUSTIBLE (WOOD FRAME) CONSTRUCTION.
 - FACING SHALL COMPLY WITH IBC 2009.
 - PROVIDE 5X5' LANDINGS, LEVEL WITH FINISHED FLOOR, OUTSIDE EXTERIOR DOORS ON WEST SIDE OF BUILDING. THRESHOLDS SHALL BE NOT MORE THAN 1/2" IN HEIGHT AND SHALL BE BEVELED IF MORE THAN 1/4".
 - CONTRACTOR TO VERIFY ALL SITE CONDITIONS, BUILDING LOCATIONS, AND DIMENSIONS PRIOR TO CONSTRUCTION.
 - MATERIALS SHALL BE NEW AND U.L. LISTED.
 - NO WORK SHALL BE CONCEALED UNTIL APPROVED BY LOCAL INSPECTORS.
 - CONSTRUCTION SHALL COMPLY WITH ALL PARISH, STATE, AND LOCAL CODES.
 - CONTRACTOR TO GUARANTEE WORK FOR ONE YEAR.
 - CONTRACTOR SHALL FURNISH WATER AND POWER FROM EXISTING SOURCES.
 - EXTERIOR CAULKING SHALL BE THICK CAULK.
 - PAINT GRADE TO SHALL BE SHERWIN WILLIAMS OR EQUIVALENT. ALL WORK TO RECEIVE 3 COATS. COLOR SELECTION BY OWNER.
 - PROVIDE CLEANUP ON A REGULAR BASIS. NO TRASH STORED IN BUILDING.
 - ALL BATT INSULATION SHALL HAVE A CLASS "A" (0-25) FLAME SPREAD IN COMPLIANCE WITH APPLICABLE CODE.
 - USE 6" STUDS, OR 4" STAGGERED STUDS AT ALL PLUMBING WALLS.
 - PROVIDE GALVANIZED METAL PAN WITH DRAIN AT WATER HEATER LOCATION.
 - ALL CORNERS SHALL BE PROPERLY BRACED FOR WIND LOADS. A 48" SHEATHING SHALL BE PROVIDED EVERY 20 FEET OF WALL LENGTH.
 - INTERIOR LOCKS ON DOORS IN MEANS OF EGRESS SHALL NOT REQUIRE THE USE OF A KEY, SPECIAL KNOWLEDGE, OR SPECIAL DEVICE TO OPEN IN THE DIRECTION OF EGRESS. ALL DOORS SHALL HAVE LEVER TYPE HANDLES.
 - INTERIOR WALLS AND CEILINGS SHALL HAVE A FLAME SPREAD OF 0-200 AND A SMOKE DEVELOPMENT RATING OF 0-450.
 - ALL WORK SHALL COMPLY WITH THE LATEST EDITION OF ALL LOCAL, STATE, AND NATIONAL CODES COVERING THE TYPE OF WORK BEING PERFORMED.
 - PROVIDE PORTABLE FIRE EXTINGUISHERS IN ACCORDANCE WITH NFPA 101. SEE APPENDIX "E" OF NFPA 101 FOR DISTRIBUTION OF EXTINGUISHERS.
 - ALL FIRE WALLS SHALL EXTEND TIGHT TO ROOF DECK AND BE SEALED WITH AN APPROVED FIRE CAULK.
 - ALL ELECTRICAL, MECHANICAL, AND PLUMBING MATERIALS PENETRATING FIRE WALLS SHALL BE FIRE CAULKED. (PENETRATIONS THROUGH RATED CONSTRUCTION SHALL BE SEALED WITH A MATERIAL CAPABLE OF PREVENTING THE PASSAGE OF FLAMES AND HOT GASES WHEN TESTED IN ACCORDANCE WITH ASTM-E814.)
 - SERVICE COUNTER SHALL HAVE A HCP ACCESSIBLE WRITING SURFACE, MAX. 36" FROM F.F. (ADAAG MANUAL 1998, PG 135)

DAMMON ENGINEERING, INC.
Architects & Engineers

admin@dammoneng.com
dammon@dammoneng.com
PHONE: 985-649-5632
FAX: 985-641-9590

CHIEF ENGINEER: DAMON DAMMON, P.E.
PROJECT ENGINEER: T. NICHOLEN
554 OLD SPANISH TRAIL
SUDELL, LA 70456

**LANDIS TRANSPORT LLC
OFFICE/WAREHOUSE BUILDING**

LOT 21 #400 LEEWARD LOOP
ST. TAMMANY PARISH COVINGTON, LOUISIANA

JOB No: 2164 DATE: 01-30-2013 CHECKED BY: CD
DRAWN BY: JCT

| REVISIONS | DATE |
|-----------|------|
| | |
| | |
| | |

FLOOR PLAN

SHEET No: 4 OF 8

A1