

ELECTRICAL LEGEND	
	EXTERIOR LIGHT FIXTURE WITH 90 MIN. BACKUP.
	EMERGENCY LIGHTING WITH 90 MINUTE BATTERY BACKUP.
	WALL OR CEILING MOUNTED EMERGENCY EXIT LIGHT WITH 90 MIN. BATTERY BACKUP.
	WALL MOUNTED LIGHT SWITCH.
	JUNCTION BOX

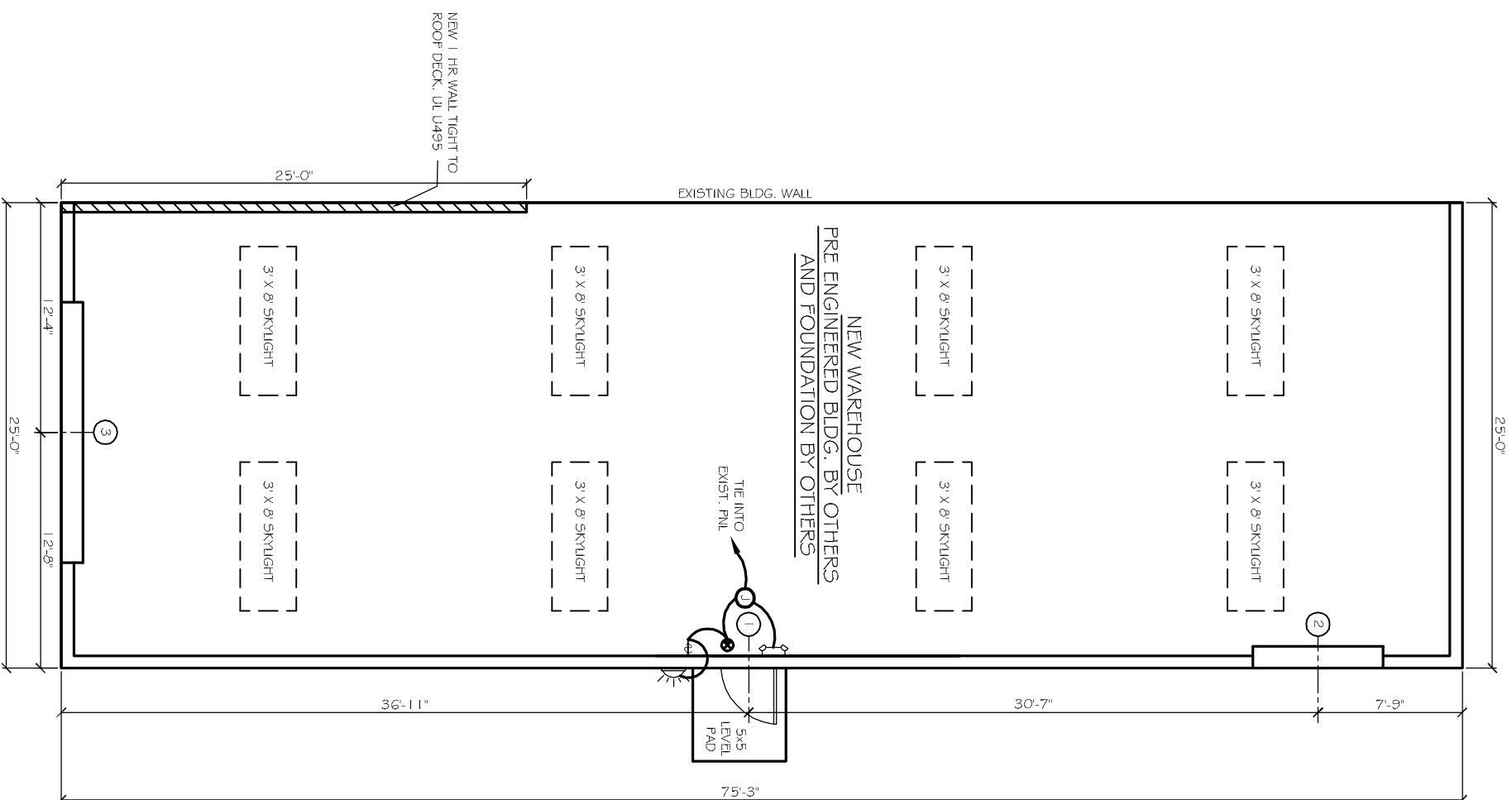

DOOR & HARDWARE SCHEDULE						
MARK	SIZE	DOOR TYPE	FRAME	HWK. NO.	STC	REMARKS
EXTERIOR DOORS						
1	PR. 3'0x6'8	FLUSH GALV. HOL. MET. STEEL INSUL.	GALV. PTD. HOL. MET.	1	NA	GALVANIZING TO BE G90
2	8' x 7'	ROLL-UP MTL. DR.	GALV. PTD. HOL. MET.	NA	NA	GALVANIZING TO BE G90
3	12' x 14'	ROLL-UP MTL. DR.	GALV. PTD. HOL. MET.	NA	NA	GALVANIZING TO BE G90

DOOR HARDWARE SCHEDULE:  
1. AUTO CLOSER, KEYPED HANDLE, AIR RESISTANT METAL THRESHOLD, WEATHERSTRIP, RATED FOR 130MPH.

WINDBORNE DEBRIS PROTECTION FASTENING SCHEDULE FOR WOOD STRUCTURAL PANELS			
FASTENER TYPE	FASTENER SPACING		
	2-1/2" #6 WOOD SCREWS	4 FOOT PANEL SPAN ≤ 4 FOOT	6 FOOT PANEL SPAN ≤ 6 FOOT
2-1/2" #8 WOOD SCREWS	16"	12"	12"

WINDOWS IN BUILDINGS LOCATED IN WIND BORNE DEBRIS REGIONS SHALL HAVE GLAZED OPENINGS PROTECTED FROM WINDBORNE DEBRIS. WOOD STRUCTURAL PANELS WITH A MIN. THICKNESS OF 7/16" AND A MAX. SPAN OF 8 FEET SHALL BE PERMITTED FOR OPENING PROTECTION IN ONE AND TWO STORY BUILDINGS. PANELS SHALL BE PRECUT TO COVER THE GLAZED OPENINGS WITH ATTACHMENT HARDWARE PROVIDED.

1 HOUR RATED FIREWALL			
REF. DESIGN NO.	DESCRIPTION	STC	TEST No.
WHI 651 -0489 01	5/8" FIRE-SHIELD TYPE X WALLBOARD SCREW ATTACHED VERTICALLY TO BOTH SIDES OF 3.5/8", 20ga. STEEL STUDS 16" O.C. WALLBOARD JOINTS STAGGERED.	40	BASED ON NCG 2501
UL U495			
UL V416		43	BASED ON NCG 2502
GA WP 1201	2-1/2" FIBERGLASS INSULATION IN CAVITY		

### GENERAL NOTES

- INSULATION AND INSULATION ASSEMBLIES SHALL MEET THE REQUIREMENTS OF SECTION 7.19.
  - CONCEALED INSULATION SHALL HAVE A FLAME SPREAD OF 0-25 AND SMOKE DEVELOPED INDEX OF 0-450. EXCEPT THAT IN COMBUSTIBLE (WOOD FRAMED) CONSTRUCTION.
    - FACING SHALL COMPLY WITH IBC 2006.
  - PROVIDE 5x5' LANDINGS, LEVEL WITH FINISHED FLOOR, OUTSIDE EXTERIOR DOORS ON WEST SIDE OF BUILDING. THRESHOLDS SHALL BE NOT MORE THAN 1/2" IN HEIGHT AND SHALL BE REVEALED IF MORE THAN 1/4".
  - CONTRACTOR TO VERIFY ALL SITE CONDITIONS, BUILDING LOCATIONS, AND DIMENSIONS PRIOR TO CONSTRUCTION.
  - MATERIALS SHALL BE NEW AND U.L. LISTED.
  - NO WORK SHALL BE CONCEALED UNTIL APPROVED BY LOCAL INSPECTORS.
  - CONSTRUCTION SHALL COMPLY WITH ALL PARISH, STATE, AND LOCAL CODES.
  - CONTRACTOR TO GUARANTEE WORK FOR ONE YEAR.
  - CONTRACTOR SHALL FURNISH WATER AND POWER FROM EXISTING SOURCES.
  - EXTERIOR CAULKING SHALL BE THIRKAL CAULK.
  - PAINT GRADE TO SHALL BE SHERWIN WILLIAMS OR EQUIVALENT. ALL WORK TO RECEIVE 3 COATS, COLOR SELECTION BY OWNER.
  - PROVIDE CLEANUP ON A REGULAR BASIS. NO TRASH STORED IN BUILDING.
  - ALL BATT INSULATION SHALL HAVE A CLASS 54" (0-25) FLAME SPREAD IN COMPLIANCE WITH APPLICABLE CODE.
  - USE 6" STUDS, OR 4" STAGGERED STUDS AT ALL PLUMBING WALLS.
  - PROVIDE GALVANIZED METAL PAN WITH DRAIN AT WATER HEATER LOCATION.
  - ALL CORNERS SHALL BE PROPERLY BRACED FOR WIND LOADS. A 4ga SHEATHING SHALL BE PROVIDED EVERY 20 FEET OF WALL LENGTH. INTERIOR LOCKS ON DOORS, IN MEANS OF EGRESS SHALL NOT REQUIRE THE USE OF A KEY, SPECIAL KNOWLEDGE, OR SPECIAL DEVICE TO OPEN IN THE DIRECTION OF EGRESS. ALL DOORS SHALL HAVE LEVER TYPE HANDLES.
  - INTERIOR WALLS AND CEILINGS SHALL HAVE A FLAME SPREAD OF 0-200 AND A SMOKE DEVELOPMENT RATING OF 0-450.
  - ALL WORK SHALL COMPLY WITH THE LATEST EDITION OF ALL LOCAL, STATE, AND NATIONAL CODES COVERING THE TYPE OF WORK BEING PERFORMED.
  - PROVIDE PORTABLE FIRE EXTINGUISHERS IN ACCORDANCE WITH NFPA 10.1. SEE APPENDIX 'E' OF NFPA 10.1 FOR DISTRIBUTION OF EXTINGUISHERS.
  - ALL FIRE WALLS SHALL EXTEND TIGHT TO ROOF DECK AND BE SEALED WITH AN APPROVED FIRE CAULK.
  - ALL ELECTRICAL, MECHANICAL, AND PLUMBING MATERIALS PENETRATING FIRE WALLS SHALL BE FIRE CAULKED, PENETRATIONS THROUGH RATED CONSTRUCTION SHALL BE SEALED WITH A MATERIAL CAPABLE OF PREVENTING THE PASSAGE OF FLAMES AND HOT GASES WHEN TESTED IN ACCORDANCE WITH ASTM E1414.
  - SERVICE COUNTER SHALL HAVE A HCP ACCESSIBLE WRITING SURFACE, MAX. 36" FROM F.F. (ADAAG MANUAL 1998, PG. 135)

**DAMMON**  
ENGINEERING, INC.

CHIEF ENGINEER  
EMMETT DAMMON, P.E.

CHIEF ARCHITECT  
ROBERT WILTSE

554 OLD SPANISH TRAIL  
SUDELL, LA. 70458  
OFFICE: 985-643-5832  
FAX: 985-641-5950

WWW.DAMMONENGINEERING.COM  
WEBSITE:  
EMAIL:  
DAMMONENG@BELL SOUTH.NET

ARCHITECTURE  
ENGINEERING  
STUDIES  
PLANNING  
INVESTIGATION  
EXPERT WITNESS

NEWMAN  
TRANSPORT LLC.  
63336  
OLD MILITARY RD.  
PEARL RIVER LA.

FLOOR  
PLAN

REV:

SCALE: AS NOTED

JOB#: 2124

DATE: 10-19-11

SHEET 3

OF 4