

4.6 PARKING AND PASSENGER LOADING ZONES.

4.6.1 **MINIMUM NUMBER.** PARKING SPACES REQUIRED TO BE ACCESSIBLE BY 4.1 SHALL COMPLY WITH 4.6.1.1 AND 4.6.1.2. UNLESS SHOWN OTHERWISE, THEY SHALL BE ACCESSIBLE BY 4.1.

4.6.1.1 **LOCATION.** ACCESSIBLE PARKING SPACES SERVING A MULTIPURPOSE BUILDING SHALL BE LOCATED ON THE SHORTEST ACCESSIBLE ROUTE OF TRAVEL FROM ADJACENT PARKING TO THE BUILDING. ACCESSIBLE PARKING SPACES SHALL BE DESIGNED AND LOCATED TO PROVIDE THE SHORTEST ACCESSIBLE ROUTE OF TRAVEL FROM ADJACENT PARKING TO THE BUILDING. ACCESSIBLE PARKING SPACES SHALL BE DESIGNED AND LOCATED TO PROVIDE THE SHORTEST ACCESSIBLE ROUTE OF TRAVEL FROM ADJACENT PARKING TO THE BUILDING. ACCESSIBLE PARKING SPACES SHALL BE DESIGNED AND LOCATED TO PROVIDE THE SHORTEST ACCESSIBLE ROUTE OF TRAVEL FROM ADJACENT PARKING TO THE BUILDING.

4.6.1.2 **PARKING SPACES.** PARKING SPACES FOR DISABLED PEOPLE SHALL BE AT LEAST 9'6" (2900 mm) WIDE AND SHALL HAVE AN ADJACENT ACCESSIBLE ROUTE OF TRAVEL TO THE BUILDING. PARKING SPACES SHALL BE AT LEAST 9'6" (2900 mm) WIDE AND SHALL HAVE AN ADJACENT ACCESSIBLE ROUTE OF TRAVEL TO THE BUILDING. PARKING SPACES SHALL BE AT LEAST 9'6" (2900 mm) WIDE AND SHALL HAVE AN ADJACENT ACCESSIBLE ROUTE OF TRAVEL TO THE BUILDING.

4.6.2 **ADJACENT SLOPE.** ADJACENT SLOPE SHALL BE 1:20 (5%) MAXIMUM. ADJACENT SLOPE SHALL BE 1:20 (5%) MAXIMUM. ADJACENT SLOPE SHALL BE 1:20 (5%) MAXIMUM. ADJACENT SLOPE SHALL BE 1:20 (5%) MAXIMUM.

4.6.3 **ACCESSIBLE PARKING SPACES.** ACCESSIBLE PARKING SPACES SHALL BE DESIGNED AS REQUIRED FOR THE ACCESSIBLE PARKING SPACES. ACCESSIBLE PARKING SPACES SHALL BE DESIGNED AS REQUIRED FOR THE ACCESSIBLE PARKING SPACES.

4.7 CURB RAMPS.

4.7.1 **GENERAL.** CURB RAMPS SHALL BE DESIGNED AS REQUIRED FOR THE ACCESSIBLE PARKING SPACES. CURB RAMPS SHALL BE DESIGNED AS REQUIRED FOR THE ACCESSIBLE PARKING SPACES.

4.7.2 **WIDTH.** THE MINIMUM WIDTH OF A CURB RAMP SHALL BE 3'0" (914 mm) EXCLUSIVE OF FLARED SIDES.

4.7.3 **SURFACE.** SURFACES OF CURB RAMPS SHALL COMPLY WITH 4.3.

4.7.4 **STAIRS OF CURB RAMPS.** STAIRS OF CURB RAMPS SHALL COMPLY WITH 4.3. STAIRS OF CURB RAMPS SHALL COMPLY WITH 4.3.

4.7.5 **PROTECTION.** CURB RAMPS SHALL BE PROTECTED TO PREVENT THEIR CONTAMINATION BY THE WHEELS, INCLUDING AIR FLARED SIDES.

4.7.6 **ADJACENT SLOPE.** ADJACENT SLOPE SHALL BE 1:20 (5%) MAXIMUM. ADJACENT SLOPE SHALL BE 1:20 (5%) MAXIMUM.

4.7.7 **WALKING SURFACES.** WALKING SURFACES SHALL BE DESIGNED AS REQUIRED FOR THE ACCESSIBLE PARKING SPACES.

4.7.8 **ADJACENT SLOPE.** ADJACENT SLOPE SHALL BE 1:20 (5%) MAXIMUM. ADJACENT SLOPE SHALL BE 1:20 (5%) MAXIMUM.

4.7.9 **ADJACENT SLOPE.** ADJACENT SLOPE SHALL BE 1:20 (5%) MAXIMUM. ADJACENT SLOPE SHALL BE 1:20 (5%) MAXIMUM.

4.7.10 **ADJACENT SLOPE.** ADJACENT SLOPE SHALL BE 1:20 (5%) MAXIMUM. ADJACENT SLOPE SHALL BE 1:20 (5%) MAXIMUM.

4.7.11 **ADJACENT SLOPE.** ADJACENT SLOPE SHALL BE 1:20 (5%) MAXIMUM. ADJACENT SLOPE SHALL BE 1:20 (5%) MAXIMUM.

4.7.12 **ADJACENT SLOPE.** ADJACENT SLOPE SHALL BE 1:20 (5%) MAXIMUM. ADJACENT SLOPE SHALL BE 1:20 (5%) MAXIMUM.

4.7.13 **ADJACENT SLOPE.** ADJACENT SLOPE SHALL BE 1:20 (5%) MAXIMUM. ADJACENT SLOPE SHALL BE 1:20 (5%) MAXIMUM.

4.7.14 **ADJACENT SLOPE.** ADJACENT SLOPE SHALL BE 1:20 (5%) MAXIMUM. ADJACENT SLOPE SHALL BE 1:20 (5%) MAXIMUM.

4.7.15 **ADJACENT SLOPE.** ADJACENT SLOPE SHALL BE 1:20 (5%) MAXIMUM. ADJACENT SLOPE SHALL BE 1:20 (5%) MAXIMUM.

4.7.16 **ADJACENT SLOPE.** ADJACENT SLOPE SHALL BE 1:20 (5%) MAXIMUM. ADJACENT SLOPE SHALL BE 1:20 (5%) MAXIMUM.

4.7.17 **ADJACENT SLOPE.** ADJACENT SLOPE SHALL BE 1:20 (5%) MAXIMUM. ADJACENT SLOPE SHALL BE 1:20 (5%) MAXIMUM.

4.7.18 **ADJACENT SLOPE.** ADJACENT SLOPE SHALL BE 1:20 (5%) MAXIMUM. ADJACENT SLOPE SHALL BE 1:20 (5%) MAXIMUM.

4.7.19 **ADJACENT SLOPE.** ADJACENT SLOPE SHALL BE 1:20 (5%) MAXIMUM. ADJACENT SLOPE SHALL BE 1:20 (5%) MAXIMUM.

4.7.20 **ADJACENT SLOPE.** ADJACENT SLOPE SHALL BE 1:20 (5%) MAXIMUM. ADJACENT SLOPE SHALL BE 1:20 (5%) MAXIMUM.

4.7.21 **ADJACENT SLOPE.** ADJACENT SLOPE SHALL BE 1:20 (5%) MAXIMUM. ADJACENT SLOPE SHALL BE 1:20 (5%) MAXIMUM.

4.7.22 **ADJACENT SLOPE.** ADJACENT SLOPE SHALL BE 1:20 (5%) MAXIMUM. ADJACENT SLOPE SHALL BE 1:20 (5%) MAXIMUM.

4.7.23 **ADJACENT SLOPE.** ADJACENT SLOPE SHALL BE 1:20 (5%) MAXIMUM. ADJACENT SLOPE SHALL BE 1:20 (5%) MAXIMUM.

4.7.24 **ADJACENT SLOPE.** ADJACENT SLOPE SHALL BE 1:20 (5%) MAXIMUM. ADJACENT SLOPE SHALL BE 1:20 (5%) MAXIMUM.

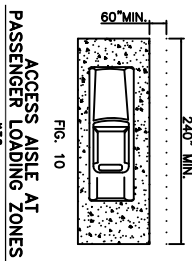

FIG. 10 ACCESS AISLE AT PASSENGER LOADING ZONES

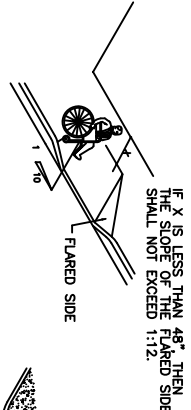

FIG. 11 MEASUREMENT OF CURB RAMP SLOPES

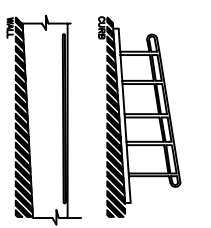

FIG. 12 SIDES OF CURB RAMPS

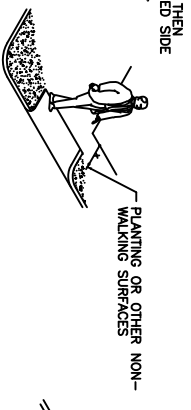

FIG. 13 BUILT-UP CURB RAMP

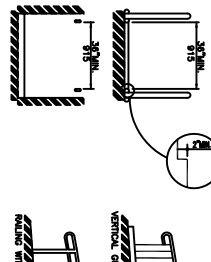

FIG. 14 EXAMPLES OF EDGE PROTECTION AND HANDRAIL EXTENSIONS

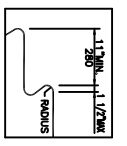

FIG. 15 FLUSH RISER

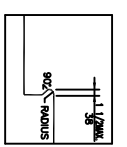

FIG. 16 BEVELED NOSING

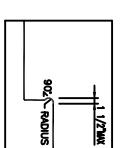

FIG. 17 ROUNDED NOSING

USEABLE TREAD WIDTH AND EXAMPLES OF ACCEPTABLE NOSINGS

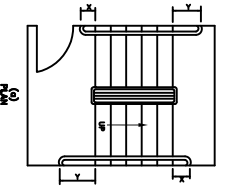

FIG. 18

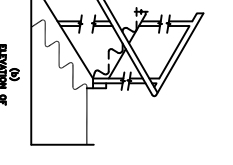

FIG. 19

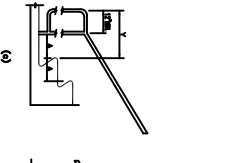

FIG. 20

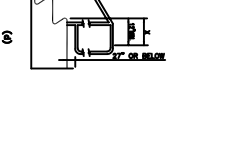

FIG. 21

STAIR HANDRAILS

FIG. 22

4.12 WINDOWS.

4.12.1 **GENERAL.** (RESERVED)

4.12.2 **WINDOW HANDRAIL.** (RESERVED)

4.13 DOORS.

4.13.1 **GENERAL.** DOORS REQUIRED TO BE ACCESSIBLE BY 4.1 SHALL COMPLY WITH THE REQUIREMENTS OF 4.13.1.1 THROUGH 4.13.1.5.

4.13.1.1 **REQUIREMENTS.** REQUIRING DOORS OF THRESHOLDS SHALL NOT BE THE ONLY WAY OF PROVIDING AN ACCESSIBLE ENTRANCE TO A ROOM OR SPACE. ACCESSIBLE ENTRANCES TO A ROOM OR SPACE SHALL BE PROVIDED BY AN ACCESSIBLE ROUTE OF TRAVEL FROM ADJACENT PARKING TO THE BUILDING. ACCESSIBLE ENTRANCES TO A ROOM OR SPACE SHALL BE PROVIDED BY AN ACCESSIBLE ROUTE OF TRAVEL FROM ADJACENT PARKING TO THE BUILDING.

4.13.1.2 **DOORS.** DOORS, INCLUDING TOWER DOORS, SHALL MEET ALL APPLICABLE REQUIREMENTS OF 4.13.1.2.1 THROUGH 4.13.1.2.5.

4.13.1.2.1 **DOUBLE-LEAF DOORWAYS.** IF DOORWAYS HAVE TWO SEPARATELY OPERATED DOOR LEAVES, THE LEAVES SHALL MEET THE REQUIREMENTS OF 4.13.1.2.1.1 THROUGH 4.13.1.2.1.5.

4.13.1.2.1.1 **GENERAL.** THE MINIMUM CLEARANCE BETWEEN THE LEAVES OF A DOUBLE-LEAF DOORWAY SHALL BE 3'0" (914 mm) EXCLUSIVE OF FLARED SIDES.

4.13.1.2.1.2 **ADJACENT SLOPE.** ADJACENT SLOPE SHALL BE 1:20 (5%) MAXIMUM. ADJACENT SLOPE SHALL BE 1:20 (5%) MAXIMUM.

4.13.1.2.1.3 **PROTECTION.** CURB RAMPS SHALL BE PROTECTED TO PREVENT THEIR CONTAMINATION BY THE WHEELS, INCLUDING AIR FLARED SIDES.

4.13.1.2.1.4 **ADJACENT SLOPE.** ADJACENT SLOPE SHALL BE 1:20 (5%) MAXIMUM. ADJACENT SLOPE SHALL BE 1:20 (5%) MAXIMUM.

4.13.1.2.1.5 **ADJACENT SLOPE.** ADJACENT SLOPE SHALL BE 1:20 (5%) MAXIMUM. ADJACENT SLOPE SHALL BE 1:20 (5%) MAXIMUM.

4.14 ENTRANCES.

4.14.1 **MINIMUM NUMBER.** ENTRANCES REQUIRED TO BE ACCESSIBLE BY 4.1 SHALL COMPLY WITH THE REQUIREMENTS OF 4.14.1.1 THROUGH 4.14.1.5.

4.14.1.1 **GENERAL.** ENTRANCES REQUIRED TO BE ACCESSIBLE BY 4.1 SHALL COMPLY WITH THE REQUIREMENTS OF 4.14.1.1.1 THROUGH 4.14.1.1.5.

4.14.1.1.1 **REQUIREMENTS.** REQUIRING DOORS OF THRESHOLDS SHALL NOT BE THE ONLY WAY OF PROVIDING AN ACCESSIBLE ENTRANCE TO A ROOM OR SPACE. ACCESSIBLE ENTRANCES TO A ROOM OR SPACE SHALL BE PROVIDED BY AN ACCESSIBLE ROUTE OF TRAVEL FROM ADJACENT PARKING TO THE BUILDING. ACCESSIBLE ENTRANCES TO A ROOM OR SPACE SHALL BE PROVIDED BY AN ACCESSIBLE ROUTE OF TRAVEL FROM ADJACENT PARKING TO THE BUILDING.

4.14.1.1.2 **DOORS.** DOORS, INCLUDING TOWER DOORS, SHALL MEET ALL APPLICABLE REQUIREMENTS OF 4.14.1.1.2.1 THROUGH 4.14.1.1.2.5.

4.14.1.1.2.1 **DOUBLE-LEAF DOORWAYS.** IF DOORWAYS HAVE TWO SEPARATELY OPERATED DOOR LEAVES, THE LEAVES SHALL MEET THE REQUIREMENTS OF 4.14.1.1.2.1.1 THROUGH 4.14.1.1.2.1.5.

4.14.1.1.2.1.1 **GENERAL.** THE MINIMUM CLEARANCE BETWEEN THE LEAVES OF A DOUBLE-LEAF DOORWAY SHALL BE 3'0" (914 mm) EXCLUSIVE OF FLARED SIDES.

4.14.1.1.2.1.2 **ADJACENT SLOPE.** ADJACENT SLOPE SHALL BE 1:20 (5%) MAXIMUM. ADJACENT SLOPE SHALL BE 1:20 (5%) MAXIMUM.

4.14.1.1.2.1.3 **PROTECTION.** CURB RAMPS SHALL BE PROTECTED TO PREVENT THEIR CONTAMINATION BY THE WHEELS, INCLUDING AIR FLARED SIDES.

4.14.1.1.2.1.4 **ADJACENT SLOPE.** ADJACENT SLOPE SHALL BE 1:20 (5%) MAXIMUM. ADJACENT SLOPE SHALL BE 1:20 (5%) MAXIMUM.

4.14.1.1.2.1.5 **ADJACENT SLOPE.** ADJACENT SLOPE SHALL BE 1:20 (5%) MAXIMUM. ADJACENT SLOPE SHALL BE 1:20 (5%) MAXIMUM.

HANDICAP DETAILS
PYTHON CONSTRUCTION
TRACT 361 OF N. OAKLAWN
ST. TAMMANY PARISH, LA

DAMMON ENGINEERING, INC.
1095 FLORIDA AVENUE 985-649-5832 SLIDELL, LA. 70458
DAMMONENGINEERING.COM

OFFICE/ WAREHOUSE
SCALE: AS NOTED
JOB NO. 1505
DATE: 03-08-05
SHEET 13
H-1
OF 21