

GENERAL NOTES

- INSULATION AND INSULATION ASSEMBLIES SHALL MEET THE REQUIREMENTS OF SECTION 719.
 - CONCEALED INSULATION SHALL HAVE A FLAME SPREAD OF 0-25 AND SMOKE DEVELOPED INDEX OF 0-450, EXCEPT THAT IN COMBUSTIBLE (WOOD FRAME) CONSTRUCTION.
 - FACING SHALL COMPLY WITH IRC 2006.
 - PROVIDE 5/8" LANDINGS, LEVEL WITH FINISHED FLOOR, OUTSIDE EXTERIOR DOORS. THRESHOLDS SHALL BE NOT MORE THAN 1/2" IN HEIGHT AND SHALL BE BEVELLED IF MORE THAN 1/4" DIMENSIONS ARE TO CENTERLINE. FACE OF STUDS, CENTER OF COLUMNS, OR FACE OF VIMBER.
 - CONTRACTOR TO VERIFY ALL SITE CONDITIONS, BUILDING LOCATIONS, AND DIMENSIONS PRIOR TO CONSTRUCTION.
 - MATERIALS SHALL BE NEW AND U.L. LISTED.
 - NO WORK SHALL BE CONCEALED UNTIL APPROVED BY LOCAL INSPECTORS.
 - CONSTRUCTION SHALL COMPLY WITH ALL PARISH, STATE AND LOCAL CODES.
 - CONTRACTOR TO GUARANTEE WORK FOR ONE YEAR.
 - CONTRACTOR SHALL FURNISH WATER AND POWER FROM EXISTING SOURCES.
- EXTERIOR CAULK SHALL BE DOW CORNING 790 SILICONE, INSTALL IN ACCORDANCE WITH MANUFACTURER'S RECOMMENDATIONS. COORDINATE WITH ARCHITECT/OWNER AS TO COLOR. INTERIOR CAULKING TO BE EQUAL TO DAP PAINTABLE LATEX WITH SILICONE. PAINT GRADE TO SHALL BE SHERMAN WILLIAMS OR EQUIVALENT. ALL WORK TO RECEIVE 3 COATS. COLOR SELECTION BY OWNER.
- PROVIDE CLEANUP ON A REGULAR BASIS. NO TRASH STORED IN BUILDING.
- ALL BATT INSULATION SHALL HAVE A CLASS "A" (0-25) FLAME SPREAD IN COMPLIANCE WITH APPLICABLE CODE.
- USE 6" STUDS, OR 4" STAGGERED STUDS AT ALL PLUMBING WALLS.
- PROVIDE GALVANIZED METAL PAN WITH DRAIN AT WATER HEATER LOCATION.
- ALL CORNERS SHALL BE PROPERLY BRACED FOR WIND LOADS. A 48" SHEATHING SHALL BE PROVIDED EVERY 20 FEET OF WALL LENGTH.
- FLOORING SHALL BE NON-SLIP.
- INTERIOR LOCKS ON DOORS, IN MEANS OF EGRESS SHALL NOT REQUIRE THE USE OF A KEY, SPECIAL KNOWLEDGE, OR SPECIAL DEVICE TO OPEN IN THE DIRECTION OF EGRESS. ALL DOORS SHALL HAVE LEVER TYPE HANDLES.
- INTERIOR WALLS AND CEILINGS SHALL HAVE A FLAME SPREAD OF 0-200 AND A SMOKE DEVELOPMENT RATING OF 0-450.
- ALL WORK SHALL COMPLY WITH THE LATEST EDITION OF ALL LOCAL, STATE AND NATIONAL CODES COVERING THE TYPE OF WORK BEING PERFORMED.
- PROVIDE PORTABLE FIRE EXTINGUISHERS IN ACCORDANCE WITH NFPA 101. SEE APPENDIX "E" OF NFPA 101 FOR DISTRIBUTION OF EXTINGUISHERS.
- ALL FIRE WALLS SHALL EXTEND TIGHT TO ROOF SHEATHING, AND BE SEALED WITH AN APPROVED FIRE CALK.
- ALL ELECTRICAL, MECHANICAL, AND PLUMBING MATERIALS PENETRATING FIRE WALLS SHALL BE FIRE CALKED (PENETRATIONS THROUGH RATED CONSTRUCTION SHALL BE SEALED WITH A MATERIAL CAPABLE OF PREVENTING THE PASSAGE OF FLAMES AND HOT GASES WHEN TESTED IN ACCORDANCE WITH ASTM-E814.)
- SERVICE COUNTER SHALL HAVE A HOP ACCESSIBLE WRITING SURFACE. MAX. 36" FROM F.F. (ADAAG MANUAL 1998, PG 135)

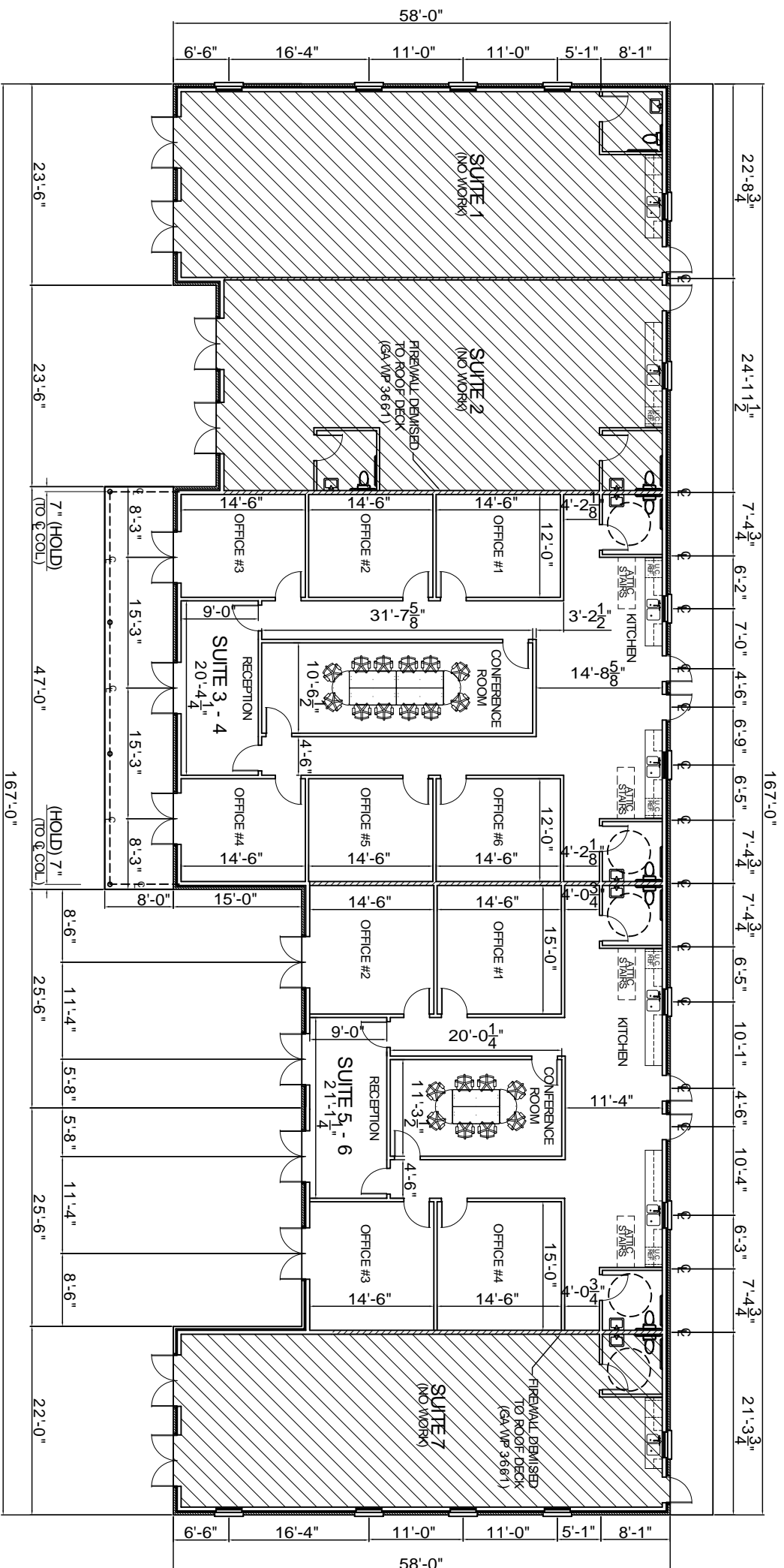

FLOOR PLAN
SCALE: 1/8" = 1'-0"

GA FILE NO. WP 3644 - GENERIC

1 HOUR FIRE

ONE LAYER TYPE X GYPSUM WALLBOARD APPLIED AT RIGHT ANGLES TO EACH OTHER ON 2x4 WOOD STUDS OR WITH 2 LAYERS OF 5/8" THICK TYPE X GYPSUM WALLBOARD INSULATION NOMINAL 5.9 PSI

VERTICAL JOINTS STAGGERED 16" O.C., HORIZONTAL JOINTS STAGGERED 24" O.C. ON OPPOSITE SIDES

TESTED AT 7.578 LBS PER STUD OR 100 PERCENT OF DESIGN LOAD.

THICKNESS: APPROX. WEIGHT: 8.7 PSF

FIRE TEST: ITS 201-061701.1.4-00

GA FILE NO. WP 3661 - GENERIC

1 HOUR FIRE

OVERSHEET WALLBOARD ON WOOD STUDS

MINERAL FIBER INSULATION

ONE LAYER TYPE X GYPSUM WALLBOARD APPLIED AT RIGHT ANGLES TO EACH OTHER ON 2x4 WOOD STUDS 16" O.C. WITH 2 LAYERS OF 5/8" THICK TYPE X GYPSUM WALLBOARD INSULATION NOMINAL 5.9 PSI

VERTICAL JOINTS STAGGERED 16" O.C., HORIZONTAL JOINTS STAGGERED 24" O.C. ON OPPOSITE SIDES

TESTED AT 7.566 LBS PER STUD OR 100 PERCENT OF DESIGN LOAD.

THICKNESS: APPROX. WEIGHT: 8.7 PSF

FIRE TEST: ITS 201-061701.1.4-00

WINDOW SCHEDULE

TYPE	FRAME	GLASS	LINES	ACCESSORIES	REMARKS
WINDOW	FIXED	TINTED	NONE	NONE	
A1 3/0x6/0	HUNG	PLAIN	NONE	NONE	
B1 3/0x3/0	SLIDE	TEMPERED	NONE	NONE	
	ALUMINUM	WIREFRAME	NONE	NONE	
	WOOD				

FINISH SCHEDULE

NAME	FLOOR	BASE	WALLS	CEILING	REMARKS
OFFICES	CARPET		GYPSUM BOARD	CEILING HEIGHT TO CEILING HEIGHT TO	
BATHROOMS	CONCRETE		GYPSUM BOARD	CEILING HEIGHT TO CEILING HEIGHT TO	
OWNER TO SELECT	VCT		2x2 LAY-IN PANELS		
	NONE		GYPSUM BOARD		
	CERAMIC TILE				
	CERAMIC TILE				
	RUBBER WALL BASE				
	WOOD BASE				
	NONE				

- WALL CONSTRUCTION TYPICAL INTERIOR TO BE SIMILAR TO GA WP3644. SEE TYPICAL BUILDING SECTION A-3.

DOOR & HARDWARE SCHEDULE

TYPE	FRAME	HINGE	LOOK	ACCESSORIES	REMARKS
DOOR	SOLID WOOD				
1 PR. 6/0x8/0	HOLLOW METAL				
2 PR. 6/0x8/0	ALUM/GLASS				
3 3/0x6/8	STOREFRONT				
4 3/0x6/8	ROLL UP				
	STEEL				
	ALUMINUM				
	WOOD				
	CASED OPENING				
	DBL SWING				
	BUTT 1-1/2 PR				
	BURGLERPRF				
	FIXED				
	PASSAGE				
	PRIVACY				
	DEADBOLT				
	KEYED HANDLE				
	OFFICE/ENTRANCE				
	PUSH PULL				
	PANIC BAR				
	THRESHOLD				
	WEATHERSTRIP				
	DOOR STOP				
	ALARM				
	SILENCER				
	CLOSER				
	W/ ARCHED TRANSOM ABOVE				
	W/ 16" TRANSOM ABOVE				
	EXTERIOR 18 GA. GALV.				
	INTERIOR 18 GA. PRIMED				

- DOOR & HARDWARE NOTES:**
- ALL GLAZING TO BE LAMINATED SAFETY GLASS.
 - DOOR HINGES TO BE STANLEY FULL MORITSE STANDARD WEIGHT BALL BEARING HINGES. STAINLESS STEEL WITH DARK BRONZE FINISH @ EXTERIOR & MATCHING DARK BRONZE FINISH ON STANDARD STEEL @ INTERIOR.
 - PROVIDE LEVER HANDLE ADA APPROVED LOCKSETS WITH MATCHING DARK BRONZE FINISH. TO BE SELECTED BY OWNER.
 - COORDINATE KEYS SCHEDULE WITH OWNER.
 - DOOR STOPS TO BE EQUAL TO IVES NO. 436 OR 437. AS REQUIRED IN MATCHING DARK BRONZE FINISH.
 - WEATHER-STRIP & THRESHOLD FINISH TO COMPLEMENT OTHER HARDWARE.
 - DOORS MARKED 1 & 2 TO BE EQUAL TO ACADIAN MILLWORK & SUPPLY. MANDEVILLE, LA. SERIES 40000. 1 1/2" THICK WITH WOOD SPECIES TO BE SELECTED BY OWNER.
 - WINDOWS MARKED 'A' TO BE EQUAL TO ACADIAN MILLWORK & SUPPLY. MANDEVILLE, LA. SERIES 43000. 1 3/4" THICK. FIXED WITH WOOD SPECIES SELECTED BY OWNER.

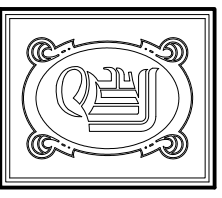

DAMMON ENGINEERING, INC.
 CHIEF ENGINEER
 EMELT DAMMON, P.E.
 CHIEF ARCHITECT
 ROBERT WALTSE

1095 FLORIDA AVENUE
 SUDELL, LA. 70458
 OFFICE: 985-649-5832
 FAX: 985-641-5950

WEBSITE: WWW.DAMMONENGINEERING.COM
 EMAIL: DAMMONER@DELSOUTH.NET

ARCHITECTURE
 ENGINEERING
 STUDIES
 PLANNING
 INVESTIGATION
 EXPERT WITNESS

TENANT BUILDOUT

DEREK DRIVE
 PROPERTY
 1303/1 307 DEREK C
 HAMMOND, LA

PROPOSED FLOOR PLAN

SCALE: AS NOTED

JOB#: DATE: 8-21-08

REV:

A-1

OF