

FILE NAME: J:\Projects\190 Business\190 Business.dwg DATE: 11/11/2021 10:00:00 AM

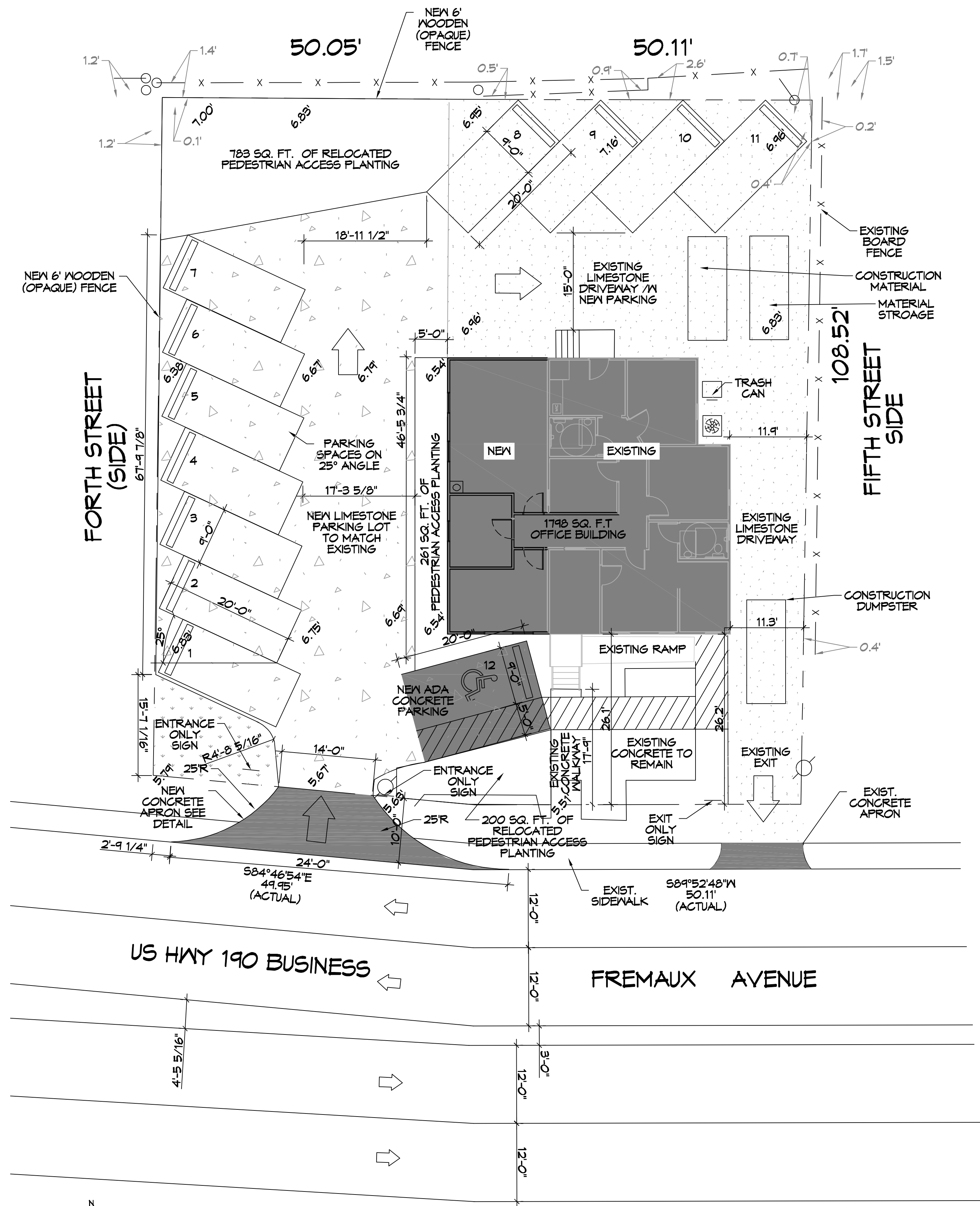

1 SITE PLAN
SCALE: 1" = 10'-0"

PLANNING
ZONED C-2 COMMERCIAL DISTRICT
FLOOD ZONE
ZONE "AE"
BUILDING ELEVATION
BASE FLOOD ELEVATION "AE" = 11.0' FINISHED FLOOR ELEVATION = 8.0'
PARKING
BUSINESS AND PROFESSIONAL OFFICES 1 SPACE FOR EACH 200 SQUARE FEET OF GROSS FLOOR AREA. 1798 / 200 = 9 PARKING REQUIRED = 9 ACTUAL PROVIDED = 12
SITE LIGHTING
EXTERIOR LIGHTING SHALL BE SHADED OR INWARDLY DIRECTED IN SUCH A MANNER SO THAT NO DIRECT LIGHTING OR GLARE BE CAST BEYOND THE PROPERTY LINE. THE INTENSITY OF SUCH LIGHTING SHALL NOT EXCEED ONE FOOT CANDLE AS MEASURED AT THE ADJACENT PROPERTY LINE.

GENERAL PAVING NOTES

CONCRETE MIX DESIGN
MIX FOR ONE CUBIC YARD OF FIBER-REINFORCED CONCRETE

28 DAY STRENGTH	4000 PSI
CEMENT (ASTM C-150, TYPE I/II)	4.64 SACKS (436 LBS.)
FLY ASH (ASTM C-618)	1.16 SACKS (109 LBS.)
GRAVEL (ASTM C-33, GRADE A)	1775 LBS.
SAND (ASTM C-33)	1226 LBS.
WATER (POTABLE)	30 GALLONS (250 LBS.) TYPE A
WATER REDUCER (ASTM C-494)	16.95 LBS.
AIR ENTRAINMENT	5% BY VOLUME, USE PER MANUFACTURER'S SPECS.
FIBER REINFORCEMENT	1.5 LBS/CY MICROFIBERS, AS SPECIFIED BELOW

FIBER REINFORCEMENT FOR CONCRETE DRIVEWAY SHALL BE MATRIX MONOFILAMENT MICROFIBER AS MANUFACTURED BY FRG INDUSTRIES OR APPROVED EQUAL, APPLIED THROUGHOUT THE CONCRETE MIXTURE. ALTERNATE PRODUCTS MUST BE PREAPPROVED BY THE CITY ENGINEER IN WRITING. CELLULOSE (TREATED OR UNTREATED), AR GLASS, NYLON AND POLYESTER FIBERS ARE SPECIFICALLY PROHIBITED FROM USE.

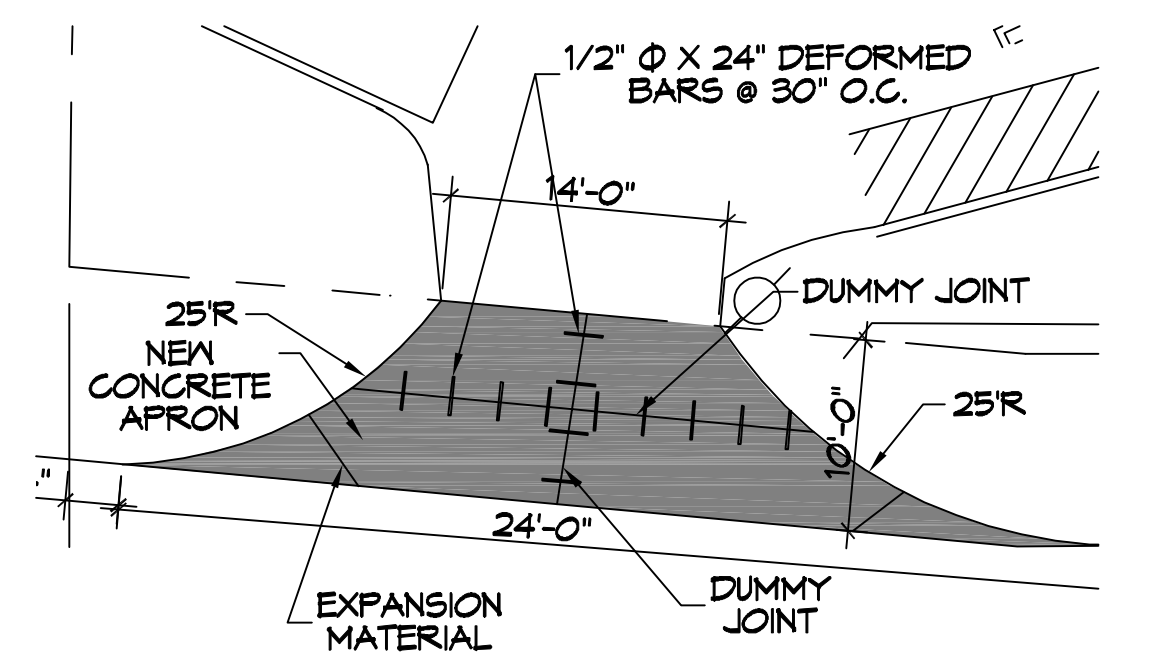

2 PAVING PLAN
SCALE: 1" = 10'-0"

DAMMON ENGINEERING, INC.
LOUISIANA & MISSISSIPPI

Chief Engineer: Brian Mistich, PE
554 Old Spanish Trail
Slidell, LA 70458
www.dammonengineering.com
info@dammonengineering.com
PH: 985.449.9832

#	DESCRIPTION	DATE
1		



FLEUR DE LIS COMPANY
442 FREMAUX AVE
SLIDELL, LA 70458

JOB No: DATE: 12-20-2021
DRAWN BY: BAW
CHECKED BY: C&D

SHEET TITLE:
SITE PLAN

DRAWING NUMBER:
C101

SHEET No: 2 of 1