

KEY MAP  
N.T.S.

**LEGEND - STRIPING**

- SWSL/4" - SINGLE WHITE SOLID LINE / 4" WIDE
- DYSL/4" - DOUBLE YELLOW SOLID LINE / 4" WIDE EACH
- YSYL/4" - SINGLE YELLOW SOLID LINE / 4" WIDE
- SWDL/4" - SINGLE WHITE DASHED LINE / 4" WIDE
- SBSL/4" - SINGLE BLUE SOLID LINE / 4" WIDE
- SWSL/24" - SINGLE WHITE SOLID LINE / 24" WIDE
- SWSL/8" - SINGLE WHITE SOLID LINE / 8" WIDE

**EXISTING LEGEND**

- FOUND PROPERTY CORNER (AS NOTED) ●
- SET 3/4" IRON ROD ○
- EXISTING POWER POLE ○
- EXISTING POWER POLE WITH LIGHT ○
- EXISTING PARKING LOT LIGHT ○
- EXISTING GUY ANCHOR ○
- EXISTING TELEPHONE PEDESTAL □
- EXISTING OVERHEAD POWER LINE —○—
- EXISTING GAS METER GM□
- EXISTING GAS VALVE ○GV
- EXISTING BARB WIRE FENCE LINE —X—
- EXISTING WIRE MESH FENCE LINE —○—
- EXISTING HIGH DENSITY POLYETHYLENE PIPE 12" HDPE ○
- EXISTING PIPE BOLLARD ○
- EXISTING MAILBOX □
- ELEVATION OF TOP OF STRUCTURE TOP = 18.00
- ELEVATION OF BOTTOM OF STRUCTURE INV. = 15.00
- EXISTING SPOT ELEVATION .
- ELEVATION OF TOP OF CURB 18.50 TC
- ELEVATION OF FACE OF CURB 18.00 FC
- EXISTING SEWER MANHOLE C.O.
- EXISTING SEWER CLEANOUT ○
- EXISTING DRAINAGE MANHOLE ○
- EXISTING SUBSURFACE DRAINAGE —
- EXISTING CATCH BASIN/DROP INLET □
- EXISTING FIRE HYDRANT ○
- EXISTING WATER METER WM○
- EXISTING WATER VALVE ○WV
- EXISTING WATER LINE —W—
- EXISTING REINFORCED CONCRETE PIPE 18" RCP
- EXISTING CORRUGATED METAL PIPE 24" CMP

**LEGEND - NEW IMPROVEMENTS**

- BUILDING [Symbol]
- CONCRETE CURB AND GUTTER [Symbol]
- PARKING SPACES [Symbol]
- ADA RAMP [Symbol]
- HEAVY DUTY ASPHALT OR CONCRETE [Symbol]
- STANDARD DUTY PAVEMENT [Symbol]
- SITE LIGHTING POLES [Symbol]
- FIRE HYDRANT [Symbol]
- WATER VALVE [Symbol]
- DOWN SPOUT [Symbol]
- DIRECTIONAL ARROWS [Symbol]
- FLUME [Symbol]
- GARAGES [Symbol]
- SIDEWALK [Symbol]
- DECORATIVE FENCE [Symbol]
- CHAINLINK FENCE [Symbol]
- COMMUNICATIONS BOX [Symbol]
- ELECTRIC BOX [Symbol]
- TREE TO REMAIN [Symbol]
- ACCESSIBLE STRIPED ISLAND [Symbol]

AREA ANALYSIS	
MULTIFAMILY TRACT	3.49 ACRES
DRAINAGE SERVITUDE	16.51 ACRES
<b>TOTAL</b>	<b>20.00 ACRES</b>

SITE ANALYSIS	
■ OF UNITS	296 UNITS
PARKING	533 SPACES
<b>RATIO</b>	<b>1.80/UNIT</b>

\* PARKING REQ = 2.0 SPACES PER UNIT  
 \*\* PARKING VARIANCE HAS BEEN APPROVED FOR THE PROPOSED PARKING RATIO.

# OVERALL SITE PLAN

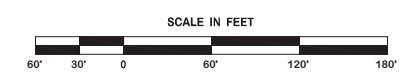

REVISION	BY
7-24-14 ADDENDUM 1	SMT

**DDG**  
 DUPLANTIS DESIGN GROUP, PC  
 CIVIL ENGINEERING - ARCHITECTURE  
 54 LOUIS PRIMA DRIVE COVINGTON, LA 70435  
 WWW.DDGPC.COM PHONE: 985-496-8600 FAX: 985-496-8690  
 THIBODAUX | COVINGTON | HOUSTON | BATON ROUGE | HOUMA

PROGRESS SET - FOR REVIEW ONLY  
 Issued 07/24/14  
 These documents are for Design Review and not intended for Construction, Bidding, Recordation, Construction, or any other use without the express written consent of Duplantis Design Group, PC.  
 They were prepared by, or under the supervision of:  
 Douglas E. Barilleaux, P.E. #34541  
 Duplantis Design Group, PC

SPRINGS AT FREMAUX TOWN CENTER  
 SLIDELL, LOUISIANA  
 ST. TAMMANY PARISH  
 FOR CONTINENTAL 294 FUND LLC  
 MEMONIEE FALLS, WI

DRAWN DGS
CHECKED DEB
ISSUED DATE 7/24/14
ISSUED FOR PERMITTING
PROJECT NO. 14-248
FILE 14-248 C-3 SITE

SHEET  
**C-3.0**

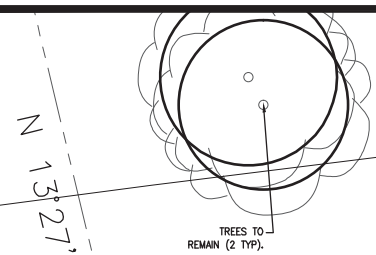

N 13°27'00" W - 202.32'

3" Live Oak

SERVITUDE AREA  
IN FAVOR OF TRACT 2D-2-B  
NOT TO BE DEVELOPED  
3.489 ACRES  
151,980 SQ. FT.

DEDICATED DRAINAGE  
SERVITUDE IN FAVOR OF  
MULTIFAMILY PROPERTY  
3.49 ACRES

WATER QUALITY POND

S 00°00'00" W - 335.27'

S 00°00'00" F - 196.76'

N 00°00'00" F - 196.76'

N 00°00'00" W - 335.27'

MATCHLINE (SEE SHEET C-3.3)

N 24°33'14" W - 205.17'

N 20°59'46" W  
18.51'

N 68°30'25" E - 310.42'

N 20°59'46" W  
24.00'

MATCHLINE 2 (SEE SHEET C-3.2)

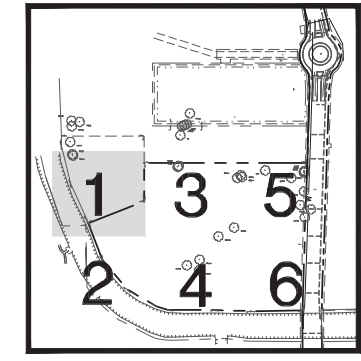

KEY MAP  
N.T.S.

LEGEND - STRIPING

- SWSL/4" - SINGLE WHITE SOLID LINE / 4" WIDE
- DYSL/4" - DOUBLE YELLOW SOLID LINE / 4" WIDE EACH
- YSL/4" - SINGLE YELLOW SOLID LINE / 4" WIDE
- SWDL/4" - SINGLE WHITE DASHED LINE / 4" WIDE
- SSSL/4" - SINGLE BLUE SOLID LINE / 4" WIDE
- SWSL/24" - SINGLE WHITE SOLID LINE / 24" WIDE
- SWSL/8" - SINGLE WHITE SOLID LINE / 8" WIDE

EXISTING LEGEND

- FOUND PROPERTY CORNER (AS NOTED)
- SET 3/4" IRON ROD
- EXISTING POWER POLE
- EXISTING POWER POLE WITH LIGHT
- EXISTING PARKING LOT LIGHT
- EXISTING GUY ANCHOR
- EXISTING TELEPHONE PEDESTAL
- EXISTING OVERHEAD POWER LINE
- EXISTING GAS METER
- EXISTING GAS VALVE
- EXISTING BARB WIRE FENCE LINE
- EXISTING WIRE MESH FENCE LINE
- EXISTING HIGH DENSITY POLYETHYLENE PIPE 12" HDPE
- EXISTING PIPE BOLLARD
- EXISTING MAILBOX
- ELEVATION OF TOP OF STRUCTURE TOP = 18.00
- ELEVATION OF BOTTOM OF STRUCTURE INV. = 15.00
- EXISTING SPOT ELEVATION
- ELEVATION OF TOP OF CURB 18.50 TC
- ELEVATION OF FACE OF CURB 18.00 FC
- EXISTING SEWER MANHOLE
- EXISTING SEWER CLEANOUT
- EXISTING DRAINAGE MANHOLE
- EXISTING SUBSURFACE DRAINAGE
- EXISTING CATCH BASIN/DROP INLET
- EXISTING FIRE HYDRANT
- EXISTING WATER METER
- EXISTING WATER VALVE
- EXISTING WATER LINE
- EXISTING REINFORCED CONCRETE PIPE 18" RCP
- EXISTING CORRUGATED METAL PIPE 24" CMP

NOTE:

1. SEE SHEETS C-3.0 FOR OVERALL SITE PLAN.
2. SEE SHEETS C-4.0-C-4.6 FOR GRADING PLANS.
3. SEE SHEETS C-6.1-C-6.2 FOR UTILITY PLANS.
4. SEE SHEETS C-8.1-C-8.2 FOR EROSION CONTROL PLANS.
5. SEE SHEETS C-1 FOR GENERAL NOTES.
6. SEE SHEETS D-1-D-6 FOR DETAILS.
7. SEE SHEETS C-2 FOR BUILDING DIMENSIONAL CONTROL PLAN.



LEGEND - NEW IMPROVEMENTS

- BUILDING
- CONCRETE CURB AND GUTTER
- PARKING SPACES
- ADA RAMP
- HEAVY DUTY ASPHALT OR CONCRETE
- STANDARD DUTY PAVEMENT
- SITE LIGHTING POLES
- FIRE HYDRANT
- WATER VALVE
- DOWN SPOUT
- DIRECTIONAL ARROWS
- FLUME
- GARAGES
- SIDEWALK
- DECORATIVE FENCE
- CHAINLINK FENCE
- COMMUNICATIONS BOX
- ELECTRIC BOX
- TREE TO REMAIN

SITE PLAN  
SECTION 1

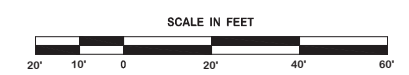

REVISION	BY
7-24-14 ADDENDUM 1	SMT

**DDG**  
DUPLANTIS DESIGN GROUP, PC  
CIVIL ENGINEERING - ARCHITECTURE  
54 LOUIS PRIMA DRIVE COVINGTON, LA 70433  
WWW.DDGPC.COM PHONE: 985-498-6160 FAX: 985-498-6190  
THIBODAUX | COVINGTON | HOUSTON | BATON ROUGE | HOUMA

PROGRESS SET - FOR REVIEW ONLY  
Issued 07/24/14  
These documents are for Design Review and not intended for Construction, Bidding, Recordation, Conveyance, or any other use without the express written consent of the Designer. They were prepared by, or under the supervision of:  
Douglas E. Barilleaux, P.E. #44541  
Duplantis Design Group, PC

SPRINGS AT FREMAUX TOWN CENTER  
SLIDELL, LOUISIANA  
ST. TAMMANY PARISH  
FOR CONTINENTAL 294 FUND LLC  
MEMONIEE FALLS, WI

DRAWN DGS  
CHECKED DEB  
ISSUED DATE 7/24/14  
ISSUED FOR PERMITTING  
PROJECT NO. 14-248  
FILE 14-248 C-3 SITE  
SHEET C-3.1

Slidell Youth Football Assoc. Inc.  
 Now or Formerly  
 Inst. # 363769

MATCHLINE (SEE SHEET C-3.1)

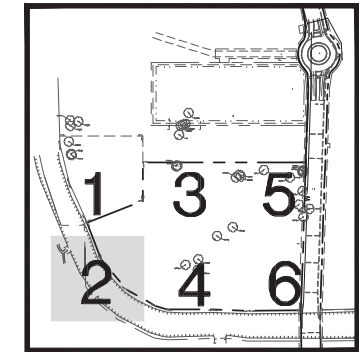
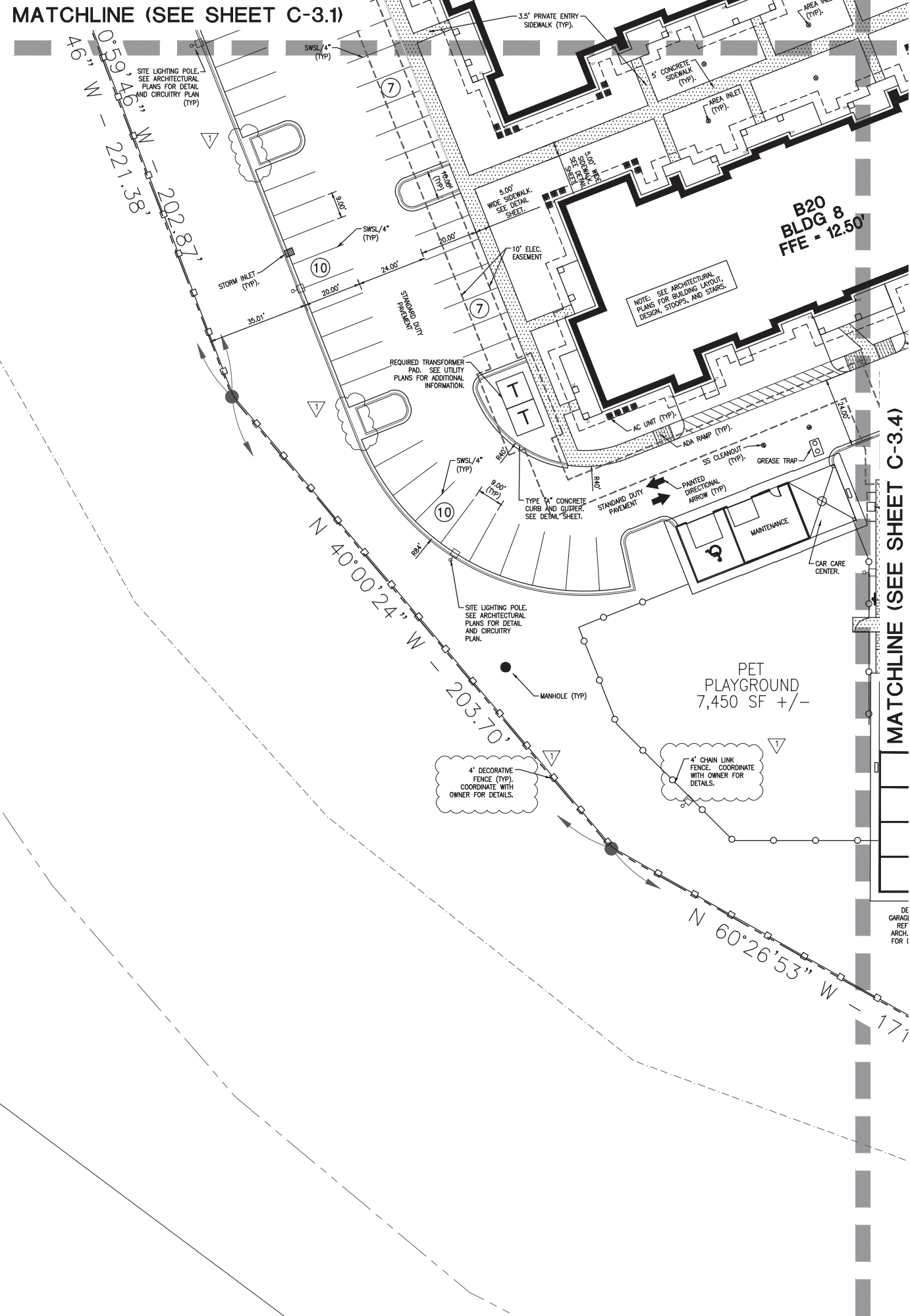

**LEGEND - STRIPING**

SWSL/4" - SINGLE WHITE SOLID LINE / 4" WIDE  
 DYSL/4" - DOUBLE YELLOW SOLID LINE / 4" WIDE EACH  
 SYSL/4" - SINGLE YELLOW SOLID LINE / 4" WIDE  
 SWDL/4" - SINGLE WHITE DASHED LINE / 4" WIDE  
 SBLSL/4" - SINGLE BLUE SOLID LINE / 4" WIDE  
 SWSL/24" - SINGLE WHITE SOLID LINE / 24" WIDE  
 SWSL/8" - SINGLE WHITE SOLID LINE / 8" WIDE

**EXISTING LEGEND**

FOUND PROPERTY CORNER (AS NOTED) ●  
 SET 3/4" IRON ROD ○  
 EXISTING POWER POLE ○  
 EXISTING POWER POLE WITH LIGHT ○  
 EXISTING PARKING LOT LIGHT ○  
 EXISTING GUY ANCHOR ○  
 EXISTING TELEPHONE PEDESTAL ○  
 EXISTING OVERHEAD POWER LINE —○—  
 EXISTING GAS METER ○  
 EXISTING GAS VALVE ○  
 EXISTING BARB WIRE FENCE LINE —X—  
 EXISTING WIRE MESH FENCE LINE —○—  
 EXISTING HIGH DENSITY POLYETHYLENE PIPE 12" HDPE ○  
 EXISTING PIPE BOLLARD ○  
 EXISTING MAILBOX ○  
 ELEVATION OF TOP OF STRUCTURE TOP = 18.00  
 ELEVATION OF BOTTOM OF STRUCTURE INV. = 15.00  
 EXISTING SPOT ELEVATION .  
 ELEVATION OF TOP OF CURB 18.50 TC  
 ELEVATION OF FACE OF CURB 18.00 FC  
 EXISTING SEWER MANHOLE ○  
 EXISTING SEWER CLEANOUT ○  
 EXISTING DRAINAGE MANHOLE ○  
 EXISTING SUBSURFACE DRAINAGE ○  
 EXISTING CATCH BASIN/DROP INLET ○  
 EXISTING FIRE HYDRANT ○  
 EXISTING WATER METER ○  
 EXISTING WATER VALVE ○  
 EXISTING WATER LINE —W—  
 EXISTING REINFORCED CONCRETE PIPE 18" RCP  
 EXISTING CORRUGATED METAL PIPE 24" CMP

**NOTE:**

- SEE SHEETS C-3.0 FOR OVERALL SITE PLAN.
- SEE SHEETS C-4.0-C-4.6 FOR GRADING PLANS.
- SEE SHEETS C-6.1-C-6.2 FOR UTILITY PLANS.
- SEE SHEETS C-8.1-C-8.2 FOR EROSION CONTROL PLANS.
- SEE SHEETS C-1 FOR GENERAL NOTES.
- SEE SHEETS D-1-D-6 FOR DETAILS.
- SEE SHEETS C-2 FOR BUILDING DIMENSIONAL CONTROL PLAN.

**LEGEND - NEW IMPROVEMENTS**

DE GARAGE REF ARCH. FOR 1  
 BUILDING  
 CONCRETE CURB AND GUTTER  
 PARKING SPACES  
 ADA RAMP  
 HEAVY DUTY ASPHALT OR CONCRETE  
 STANDARD DUTY PAVEMENT  
 SITE LIGHTING POLES  
 FIRE HYDRANT  
 WATER VALVE  
 DOWN SPOUT

DIRECTIONAL ARROWS  
 FLUME  
 GARAGES  
 SIDEWALK  
 DECORATIVE FENCE  
 CHAINLINK FENCE  
 COMMUNICATIONS BOX  
 ELECTRIC BOX  
 TREE TO REMAIN

**SITE PLAN SECTION 2**

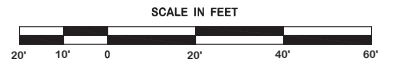

MATCHLINE (SEE SHEET C-3.4)

REVISION	BY
7-24-14 ADDENDUM 1	SMT

**DDG**  
 DUPLANTIS DESIGN GROUP, PC  
 CIVIL ENGINEERING - ARCHITECTURE  
 54 LOUISIANA DRIVE COVINGTON, LA 70433  
 WWW.DDGPC.COM PHONE: 985-496-8100 FAX: 985-496-9190  
 THIBODAUX | COVINGTON | HOUSTON | BATON ROUGE | HOUMA

PROGRESS SET - FOR REVIEW ONLY  
 Issued 07/24/14  
 These documents are for Design Review and not intended for Construction, Bidding, Recordation, Conveyance, or any other use without the express written consent of the Designer. They were prepared by, or under the supervision of:  
 Douglas E. Bartheleaux, P.E. #34541  
 Duplantis Design Group, PC

SPRINGS AT FREMAUX TOWN CENTER  
 SLIDELL, LOUISIANA  
 ST. TAMMANY PARISH  
 FOR CONTINENTAL 294 FUND LLC  
 MEMONIEE FALLS, WI

DRAWN DGS
CHECKED DEB
ISSUED DATE 7/24/14
ISSUED FOR PERMITTING
PROJECT NO. 14-248
FILE 14-248 C-3 SITE
SHEET <b>C-3.2</b>

REVISION	BY
7-24-14 ADDENDUM 1	SMT

**DDG**  
DUPLANTS DESIGN GROUP, PC  
CIVIL ENGINEERING - ARCHITECTURE  
54 LOUISIANA DRIVE COVINGTON, LA 70435  
WWW.DDGPC.COM  
PHONE: 985-496-9850 FAX: 985-496-9850  
THIBODAUX | COVINGTON | HOUSTON | BATON ROUGE | HOUMA

PROGRESS SET - FOR REVIEW ONLY  
Issued 07/24/14  
These documents are for Design Review and not intended for Construction, Bidding, Recordation, Conveyance, or any other use without the express written consent of the Designer. They were prepared by, or under the supervision of:  
Douglas E. Barilleaux, P.E. #434541  
Duplants Design Group, PC

**SPRINGS AT FREMAUX TOWN CENTER**  
SLIDELL, LOUISIANA  
ST. TAMMANY PARISH  
FOR CONTINENTAL 294 FUND LLC  
MEMPHIS FALLS, WI

DRAWN DGS  
CHECKED DEB  
ISSUED DATE 7/24/14  
ISSUED FOR PERMITTING  
PROJECT NO. 14-248  
FILE 14-248 C-3 SITE  
SHEET **C-3.3**

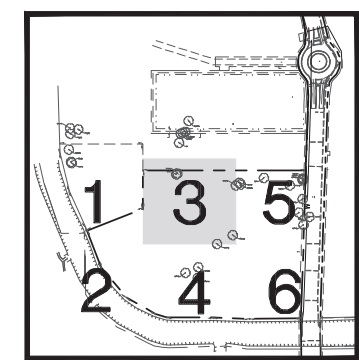

KEY MAP  
N.T.S.

**LEGEND - STRIPING**

- SWSL/4" - SINGLE WHITE SOLID LINE / 4" WIDE
- DYSL/4" - DOUBLE YELLOW SOLID LINE / 4" WIDE EACH
- YSL/4" - SINGLE YELLOW SOLID LINE / 4" WIDE
- SWDL/4" - SINGLE WHITE DASHED LINE / 4" WIDE
- SSSL/4" - SINGLE BLUE SOLID LINE / 4" WIDE
- SWSL/24" - SINGLE WHITE SOLID LINE / 24" WIDE
- SWSL/8" - SINGLE WHITE SOLID LINE / 8" WIDE

**EXISTING LEGEND**

- FOUND PROPERTY CORNER (AS NOTED)
- SET 3/4" IRON ROD
- EXISTING POWER POLE
- EXISTING POWER POLE WITH LIGHT
- EXISTING PARKING LOT LIGHT
- EXISTING GUY ANCHOR
- EXISTING TELEPHONE PEDESTAL
- EXISTING OVERHEAD POWER LINE
- EXISTING GAS METER
- EXISTING GAS VALVE
- EXISTING BARR WIRE FENCE LINE
- EXISTING WIRE MESH FENCE LINE
- EXISTING HIGH DENSITY POLYETHYLENE PIPE 12" HDPE
- EXISTING PIPE BOLLARD
- EXISTING MAILBOX
- ELEVATION OF TOP OF STRUCTURE TOP = 18.00
- ELEVATION OF BOTTOM OF STRUCTURE INV. = 15.00
- EXISTING SPOT ELEVATION
- ELEVATION OF TOP OF CURB 18.50 TC
- ELEVATION OF FACE OF CURB 18.00 FC
- EXISTING SEWER MANHOLE C.O.
- EXISTING SEWER CLEANOUT
- EXISTING DRAINAGE MANHOLE
- EXISTING SUBSURFACE DRAINAGE
- EXISTING CATCH BASIN/DROP INLET
- EXISTING FIRE HYDRANT
- EXISTING WATER METER
- EXISTING WATER VALVE
- EXISTING WATER LINE
- EXISTING REINFORCED CONCRETE PIPE 18" RCP
- EXISTING CORRUGATED METAL PIPE 24" CMP

**NOTE:**

1. SEE SHEETS C-3.0 FOR OVERALL SITE PLAN.
2. SEE SHEETS C-4.0-C-4.6 FOR GRADING PLANS.
3. SEE SHEETS C-6.1-C-6.2 FOR UTILITY PLANS.
4. SEE SHEETS C-8.1-C-8.2 FOR EROSION CONTROL PLANS.
5. SEE SHEETS C-1 FOR GENERAL NOTES.
6. SEE SHEETS D-1-D-6 FOR DETAILS.
7. SEE SHEETS C-2 FOR BUILDING DIMENSIONAL CONTROL PLAN.



**LEGEND - NEW IMPROVEMENTS**

- BUILDING
- CONCRETE CURB AND GUTTER
- PARKING SPACES
- ADA RAMP
- HEAVY DUTY ASPHALT OR CONCRETE
- STANDARD DUTY PAVEMENT
- SITE LIGHTING POLES
- FIRE HYDRANT
- WATER VALVE
- DOWN SPOUT
- ACCESSIBLE STRIPED ISLAND
- DIRECTIONAL ARROWS
- FLUME
- GARAGES
- SIDEWALK
- DECORATIVE FENCE
- CHAINLINK FENCE
- COMMUNICATIONS BOX
- ELECTRIC BOX
- TREE TO REMAIN

**SITE PLAN SECTION 3**

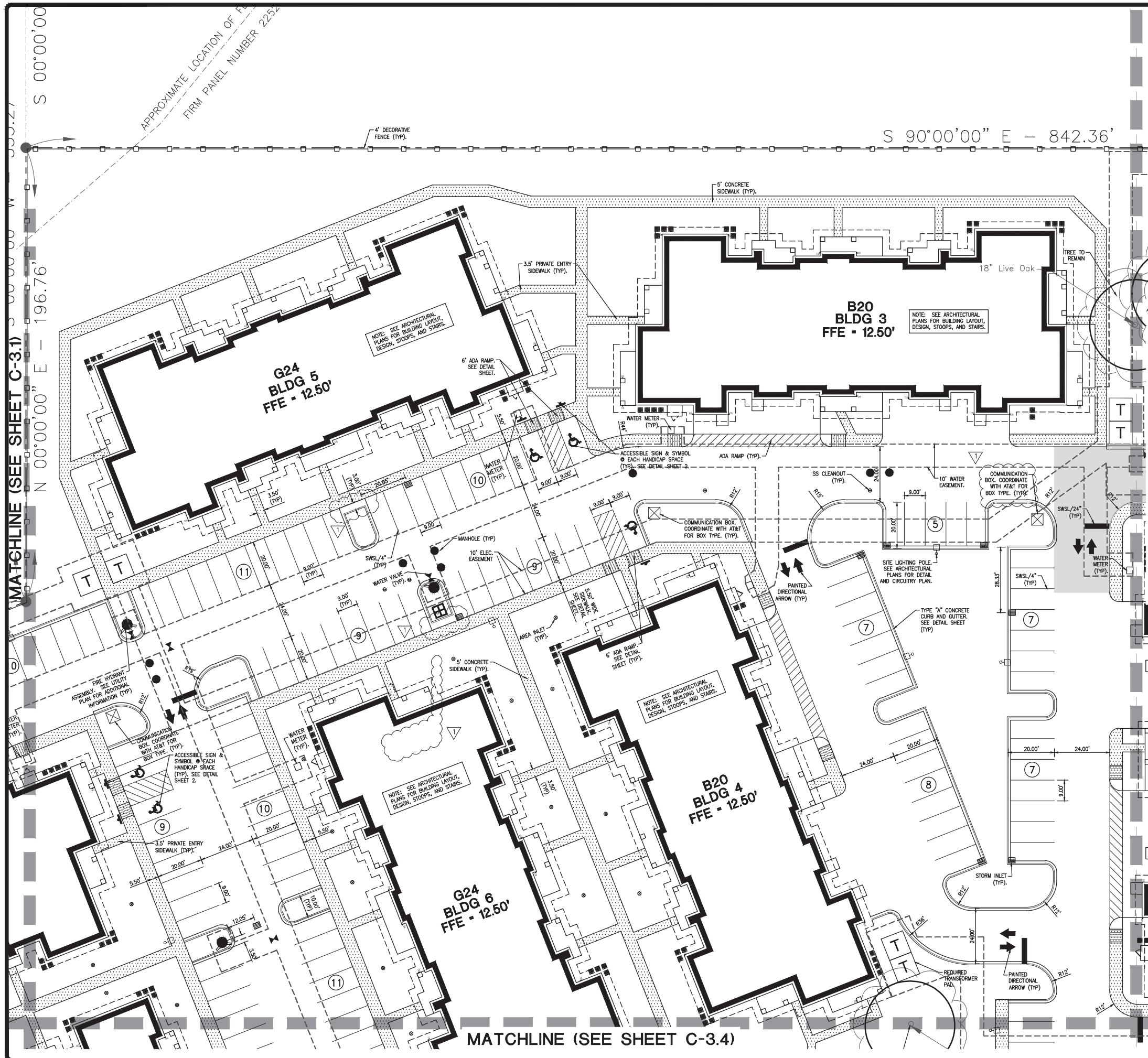
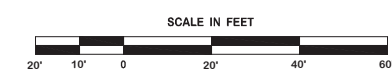

MATCHLINE (SEE SHEET C-3.1)

MATCHLINE (SEE SHEET C-3.5)

MATCHLINE (SEE SHEET C-3.4)

N 00°00'00" E - 196.76'

S 90°00'00" E - 842.36'

APPROXIMATE LOCATION OF FIRM PANEL NUMBER 2252

G24 BLDG 5  
FFE = 12.50'

B20 BLDG 3  
FFE = 12.50'

B20 BLDG 4  
FFE = 12.50'

G24 BLDG 6  
FFE = 12.50'

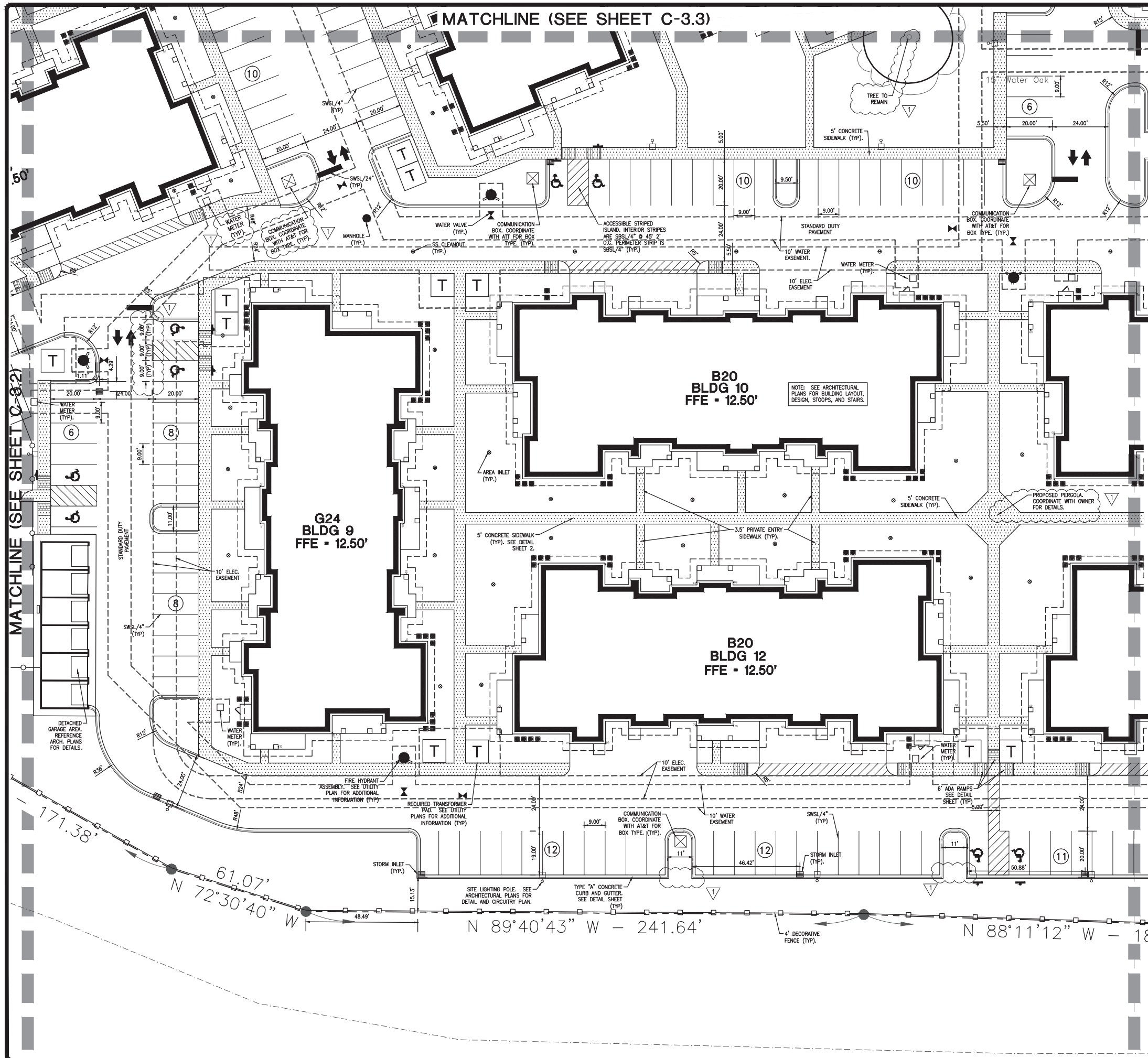

REVISION	BY
7-24-14 ADDENDUM 1	SMT

**DDG**  
DUPLANTS DESIGN GROUP, PC  
CIVIL ENGINEERING - ARCHITECTURE  
34 LOUISIANA DRIVE COVINGTON, LA 70433  
WWW.DDGPC.COM  
PHONE: 985-496-9500 FAX: 985-496-9590  
THIBODAUX | COVINGTON | HOUSTON | BATON ROUGE | HOUMA

**PROGRESS SET - FOR REVIEW ONLY**  
Issued 07/24/14  
These documents are for Design Review and not intended for Construction, Bidding, Recordation, Construction, or under the supervision of. They were prepared by, or under the supervision of:  
Douglas E. Barilleaux, P.E. #434541  
Duplants Design Group, PC

**SPRINGS AT FREMAUX TOWN CENTER**  
SLIDELL, LOUISIANA  
ST. TAMMANY PARISH  
FOR CONTINENTAL 294 FUND LLC  
MENOMONEE FALLS, WI

**DRAWN** DGS  
**CHECKED** DEB  
**ISSUED DATE** 7/24/14  
**ISSUED FOR** PERMITTING  
**PROJECT NO.** 14-248  
**FILE** 14-248 C-3 SITE  
**SHEET** C-3.4



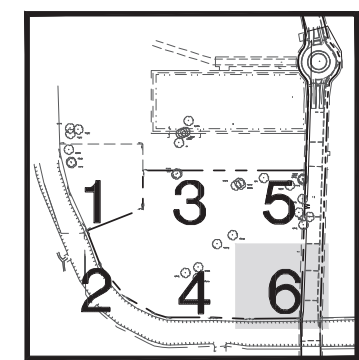
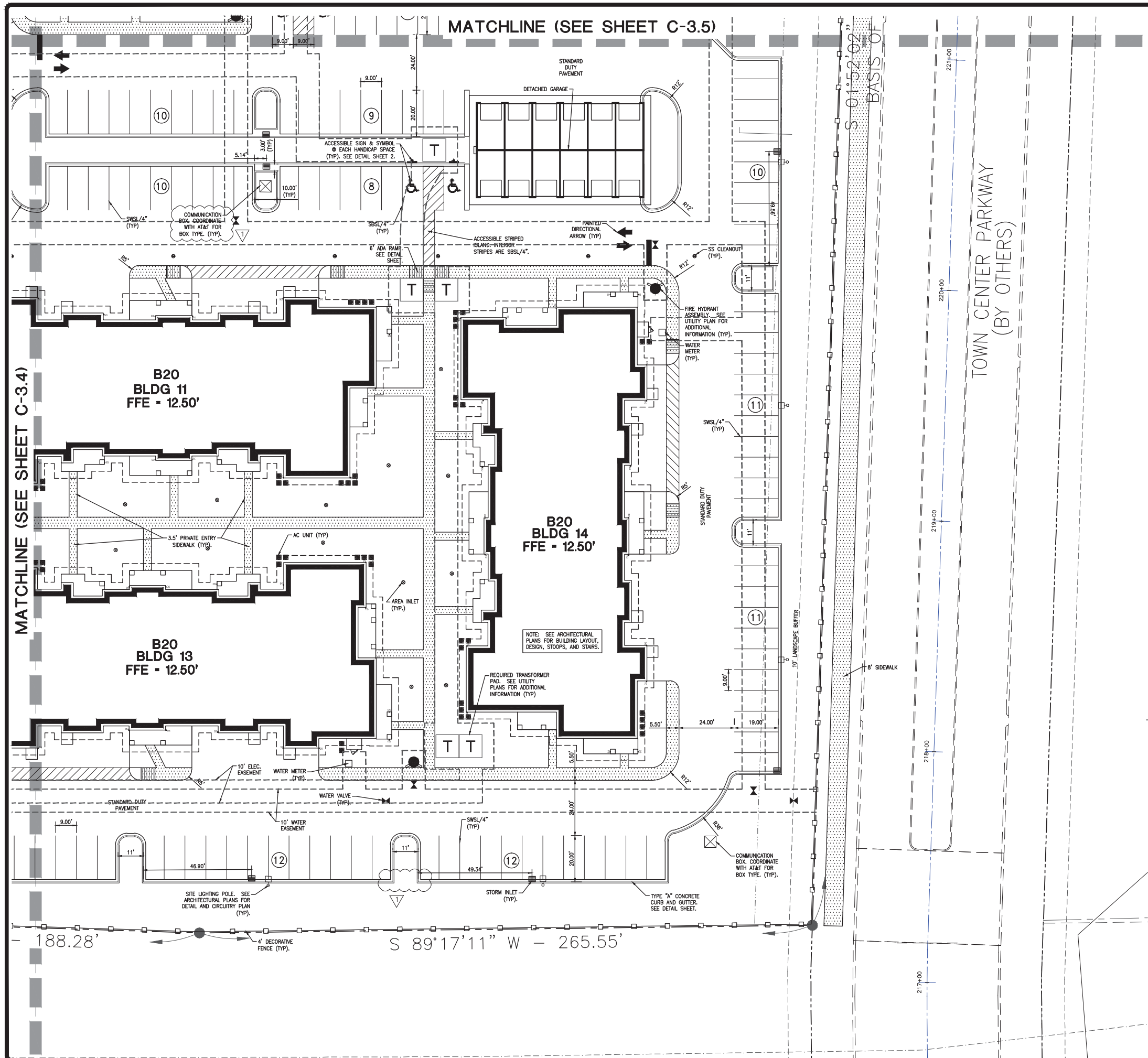

- LEGEND - STRIPING**
- SWSL/4" - SINGLE WHITE SOLID LINE / 4" WIDE
  - DYSL/4" - DOUBLE YELLOW SOLID LINE / 4" WIDE EACH
  - YSL/4" - SINGLE YELLOW SOLID LINE / 4" WIDE
  - SWDL/4" - SINGLE WHITE DASHED LINE / 4" WIDE
  - SBSL/4" - SINGLE BLUE SOLID LINE / 4" WIDE
  - SWSL/24" - SINGLE WHITE SOLID LINE / 24" WIDE
  - SWSL/8" - SINGLE WHITE SOLID LINE / 8" WIDE

- EXISTING LEGEND**
- FOUND PROPERTY CORNER (AS NOTED) ○
  - SET 3/4" IRON ROD ●
  - EXISTING POWER POLE ⊗
  - EXISTING POWER POLE WITH LIGHT ⊗
  - EXISTING PARKING LOT LIGHT ⊗
  - EXISTING GUY ANCHOR ⊗
  - EXISTING TELEPHONE PEDESTAL ⊗
  - EXISTING OVERHEAD POWER LINE —○—
  - EXISTING GAS METER GM □
  - EXISTING GAS VALVE ⊗GV
  - EXISTING BARB WIRE FENCE LINE —X—
  - EXISTING WIRE MESH FENCE LINE —○—
  - EXISTING HIGH DENSITY POLYETHYLENE PIPE 12" HDPE —|—
  - EXISTING PIPE BOLLARD —|—
  - EXISTING MAILBOX —|—
  - ELEVATION OF TOP OF STRUCTURE TOP = 18.00
  - ELEVATION OF BOTTOM OF STRUCTURE INV. = 15.00
  - EXISTING SPOT ELEVATION .
  - ELEVATION OF TOP OF CURB 18.50 TC
  - ELEVATION OF FACE OF CURB 18.00 FC
  - EXISTING SEWER MANHOLE ⊗
  - EXISTING SEWER CLEANOUT ⊗
  - EXISTING DRAINAGE MANHOLE ⊗
  - EXISTING SUBSURFACE DRAINAGE —|—
  - EXISTING CATCH BASIN/DROP INLET ⊗
  - EXISTING FIRE HYDRANT ⊗
  - EXISTING WATER METER ⊗WM
  - EXISTING WATER VALVE ⊗WV
  - EXISTING WATER LINE —W—
  - EXISTING REINFORCED CONCRETE PIPE 18" RCP —|—
  - EXISTING CORRUGATED METAL PIPE 24" CMP —|—

- NOTE:**
1. SEE SHEETS C-3.0 FOR OVERALL SITE PLAN.
  2. SEE SHEETS C-4.0-C-4.6 FOR GRADING PLANS.
  3. SEE SHEETS C-6.1-C-6.2 FOR UTILITY PLANS.
  4. SEE SHEETS C-8.1-C-8.2 FOR EROSION CONTROL PLANS.
  5. SEE SHEETS C-1 FOR GENERAL NOTES.
  6. SEE SHEETS D-1-D-6 FOR DETAILS.
  7. SEE SHEETS C-2 FOR BUILDING DIMENSIONAL CONTROL PLAN.



- LEGEND - NEW IMPROVEMENTS**
- BUILDING [Symbol]
  - CONCRETE CURB AND GUTTER [Symbol]
  - PARKING SPACES [Symbol]
  - ADA RAMP [Symbol]
  - HEAVY DUTY ASPHALT OR CONCRETE [Symbol]
  - STANDARD DUTY PAVEMENT [Symbol]
  - SITE LIGHTING POLES [Symbol]
  - FIRE HYDRANT [Symbol]
  - WATER VALVE [Symbol]
  - DOWN SPOUT [Symbol]
  - DIRECTIONAL ARROWS [Symbol]
  - FLUME [Symbol]
  - GARAGES [Symbol]
  - SIDEWALK [Symbol]
  - DECORATIVE FENCE [Symbol]
  - CHAINLINK FENCE [Symbol]
  - COMMUNICATIONS BOX [Symbol]
  - ELECTRIC BOX [Symbol]
  - TREE TO REMAIN [Symbol]

**SITE PLAN  
SECTION 6**

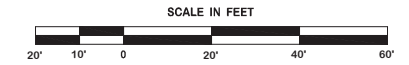

REVISION	BY
7-24-14 ADDENDUM 1	SMT

**DDG**  
DUPLANTIS DESIGN GROUP, PC  
CIVIL ENGINEERING - ARCHITECTURE  
54 LOUISIANA DRIVE COVINGTON, LA 70435  
WWW.DDGPC.COM PHONE: 985.496.6100 FAX: 985.496.6190  
THIBODAUX | COVINGTON | HOUSTON | BATON ROUGE | HOUMA

PROGRESS SET - FOR REVIEW ONLY  
Issued 07/24/14

These documents are for Design Review and not intended for Construction, Bidding, Recordation, Conveyance, or any other use without the express written consent of the Designer. They were prepared by, or under the supervision of:  
Douglas E. Barzilleaux, P.E. #34541  
Duplantis Design Group, PC

SPRINGS AT FREMAUX TOWN CENTER  
SLIDELL, LOUISIANA  
ST. TAMMANY PARISH  
FOR CONTINENTAL 294 FUND LLC  
MENOMONEE FALLS, WI

DRAWN DGS  
CHECKED DEB  
ISSUED DATE 7/24/14  
ISSUED FOR PERMITTING  
PROJECT NO. 14-248  
FILE 14-248 C-3 SITE

SHEET  
**C-3.6**

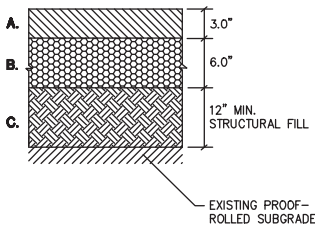

**A.** 3.0" (2-1/2" LIFTS) OF TYPE 3 ASPHALTIC CONCRETE WEARING COURSE WITH INCIDENTAL PAVING PG 64-22 LIQUID ASPHALT (AGGREGATE 3/4" TO 3/8" MIX) IN ACCORDANCE WITH THE LOUISIANA DEPARTMENT OF TRANSPORTATION & DEVELOPMENT (LADOT) STANDARD SPECIFICATIONS FOR ROADS & BRIDGES, SECTION 501 OF THE 2000 EDITION.

**B.** 6.0" OF COMPACTED 610 LIMESTONE BASE. THE CRUSHED LIMESTONE BASE SHALL MEET THE REQUIREMENTS OF THE LATEST EDITION OF LOUISIANA STANDARD SPECIFICATIONS FOR ROADS & BRIDGES (LSSRB) SECTION 1003.03, & BE COMPACTED TO AT LEAST 95 PERCENT OF THE MAXIMUM DRY DENSITY DETERMINED BY ASTM D698 (STANDARD PROCTOR) WITHIN 3 PERCENT OF OPTIMUM MOISTURE CONTENT.

**C.** 12.0" MIN. STRUCTURAL FILL. THE STRUCTURAL FILL SHALL BE COMPACTED TO AT LEAST 95% OF THE SOIL'S MAXIMUM DRY DENSITY AS DETERMINED BY ASTM D698 (STANDARD PROCTOR) AND WITHIN THE RANGE OF 1% BELOW TO 3% ABOVE THE OPTIMUM MOISTURE CONTENT VALUE.

**NOTES:**

- 1) ALL STRUCTURAL FILL SHALL BE FREE OF ORGANIC AND OTHER DELETERIOUS MATERIALS, HAVE A MAXIMUM PARTICLE SIZE LESS THAN 2 INCHES, A LIQUID LIMIT LESS THAN 40, AND A PLASTICITY INDEX LESS THAN 18. SANDY CLAY OR CLAYEY SANDS ARE RECOMMENDED FOR USE AS STRUCTURAL FILL. THE ON-SITE SILTY SANDS MAY BE SUITABLE FOR USE AS FILL.
- 2) FILL SHALL BE PLACED IN A MAXIMUM OF 8" LOOSE LIFTS & COMPACTED WITHIN 1% BELOW TO 3% ABOVE OPTIMUM MOISTURE CONTENT VALUE. IF WATER MUST BE ADDED, IT SHALL BE UNIFORMLY APPLIED AND THOROUGHLY MIXED INTO THE SOIL BY DISKING OR SCARIFYING.
- 3) EXISTING SUBGRADE IN PARKING AREAS SHALL BE PROOF-ROLLED WITH A LOADED TANDEM AXLE DUMP TRUCK OR SIMILAR HEAVY RUBBER Tired VEHICLE. SOILS THAT RUT OR DEFLECT EXCESSIVELY UNDER THE MOVING LOAD SHALL BE UNDERCUT AND REPLACED WITH PROPERLY COMPACTED STRUCTURAL FILL.
- 4) ALL SUBGRADE, BASE & PAVEMENT CONSTRUCTION OPERATIONS SHOULD MEET MINIMUM REQUIREMENTS OF THE LOUISIANA DEPARTMENT OF TRANSPORTATION.

**STANDARD DUTY ASPHALTIC PAVEMENT**  
N.T.S.

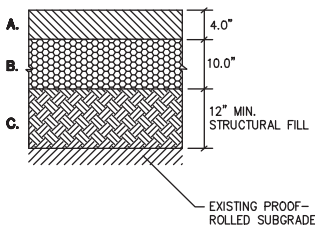

**A.** 4.0" (2-2" LIFTS) OF TYPE 3 ASPHALTIC CONCRETE WEARING COURSE WITH INCIDENTAL PAVING PG 64-22 LIQUID ASPHALT (AGGREGATE 3/4" TO 3/8" MIX) IN ACCORDANCE WITH THE LOUISIANA DEPARTMENT OF TRANSPORTATION & DEVELOPMENT (LADOT) STANDARD SPECIFICATIONS FOR ROADS & BRIDGES, SECTION 501 OF THE 2000 EDITION.

**B.** 10.0" OF COMPACTED 610 LIMESTONE BASE. THE CRUSHED LIMESTONE BASE SHALL MEET THE REQUIREMENTS OF THE LATEST EDITION OF LOUISIANA STANDARD SPECIFICATIONS FOR ROADS & BRIDGES (LSSRB) SECTION 1003.03, & BE COMPACTED TO AT LEAST 95 PERCENT OF THE MAXIMUM DRY DENSITY DETERMINED BY ASTM D698 (STANDARD PROCTOR) WITHIN 3 PERCENT OF OPTIMUM MOISTURE CONTENT.

**C.** 12.0" MIN. STRUCTURAL FILL. THE STRUCTURAL FILL SHALL BE COMPACTED TO AT LEAST 95% OF THE SOIL'S MAXIMUM DRY DENSITY AS DETERMINED BY ASTM D698 (STANDARD PROCTOR) AND WITHIN THE RANGE OF 1% BELOW TO 3% ABOVE THE OPTIMUM MOISTURE CONTENT VALUE.

**NOTES:**

- 1) ALL STRUCTURAL FILL SHALL BE FREE OF ORGANIC AND OTHER DELETERIOUS MATERIALS, HAVE A MAXIMUM PARTICLE SIZE LESS THAN 2 INCHES, A LIQUID LIMIT LESS THAN 40, AND A PLASTICITY INDEX LESS THAN 18. SANDY CLAY OR CLAYEY SANDS ARE RECOMMENDED FOR USE AS STRUCTURAL FILL. THE ON-SITE SILTY SANDS MAY BE SUITABLE FOR USE AS FILL.
- 2) FILL SHALL BE PLACED IN A MAXIMUM OF 8" LOOSE LIFTS & COMPACTED WITHIN 1% BELOW TO 3% ABOVE OPTIMUM MOISTURE CONTENT VALUE. IF WATER MUST BE ADDED, IT SHALL BE UNIFORMLY APPLIED AND THOROUGHLY MIXED INTO THE SOIL BY DISKING OR SCARIFYING.
- 3) EXISTING SUBGRADE IN PARKING AREAS SHALL BE PROOF-ROLLED WITH A LOADED TANDEM AXLE DUMP TRUCK OR SIMILAR HEAVY RUBBER Tired VEHICLE. SOILS THAT RUT OR DEFLECT EXCESSIVELY UNDER THE MOVING LOAD SHALL BE UNDERCUT AND REPLACED WITH PROPERLY COMPACTED STRUCTURAL FILL.
- 4) ALL SUBGRADE, BASE & PAVEMENT CONSTRUCTION OPERATIONS SHOULD MEET MINIMUM REQUIREMENTS OF THE LOUISIANA DEPARTMENT OF TRANSPORTATION.

**HEAVY DUTY ASPHALTIC PAVEMENT**  
N.T.S.

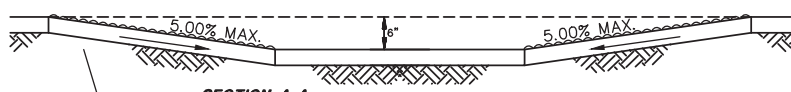
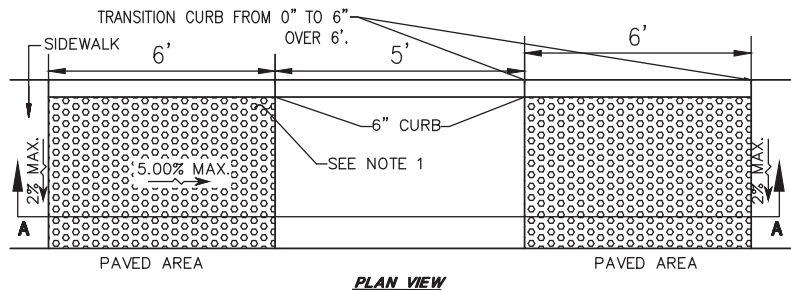

**NOTES:**

1. WHERE SHOWN AS DOTTED PATTERN, THE SURFACE OF RAMP SHALL HAVE A TERRA COTTA RED TRUNCATED DOME BRICK MAT, SET FLUSH WITH TOP OF CONCRETE SURFACE AND INSTALLED AS PER MANUFACTURERS RECOMMENDATIONS.
2. CONSTRUCT PER A.D.A. STANDARDS.

**ADA RAMP IN SIDEWALK**  
N.T.S.

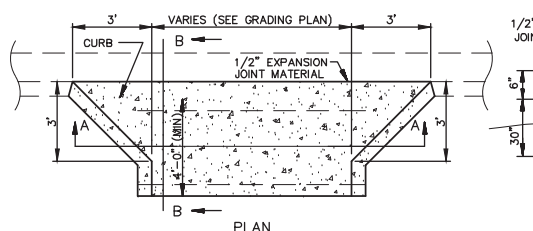
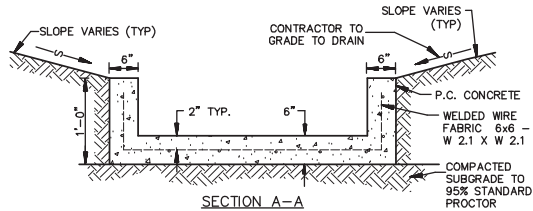

**CONCRETE FLUME**  
N.T.S.

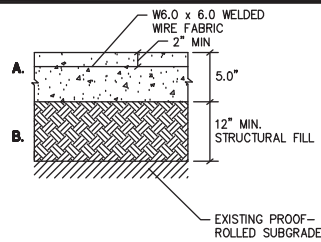

**STANDARD DUTY CONCRETE PAVEMENT**  
N.T.S.

**A.** 5.0" REINFORCED PORTLAND CEMENT CONCRETE TYPE B (4000 PSI COMPRESSIVE STRENGTH & A FLEXURAL STRENGTH AT 550 PSI AT 28 DAYS) COMPLYING WITH THE LOUISIANA DEPARTMENT OF TRANSPORTATION SPECIFICATIONS FOR ROADS & BRIDGES. THE CONCRETE SHALL ALSO BE DESIGNED WITH 5+/- PERCENT ENTRAINED AIR. THE PORTLAND CEMENT SHALL ALSO CONFORM TO THE REQUIREMENTS FOR PORTLAND CEMENT CONCRETE PAVEMENT SECTION 601 & 901 OF THE LADOT STANDARD SPECIFICATIONS FOR ROADS & BRIDGES.

**B.** 12.0" MIN. COMPACTED GRANULAR STRUCTURAL FILL. GRANULAR FILL SHALL MEET THE REQUIREMENTS OF THE LOUISIANA STANDARD SPECIFICATIONS FOR ROADWAY AND BRIDGE CONSTRUCTION AND BE COMPACTED TO 95% OF THE MAXIMUM DRY DENSITY AS DETERMINED BY ASTM D698.

**NOTES:**

- 1) ALL STRUCTURAL FILL SHALL BE FREE OF ORGANIC AND OTHER DELETERIOUS MATERIALS, HAVE A MAXIMUM PARTICLE SIZE LESS THAN 2 INCHES, A LIQUID LIMIT LESS THAN 40, AND A PLASTICITY INDEX LESS THAN 18. SANDY CLAY OR CLAYEY SANDS ARE RECOMMENDED FOR USE AS STRUCTURAL FILL. THE ON-SITE SILTY SANDS MAY BE SUITABLE FOR USE AS FILL.
- 2) FILL SHALL BE PLACED IN A MAXIMUM OF 8" LOOSE LIFTS & COMPACTED WITHIN 1% BELOW TO 3% ABOVE OPTIMUM MOISTURE CONTENT VALUE. IF WATER MUST BE ADDED, IT SHALL BE UNIFORMLY APPLIED AND THOROUGHLY MIXED INTO THE SOIL BY DISKING OR SCARIFYING.
- 3) EXISTING SUBGRADE IN PARKING AREAS SHALL BE PROOF-ROLLED WITH A LOADED TANDEM AXLE DUMP TRUCK OR SIMILAR HEAVY RUBBER Tired VEHICLE. SOILS THAT RUT OR DEFLECT EXCESSIVELY UNDER THE MOVING LOAD SHALL BE UNDERCUT AND REPLACED WITH PROPERLY COMPACTED STRUCTURAL FILL.
- 4) ALL SUBGRADE, BASE & PAVEMENT CONSTRUCTION OPERATIONS SHOULD MEET MINIMUM REQUIREMENTS OF THE LOUISIANA DEPARTMENT OF TRANSPORTATION.
- 5) CONTROL JOINT SPACING SHALL BE A MAXIMUM OF 12 FEET. IF SAWCUT, CONTROL JOINTS SHALL BE CUT WITHIN 6 TO 12 HOURS OF CONCRETE PLACEMENT.
- 6) EXPANSION JOINT SPACING SHALL BE A MAXIMUM OF 75 FT.
- 7) DOWELS AT EXPANSION JOINTS SHALL BE 3/4 INCH BARS, 18 INCHES IN LENGTH, WITH ONE END TREATED TO SLIP, SPACED AT 12 INCHES ON CENTERS AT EACH JOINT.

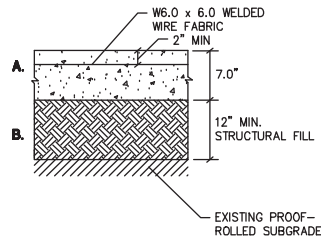

**HEAVY DUTY CONCRETE PAVEMENT**  
N.T.S.

**A.** 7.0" REINFORCED PORTLAND CEMENT CONCRETE TYPE B (4000 PSI COMPRESSIVE STRENGTH & A FLEXURAL STRENGTH AT 550 PSI AT 28 DAYS) COMPLYING WITH THE LOUISIANA DEPARTMENT OF TRANSPORTATION SPECIFICATIONS FOR ROADS & BRIDGES. THE CONCRETE SHALL ALSO BE DESIGNED WITH 5+/- PERCENT ENTRAINED AIR. THE PORTLAND CEMENT SHALL ALSO CONFORM TO THE REQUIREMENTS FOR PORTLAND CEMENT CONCRETE PAVEMENT SECTION 601 & 901 OF THE LADOT STANDARD SPECIFICATIONS FOR ROADS & BRIDGES.

**B.** 12.0" MIN. COMPACTED GRANULAR STRUCTURAL FILL. GRANULAR FILL SHALL MEET THE REQUIREMENTS OF THE LOUISIANA STANDARD SPECIFICATIONS FOR ROADWAY AND BRIDGE CONSTRUCTION AND BE COMPACTED TO 95% OF THE MAXIMUM DRY DENSITY AS DETERMINED BY ASTM D698.

**NOTES:**

- 1) ALL STRUCTURAL FILL SHALL BE FREE OF ORGANIC AND OTHER DELETERIOUS MATERIALS, HAVE A MAXIMUM PARTICLE SIZE LESS THAN 2 INCHES, A LIQUID LIMIT LESS THAN 40, AND A PLASTICITY INDEX LESS THAN 18. SANDY CLAY OR CLAYEY SANDS ARE RECOMMENDED FOR USE AS STRUCTURAL FILL. THE ON-SITE SILTY SANDS MAY BE SUITABLE FOR USE AS FILL.
- 2) FILL SHALL BE PLACED IN A MAXIMUM OF 8" LOOSE LIFTS & COMPACTED WITHIN 1% BELOW TO 3% ABOVE OPTIMUM MOISTURE CONTENT VALUE. IF WATER MUST BE ADDED, IT SHALL BE UNIFORMLY APPLIED AND THOROUGHLY MIXED INTO THE SOIL BY DISKING OR SCARIFYING.
- 3) EXISTING SUBGRADE IN PARKING AREAS SHALL BE PROOF-ROLLED WITH A LOADED TANDEM AXLE DUMP TRUCK OR SIMILAR HEAVY RUBBER Tired VEHICLE. SOILS THAT RUT OR DEFLECT EXCESSIVELY UNDER THE MOVING LOAD SHALL BE UNDERCUT AND REPLACED WITH PROPERLY COMPACTED STRUCTURAL FILL.
- 4) ALL SUBGRADE, BASE & PAVEMENT CONSTRUCTION OPERATIONS SHOULD MEET MINIMUM REQUIREMENTS OF THE LOUISIANA DEPARTMENT OF TRANSPORTATION.
- 5) CONTROL JOINT SPACING SHALL BE A MAXIMUM OF 12 FEET. IF SAWCUT, CONTROL JOINTS SHALL BE CUT WITHIN 6 TO 12 HOURS OF CONCRETE PLACEMENT.
- 6) EXPANSION JOINT SPACING SHALL BE A MAXIMUM OF 75 FT.
- 7) DOWELS AT EXPANSION JOINTS SHALL BE 3/4 INCH BARS, 18 INCHES IN LENGTH, WITH ONE END TREATED TO SLIP, SPACED AT 12 INCHES ON CENTERS AT EACH JOINT.

(CITY OF SLIDELL ROW ONLY)

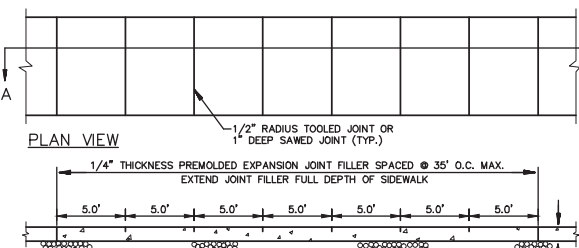

**NOTE:** WHERE REQUIRED REINFORCEMENT WILL BE NO. 3 BARS 24" O.C. EACH WAY MAX. SPACING, OR 6 X 6 W1.4 X W1.4 WWF

**CONCRETE SIDEWALK**  
N.T.S.

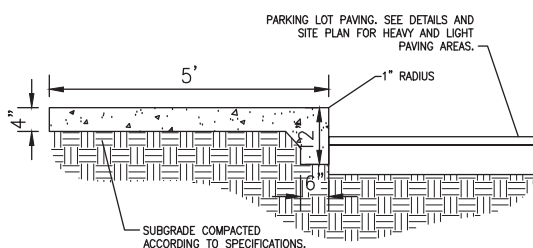

**TURNDOWN SIDEWALK**  
N.T.S.

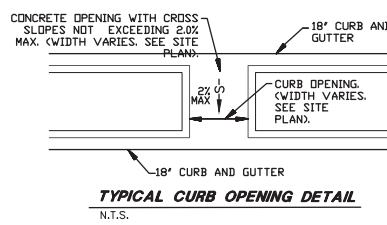

**TYPICAL CURB OPENING DETAIL**  
N.T.S.

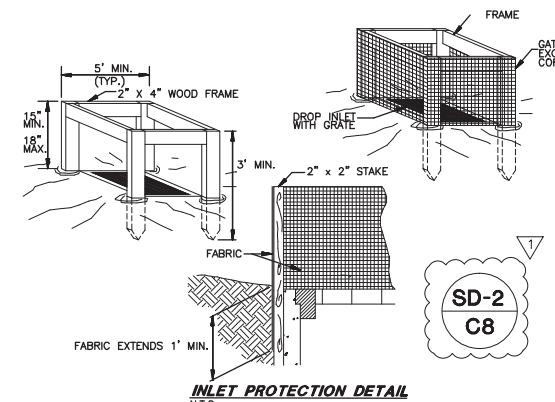

**INLET PROTECTION DETAIL**  
N.T.S.

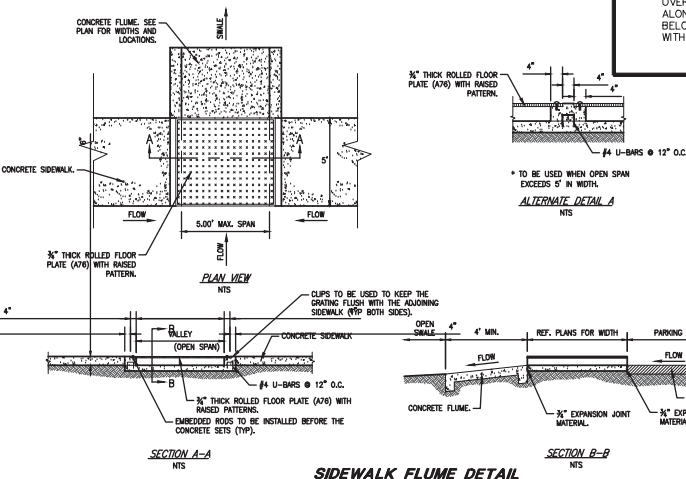

**SIDEWALK FLUME DETAIL**  
N.T.S.

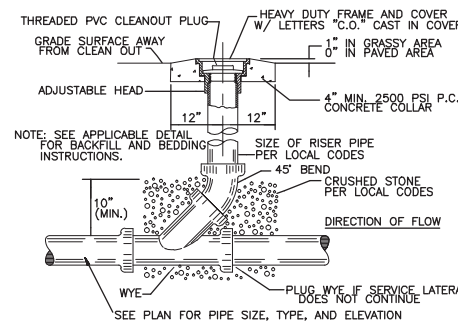

**SANITARY/STORM SEWER CLEAN-OUT**  
N.T.S.

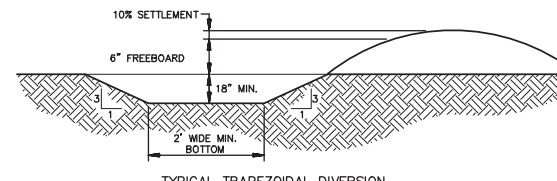

**INTERCEPTOR DITCH**  
N.T.S.

**NOTE:** PURPOSE OF THE INTERCEPTOR DITCH IS TO INTERCEPT STORMWATER & SEDIMENTATION FROM DISCHARGING ONTO THE ADJACENT PROPERTY. INTERCEPTOR DITCH IS TO DISCHARGE TO TEMPORARY SEDIMENTATION BASIN.

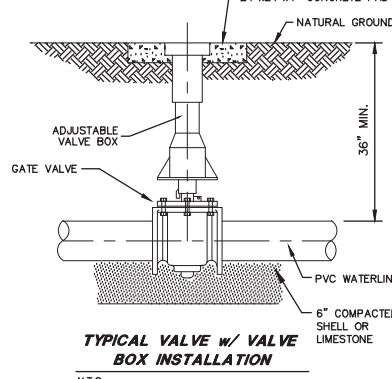

**TYPICAL VALVE w/ VALVE BOX INSTALLATION**  
N.T.S.

\* IF VALVE IS TO BE INSTALLED IN PAVED AREA, VALVE TOP IS TO BE SET AT FINISHED PAVEMENT GRADE.

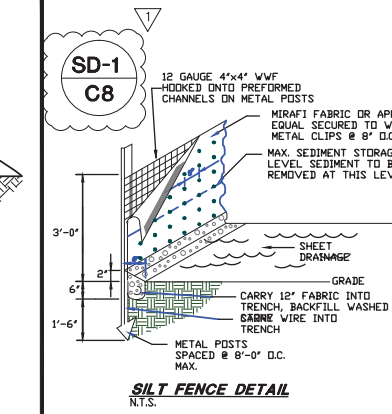

**SILT FENCE DETAIL**  
N.T.S.

**TABLE 5.11 GRADATION OF RIP RAP ROCK**

NSA NUMBER	SIZE IN INCHES					FILTER SIZE
	MAX.	AVG. (1) D 50	(1) MIN. (2)	(2) MIN. (3)	(3) MAX. (4)	
R-1	1.50	.75	(NO. 8)	2.25	FS-1	
R-2	3	1.50	1	4.5	FS-1	
R-3	6	3	2	9	FS-2	
R-4	12	6	3	18	FS-2	
R-5	18	9	5	27	FS-2	
R-6	24	12	7	36	FS-3	
R-7	30	15	12	45	FS-3	
R-8	48	24	15	72	FS-3	

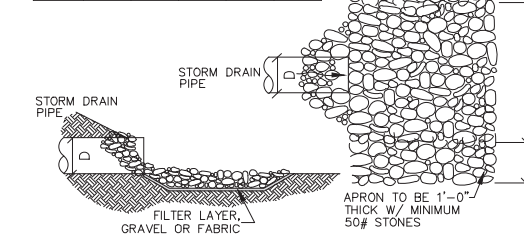

**NOTES:**

1. "AVERAGE SIZE" IS THAT SIZE EXCEEDED BY AT LEAST 50% OF THE TOTAL WEIGHT OF THE TONNAGE SHIPPED. I.e., 50% OF THE TONNAGE SHALL CONSIST OF PIECES LARGER THAN THE "AVERAGE" SIZE (NORMALLY HALF THE SPECIFIED NOMINAL TOP SIZE).
2. PIECES SMALLER THAN THE MINIMUM SIZE SHOWN SHALL NOT EXCEED 15% OF THE TONNAGE SHIPPED.
3. RIP-RAP SHALL BE GROUTED WITH A NON-SHRINKING GROUT OR UNDERLINED WITH FILTER FABRIC TO PREVENT ROCK & STONE INTEGRATION.
4. RIP-RAP UTILIZED SHALL BE SIZED R-4 OR LARGER. SEE SHEET C-4.
5. FOR LENGTH OF APRON (La), SEE SHEET C-4 (STORMWATER POLLUTION PREVENTION PLAN). OTHERWISE, USE 6 TIMES THE PIPE DIAMETER FOR LENGTH OF RIP RAP APRON.
6. RIP-RAP SHALL BE ON TOP THE CLOTH FILTER DIRECTLY ON THE PREPARED FOUNDATION. OVERLAP THE EDGES BY AT LEAST 12 INCHES, & SPACE ANCHOR PINS EVERY 3 FEET ALONG OVERLAP. BURY THE UPSTREAM END OF THE CLOTH A MINIMUM OF 12 INCHES BELOW GROUND & WHERE NECESSARY, BURY THE LOWER END OF THE CLOTH OR OVERLAP WITH THE NEXT SECTION AS REQUIRED.

**RIP RAP DETAIL**  
N.T.S.

**REVISION**

NO.	DATE	BY
1	7-24-14	SMT
ADDENDUM 1		

**DDG**  
DUPLANTIS DESIGN GROUP, PC  
CIVIL ENGINEERING - ARCHITECTURE  
54 LOUISIANA PRIMA DRIVE COVINGTON, LA 70439  
WWW.DDGPC.COM  
PHONE: 985-496-8011 FAX: 985-496-9190  
THIBODIAUX | COVINGTON | HOUSTON | BATON ROUGE | HOUMA

PROGRESS SET - FOR REVIEW ONLY  
Issued 07/24/14  
These documents are for Design Review and not intended for Construction, Bidding, Recordation, Commencement, or under the supervision of: Douglas E. Barthelemy, P.E., #24541 Duplantis Design Group, PC

SPRINGS AT FREMAUX TOWN CENTER  
SLIDELL, LOUISIANA  
ST. TAMMANY PARISH  
FOR CONTINENTAL 294 FUND LLC  
MEMONIEE FALLS, WI

DRAWN DGS  
CHECKED DEB  
ISSUED DATE 7/24/14  
ISSUED FOR PERMITTING  
PROJECT NO. 14-248  
FILE 14-248 DETAILS  
SHEET D-1

**DETAIL SHEET**