

**UTILITY LEGEND**

- (E) UNDERGROUND TELEPHONE WIRING TO BE EXTENDED TO BUILDING BY AT&T. CONTRACTOR SHALL INSTALL (2)-4" CONDUIT FOR UNDERGROUND TELEPHONE SERVICE. CONTRACTOR SHALL BE RESPONSIBLE FOR ANY TRENCHING, BEDDING, BACK FILL WHICH MAY BE REQUIRED. CONTRACTOR SHALL COORDINATE WITH TELEPHONE COMPANY FOR SAID WORK. REFER TO ARCHITECTURAL PLANS FOR ENTRY LOCATION, PANEL SIZE, & GROUND.
- (F) UNDERGROUND ELECTRIC TO BE EXTENDED TO BUILDING BY THE ELECTRIC CONTRACTOR. CLECO WILL PROVIDE PAD MOUNTED TRANSFORMER. CONTRACTOR SHALL SUPPLY PRECAST CONCRETE PAD AND CONDUIT FROM THE TIE-IN LOCATION AT THE RIGHT OF WAY TO THE TRANSFORMER. CONTRACTOR TO PROVIDE 1-2" CONDUIT FOR PRIMARY ROUTING OF ELECTRIC SERVICE. CONTRACTOR TO PROVIDE 1-3" SECONDARY CONDUIT TO THE BUILDING. CONTRACTOR TO COORDINATE WITH CLECO FOR SAID WORK. REFER TO ARCHITECTURAL PLANS FOR ENTRY LOCATION & METER DESIGN.

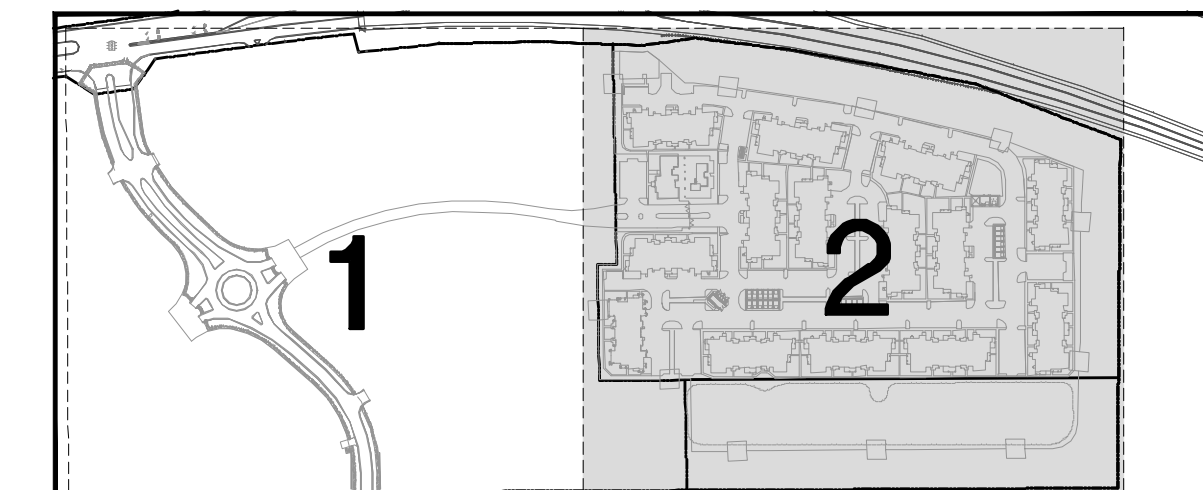

**KEY MAP  
NTS**

**LEGEND - NEW IMPROVEMENTS**

- WATERLINE
- SANITARY SEWERLINE
- UNDERGROUND ELECTRIC
- GAS LINE
- UNDERGROUND TELEPHONE
- STORM DRAIN SYSTEM
- FIRE HYDRANT
- SEWER MANHOLE
- GATE VALVE
- DOMESTIC WATER METER
- SITE LIGHTING POLES (BY SITE CONTRACTOR)
- SANITARY SEWER CLEANOUT
- TELE PULL BOX
- TRANSFORMER
- ELECTRIC VAULT

**LEGEND - EXISTING**

- = FOUND 3/4" IRON PIPE
- ⊙ = FOUND 5/8" IRON ROD
- B = BOLLARD
- BM = PROJECT BENCHMARK
- FH = FIRE HYDRANT
- FL = FLOW LINE
- FO = FIBER OPTIC CABLE
- G = GUY WIRE
- MHST = MANHOLE STORM
- MHSS = MANHOLE SEWER
- PP = POWER POLE
- RCP = REINFORCED CONCRETE PIPE
- S = STOP SIGN
- WV = WATER VALVE

**TELEPHONE NOTES:**

1. ALL PHONE LINE LOCATIONS ARE APPROXIMATE & SHOWN FOR COORDINATION PURPOSES ONLY. REFERENCE ARCHITECT'S PLANS FOR ALL BUILDING SERVICE CONNECTIONS.

**POWER NOTES:**

1. REFERENCE ARCHITECT'S PLANS FOR ALL BUILDING SERVICE CONNECTIONS.
2. ALL PRIMARY & SECONDARY SERVICE LOCATIONS ARE APPROXIMATE & ARE SHOWN FOR COORDINATION PURPOSES ONLY. CONTRACTOR IS RESPONSIBLE FOR COORDINATING WITH THE POWER COMPANY, TO DETERMINE EXACT LOCATION & RESPONSIBILITIES INCLUDING COST.



**DRY UTILITY  
PLAN 2**

SCALE IN FEET



| REVISION | BY |
|----------|----|
|          |    |
|          |    |
|          |    |

**DUPPLANTIS DESIGN GROUP, PC**  
 CIVIL ENGINEERING - ARCHITECTURE  
 34 LOUIS PRIMA DRIVE COVINGTON, LA 70433  
 WWW.DDGP.COM PHONE: 985-249-6880 || FAX: 985-249-6790  
 THIBODAUX | COVINGTON | HOUSTON | BATON ROUGE | HOUMA | DALLAS

*Thomas H. Buckel*  
 SIGNATURE  
 10/28/2015  
 DATE

STAMP  
 STATE OF LOUISIANA  
 THOMAS H. BUCKEL  
 PROFESSIONAL ENGINEER  
 IN  
 CIVIL ENGINEERING

SPRINGS @ RIVER CHASE  
 COVINGTON, LA  
 ST. TAMMANY PARISH  
 FOR CONTINENTAL 339 FUND LLC  
 COVINGTON, LA

DRAWN  
 DJG  
 CHECKED  
 THB  
 ISSUED DATE  
 10/28/2015  
 ISSUED FOR  
 CONSTRUCTION  
 PROJECT NO.  
 14-597  
 FILE  
 DRY UTILITY

SHEET  
**C-3.3**

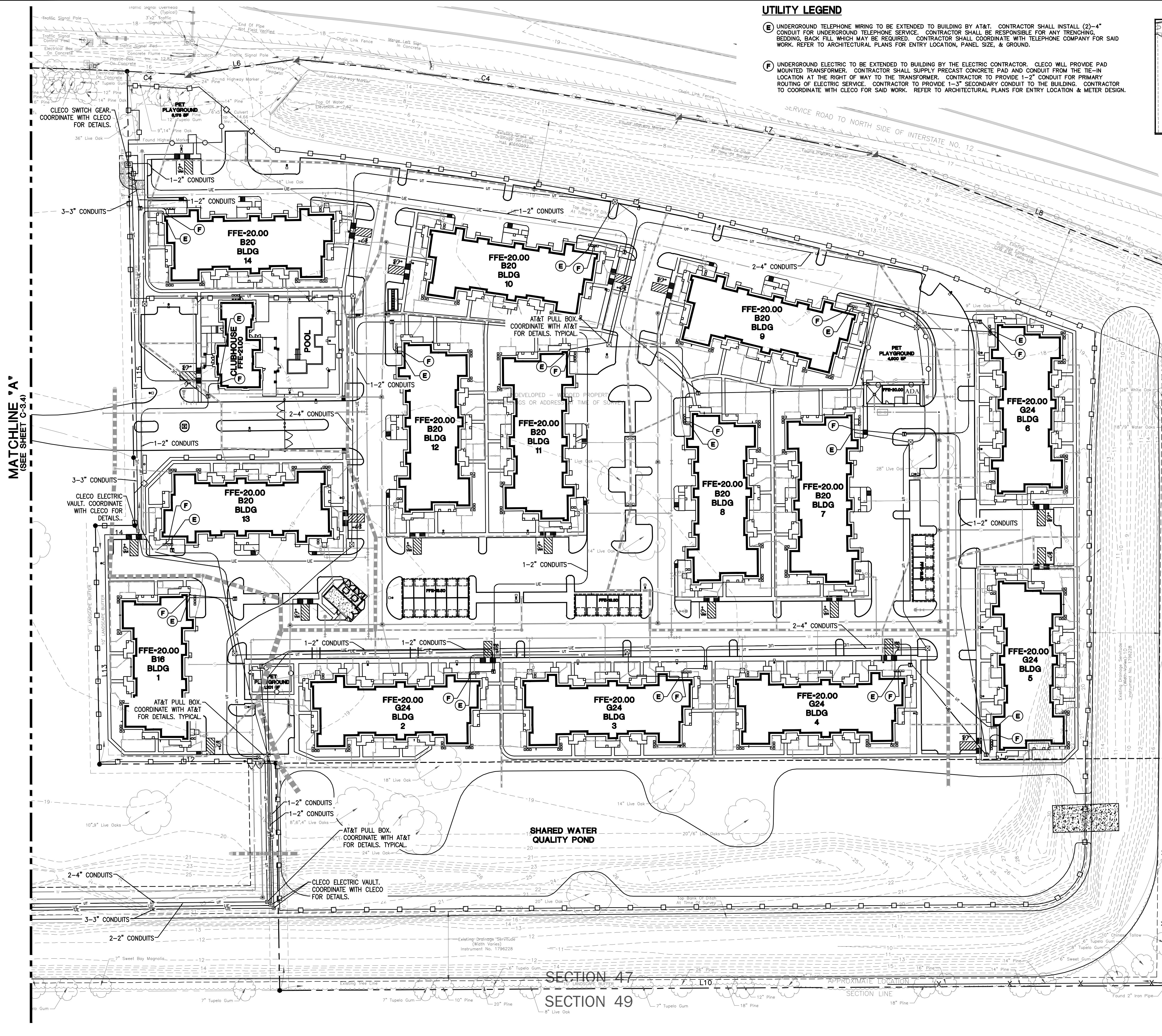

M:\CAD\DWG\14-000\14-597\_DWG\DRY UTILITY.dwg