

Sides

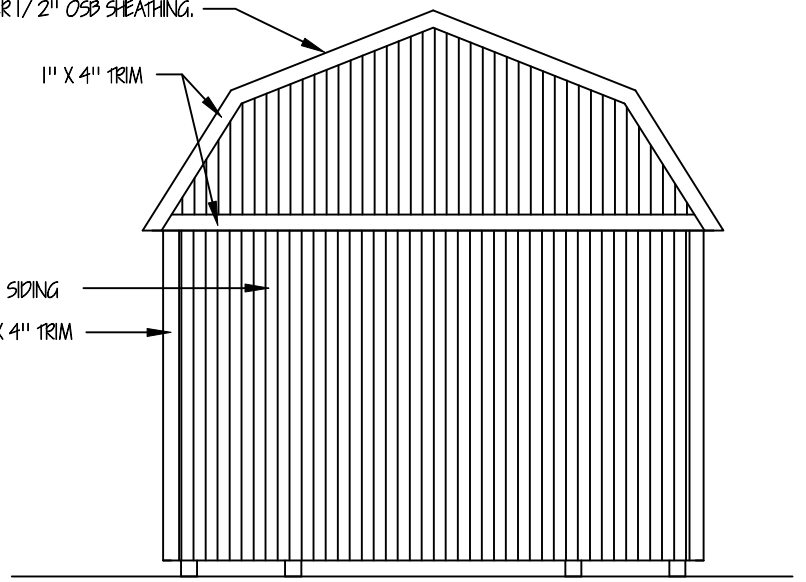

Rear

SIDE DOORS AND WINDOWS OPTIONAL

ANCHORS: IRON ROOF DOUBLE HEAD DOUBLE HELIX EARTH ANCHORS. 30" LONG BY 3/4" W/ 2-4" HELIX FOR SOIL CLASS 2

GIRDERS: TWO REQUIRED FOR 8' and 10' BUILDINGS AND FOUR REQUIRED FOR 12', 14' and 16' BUILDINGS.

1-1/4" FRAME TIE GALVANIZE STRAP WITH BUCKLE AND SLOTTED BOLTS CENTERED BETWEEN EACH PIER

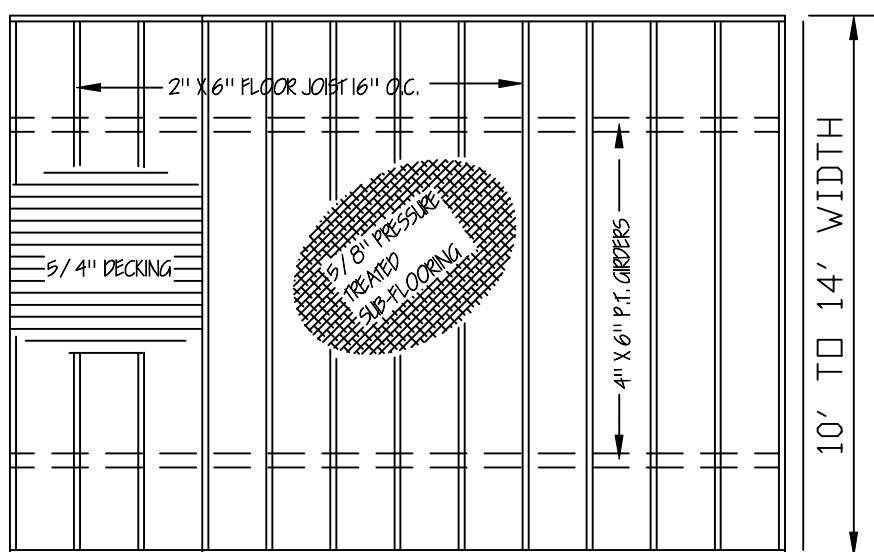
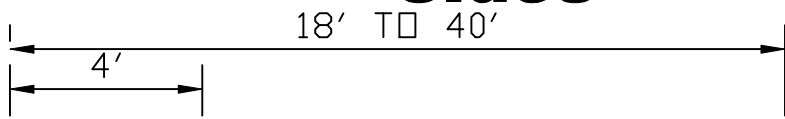

GIRDERS: TWO REQUIRED FOR 8' and 10' BUILDINGS AND FOUR REQUIRED FOR 12', 14' and 16' BUILDINGS.

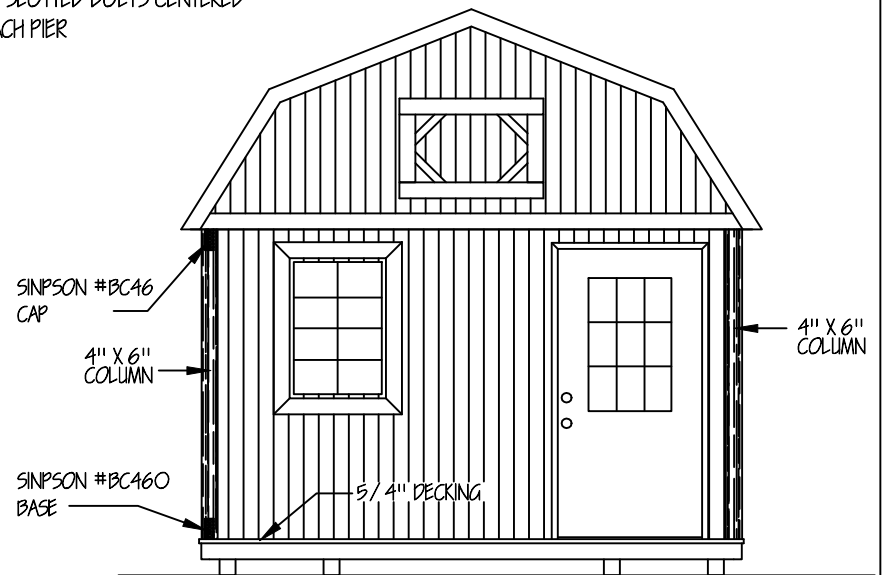

Front

FLOOR FRAMING

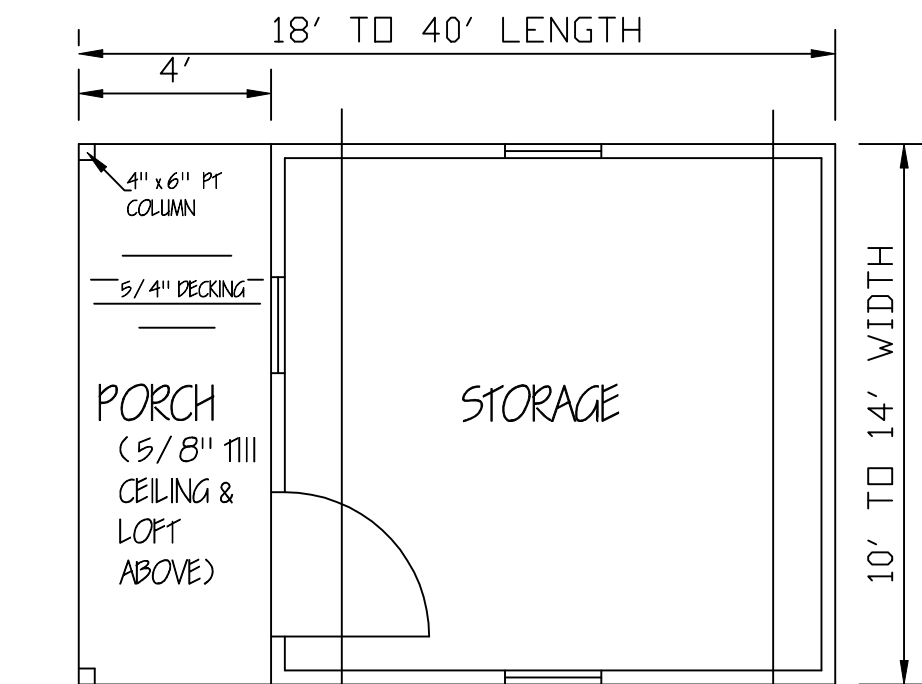

FLOOR PLAN

ENGINEERS' NOTES:

1. FOUNDATIONS PIERS, TIE-DOWNS AND ANCHORS SHALL MEET THE REQUIREMENTS OF THE "PERMANENT FOUNDATIONS GUIDE OF MANUFACTURED HOUSING" AS PUBLISHED BY HUD IN SEPTEMBER 1996, AND THE HUD HANDBOOK 4145.1 REV. 2.
2. NO FIELD SUPERVISION PROVIDED UNDER THIS SEAL.
3. NO ADMINISTRATION PROVIDED UNDER THIS SEAL.

MEASURES SHALL BE TAKEN DURING CONSTRUCTION TO INSURE THAT ONLY WORKMANSHIP OF THE HIGHEST QUALITY IS PERFORMED AND THAT ONLY THE BEST MATERIALS AND PRACTICES OF CONSTRUCTION ARE USED FOR A QUALITY AND SOUND BUILDING.

BUILDINGS 14'-0" AND 16'-0" WIDE, STUDS 16" O.C.

NOTE: THE LOFTED BARN CABIN FLOORING, WALLS AND ROOF ARE DESIGNED TO COMPLY WITH THE 2012 INTERNATIONAL BUILDING AND INTERNATIONAL RESIDENTIAL CODES. THEY ARE NOT INTENDED FOR RESIDENTIAL USE. FOR RESIDENTIAL USAGE 'ALL' STATE AND LOCAL CODES MUST BE MET INCLUDING BUT NOT LIMITED TO SIZES, OPENINGS, CEILING HEIGHTS, ELECTRICAL, PLUMBING ETC.

Lofted Barn Cabin

WIND CERTIFICATION

WIND EXPOSURE CATEGORY 'C'

BASIC WIND SPEED (3 SECOND GUST) 150 M.P.H.

MISSISSIPPI-LOUISIANA

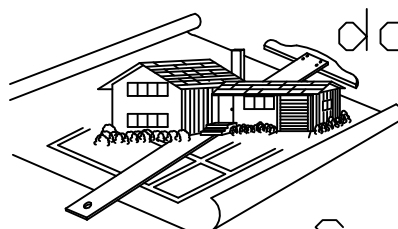

doug's
plan
Service

4210 Stewart Lane
Perkinston, MS 39573
228/255-5259

GRACELAND PROPERTIES LLC
P.O. BOX 665
CUNNINGHAM, KY 42035

Copyright (C) 2008 by Graceland Properties LLC
All Rights Reserved, including the rights of reproduction in whole or in part in any form.