

## OPTIONAL METAL ROOFING

OPTIONAL METAL ROOFING SHALL BE 29 GAGE OVER 1/2" OSB SHEATHING WITH 29 GAGE RIDGE CAP, EAVE TRIM AND RAKE TRIM. SCREEN CLOSURE OVER RIDGE OPENING.

NOTES:  
WOOD TRUSSES SHALL COMPLY WITH R 502.11 AND DESIGN SHALL COMPLY WITH ANSI/ TPI 1 AND APPROVED ACCORDING TO R 106 1. (R = INTERNATIONAL BUILDING CODE)

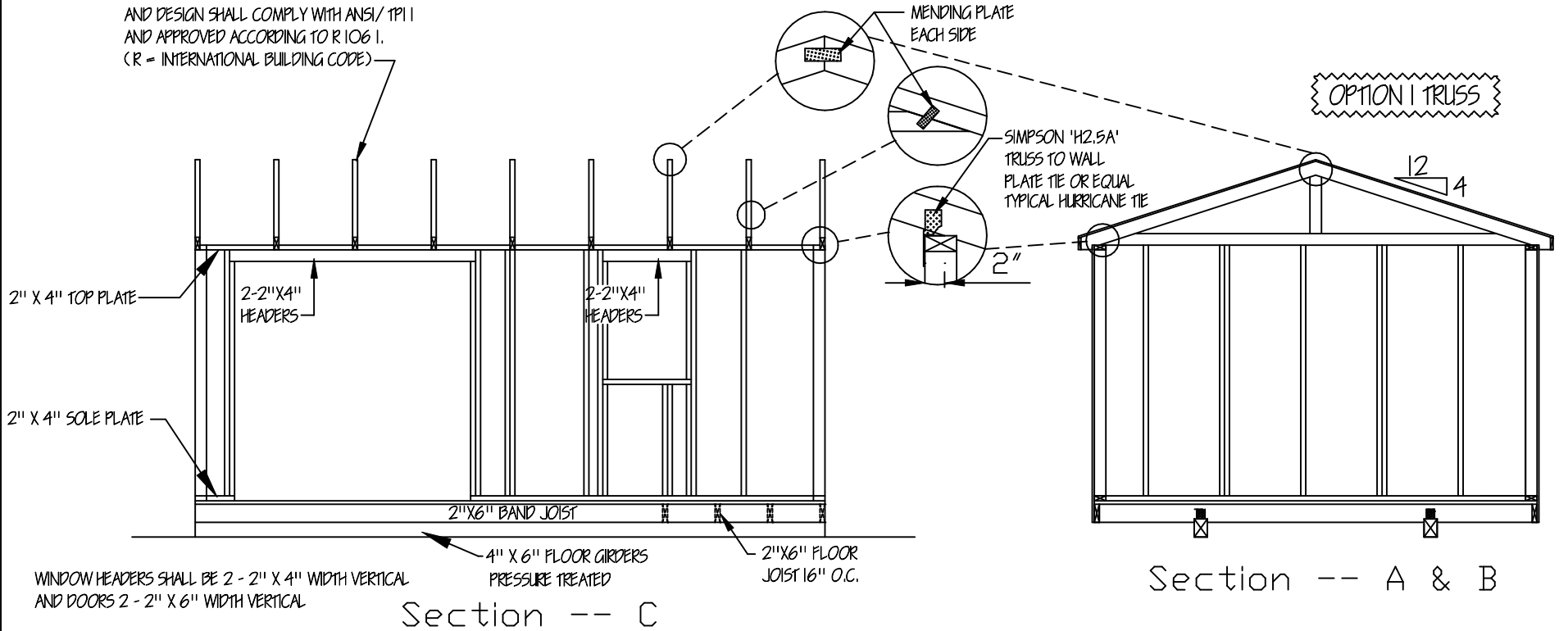

WINDOW HEADERS SHALL BE 2 - 2" X 4" WIDTH VERTICAL AND DOORS 2 - 2" X 6" WIDTH VERTICAL

Section -- C

Section -- A & B

### NOTES:

WOOD TRUSSES SHALL COMPLY WITH R 502.11 AND DESIGN SHALL COMPLY WITH ANSI/ TPI 1 AND APPROVED ACCORDING TO R 106 1. (R = INTERNATIONAL BUILDING CODE)

30 YEAR FIBERGLASS SHINGLES OVER ONE PLY 15# FELT OVER 1/2" OSB SHEATHING. (5/8" TRUSSES 24" O.C.)

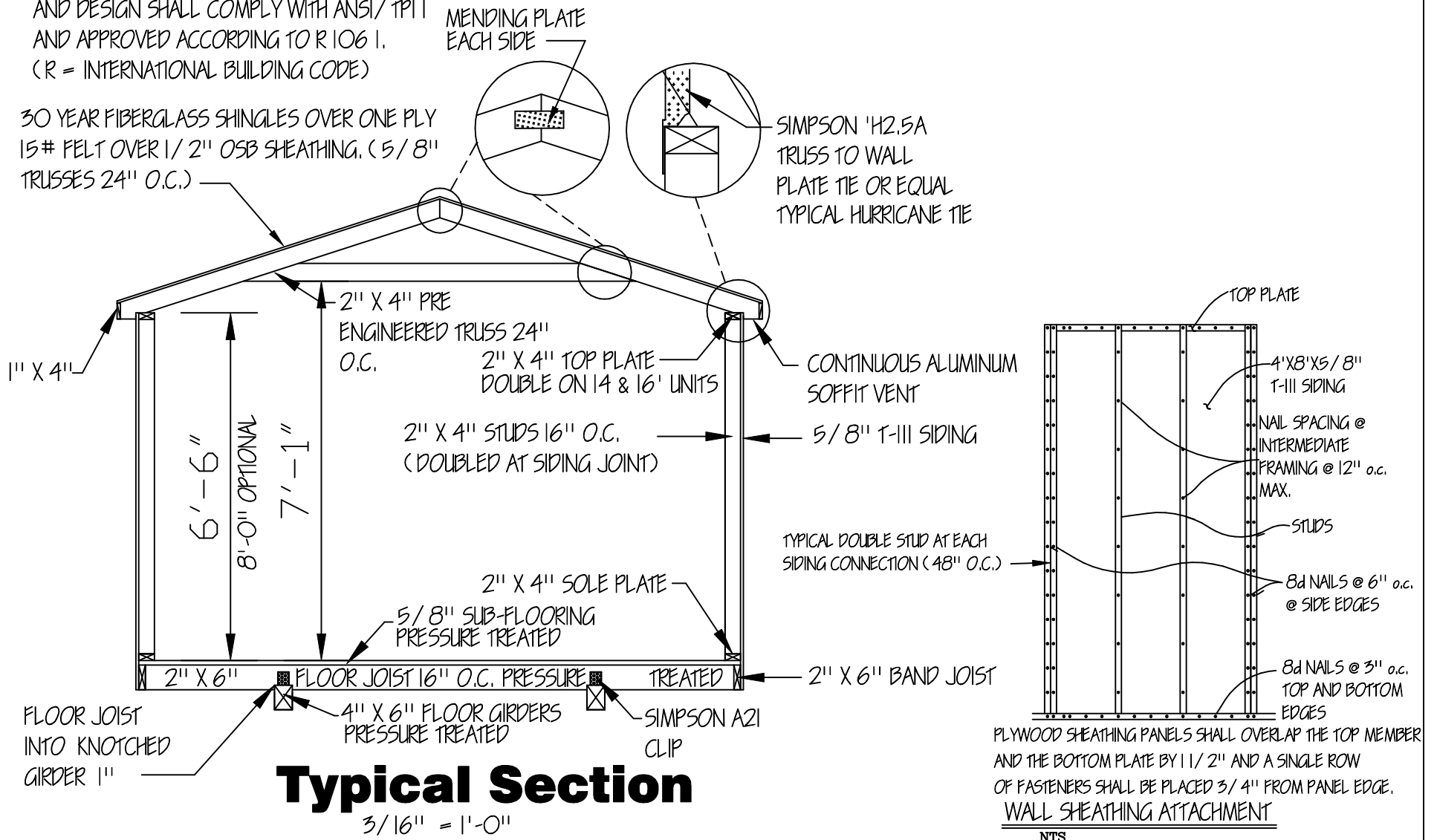

## Typical Section

3/16" = 1'-0"

PLYWOOD SHEATHING PANELS SHALL OVERLAP THE TOP MEMBER AND THE BOTTOM PLATE BY 1 1/2" AND A SINGLE ROW OF FASTENERS SHALL BE PLACED 3/4" FROM PANEL EDGE.  
WALL SHEATHING ATTACHMENT

NTS

# GARDEN SHED

### ENGINEERS' NOTES:

1. FOUNDATIONS PIERS, TIE-DOWNS AND ANCHORS SHALL MEET THE REQUIREMENTS OF THE "PERMANENT FOUNDATIONS GUIDE OF MANUFACTURED HOUSING" AS PUBLISHED BY HUD IN SEPTEMBER 1996, AND THE HUD HANDBOOK 4145.1 REV. 2.
2. NO FIELD SUPERVISION PROVIDED UNDER THIS SEAL.
3. NO ADMINISTRATION PROVIDED UNDER THIS SEAL.

MISSISSIPPI-LOUISIANA

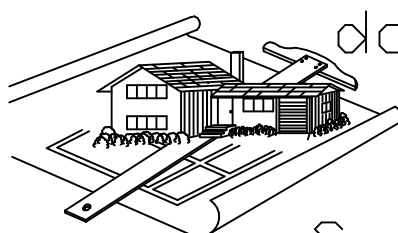

doug's  
plan  
Service

4210 Stewart Lane  
Perkinston, MS 39573  
228/255-5259

GRACELAND PROPERTIES LLC  
P.O. BOX 665  
CUNNINGHAM, KY 42035

Copyright (C) 2008 by Graceland Properties LLC  
All Rights Reserved, including the rights of reproduction in whole or in part in any form.