

ANCHORS: IRON ROOF DOUBLE HEAD
DOUBLE HELIX EARTH ANCHORS. 30" LONG
BY 3/4" W/ 2-4" HELIX FOR SOIL CLASS
2'
1-1/4" FRAME TIE GALVANIZE STRAP WITH
BUCKLE AND SLOTTED BOLTS 4'-0" O.C.
OR AS REQUIRED BY LOCAL CODES.

GIRDERS: TWO REQUIRED FOR 8'
and 10' BUILDINGS AND FOUR
REQUIRED FOR 12', 14' and 16'
BUILDINGS.

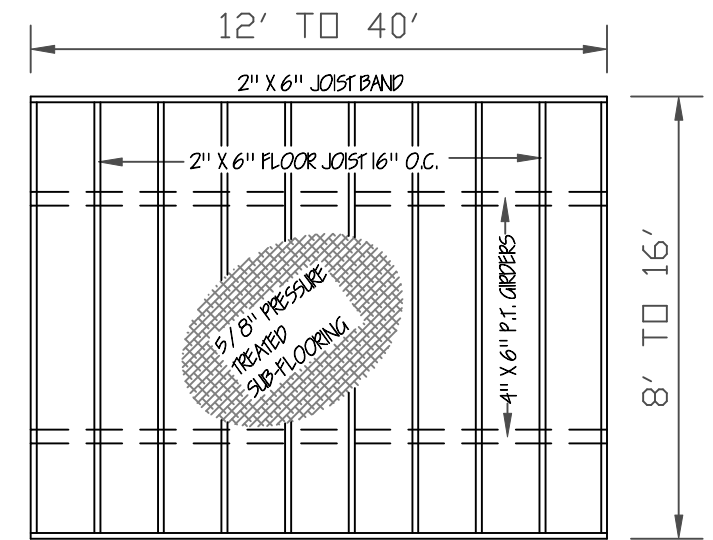
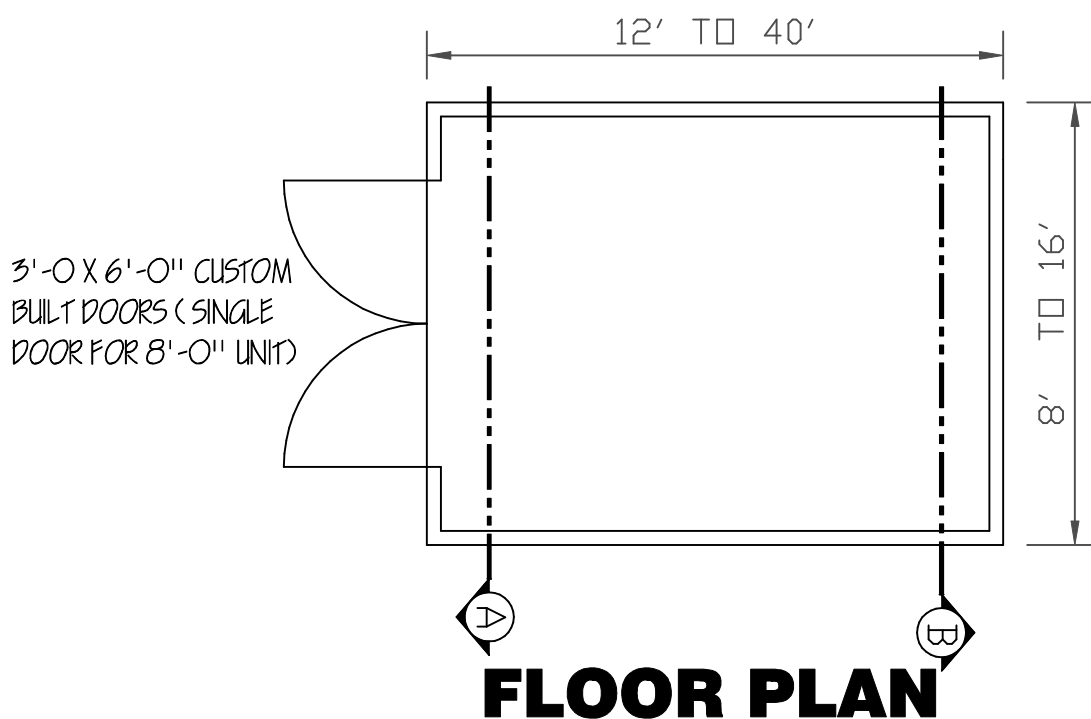

FLOOR FRAMING

GIRDERS: TWO REQUIRED FOR 8' and
10' BUILDINGS AND FOUR REQUIRED FOR
12', 14' and 16' BUILDINGS.

MEASURES SHALL BE TAKEN DURING CONSTRUCTION
TO INSURE THAT ONLY WORKMANSHIP OF THE HIGHEST QUALITY
IS PERFORMED AND THAT ONLY THE BEST MATERIALS AND
PRACTICES OF CONSTRUCTION ARE USED FOR A QUALITY AND
SOUND BUILDING.

NOTE: THE UTILITY FLOORING, WALLS AND ROOF
IS DESIGN TO COMPLY WITH THE 2003, 2006
AND 2009 INTERNATIONAL BUILDING AND
RESIDENTIAL CODES. FOR RESIDENTIAL USAGE
'ALL' STATE AND LOCAL CODES MUST BE MET.

BUILDINGS 14'-0" AND 16'-0" WIDE, STUDS
16" O.C.

ENGINEERS' NOTES:

1. FOUNDATIONS PIERS, TIE-DOWNS AND ANCHORS SHALL MEET THE REQUIREMENTS OF THE "PERMANENT FOUNDATIONS GUIDE OF MANUFACTURED HOUSING" AS PUBLISHED BY HUD IN SEPTEMBER 1996, AND THE HUD HANDBOOK 4145.1 REV. 2.
2. NO FIELD SUPERVISION PROVIDED UNDER THIS SEAL.
3. NO ADMINISTRATION PROVIDED UNDER THIS SEAL.

The Barn

WIND CERTIFICATION

WIND EXPOSURE CATEGORY 'C'
BASIC WIND SPEED (3 SECOND GUST) 150 M.P.H.

MISSISSIPPI-LOUISIANA

DAMMON ENGINEERING
1095 FLORIDA AVE.
SLIDELL, LOUISIANA

985 - 649 - 5832

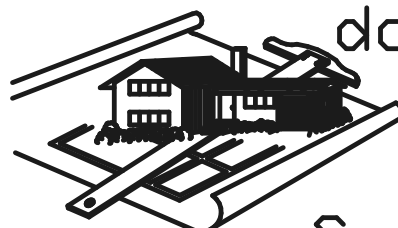

4210 Stewart Lane
Perdinston, MS 39573
228/255-5259

doug's
plan
Service

GRACELAND PROPERTIES LLC

P.O. BOX 665
CUNNINGHAM, KY 42035
601 - 799 - 4545

Copyright (C) 2008 by Graceland Properties LLC
All Rights Reserved, including the rights of reproduction in
whole or in part in any form.