

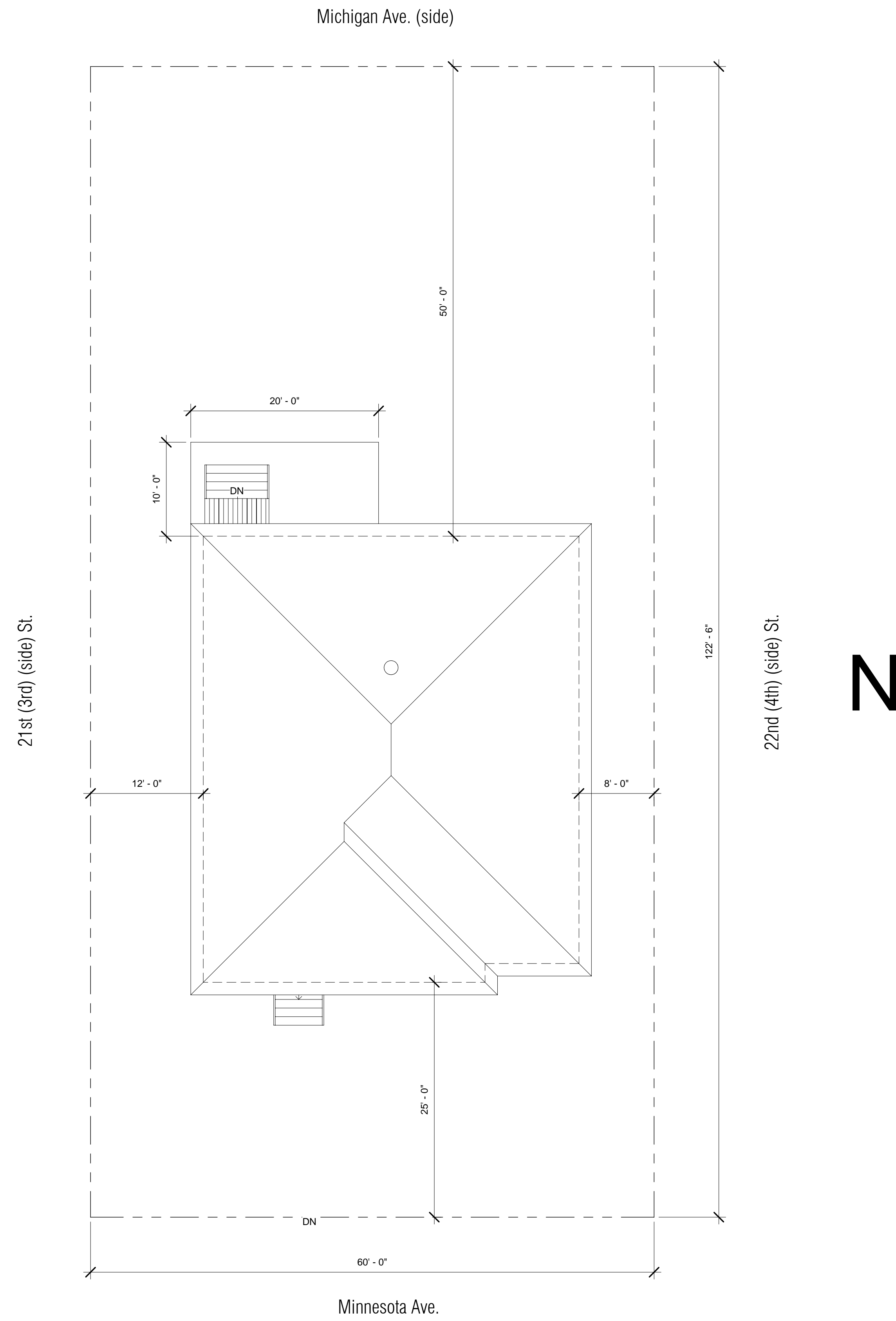

**Karen Zito Residence  
1708 Minnesota Ave.  
Metairie, LA.**

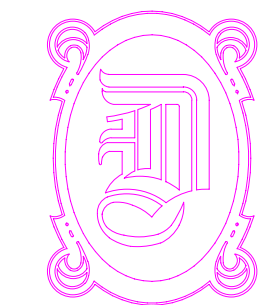

2 Plot Plan  
1/8" = 1'-0"



**DAMMON  
ENGINEERING, INC.**

**EMMETT  
DAMMON**

**ARCHITECT  
ROBERT  
WILTSE**

1095 FLORIDA AVENUE  
SLIDELL, LA. 70458  
985-649-5832

WEBSITE:  
WWW.DAMMONENGINEERING.COM  
EMAIL:  
DAMMONENG@BELLSOUTH.NET

ARCHITECTURE  
ENGINEERING  
STUDIES  
PLANNING  
INVESTIGATION  
EXPERT WITNESS

**N**

Karen Zito  
1708 Minnesota Ave.  
Metairie, LA.

Cover Sheet

**A-100**

Project No. 0733

Date 11/22/07

Scale As Indicated