

GENERAL NOTES

THE LOCATIONS OF UNDERGROUND UTILITIES AS SHOWN HEREON ARE BASED ON ABOVEGROUND STRUCTURES AND RECORD DRAWINGS PROVIDED THE SURVEYOR. LOCATIONS OF UNDERGROUND UTILITIES OR STRUCTURES MAY VARY FROM LOCATIONS SHOWN HEREON. ADDITIONAL BURIED UTILITIES OR STRUCTURES MAY BE ENCOUNTERED. NO EXCAVATIONS WERE MADE DURING THE PROGRESS OF THIS SURVEY TO LOCATE BURIED UTILITIES OR STRUCTURES.

I HAVE CONSULTED THE FLOOD INSURANCE RATE MAPS AND FOUND THIS PROPERTY IS IN A SPECIAL FLOOD HAZARD AREA. F.I.R.M. COMMUNITY MAP NO. 225205 0430 D; DATED: 4/21/99. FLOOD ZONE: A4 & C; BASE FLOOD ELEVATION: 13'. T.B.M. = 604 NAIL IN A POWER POLE (SEE MAP) EL. = 19.67'

- REFERENCES:
- 1.) SURVEY BY THIS FIRM DATED 5/5/64, SURVEY NO. 4520.
 - 2.) SURVEY BY JAMES ANSLEY DATED 6/2/64.
 - 3.) SURVEY BY IVAN M. BORGEN DATED 5/17/76, LAST REVISED 4/8/91, SURVEY NO. 6703/24735/47133.

P.O.B. IS REPORTED TO BE NORTH 568.0'; THENCE N79°20'E 152.6'; THENCE N00°57'28"W 334.10'; THENCE N89°31'03"E 762.5'; THENCE N30°31'E 243.78' FROM THE SECTION CORNER COMMON TO SECTIONS 19, 24, 25 & 30, T-8-S, R-14-E, GREENSBURG LAND DISTRICT, ST. TAMMANY PARISH, LOUISIANA.

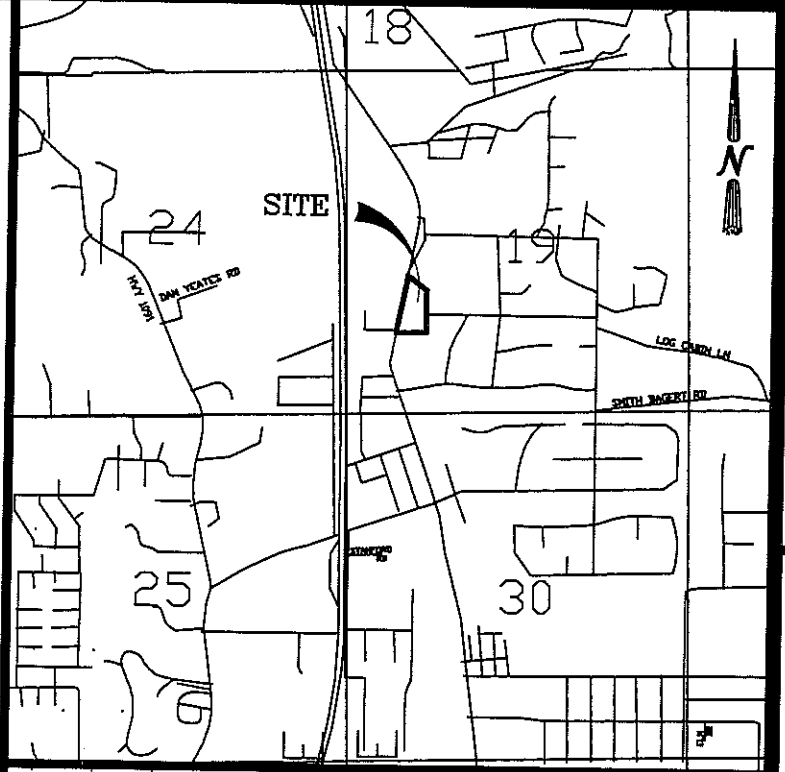

VICINITY MAP
NOT TO SCALE

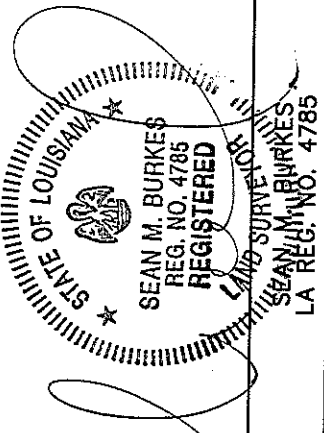

J.V. Burkes & Associates, Inc.
SURVEYING ENGINEERING • ENVIRONMENTAL

1805 Shortcut Highway
Slidell, Louisiana 70458
E-mail: jvbassoc@jvburkes.com
Phone: 985-649-0075 Fax: 985-649-0751
Mississippi Phone: 228-435-5800

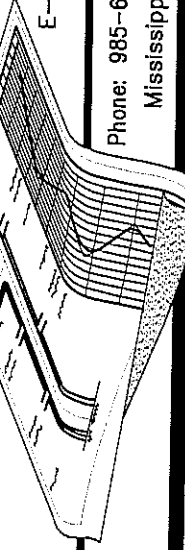

GRAPHIC SCALE

(IN FEET)
1 inch = 60 ft.

LEGEND

- ⊙ S — SEWER MANHOLE, SEWER LINE
- ⊙ W — WATER MANHOLE, WATER LINE
- ⊙ G — GAS MANHOLE, GAS LINE
- ⊙ T — TELE. MANHOLE, TELE. LINE
- ⊙ D — DRAIN MANHOLE, DRAIN LINE
- ⊙ I — DRAIN INLET, DRAIN LINE
- W — POWER POLE / OVERHEAD LINES
- E — ELEC. TOWER / OVERHEAD LINES
- ⊙ — CATCH BASIN
- ⊙ — LIGHT STANDARD
- ⊙ — TRAFFIC LIGHT
- ⊙ — TELE., ELEC., CATV PEDESTAL
- ⊙ — GAS, WATER, ELECTRIC METER
- ⊙ — GAS, WATER VALVE
- ⊙ — SEWER, DRAIN CLEANOUT
- ⊙ — FIRE HYDRANT
- ⊙ — GUY WIRE ANCHOR
- ⊙ — SIGN
- ⊙ — PYLON
- ⊙ — MAILBOX
- ⊙ — TREE
- ⊙ — SHRUB
- ⊙ — FENCE

MILITARY ROAD
(LA. HWY 1690)

6.905 ACRES

LOT 48

50' DRAINAGE EASEMENT

25' EASEMENT

25' DRAINAGE & UTILITY EASEMENT

ORMOND DRIVE

NW 1/4 of the SW 1/4

SE 1/4 of the SW 1/4

SW 1/4 of the SW 1/4

SE 1/4 of the SW 1/4

MR. & MRS. LUCIEN MAURICE PROVOSTY
(NOW OR FORMERLY)

CERTIFICATION

I CERTIFY THAT THIS PLAT DOES REPRESENT AN ACTUAL GROUND SURVEY AND THAT TO THE BEST OF MY KNOWLEDGE NO ENCROACHMENTS EXIST EITHER WAY ACROSS ANY OF THE PROPERTY LINES, EXCEPT AS SHOWN. ENCUMBRANCES AS SHOWN HEREON ARE NOT NECESSARILY EXCLUSIVE. ENCUMBRANCES OF RECORD AS SHOWN ON TITLE OPINION OR TITLE POLICY WILL BE ADDED HERETO UPON REQUEST, AS SURVEYOR HAS NOT PERFORMED ANY TITLE SEARCH OR ABSTRACT.

PROPERTY IS SURVEYED IN ACCORDANCE WITH THE LOUISIANA "MINIMUM STANDARDS FOR PROPERTY BOUNDARY SURVEYS" FOR A CLASS C SURVEY. BEARINGS ARE BASED ON RECORD BEARINGS UNLESS NOTED OTHERWISE.

SCALE:	1" = 60'
DATE:	1/22/14
DRAWN BY:	CHECKED BY:
JDL	JWG
DWG. NO.	20130772
SHEET	1 OF 1

A TOPOGRAPHIC SURVEY
OF A 6.905 ACRE PARCEL OF LAND
IN SECTION 19, T-8-S, R-15-E,
ST. TAMMANY PARISH, LOUISIANA

DECLARATION IS MADE TO ORIGINAL PURCHASER OF THE SURVEY. IT IS NOT TRANSFERABLE TO ADDITIONAL INSTITUTIONS OR SUBSEQUENT OWNERS. SURVEY IS VALID ONLY IF PRINT HAS ORIGINAL SEAL OF SURVEYOR.
KB KAUFMANN CONSTRUCTION