

POLAR-PAK

~ Kolpak's Mission ~

To provide exceptional environments to our employees, customers and shareholders worldwide.



POLAR-PAK  KOLPAK

800•826•7036

901•847•5620

KOLPAK

5 Reasons For Choosing Polar-Pak...

1. THE INDUSTRY'S SIMPLEST INSTALLATION.

Polar-Pak can easily be installed in practically no time at all without the services of a refrigeration technician or plumber.

Corners, wall panels and doors are quickly assembled on the unit's floor (or screeds), and the ceiling panels lifted into place. Then the self-contained wall-mount refrigeration unit, equipped with casters for leveling, is simply rolled up and fitted into place. The top mount system is shipped ready to fit into the appropriate ceiling panel, and is simply lifted into position and then bolted into place. Wiring the refrigeration system can be as simple as attaching a pigtail and plugging the unit into the wall. No drain line is required on indoor installations - making Polar-Pak ideal for basements and upper-floor applications. Note: Outdoor Polar-Pak require drain lines (field supplied and installed).



2. UNSURPASSED QUALITY

Polar-Pak coolers and freezers are made with the same rugged, high performance construction that has made Polar-Pak the leader in walk-in refrigeration.

The Polar-Pak modular panels of 4" 100% foamed in place non-CFC urethane foam offer superior insulating capabilities. The exterior and interior of top-quality galvalume offer an attractive and rugged metal finish.

Polar-Pak also offers superior air circulation around the coils making it both economical and efficient to run.



3. HOST OF INNOVATIVE STANDARD FEATURES

- Hot gas condensate evaporator.
- "Super Door" construction to seal in cold, prevent condensation.
- Posi-Loc panel fasteners for a perfect airtight fit.
- Brushed chrome hinges and door handle with key lock.
- Interior safety release to prevent accidental entrapment.
- Coved corners on floor panels for easier cleaning, greater sanitation.
- Heated air-vents on freezers to eliminate vacuum and pressure build-up.
- Vapor-proof interior light with convenient switch.

5. SEVEN DAY QUICK SHIP

Some standard 7'6" high units are part of our Polar-Pak program, and will ship within 7 working days after your order has been received. (see "QS" designation)

Orders specifying options will require standard lead times for shipping.



4. NO OTHER MANUFACTURER OFFERS YOU GREATER FLEXIBILITY

Polar-Pak is flexible enough to be used in virtually any configuration. There's no need for numbered panels. Side mount refrigeration systems can easily be set into any of the unit's 46" wide wall panel locations.

Polar-Pak is the answer for your indoor and outdoor applications and is available in both top-mount and side-mount models. There are many more reasons to buy Polar-Pak coolers and freezers...

Note:
Self-contained units require at least 18" of clearance on top mount models and at least 2' of clearance on sides and back of side mount models for air circulation around refrigeration system.

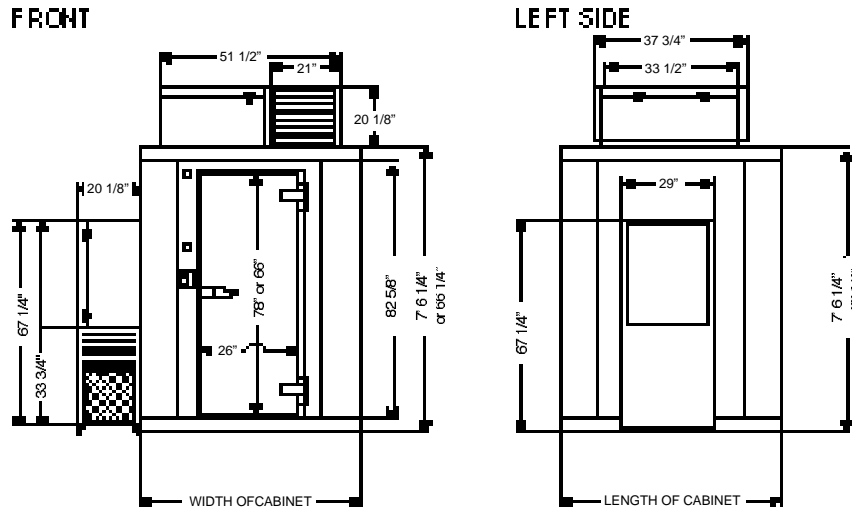

26" wide door opening is standard

Specifications subject to change without notice.

| Key: ● Standard ○ Optional | Cooler | Freezer | | Cooler | Freezer |
|---|--------|---------|---------------------------------------|--------|---------|
| Air cooled condensing units | ● | ● | Interior vapor proof light | ● | ● |
| Aluminum diamond tread plates (1/8", 3/16" or 1/4") | ○ | ○ | Keyed door locks | ● | ● |
| Automatic condensate evaporator | ● | ● | Kick plates (3' x 3') | ○ | ○ |
| Bumper rails and door bumpers | ○ | ○ | Low ambient controls | ○ | ○ |
| Combination construction | ○ | ○ | Magnetic door gaskets | ● | ● |
| Defrost timer | ● | ● | Membrane roof caps (side mount units) | ○ | ○ |
| Dial thermometer | ● | ● | Outdoor package | ○ | ○ |
| Door heater | ● | ● | NSF panels | ● | ● |
| Electric coil defrost system (indoor units) | ● | ● | Non-skid floor strips | ○ | ○ |
| Expansion valve systems | ● | ● | Off cycle coil defrost system | ● | ● |
| Exterior aluminum or stainless ramps (34" x 36") | ○ | ○ | Outdoor rain hoods | ○ | ○ |
| Fluorescent lights | ○ | ○ | Outside locking bar | ○ | ○ |
| 100% Foamed-in-place polyurethane insulation (4") | ● | ● | Self closing door | ● | ● |
| Foamed in place panel gaskets | ● | ● | Shelving kits: three and four tier | ○ | ○ |
| Galvalume interior and exterior | ● | ● | Strip curtains | ○ | ○ |
| High pressure safety control | ● | ● | UL door section | ● | ● |
| Holding only refrigeration systems | ● | ● | UL panels (fire rated) | ● | ● |
| Inside safety release | ● | ● | 1 year parts warranty | ● | ● |
| Interior .100" aluminum floor | ● | ● | 10 year panel warranty | ● | ● |
| Interior aluminum ramps (34" x 20") | ○ | ○ | 5 year compressor warranty - option | ● | ● |
| | | | 1 year labor warranty | ● | ● |
| | | | 30" or 34" wide door opening | ○ | ○ |

With Floor

COOLERS: 38° F. - 7'6" High

| | Side Mount | Top Mount | Actual Size | Door Size | Capacity | Compressor | Amps | Electrical | Ship Weight |
|----|------------|------------|-------------------|-----------|-------------|------------|------|------------|-------------|
| | P7-054-CS | P7-054-CT | 4'10-1/2" x 3'11" | 26" x 78" | 84 cu. ft. | 1/3 HP | 12.0 | 115/60/1 | 779 |
| QS | P7-064-CS | P7-064-CT | 5'10" x 3'11" | 26" x 78" | 116 cu. ft. | 1/3 HP | 12.0 | 115/60/1 | 844 |
| QS | P7-066-CS | P7-066-CT | 5'10" x 5'10" | 26" x 78" | 184 cu. ft. | 1/2 HP | 13.4 | 115/60/1 | 1013 |
| QS | P7-068-CS | P7-068-CT | 5'10" x 7'9" | 26" x 78" | 252 cu. ft. | 1/2 HP | 13.4 | 115/60/1 | 1169 |
| | P7-610-CS | P7-610-CT | 5'10" x 9'8" | 26" x 78" | 320 cu. ft. | 3/4 HP | 19.8 | *115/60/1 | 1368 |
| | P7-612-CS | P7-612-CT | 5'10" x 11'7" | 26" x 78" | 388 cu. ft. | 3/4 HP | 19.8 | *115/60/1 | 1434 |
| QS | P7-088-CS | P7-088-CT | 7'9" x 7'9" | 26" x 78" | 345 cu. ft. | 3/4 HP | 19.8 | *115/60/1 | 1391 |
| QS | P7-810-CS | P7-810-CT | 7'9" x 9'8" | 26" x 78" | 439 cu. ft. | 3/4 HP | 19.8 | *115/60/1 | 1573 |
| | P7-812-CS | P7-812-CT | 7'9" x 11'7" | 26" x 78" | 532 cu. ft. | 1 HP | 18.7 | **115/60/1 | 1762 |
| | P7-108-CS | P7-108-CT | 9'8" x 7'9" | 26" x 78" | 439 cu. ft. | 3/4 HP | 19.8 | *115/60/1 | 1503 |
| | P7-1010-CS | P7-1010-CT | 9'8" x 9'8" | 26" x 78" | 558 cu. ft. | 1 HP | 18.7 | **115/60/1 | 1790 |

With Floor

FREEZERS -10° F. - 7'6" High

| | Side Mount | Top Mount | Actual Size | Door Size | Capacity | Compressor | Amps | Electrical | Ship Weight |
|----|------------|------------|-------------------|-----------|-------------|------------|------|--------------|-------------|
| | P7-054-FS | P7-054-FT | 4'10-1/2" x 3'11" | 26" x 78" | 84 cu. ft. | 1 HP | 9.7 | 208-230/60/1 | 879 |
| QS | P7-064-FS | P7-064-FT | 5'10" x 3'11" | 26" x 78" | 116 cu. ft. | 1 HP | 9.7 | 208-230/60/1 | 944 |
| QS | P7-066-FS | P7-066-FT | 5'10" x 5'10" | 26" x 78" | 184 cu. ft. | 1 1/2 HP | 12.3 | 208-230/60/1 | 1113 |
| QS | P7-068-FS | P7-068-FT | 5'10" x 7'9" | 26" x 78" | 252 cu. ft. | 1 1/2 HP | 12.3 | 208-230/60/1 | 1269 |
| | P7-610-FS | P7-610-FT | 5'10" x 9'8" | 26" x 78" | 320 cu. ft. | 2 HP | 16.2 | 208-230/60/1 | 1433 |
| | P7-612-FS | P7-612-FT | 5'10" x 11'7" | 26" x 78" | 388 cu. ft. | 2 HP | 16.2 | 208-230/60/1 | 1524 |
| QS | P7-088-FS | P7-088-FT | 7'9" x 7'9" | 26" x 78" | 345 cu. ft. | 2 HP | 16.2 | 208-230/60/1 | 1456 |
| QS | P7-810-FS | P7-810-FT | 7'9" x 9'8" | 26" x 78" | 439 cu. ft. | 2 HP | 16.2 | 208-230/60/1 | 1638 |
| | P7-812-FS | P7-812-FT | 7'9" x 11'7" | 26" x 78" | 532 cu. ft. | 2 HP | 16.2 | 208-230/60/1 | 1762 |
| | P7-108-FS | P7-108-FT | 9'8" x 7'9" | 26" x 78" | 439 cu. ft. | 2 HP | 16.2 | 208-230/60/1 | 1503 |
| | P7-1010-FS | P7-1010-FT | 9'8" x 9'8" | 26" x 78" | 558 cu. ft. | 2 HP | 16.2 | 208-230/60/1 | 1790 |

QS = Available on the Polar-Pak program.

Specifications:

| | |
|-------------------------|------------------------------------|
| Interior Finish: | 26 gauge embossed galvalume |
| Exterior Finish: | 26 gauge embossed galvalume |
| Interior Floor: | .100" smooth aluminum |
| Insulation: | 4" 100% foam-in-place polyurethane |
| Thermometer: | 2 1/2" dial type |

Options & Accessories:

Cooler/freezer Combinations are available using listed compartment sizes. 30" and 34" wide doors. Contact factory for additional options and accessories.

With Floor **COOLERS: 38°F. - 6'6" High**

| Side Mount | Top Mount | Actual Size | Door Size | Capacity | Compressor | Amps | Electrical | Ship Weight |
|------------|------------|-------------------|-----------|-------------|------------|------|------------|-------------|
| P6-054-CS | P6-054-CT | 4'10-1/2" x 3'11" | 26" x 66" | 80 cu. ft. | 1/3 HP | 12.0 | 115/60/1 | 742 |
| P6-064-CS | P6-064-CT | 5'10" x 3'11" | 26" x 66" | 98 cu. ft. | 1/3 HP | 12.0 | 115/60/1 | 803 |
| P6-066-CS | P6-066-CT | 5'10" x 5'10" | 26" x 66" | 156 cu. ft. | 1/2 HP | 13.4 | 115/60/1 | 965 |
| P6-068-CS | P6-068-CT | 5'10" x 7'9" | 26" x 66" | 213 cu. ft. | 1/2 HP | 13.4 | 115/60/1 | 1113 |
| P6-610-CS | P6-610-CT | 5'10" x 9'8" | 26" x 66" | 271 cu. ft. | 3/4 HP | 19.8 | *115/60/1 | 1304 |
| P6-612-CS | P6-612-CT | 5'10" x 11'7" | 26" x 66" | 332 cu. ft. | 3/4 HP | 19.8 | *115/60/1 | 1434 |
| P6-088-CS | P6-088-CT | 7'9" x 7'9" | 26" x 66" | 293 cu. ft. | 3/4 HP | 19.8 | *115/60/1 | 1325 |
| P6-810-CS | P6-810-CT | 7'9" x 9'8" | 26" x 66" | 372 cu. ft. | 3/4 HP | 19.8 | *115/60/1 | 1503 |
| P6-812-CS | P6-812-CT | 7'9" x 11'7" | 26" x 66" | 455 cu. ft. | 1 HP | 18.7 | *115/60/1 | 1662 |
| P6-108-CS | P6-108-CT | 9'8" x 7'9" | 26" x 66" | 372 cu. ft. | 3/4 HP | 19.8 | *115/60/1 | 1573 |
| P6-1010-CS | P6-1010-CT | 9'8" x 9'8" | 26" x 66" | 477 cu. ft. | 1 HP | 18.7 | *115/60/1 | 1690 |

With Floor **FREEZERS -10°F. - 6'6" High**

| Side Mount | Top Mount | Actual Size | Door Size | Capacity | Compressor | Amps | Electrical | Ship Weight |
|------------|------------|-------------------|-----------|-------------|------------|------|--------------|-------------|
| P6-054-FS | P6-054-FT | 4'10-1/2" x 3'11" | 26" x 66" | 80 cu. ft. | 1 HP | 9.7 | 208-230/60/1 | 842 |
| P6-064-FS | P6-064-FT | 5'10" x 3'11" | 26" x 66" | 98 cu. ft. | 1 HP | 9.7 | 208-230/60/1 | 903 |
| P6-066-FS | P6-066-FT | 5'10" x 5'10" | 26" x 66" | 156 cu. ft. | 1 1/2 HP | 12.3 | 208-230/60/1 | 1065 |
| P6-068-FS | P6-068-FT | 5'10" x 7'9" | 26" x 66" | 213 cu. ft. | 1 1/2 HP | 12.3 | 208-230/60/1 | 1213 |
| P6-610-FS | P6-610-FT | 5'10" x 9'8" | 26" x 66" | 271 cu. ft. | 2 HP | 16.2 | 208-230/60/1 | 1369 |
| P6-612-FS | P6-612-FT | 5'10" x 11'7" | 26" x 66" | 332 cu. ft. | 2 HP | 16.2 | 208-230/60/1 | 1434 |
| P6-088-FS | P6-088-FT | 7'9" x 7'9" | 26" x 66" | 293 cu. ft. | 2 HP | 16.2 | 208-230/60/1 | 1390 |
| P6-810-FS | P6-810-FT | 7'9" x 9'8" | 26" x 66" | 372 cu. ft. | 2 HP | 16.2 | 208-230/60/1 | 1568 |
| P6-812-FS | P6-812-FT | 7'9" x 11'7" | 26" x 66" | 455 cu. ft. | 2 HP | 16.2 | 208-230/60/1 | 1662 |
| P6-108-FS | P6-108-FT | 9'8" x 7'9" | 26" x 66" | 372 cu. ft. | 2 HP | 16.2 | 208-230/60/1 | 1573 |
| P6-1010-FS | P6-1010-FT | 9'8" x 9'8" | 26" x 66" | 477 cu. ft. | 2 HP | 16.2 | 208-230/60/1 | 1690 |

Floorless **COOLERS: 38°F - 6'6" High**

| Side Mount | Top Mount | Actual Size | Capacity | Compressor | Amps | Electrical | Ship Weight |
|------------|------------|-------------------|-------------|------------|------|------------|-------------|
| PX6-054-CS | PX6-054-CT | 4'10-1/2" x 3'11" | 84 cu. ft. | 1/2 HP | 13.4 | 115/60/1 | 662 |
| PX6-064-CS | PX6-064-CT | 5'10" x 3'11" | 104 cu. ft. | 1/2 HP | 13.4 | 115/60/1 | 707 |
| PX6-066-CS | PX6-066-CT | 5'10" x 5'10" | 165 cu. ft. | 3/4 HP | 19.8 | *115/60/1 | 821 |
| PX6-068-CS | PX6-068-CT | 5'10" x 7'9" | 226 cu. ft. | 3/4 HP | 19.8 | *115/60/1 | 921 |
| PX6-610-CS | PX6-610-CT | 5'10" x 9'8" | 287 cu. ft. | 3/4 HP | 19.8 | *115/60/1 | 1064 |
| PX6-612-CS | PX6-612-CT | 5'10" x 11'7" | 348 cu. ft. | 3/4 HP | 19.8 | *115/60/1 | 1146 |
| PX6-088-CS | PX6-088-CT | 7'9" x 7'9" | 309 cu. ft. | 3/4 HP | 19.8 | *115/60/1 | 1067 |
| PX6-810-CS | PX6-810-CT | 7'9" x 9'8" | 393 cu. ft. | 1 HP | 18.7 | **115/60/1 | 1183 |
| PX6-108-CS | PX6-108-CT | 9'8" x 7'9" | 393 cu. ft. | 1 HP | 18.7 | **115/60/1 | 1183 |

Note: Add "R" or "L" to end of Model Numbers above to designate Right or Left Door Hinge.

Floorless **COOLERS: 38°F - 7'6" High**

| Side Mount | Top Mount | Actual Size | Capacity | Compressor | Amps | Electrical | Ship Weight |
|------------|------------|-------------------|-------------|------------|------|------------|-------------|
| PX7-054-CS | PX7-054-CT | 4'10-1/2" x 3'11" | 98 cu. ft. | 1/2 HP | 13.4 | 115/60/1 | 699 |
| PX7-064-CS | PX7-064-CT | 5'10" x 3'11" | 121 cu. ft. | 1/2 HP | 13.4 | 115/60/1 | 748 |
| PX7-066-CS | PX7-066-CT | 5'10" x 5'10" | 192 cu. ft. | 3/4 HP | 19.8 | *115/60/1 | 869 |
| PX7-068-CS | PX7-068-CT | 5'10" x 7'9" | 264 cu. ft. | 3/4 HP | 19.8 | *115/60/1 | 977 |
| PX7-610-CS | PX7-610-CT | 5'10" x 9'8" | 335 cu. ft. | 3/4 HP | 19.8 | *115/60/1 | 1128 |
| PX7-612-CS | PX7-612-CT | 5'10" x 11'7" | 406 cu. ft. | 3/4 HP | 19.8 | *115/60/1 | 1236 |
| PX7-088-CS | PX7-088-CT | 7'9" x 7'9" | 360 cu. ft. | 3/4 HP | 19.8 | *115/60/1 | 1135 |
| PX7-810-CS | PX7-810-CT | 7'9" x 9'8" | 458 cu. ft. | 1 HP | 18.7 | **115/60/1 | 1253 |
| PX7-108-CS | PX7-108-CT | 9'8" x 7'9" | 458 cu. ft. | 1 HP | 18.7 | **115/60/1 | 1253 |

Note: Add "R" or "L" to end of Model Numbers above to designate Right or Left Door Hinge.
(*Also available 208-230/60/11; *Will run at 10.5 amps; **Will run at 11.3 amps)