

GENERAL NOTES:
 -ALL A/C IS IN PLACE AND EXISTING--NO CHANGES
 -ALL ELECTRICAL IS IN PLACE AND EXISTING
 -THERE IS NO CHANGE OF OCCUPANCY, IT WAS CURRENTLY A RESTURANT
 -THIS BUILDING IS ALL EXISTING, THE BUILD OUT IS ONLY TO THE BAR,COOLER RM. AND KITCHEN AREA
 -TWO WINDOWS ARE BEING REMOVED FROM KITCHEN
 -ALL REAR STAIR HAVE BEEN APPROVED PREVIOUSLY AND ARE COMPLIANT
 -THE SECOND FLOOR WILL BE USED AS A OFFICE AND THE OCCUPANT LEVEL IS BELOW 30 PEOPLE AND EXITS DIRECTLY TO THE OUTSIDE

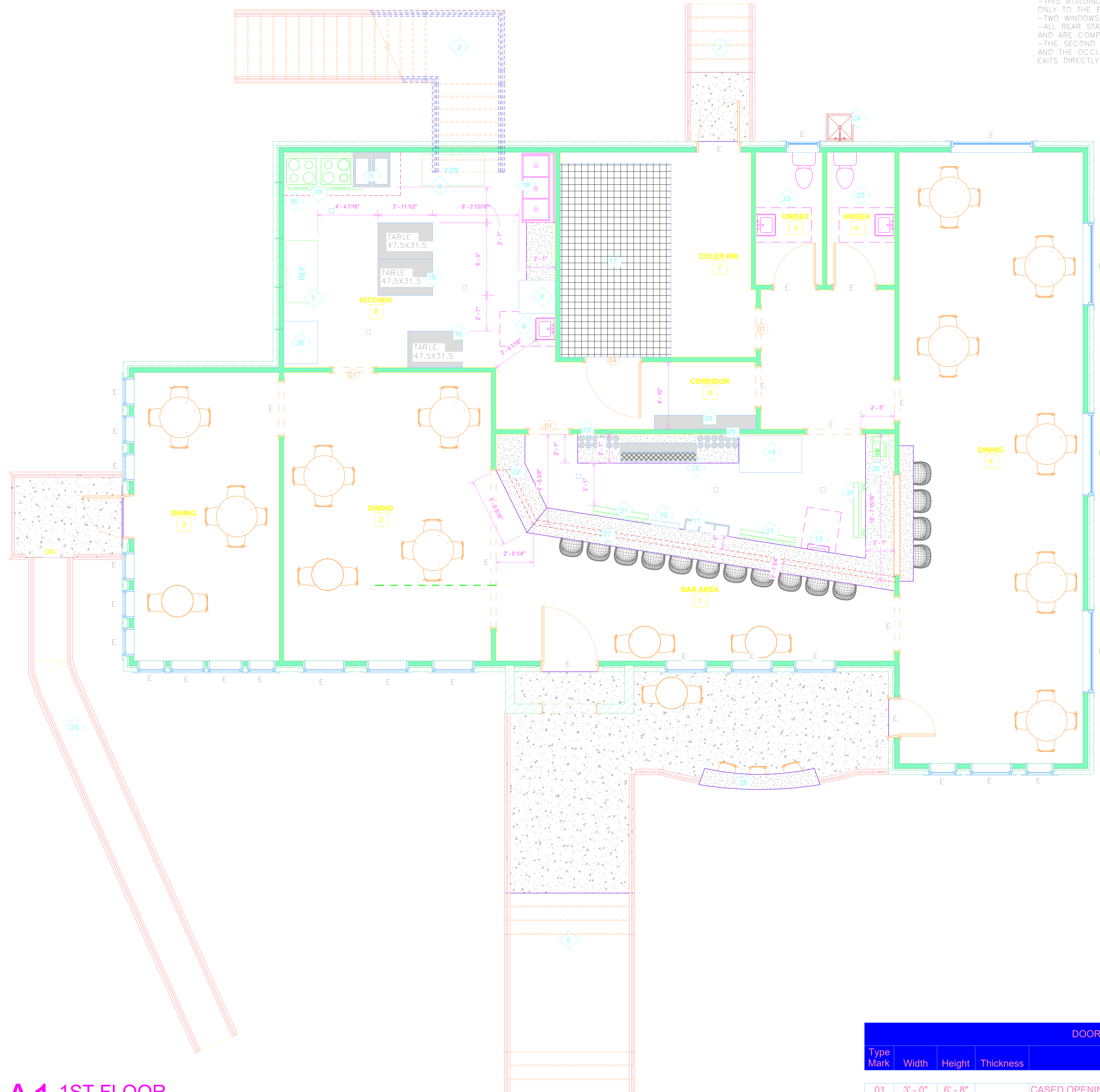

- 1 2X6 WALL
- 2 EXISTING STAIRS
- 3 RAILINGS ARE TO HAVE 4" MIN. SPACE BETWEEN BALUSTERS, AND 34" TO 38" HIGH.
- 4 STAIRS: AS PER CODE, 2021 IRC-R311.7
- 5 2-FRYERS-ATO-ATFS-40
- 6 DISHWASHER-495NOWF1EX
- 7 REACH IN COOLER-178a49rhc
- 8 REACH IN FREEZER- 178a49fhc
- 9 HAND SINK-600hs12
- 10 BAR DISHWASHER-MD-GW-HTB22P
- 11 BAR TRIPLE COMPARTMENT-600hs31014g
- 12 CHILL RITE CM SBT 20F TAP SYSTEM
- 13 BAR HAND SINK 600hs12
- 14 MERCH REACH IN-ATVANCO 54" 178gdc49hcb
- 15 HOOD SYSTEM W/ SUSPRESSION- ACCUREX XBEW-T-120.00S
- 16 PREP TABLE-EPBNR2-D4 47.5
- 17 WALK IN COOLER/FREEZER
- 18 TRIPLE SINK- 60s3151515gl
- 19 GRILL/BURNERS ATO-AGR-6B24GR-NG 66"
- 20 PIZZA OVEN-SHUFFLE 1200
- 21 SPEED RACK
- 22 ADA COUNTER
- 23 EXISTING ADA APPROVED BATHS
- 24 MOP SINK
- 25 EXISTING ADA APPROVED RAMP
- 26 BAR BRACKETS ARE TO BE WELDED TO EXISTING IRON RAILING TO MOUNT A BAR TOP TO IT.
- 27 4" STUD WALL BELOW BAR
- 28 NEW WALL OF SHELVES TO BE BUILT HERE
- 29 PREMIUM LIQUOURS
- 30 ICE MAKER (NEEDS SPECS)

WARREN L. DIETZ JR. P.E.
 CIVIL ENGINEER
 Covington, LA
 985-809-8033

2998 PONCHATRIN DR.
 CAMELLIA POINT
 CITY OF SLIDELL

A1 1ST FLOOR
 1/4" = 1'-0"

DOOR SCHEDULE					
Type Mark	Width	Height	Thickness	Description	Count
01	3' - 0"	6' - 8"		CASED OPENING	3
04	4' - 0"	6' - 8"	0' - 1 3/8"	INTERIOR SOLID DOOR	1

SQ. FOOTAGE	
Comments	Area
CONDITIONED	
EXISTING 2ND. FLR.	591 SF
EXISTING RENOVATED 1ST. FLR.	2627 SF
CONDITIONED	3218 SF
Grand total	3218 SF

Drawn by JJB Checked by MKB
 Project number DD-226C
 Date 4/10/2024

SHEET
A1.4