

NAIL SALON
TENANT "D"
(1,025 S.F.)
401

2 TENANT "D", "E"
ENLARGED WATER PLAN
SCALE: 1/4"=1'-0"

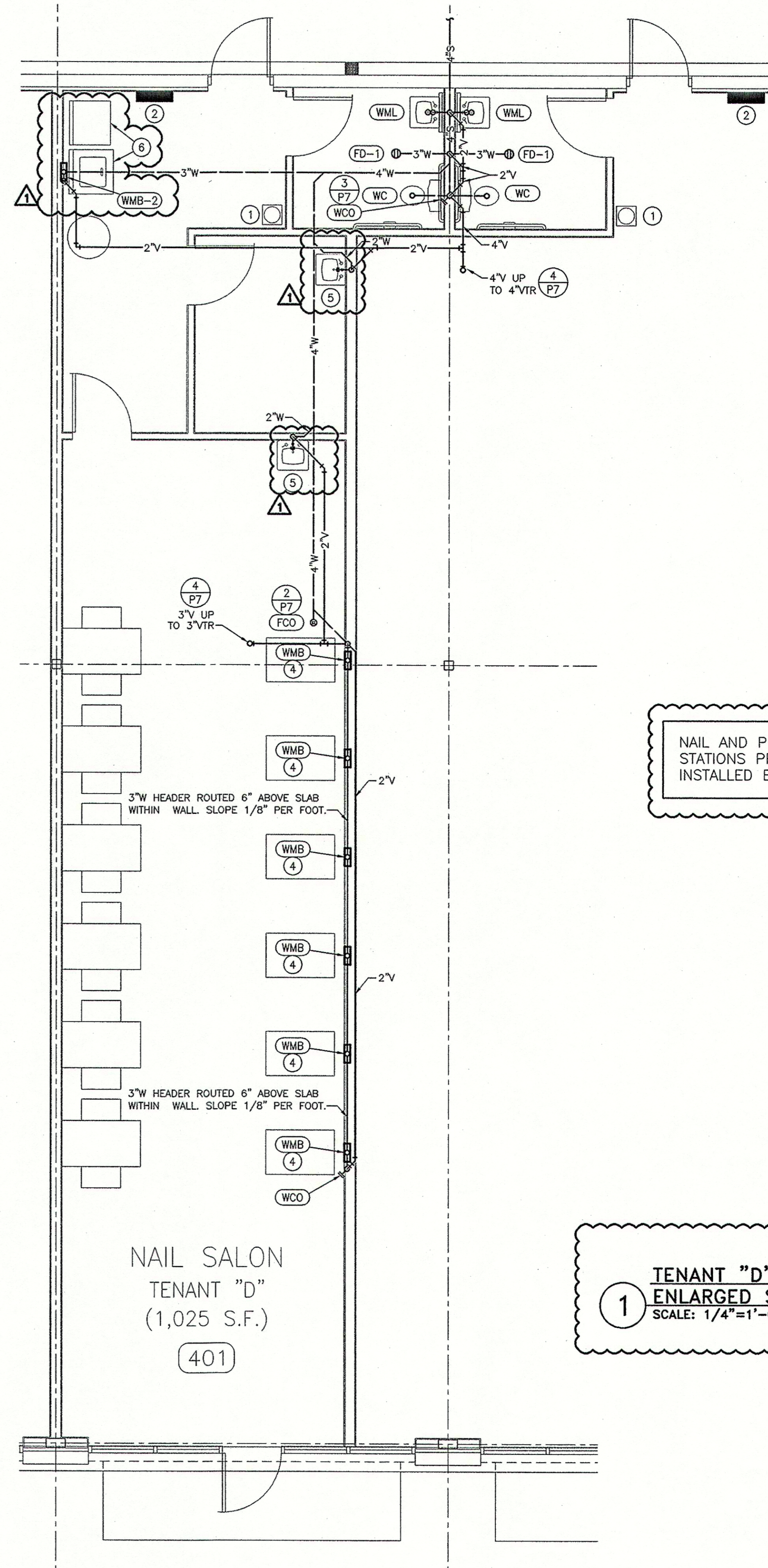

NAIL SALON
TENANT "D"
(1,025 S.F.)
401

1 TENANT "D", "E"
ENLARGED SANITARY PLAN
SCALE: 1/4"=1'-0"

PLUMBING PLAN NOTES:

- 1 BOTTLED WATER DISPENSER PROVIDED BY TENANT. NOT IN CONTRACT.
- 2 NO PLUMBING RELATED PIPING SHALL BE ROUTED OVER ELECTRICAL PANELS.
- 3 1/2" CW AND HW DOWN TO WMB. WMB INSTALLED 26" AFF.
- 4 2"W WITH P-TRAP DOWN FROM WMB TO 3"W HEADER WITHIN WALL. WMB INSTALLED 26" AFF.
- 5 WALL MOUNTED LAVATORY PROVIDED AND INSTALLED BY TENANT. PROVIDE ROUGH-IN FOR TENANT PROVIDED SINK.
- 6 WASHER AND DRYER PROVIDED AND INSTALLED BY TENANT.

NAIL AND PEDICURE STATIONS PROVIDED AND INSTALLED BY TENANT.

REVISION #	DATE	DESCRIPTION	BY
1	8/13/07		

DDG DUPLANTIS
DESIGN GROUP, PC

Respect. Integrity. Client Satisfaction. Excellence

THIBODAUX, LOUISIANA
MANDEVILLE, LOUISIANA
HOUSTON, TEXAS

Civil Engineering • Site Development • Land Planning • Public Works • Architecture
314 East Bayou Road
Thibodaux, Louisiana 70301
Phone: 985-447-0090
Fax: 985-447-7069

STATE OF LOUISIANA
DUANE S. HENDERSON
License No. 23329
PROFESSIONAL ENGINEER
IN MECHANICAL ENGINEERING

2/28/08

PROPOSED RETAIL DEVELOPMENT
CITY OF BOULTE
ST. CHARLES PARISH, LOUISIANA

FOR THE SPECTRA GROUP, INC.
MEMPHIS, TENNESSEE

DRAWN	NDC
CHECKED	WWR
DATE	8/13/07
SCALE	AS NOTED ON DWG
PROJECT NO.	0750001106
FILE	0750001106P4.DWG
SHEET	

P4.1

HENDERSON ENGINEERS

8325 LINDA DRIVE
LENOX, IA 66214
TEL 913 742 5000 FAX 913 742 5001
www.hel-eng.com
0750001106

Program: Duplantis\0750001106_Spectra Retail Center - Booth - L:\0000\0750001106\4.dwg, PLOT: 8/13/07 10:08:41 AM, User: hndrns, Plotter: HP DesignJet 5000, Plot Size: 36x48