



CONSTRUCTION DOCUMENTS REVIEW

October 10, 2006

David Dammon
Dammon Engineering
1095 Florida Ave.
Slidell, LA 70458

RE: QUIZNOS SUB
Highland Commons Store #11466
17002 Jefferson Hwy. Ste. C
Baton Rouge, LA 70817
(Accepted 10-9-06)

Dear David:

I have reviewed the construction documents for the above location, based on The Quiznos Master LLC design criteria, equipment standards, material and general information, and have the following comments and/or concerns:

The construction documents for the above project are:

APPROVED JA JA
(Based on compliance with the below comments, concerns, issues)

-
- a. This store will use the materials, methods and general information that is found and detailed in the **Q2006 Architectural and Construction Manual Version One**.
 - b. **All construction documents must reflect Addendum #4 and the Cost Reduction Program.** If the construction documents were sent to our department prior to Addendum #4 the architect is responsible for revising all plans affected by the changes.
 - c. A standard Q-Vent will be ordered per the QVent worksheet.
 - d. An 8'x8'x9'-6" freezer, remote compressor, will be ordered per the Kolpak worksheet. Verify.
 - e. A 6'x6'x7'-6" cooler, remote compressor, will be ordered. Verify.
 - f. A 208V toaster will be ordered. Verify.
 - g. All millwork will be ordered as standard prototype sizes.
 - h. Note: all sneeze guard glass must be angled 15 degrees, VERIFY.
 - i. The electrical panel has been noted as new and will be ordered.
 - j. The order neon requires a ceiling mounted electrical outlet. Verify (see attached)
 - k. Standard FRP is to be used in the back room and the restrooms around all water use areas including the 3-compartment sink and backroom beverage equipment. (see attached)

This review is performed solely for Quizno's benefit to ensure that the schematic layout meets the requirements of The Quiznos Master LLC and complies with the design and specifications. It shall become incumbent upon you, the Project Architect to insure that the Franchisee have a final architectural plan set that complies with all applicable codes and regulations, as well as mechanical and electrical requirements suited to the restaurant needs.

During the Construction Drawing and Construction Administration phase of the project, keep us informed of any substantial changes and/or problems to the schematic. Copies of any clarifications or addenda's issued, should be sent to The Quiznos Master LLC Design and Construction Department as soon as they are issued.

Should any questions or concerns arise during this project, please contact me at janton@quiznos.com or 303.633.5274 if I can be of any assistance.

Respectfully,
THE QUIZNO'S MASTER LLC

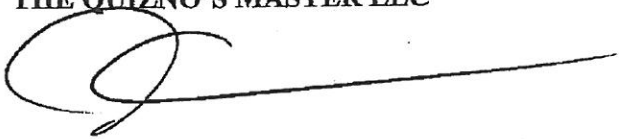

Justin Anton
Design & Construction Department

cc: David Lake

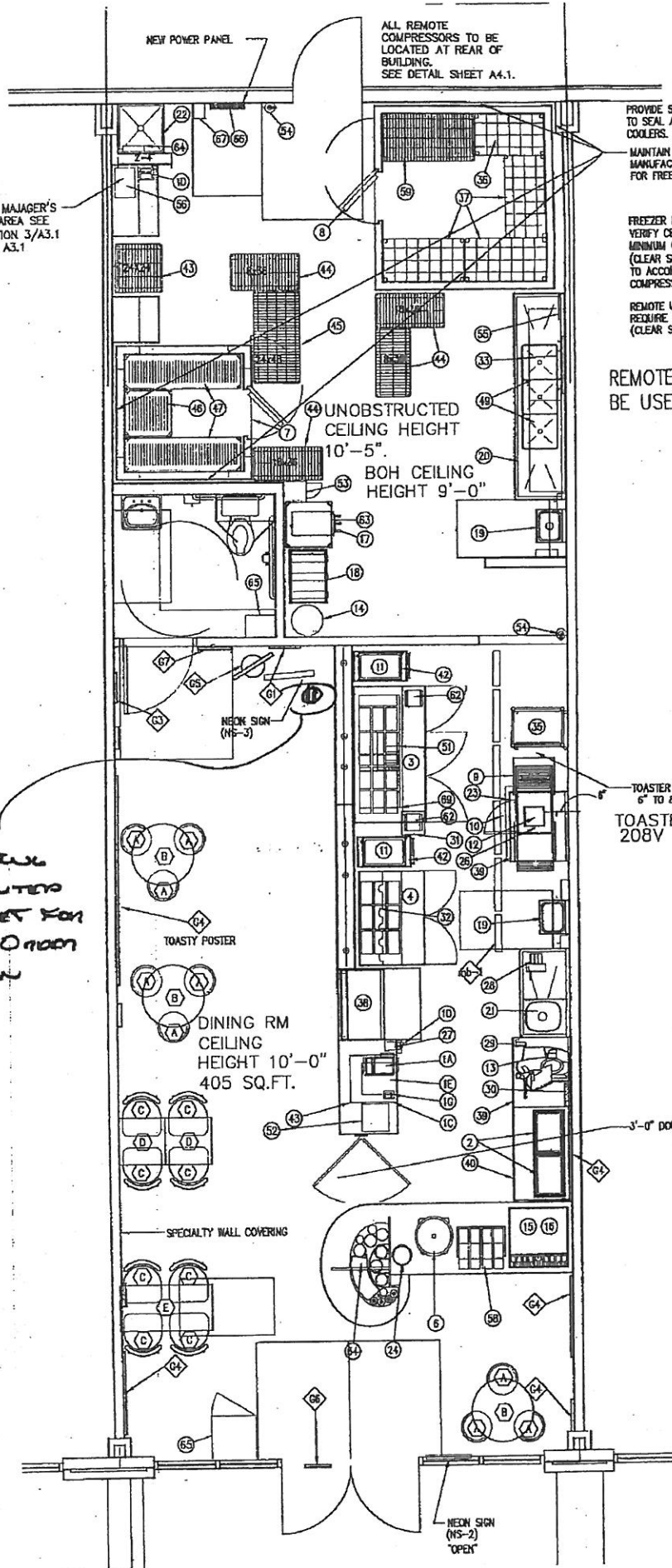

11466

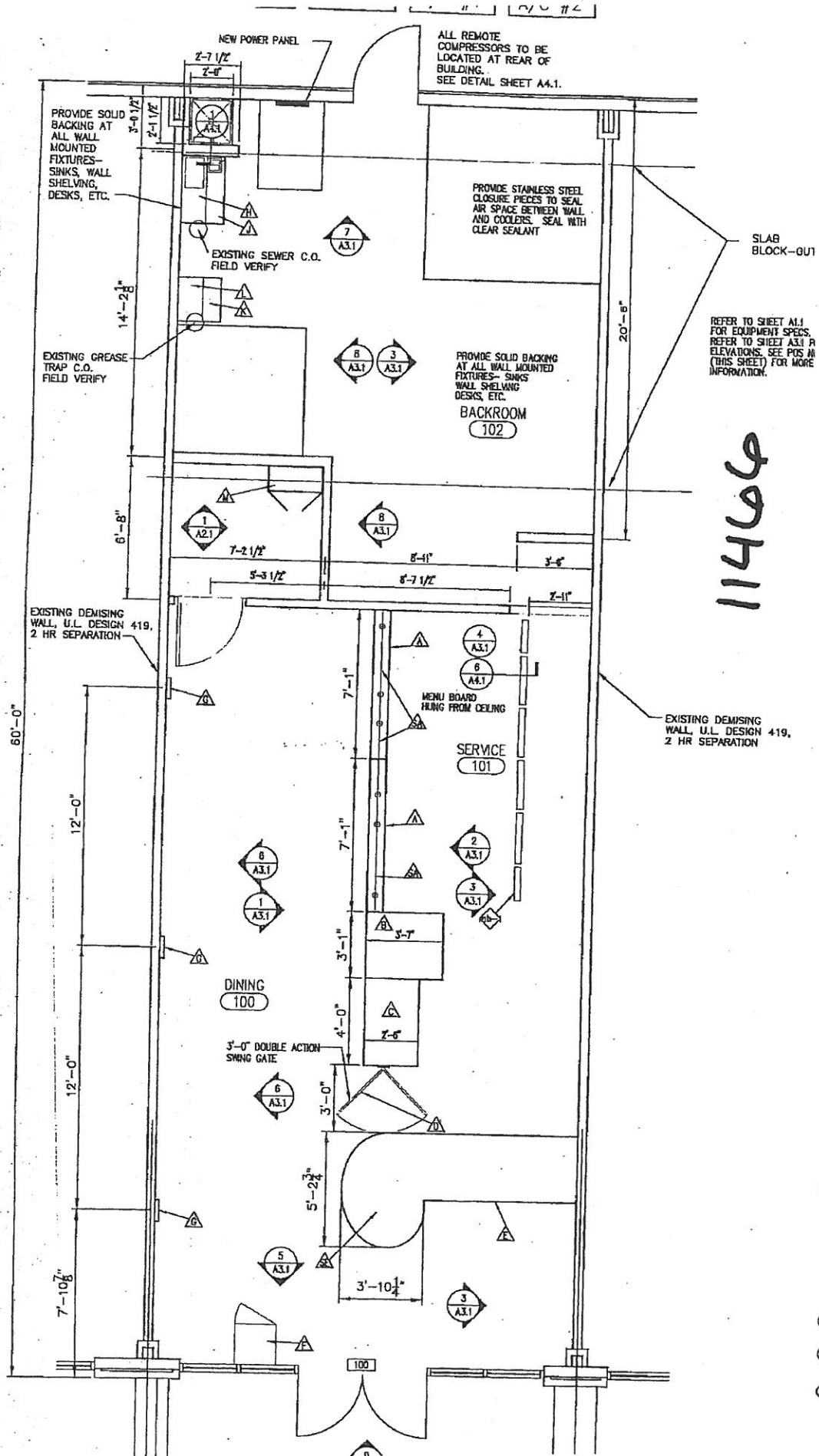

114668

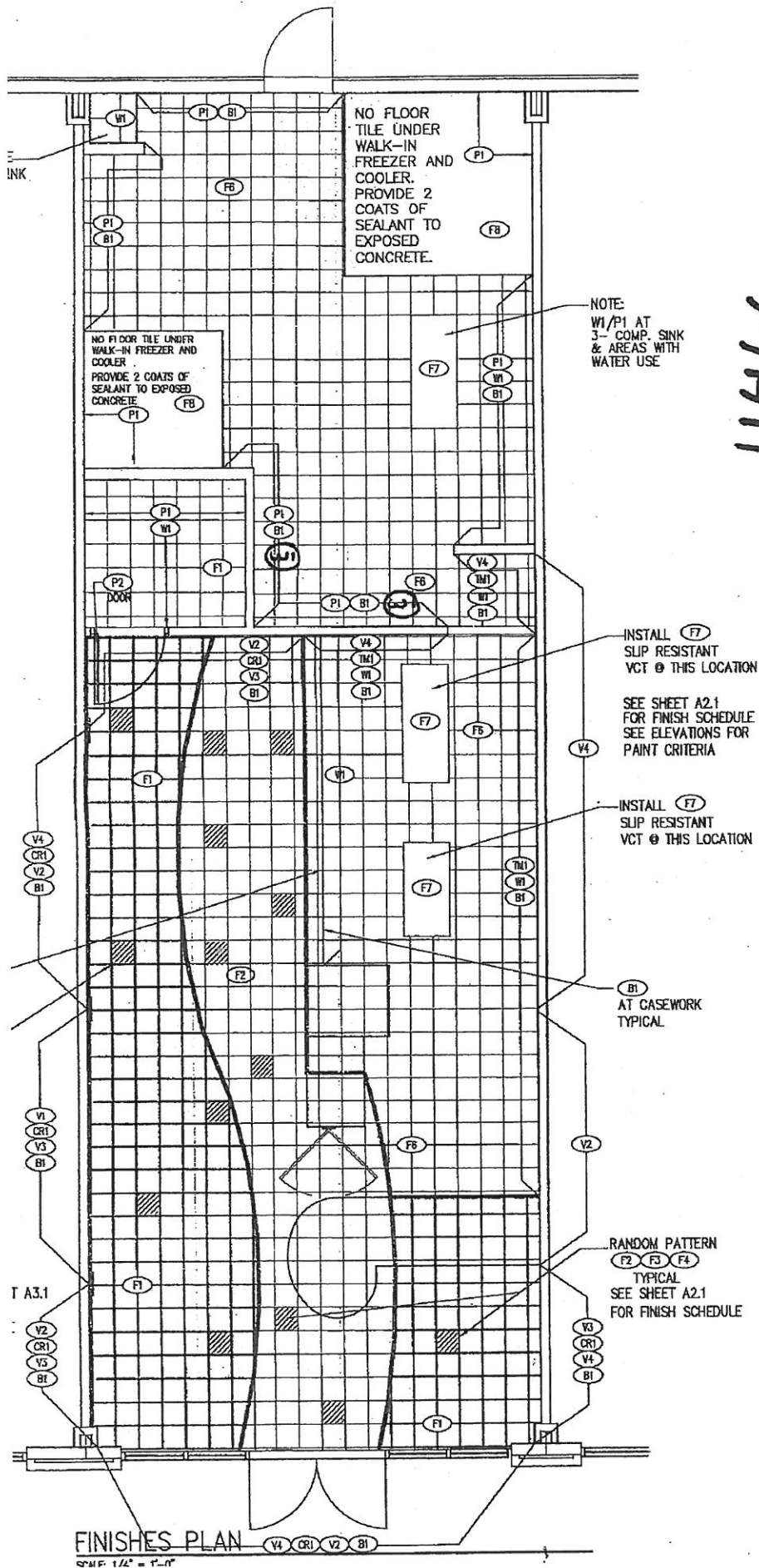

11466

CEILING
QUIZNC
17002
BATON

QUIZNOS #11466

DAMMON ENGINEERING, INC.

1095 FLORIDA AVENUE 985-649-5882 SLIDELL, LA. 70458

SCALE: AS NOTE

FILE:

JOB NO. 1803

DATE: 09-25-0

11460

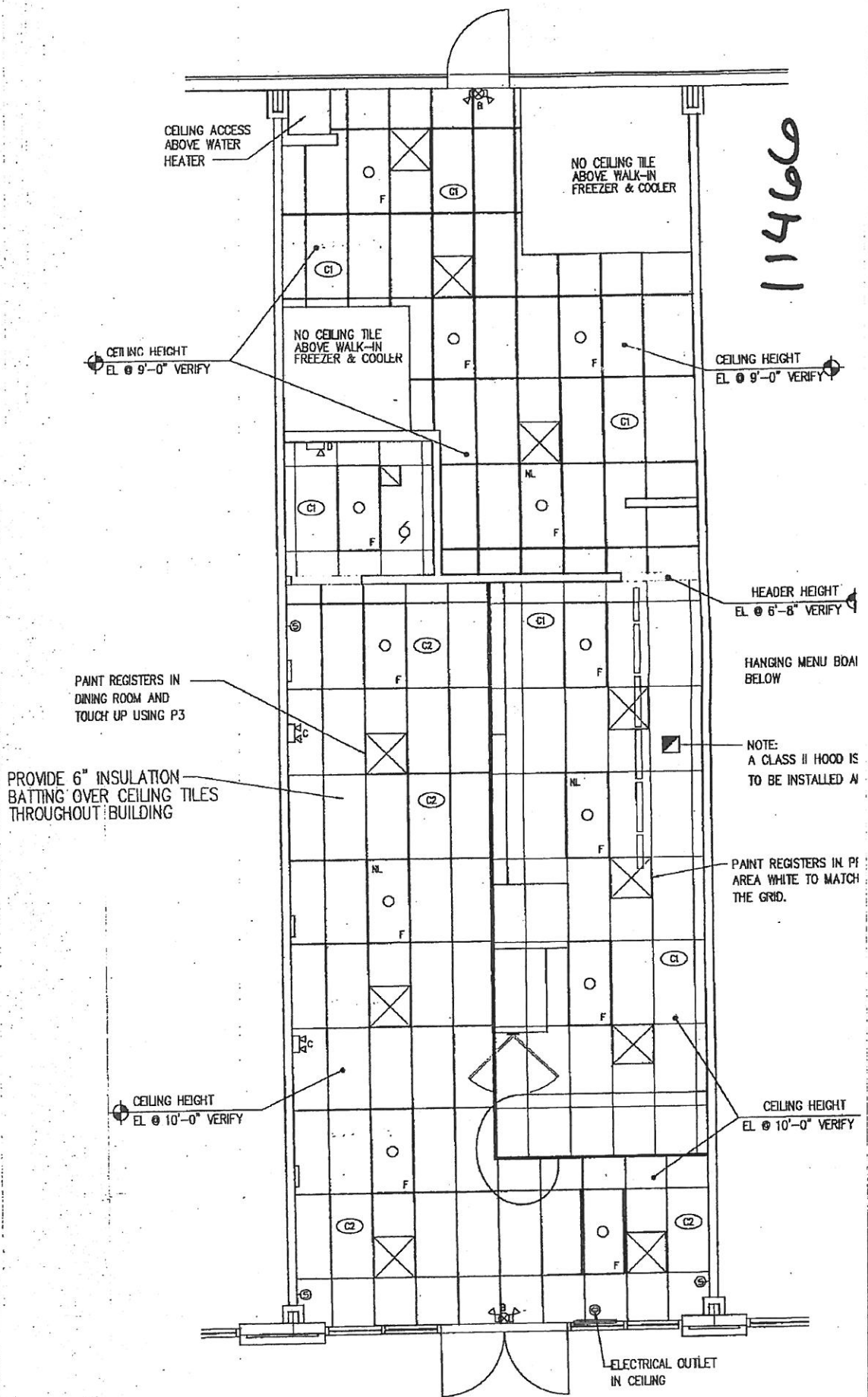

CEILING PLAN