

HIBACHI TABLE

TGU-08 / TGUZ-08 / TGU-10 / TGUZ-10



CLEANING MANUAL

CUSTOMER'S GUIDE



Roaster Tech. Inc.

OFFICE
493 ASHFORD AVENUE, OFFICE #2
ARDSLEY, NY 10502
TEL: 914.693.0936
FAX: 914.693.0524
WEBSITE: www.roastertech.com
EMAIL: info@roastertech.com

FACTORY
352 MORGAN AVENUE
BROOKLYN, NY 11211
TEL: 718.599.2747
FAX: 718.599.0235

Introduction

This manual is designed to serve as a guide for our customer in the cleaning and maintenance of our SMOKELESS HIBACHI TABLE.

We understand the importance of maintaining a clean HIBACHI TABLE is necessary to ensure safe food preparation.

By regularly cleaning and maintaining the SMOKELESS HIBACHI TABLE, you can reduce your utility expense.

CONTENTS

-HIBACHI TABLE Parts List 1-3

-Daily CLEANING 4-8

GUTTER / TABLE TOP / GRIDDLE / INNER COVER

SIDE ARM / PUSH AIR BAR / EXH.BAR

-Twice a Month CLEANING 9-15

C-Box / Grease Filter / Oil Pan / Exhaust Unit

Blower Air Filter

-Twice a Year CLEANING 16-20

Exhaust Duct

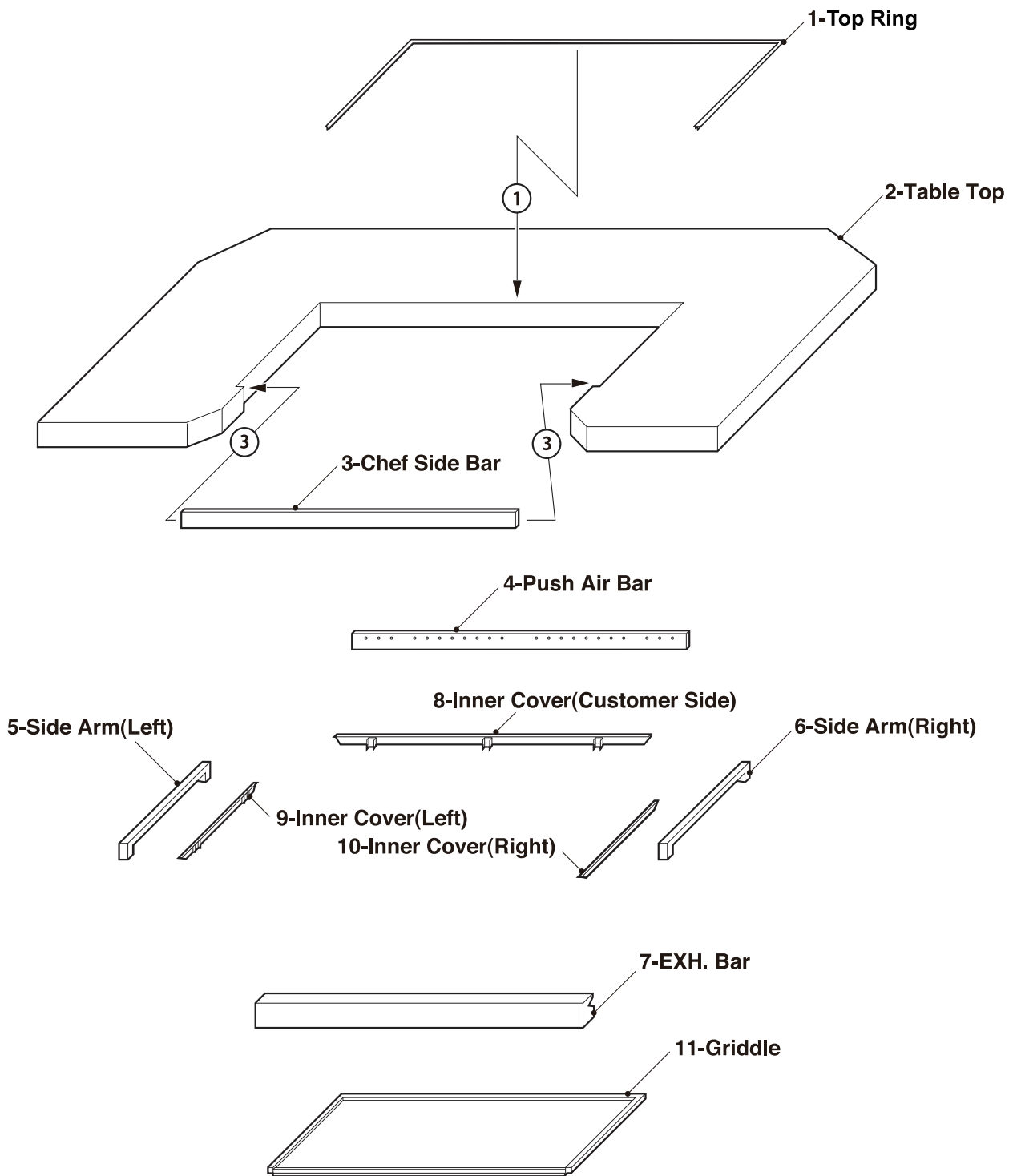

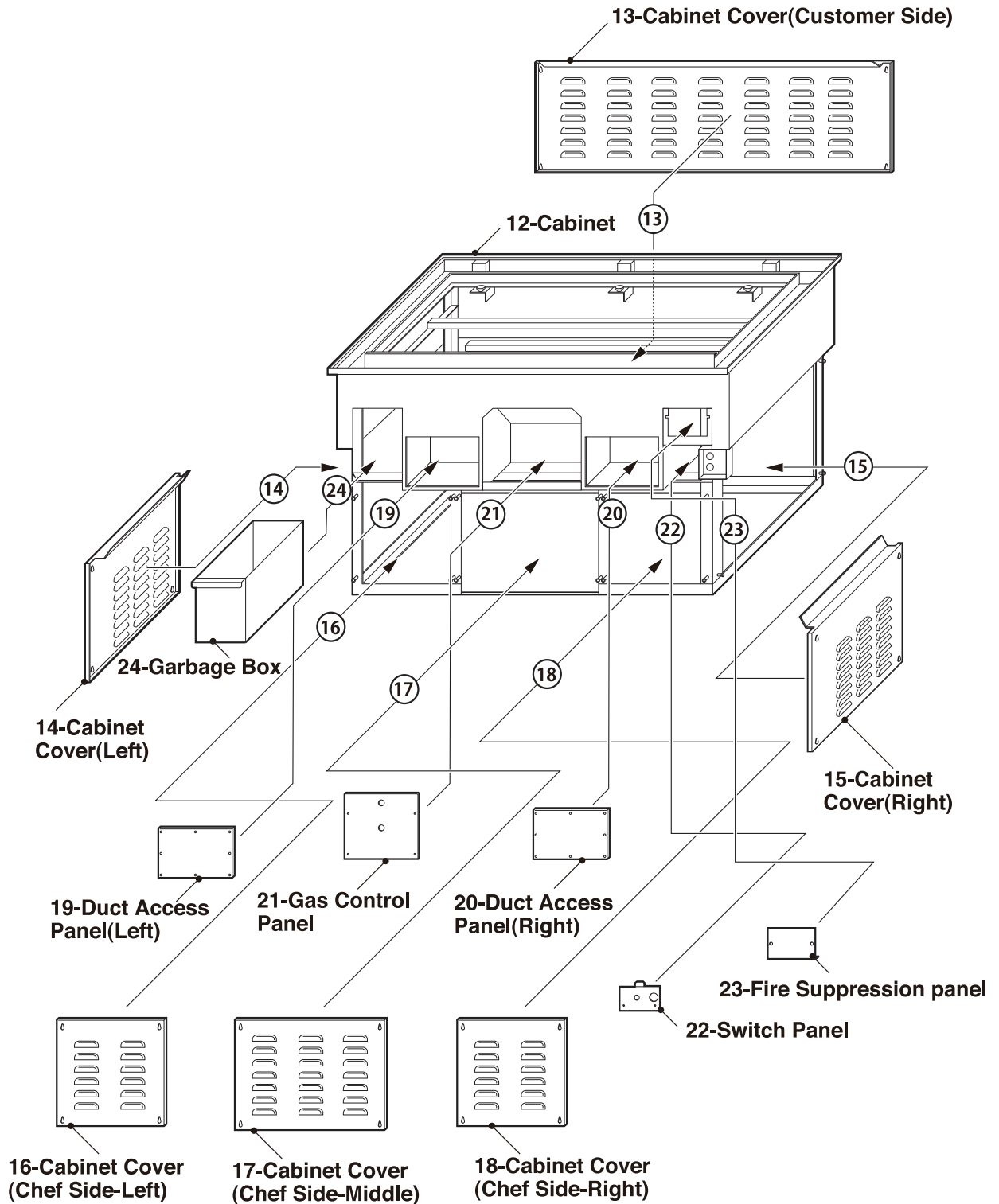

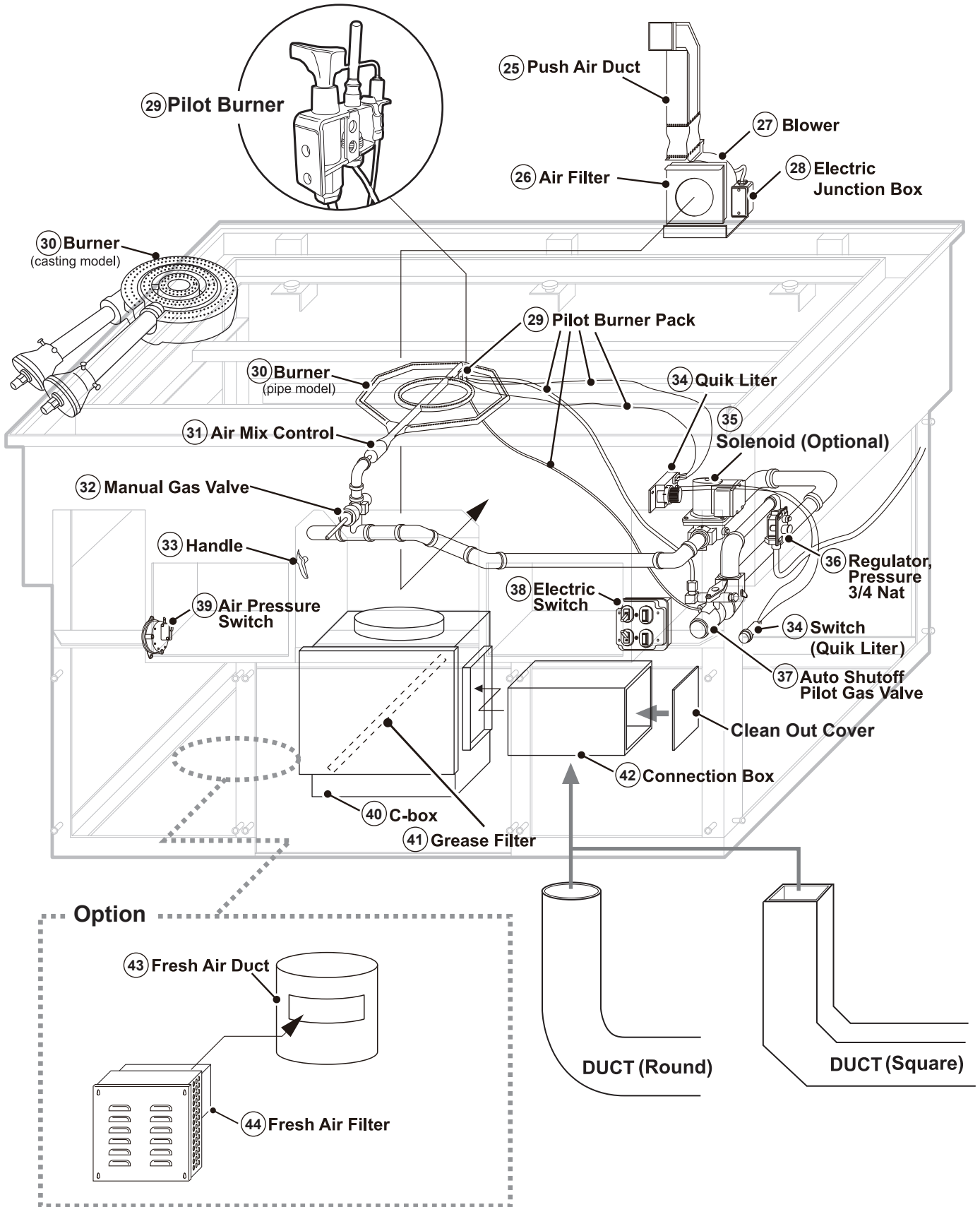

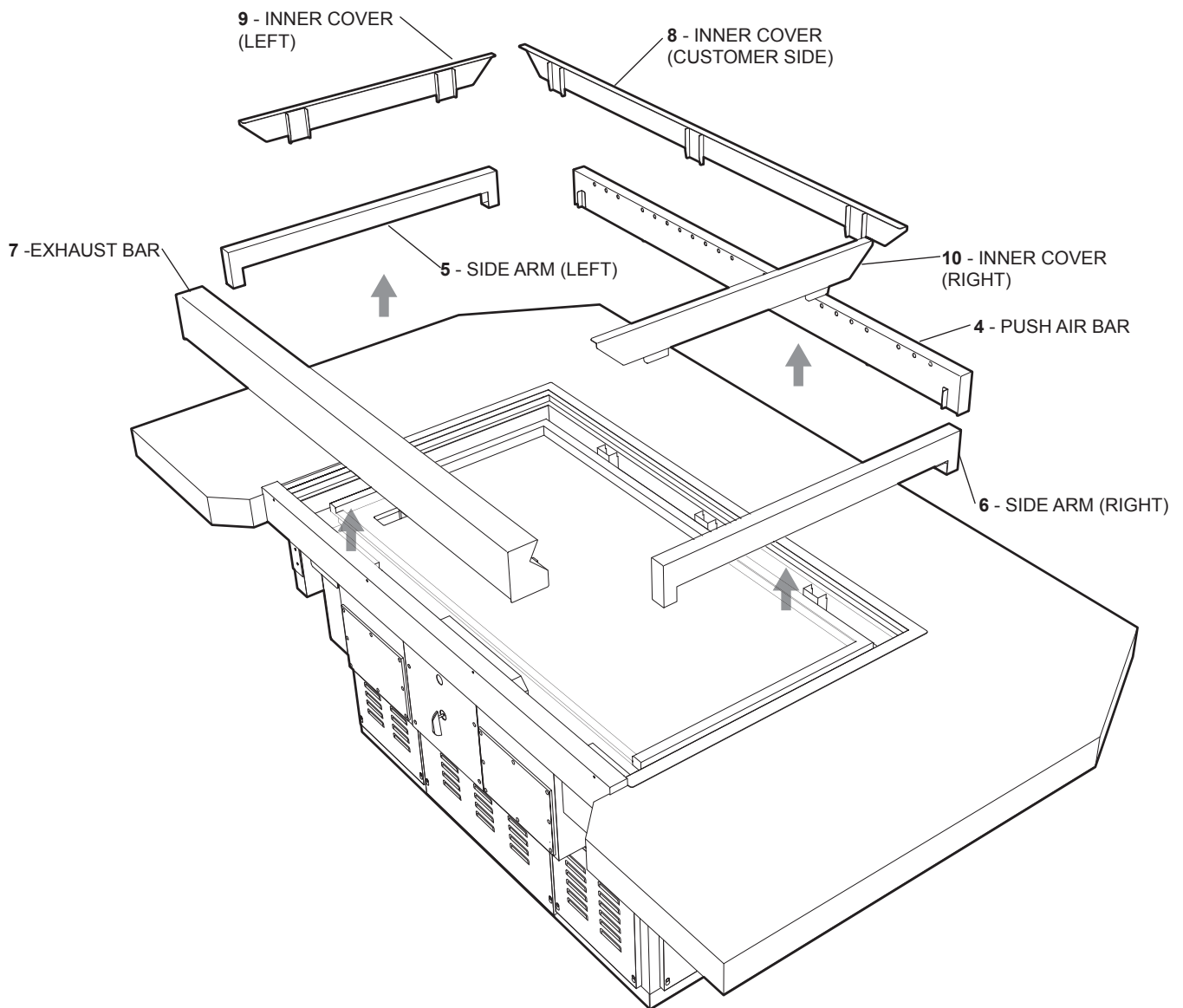

CLEANING THE ACCESSORIES

1. Please remove all the parts as shown on the above illustration.
2. Cleaning tools to use
 - a. Wet cleaning cloth or sponge
 - b. Coconut Oil (see page 8)
3. Spray the coconut oil on each of the parts and wipe it thoroughly clean.
4. After cleaning each of the parts, put them aside and clean the gutters (see page 6)

How to insert and remove the inner covers (8-customer side, 9-left side & 10-right side)

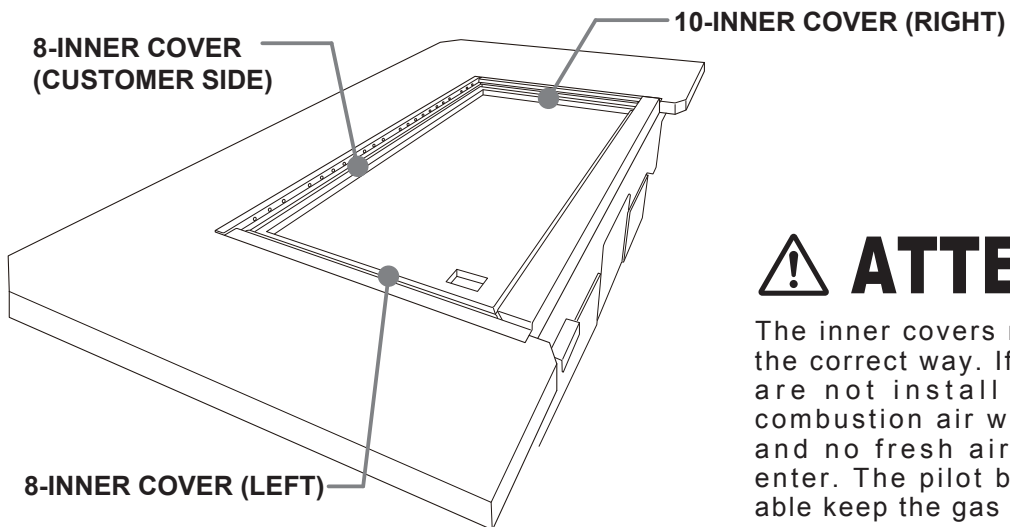
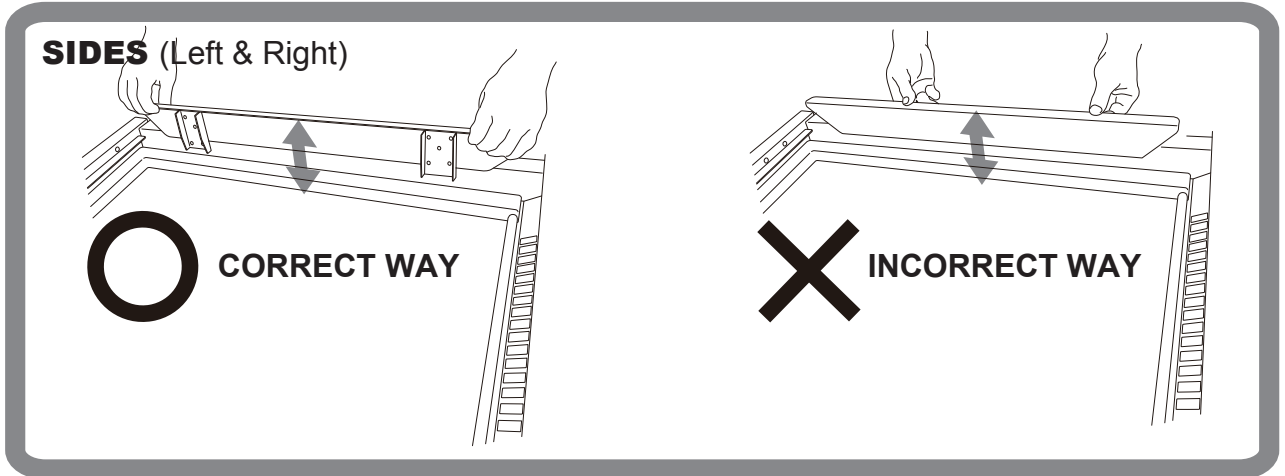

⚠ ATTENTION!

The inner covers must be install in the correct way. If the inner covers are not install correctly, the combustion air will be trap inside and no fresh air will be able to enter. The pilot burner will not be able keep the gas flame on for long.

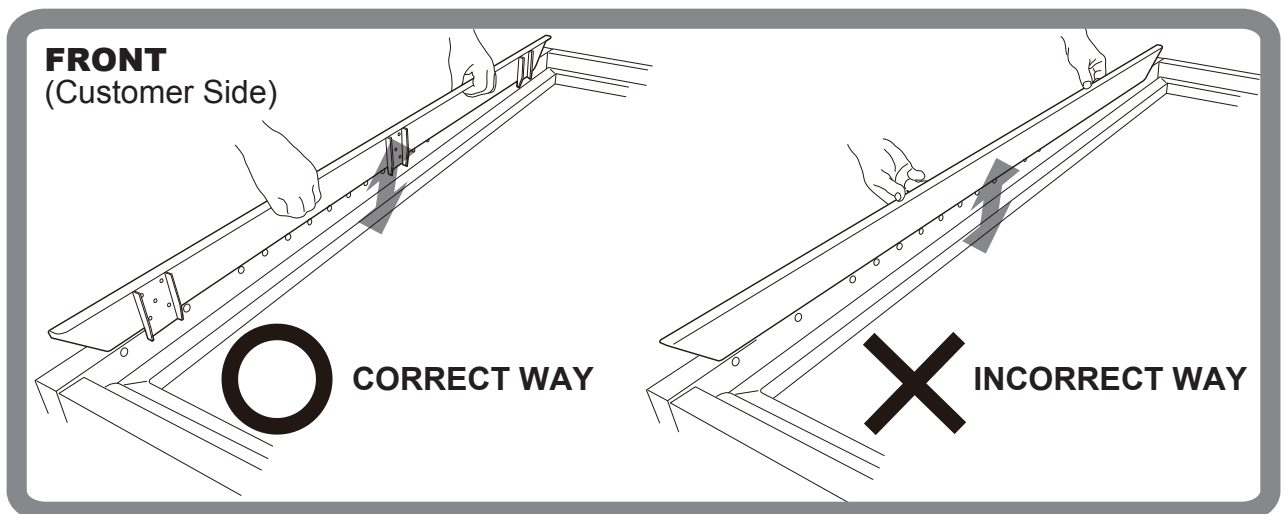

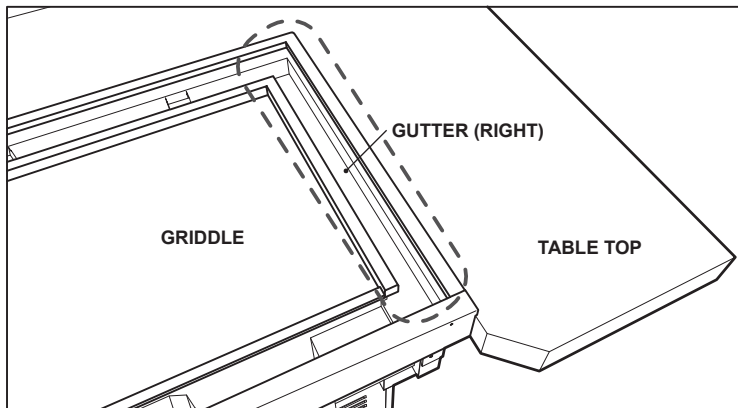
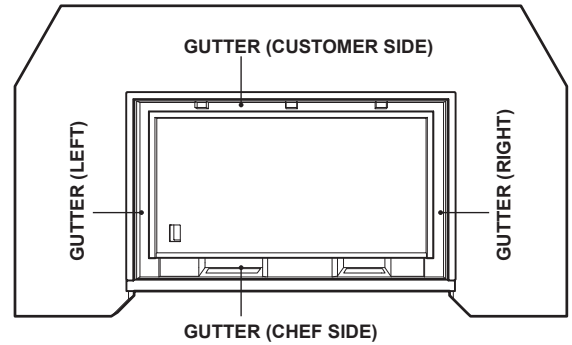
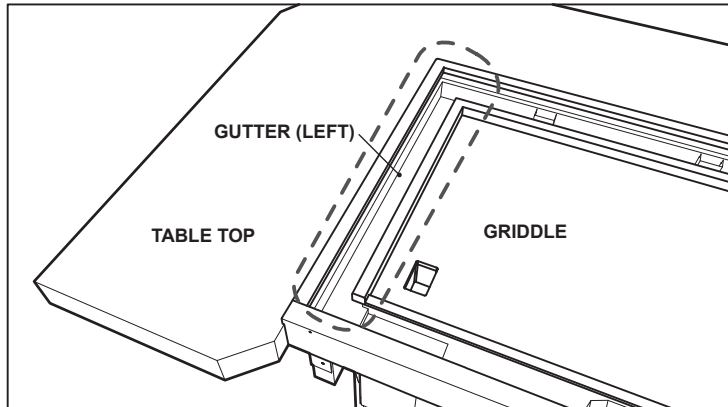

CLEANING THE GUTTERS

1. Spray the coconut oil all around the gutters.
2. Wait around 5 to 10 minutes for the grease to break down.
3. Use a wet cleaning cloth or sponge to wipe away the grease from the gutter.
4. If you have trouble wiping some of the grease, use a scraper to remove it.
5. Spray the coconut oil on the griddle.

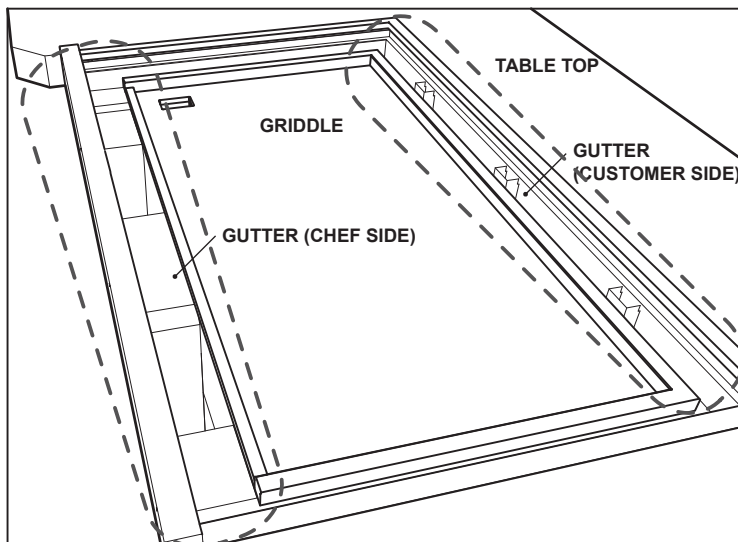

CLEANING THE GRIDDLE

1. Spray the coconut oil all around the griddle.
2. Wait around 5 to 10 minutes for the grease to break down.
3. Use a wet cleaning cloth or sponge to wipe away the grease from the griddle.
4. If you have trouble wiping some of the grease, use a scraper to remove it.

Spraying the coconut oil and wiping with a cleaning cloth.



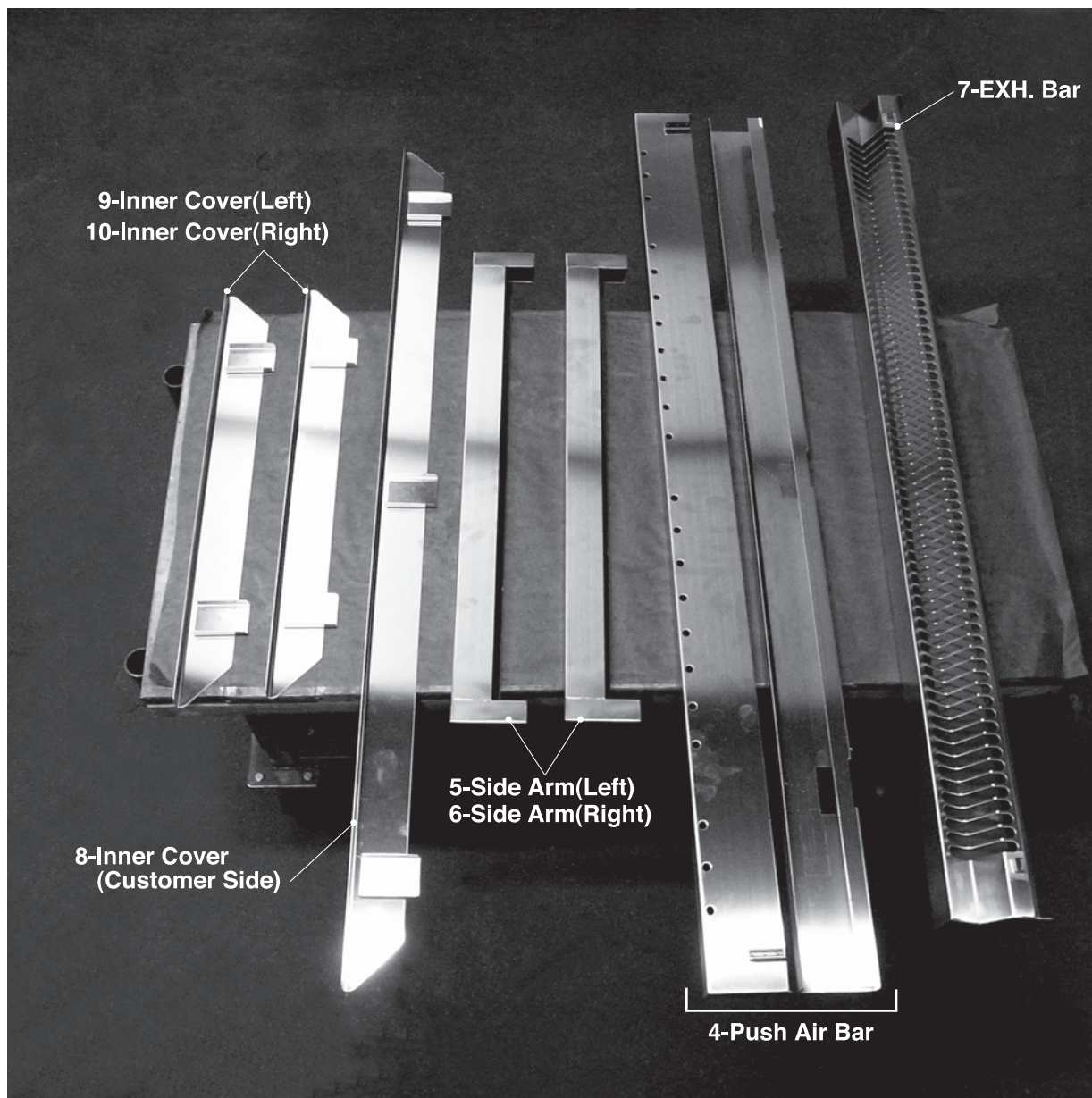

The coconuts oil information

We recomend the below cleaning product:



Company:VIGON INTERNATIONAL
Product:Delytl Extra Isopropyl Myristate
Viogon Number:D-001995
<http://www.viogoninternational.com>



1. Please remove the Cabinet Cover (Chef Side-Middle) like below:

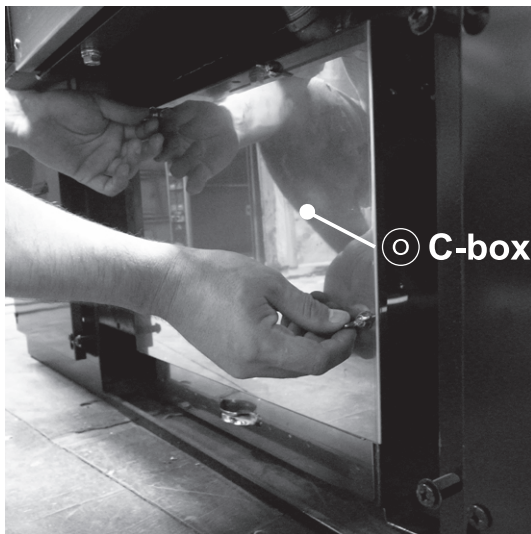
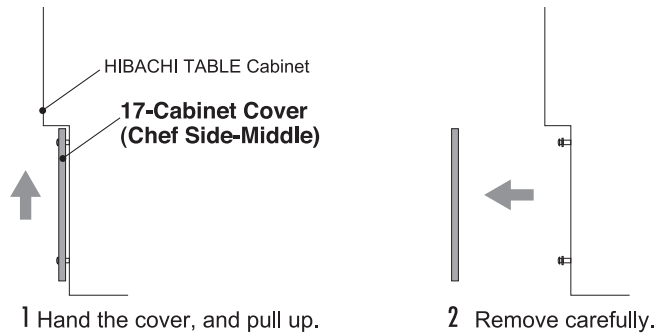

2. Remove the C-box cover like below.
Remove the wingnuts, then pull out the C-box cover.

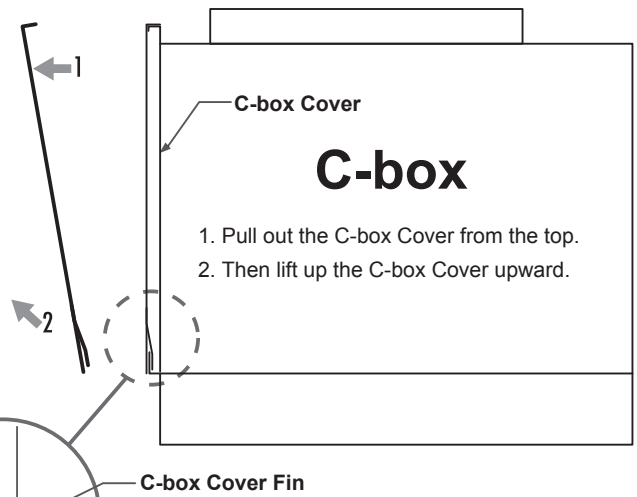
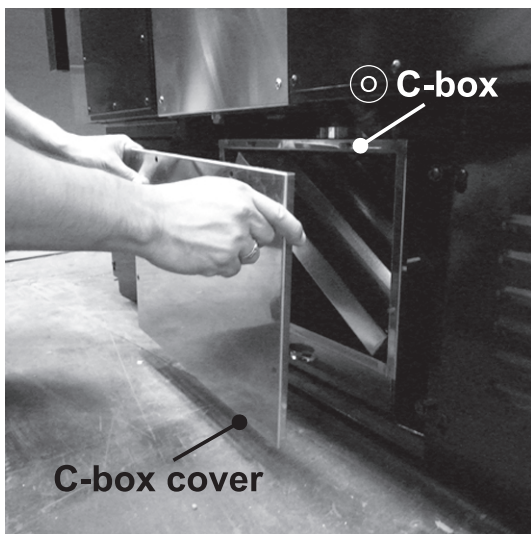
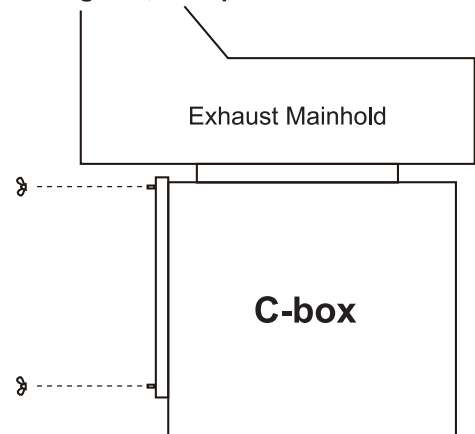

Please make sure the **FIN** is inserted over this edge when putting the **C-box Cover** back onto the **C-box**.

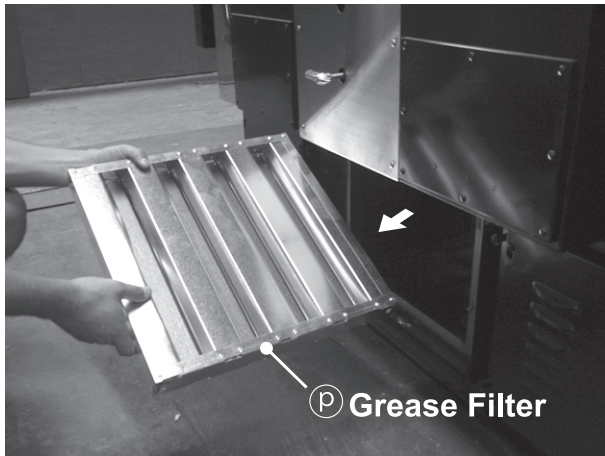

3. Please take out the Grease Filter and Oil Pan.



4. Spray the chemical to remove the grease in the C-box, and wipe out.

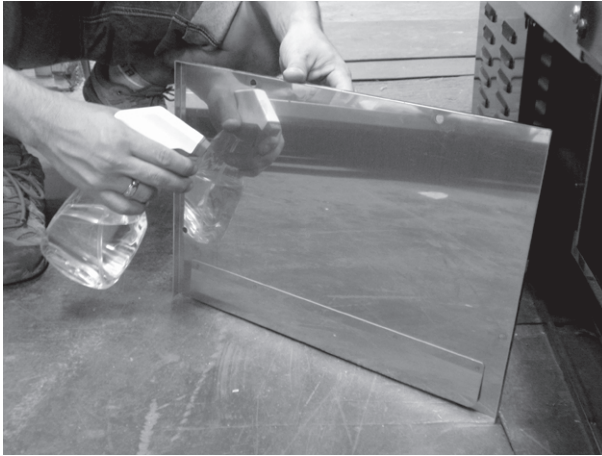

4.Spray the chemical to remove the grease on the C-box cover, and wipe it with a cleaning cloth.

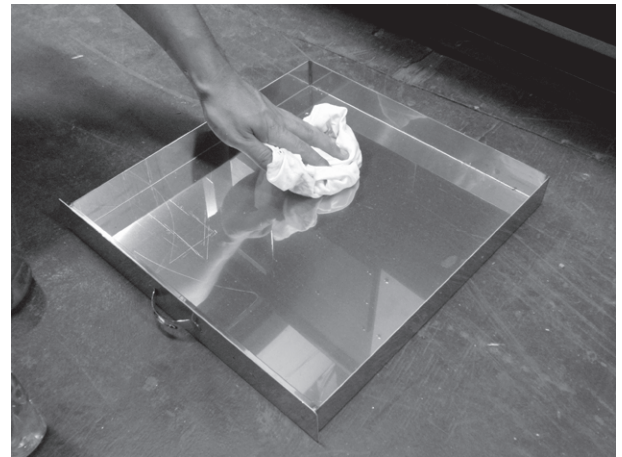
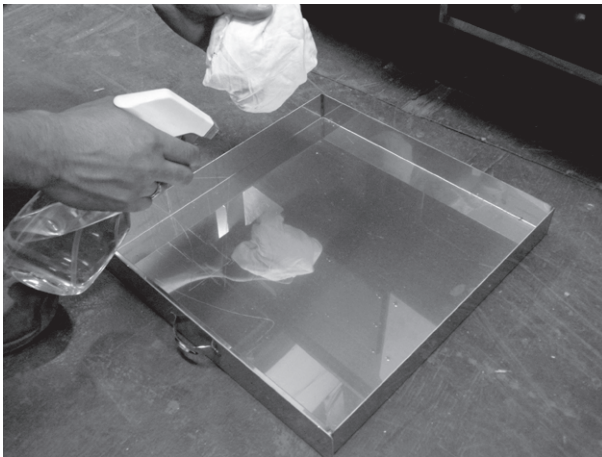

5.Spray the chemical to remove the grease in the Oil Pan, and wipe it with a cleaning cloth.

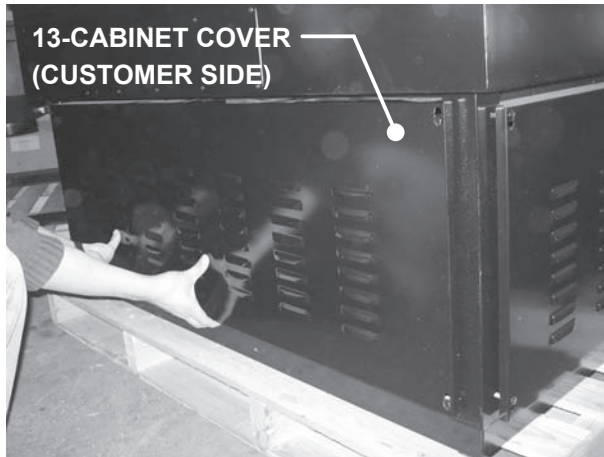

1. Push up from the bottom and pull out the cabinet cover to remove.

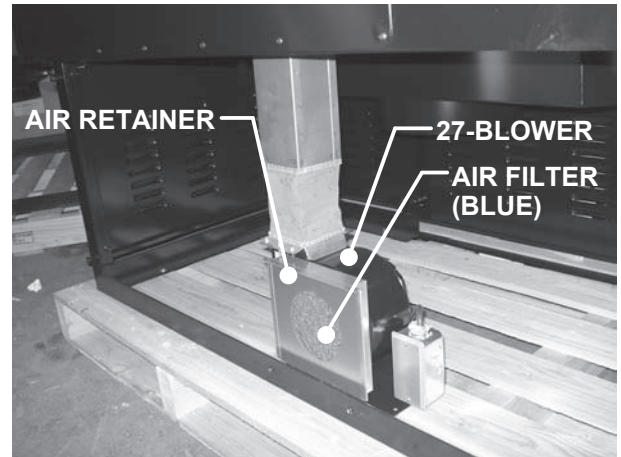

2. The blower is located at the center.

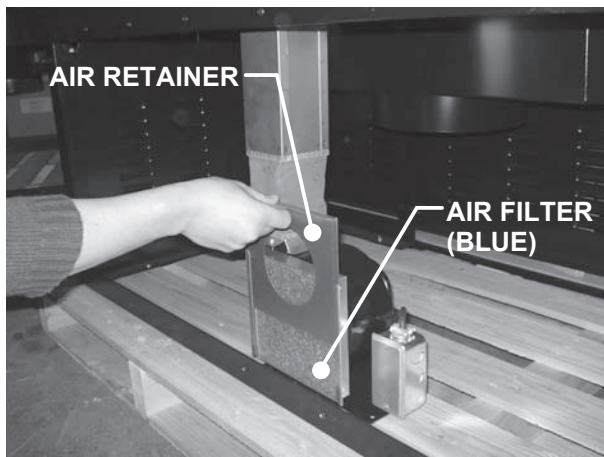

3. Remove the air retainer by pulling it up.

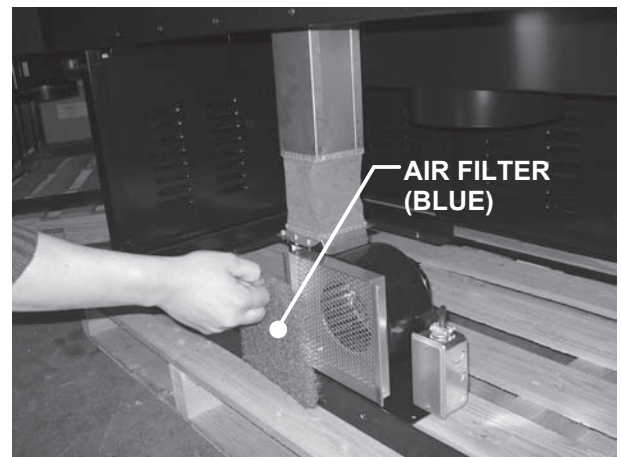

4. Remove the air filter and replace it with a new one.

We recommend using air filter from
FLANDERS PRECISIONAIRE
SM100S 20x30x1 Latex NAT Filter

Flanders Corporation
531 Flanders Filters Road
Washington, NC 27889
<http://www.flanderscorp.com>

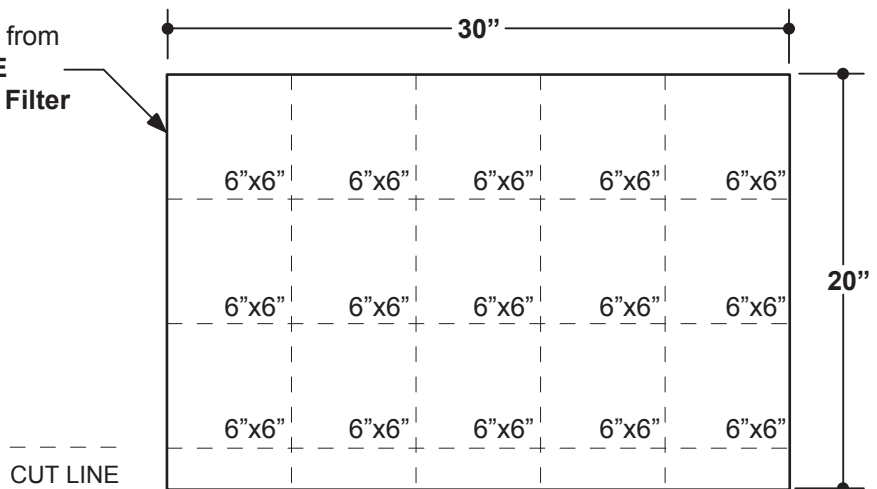

Please make sure the new air filter size is cut to 6"x6" or it will not fit properly.

ATTENTION!

WHEN YOU CLEAN IN THE C-BOX, PLEASE PAY ATTENTION TO THE PROBE.

Oil and grease may enter the probe opening. If the probe is block, the air pressure sensor signal the solenoid to prevent the gas supply passing through to the burner. It will release the gas once the probe is unclog of the oil and/or grease and the air pressure sensor can sense air from from the exhaust fan.

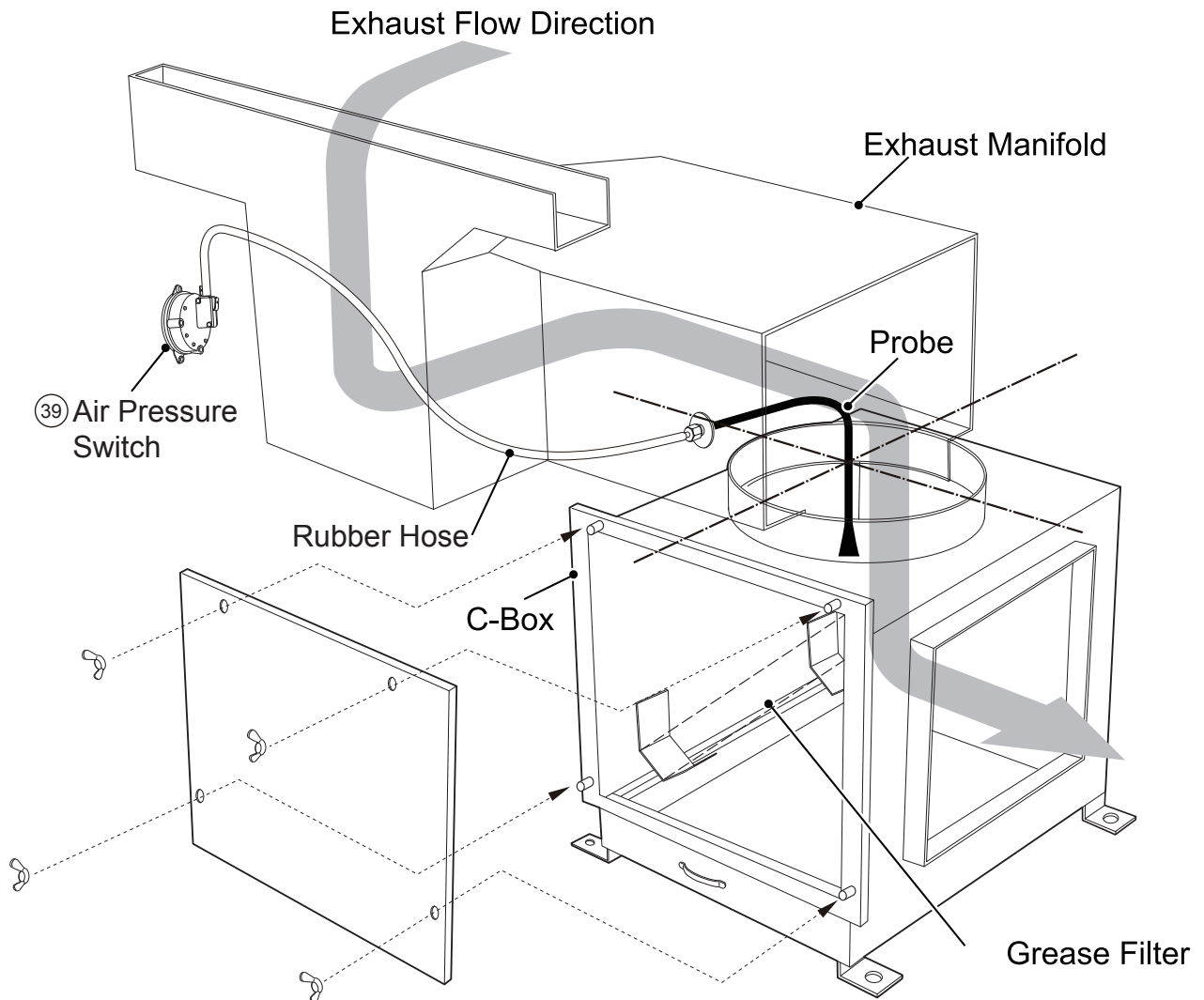

 THE PROBE MUST BE POSITION STRAIGHT DOWNWARD.

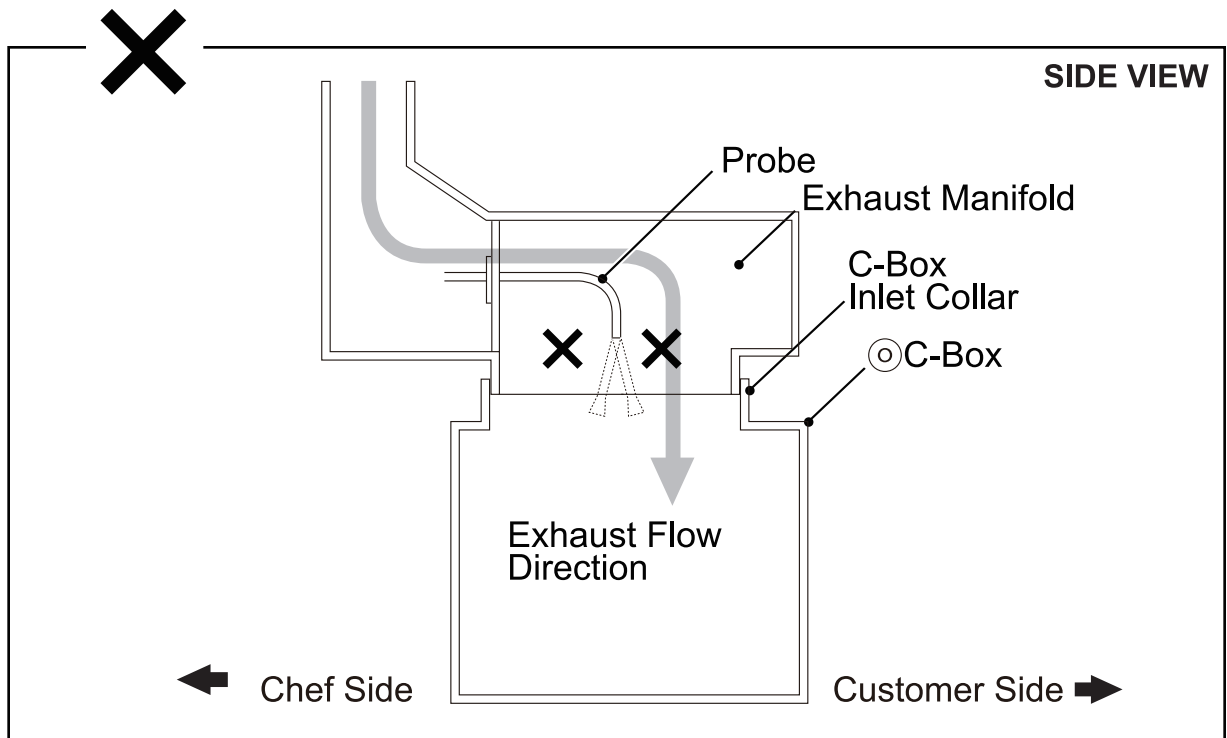
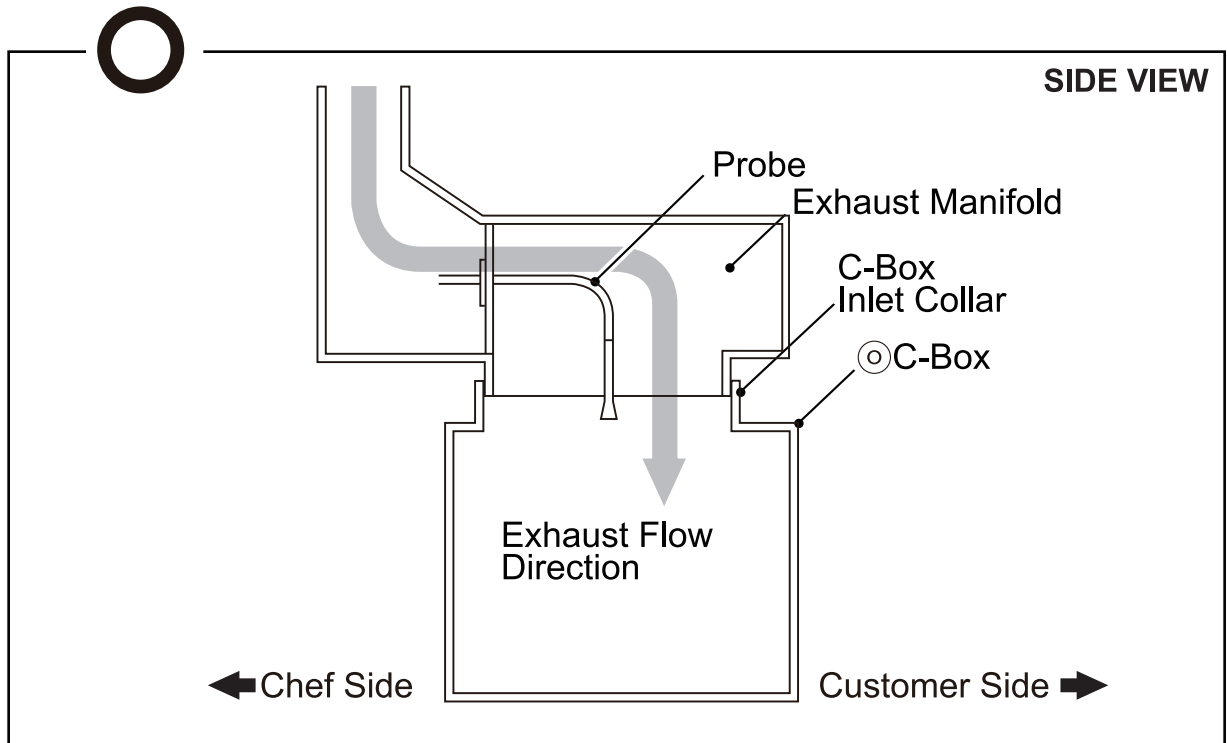



THE PROBE MUST BE POSITION STRAIGHT DOWNWARD.

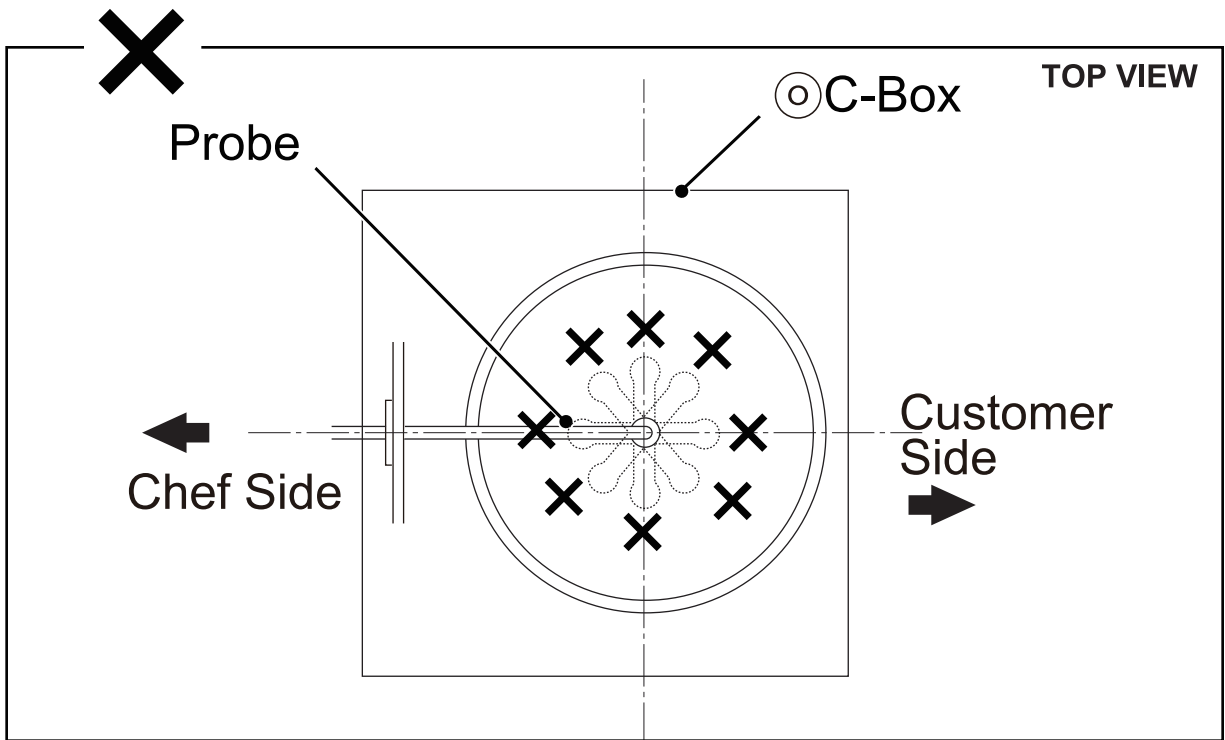
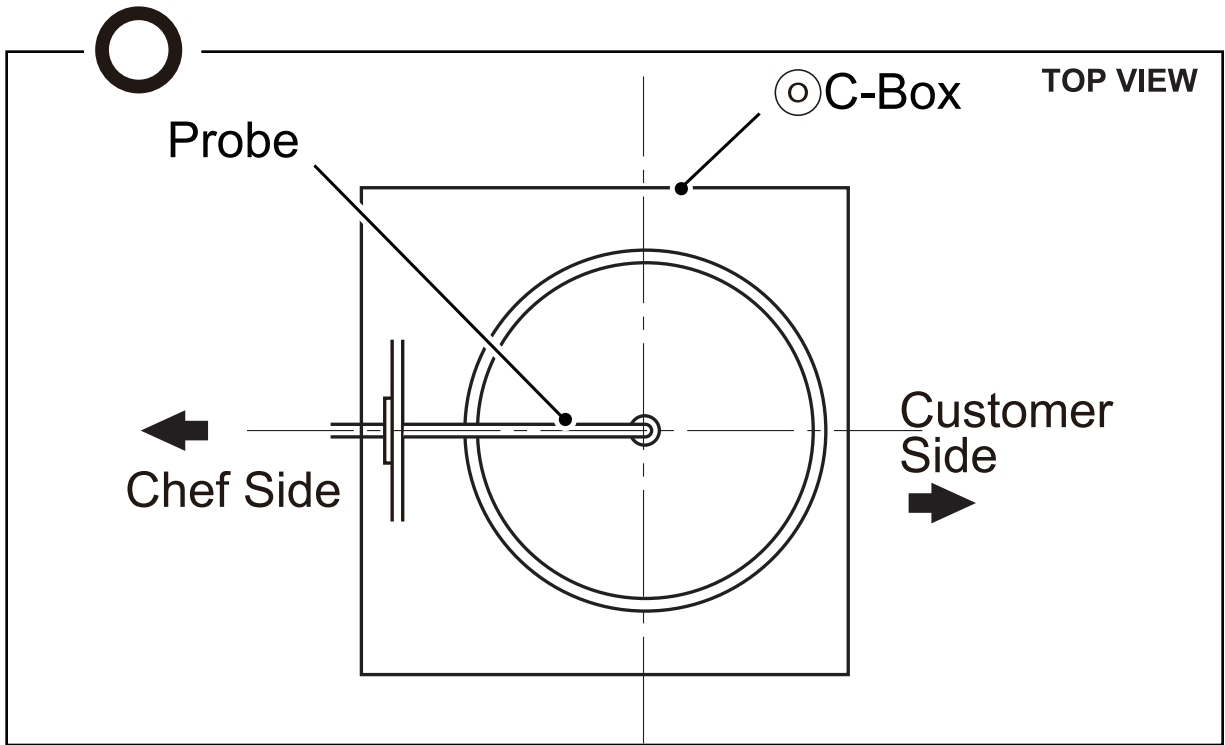

! ATTENTION!

If the exhaust manifold is not clean, the grease will build up and will block the exhaust air flow. This will result in the low exhaust air flow and combustion air will be trap inside and no fresh air will be able to enter. The pilot burner will not be able to keep the burner on for long.

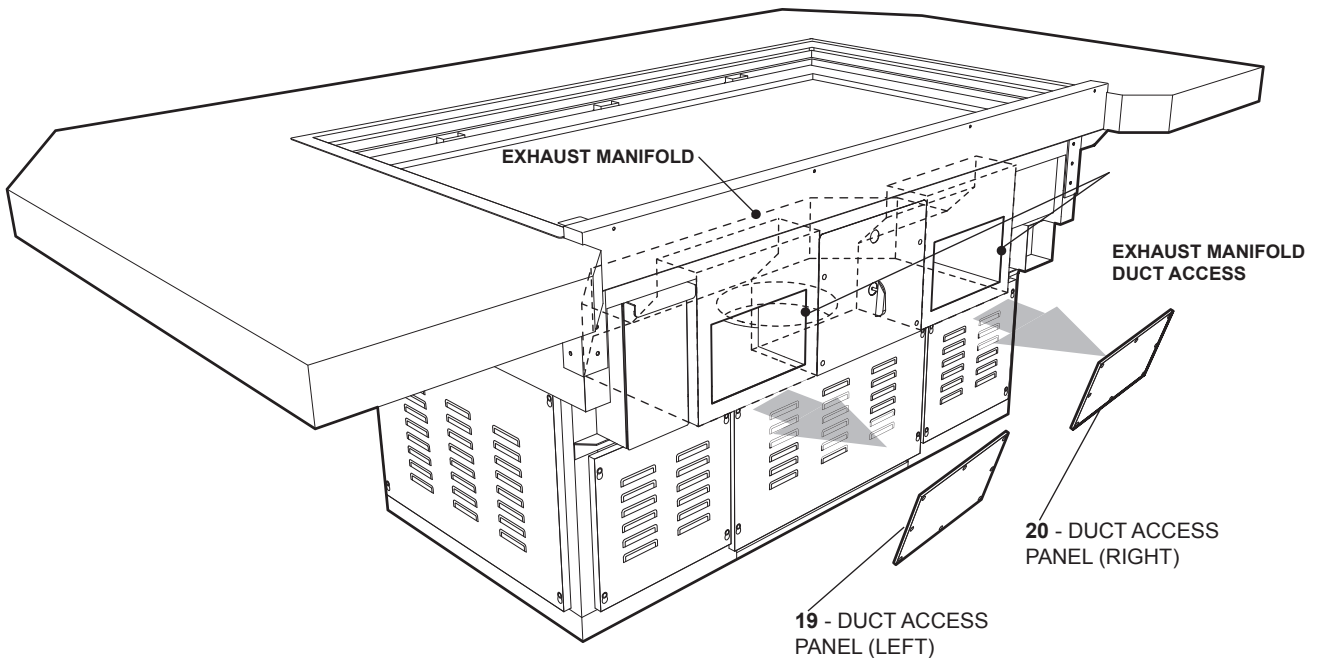

CLEANING THE EXHAUST MANIFOLD

1. Remove the Duct Access Panels.
2. Spray the coconut oil into the exhaust manifold through the duct access openings.
3. Wait around 5 to 10 minutes for the grease to break down.
4. Use a wet cleaning cloth or sponge to wipe away the grease from the exhaust manifold.
5. If you have trouble wiping some of the grease, use a scraper to remove it.



WATER PITCH DUCT

2~3hr STAY WATER WITH GREASE CUTTER
AFTER WET VACUUM SOAK UP.

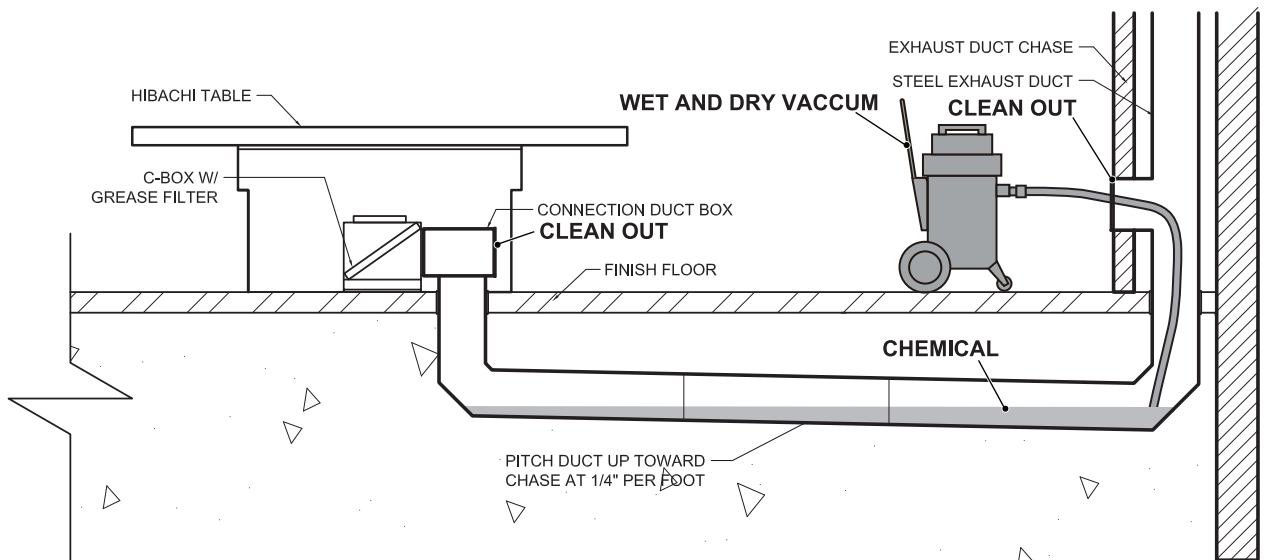
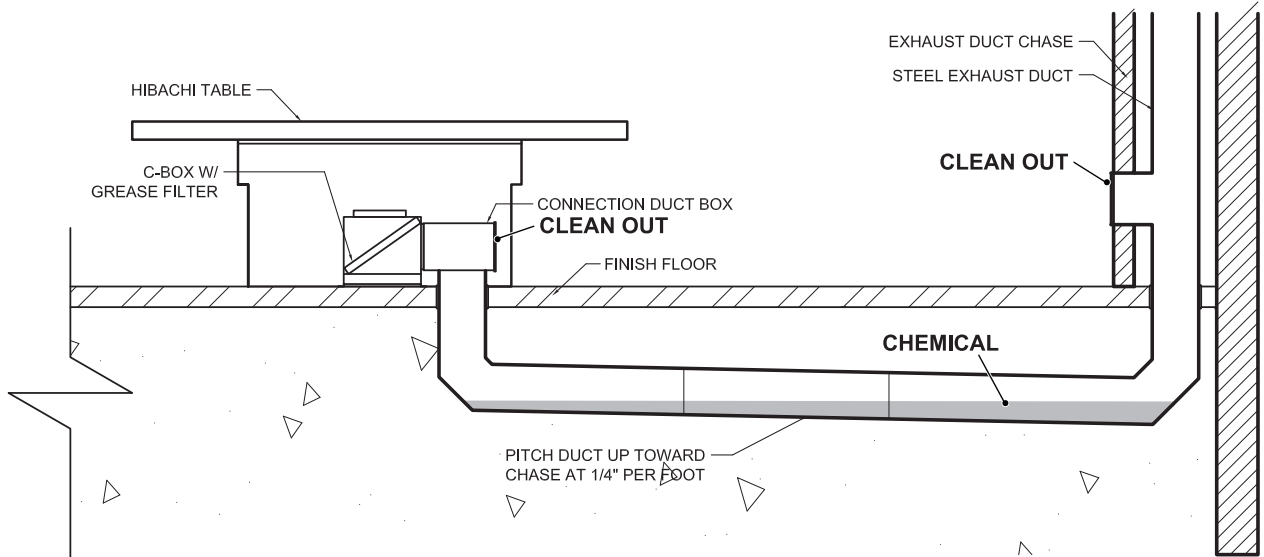

NO WATER PITCH DUCT

**2~3hr STAY WATER WITH GREASE CUTTER
AFTER WET VACUUM SOAK UP.**

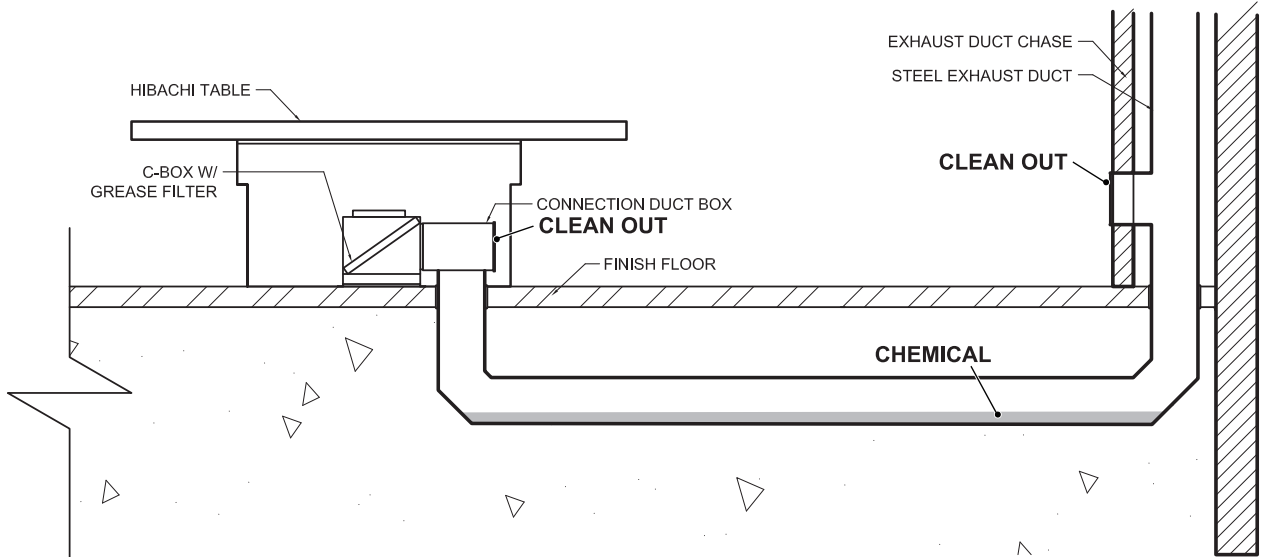

**IN CASE, IF YOUR HIBACHI TABLE DON'T HAVE THE
CLEANOUT ON THE CONNECTION DUCT BOX, PLEASE
PUT THE NOZZLE OF THE WET VACUUM FROM C-BOX.**

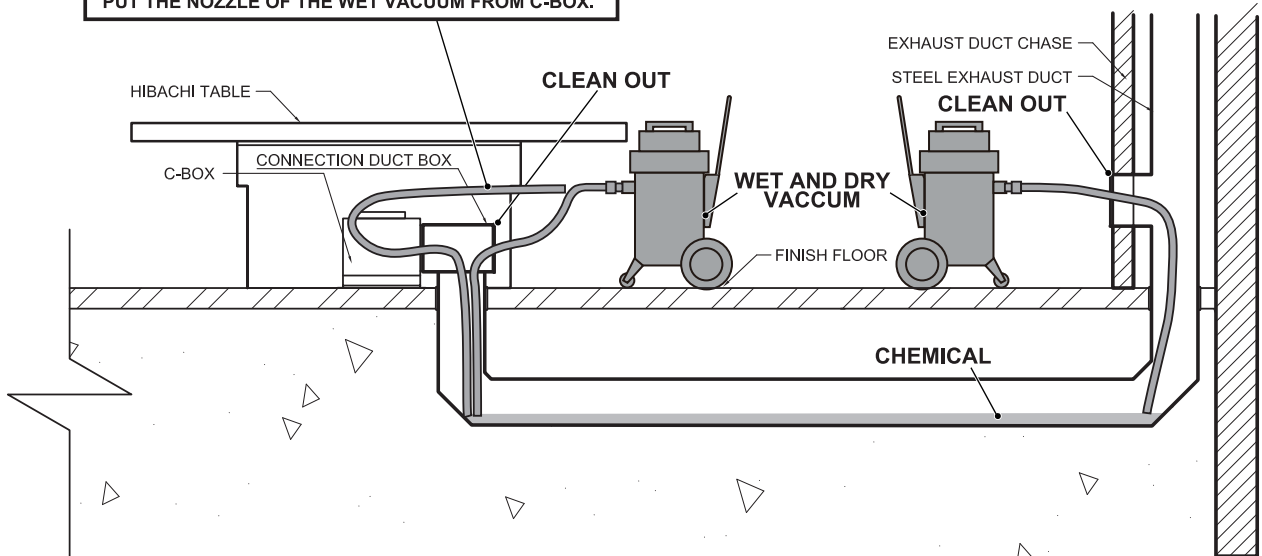

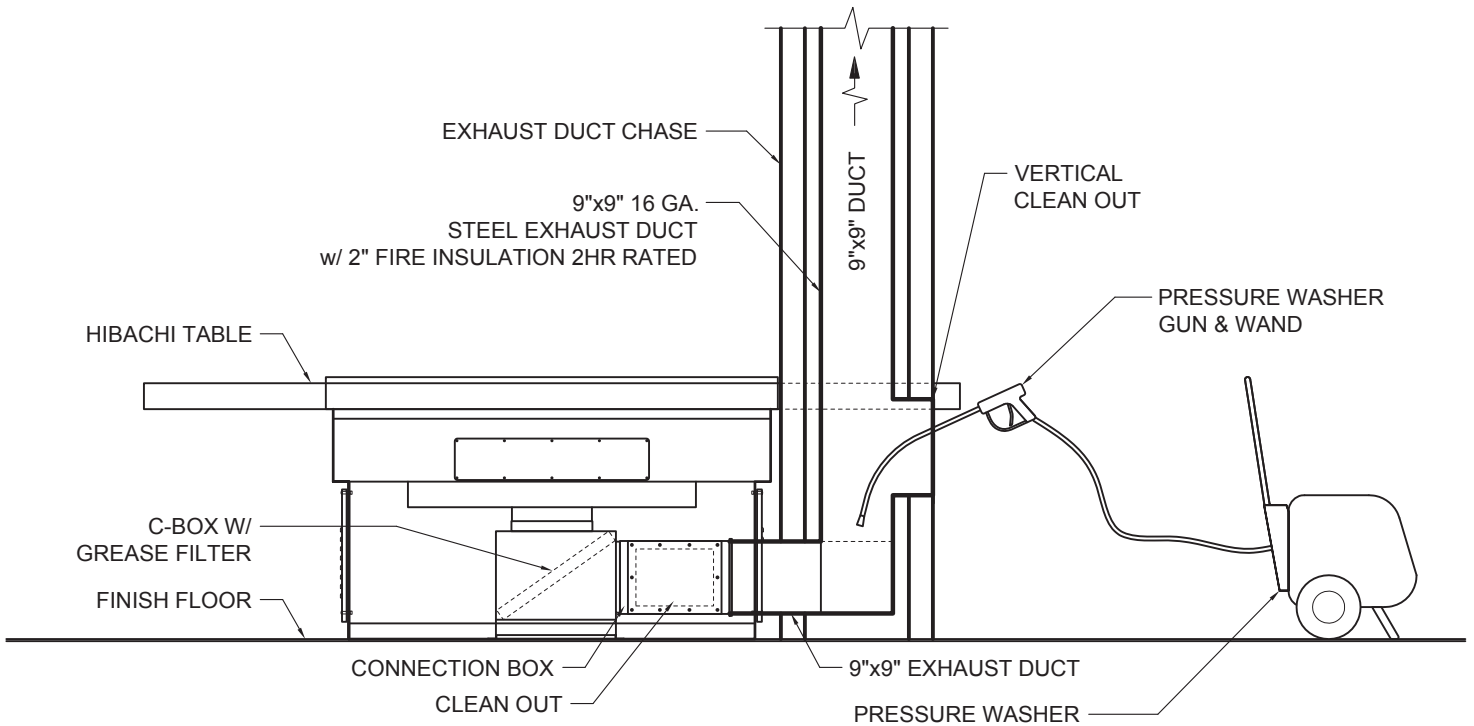

1. Open the vertical cleanout cover from the duct chase
2. Use a pressure washer to wash the inside of the duct.
3. Then use a wet/dry vacuum to clean up the water and grease.
4. Close the vertical cleanout and repeat step 1-3 with the other cleanouts.

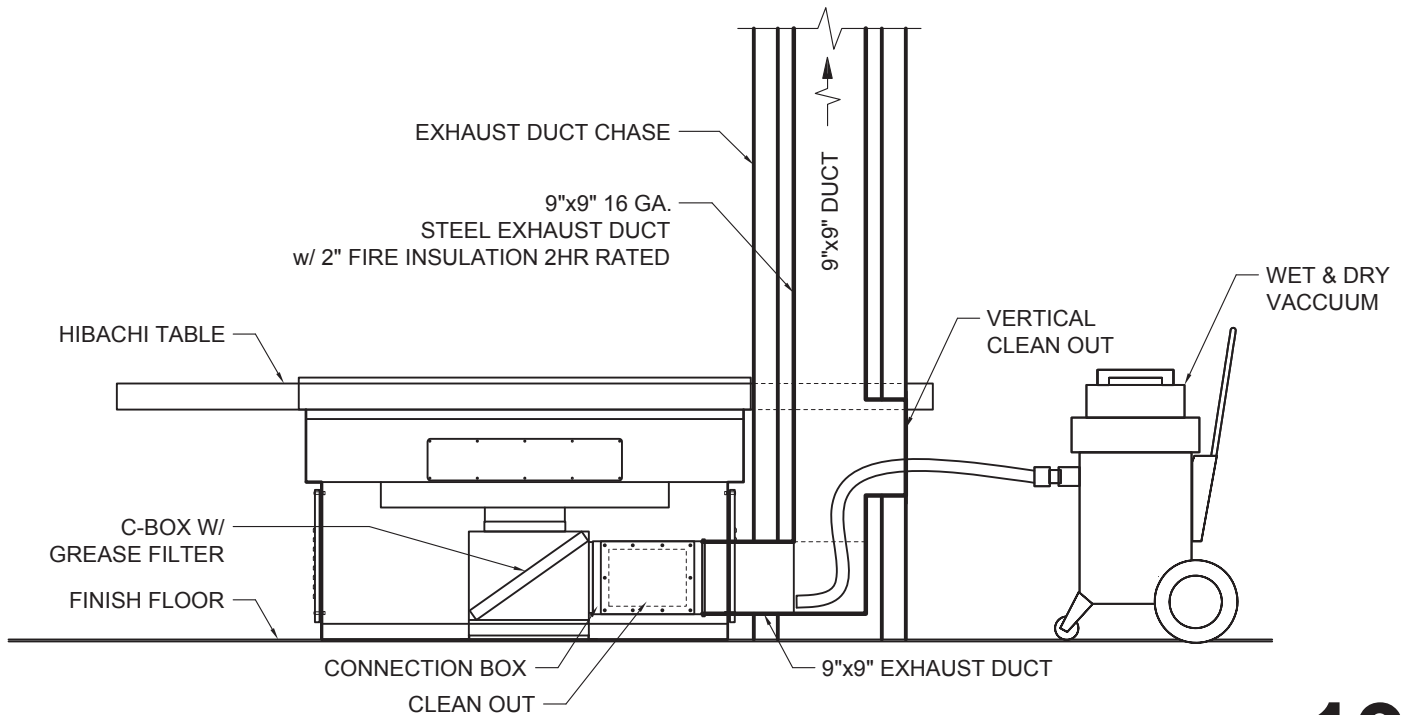

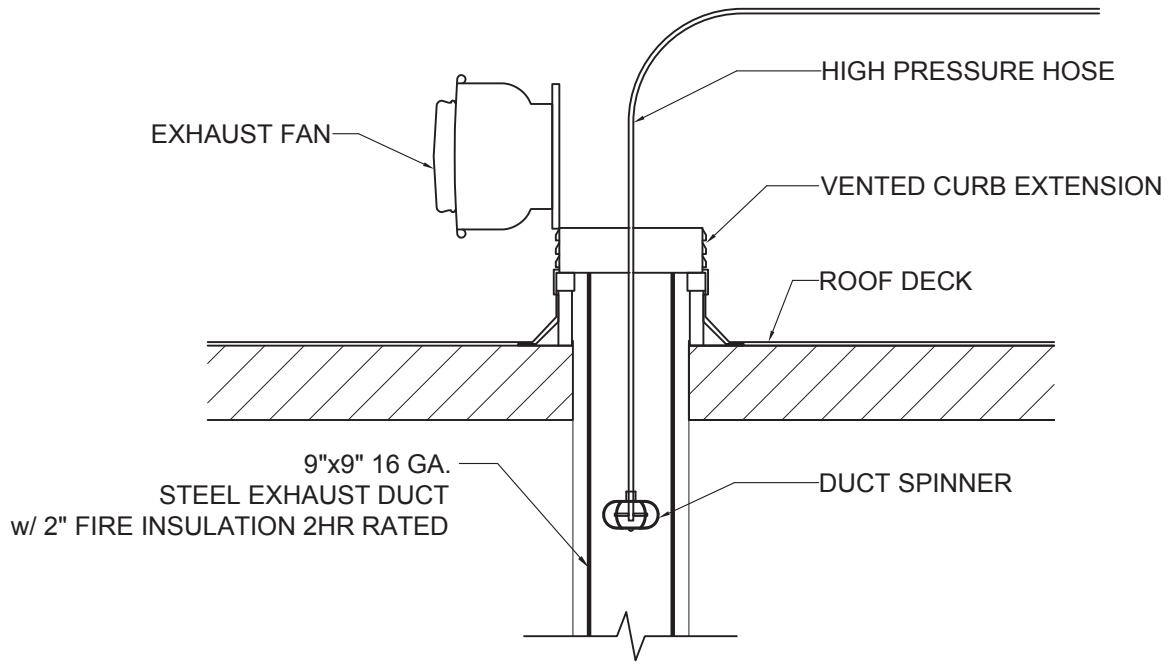

1. Attached the duct spinner to a high pressure hose using a pressure washer.
2. Open the Exhaust Fan top.
3. Lower the duct spinner down to the exhaust duct to clean.
The duct spinner will clean the vertical exhaust duct with a rotating nozzle.