

**ROOM LEGEND**

UNIT A - 1ST FLOOR	
ROOM NO.	ROOM NAME
1011	SPECIAL NEEDS CLASSROOM
1013	CHANGING ROOM
1013A	RESTROOM
1015	RECEPTION
1016	SPEECH
1017	PRINCIPAL (OFFICE C)
1018	OP/PT
1018A	STORAGE
1019	S.R.T.
1020	FACULTY LOUNGE
1021	CONFERENCE
1023	S.R.T.
1024	RESTROOM
1025	WOMEN
1026	OFFICE A
1027	MEN
1028	OFFICE A
1029	OFFICE A
1030	HEALTH CLINIC
1030A	NURSE'S OFFICE
1030B	RESTROOM
1030C	STORAGE
1031	CUSTODIAL
1033	BOYS RESTROOM
1035	GIRLS RESTROOM
1037A	SOUND
1037B	STORAGE
1037C	ELEVATOR EQUIPMENT
1047F	STORAGE
C1000	VESTIBULE
C1001	CORRIDOR
C1001A	CORRIDOR
C1001B	CORRIDOR
C1002	CORRIDOR
E1014	ELECTRICAL
M1020	MECHANICAL
M1022	MECHANICAL
S102	STAIR
T1012	TECHNOLOGY

**ROOM LEGEND**

UNIT C - 1ST FLOOR	
ROOM NO.	ROOM NAME
1037	STUDENT DINING COMMONS
1039	MAINTENANCE & REPAIR AREA
1039A	RESTROOM
1041	RECEIVING
1041A	OFF. A
1043	DISHWASHING
1045	SERVING
1047	KITCHEN
1047A	KIT. OFF.
1047B	LAUNDRY
1047C	COOLER
1047D	FREEZER
1047E	DRY STORAGE
1047G	LOCKERS
1047H	RESTROOM
1049	SPRINKLER
C1003	CORRIDOR
E1	ELEVATOR
S103	STAIR
S104	STAIR
T1037	TECHNOLOGY

**ROOM LEGEND**

UNIT D - 1ST FLOOR	
ROOM NO.	ROOM NAME
1034	GYMNASIUM
1034A	CHAIR STORAGE
1034B	PE STORAGE
1034C	PLATFORM
1034D	SOUND
1034E	PE STORAGE
1036	PE OFFICE (TYPE A)
1038	GIRLS LOCKER ROOM
1040	LAUNDRY
1042	CUSTODIAL
1044	BOYS LOCKER ROOM
1046	PE OFFICE (TYPE A)
1048	GIRLS RESTROOM
1050	BOYS RESTROOM
1052	CONCESSIONS
1054	FAMILY RESTROOM
1054A	SHOWER
C1004	CORRIDOR
C1005	CORRIDOR

**ROOM LEGEND**

UNIT B - 1ST FLOOR	
ROOM NO.	ROOM NAME
1001	KINDERGARTEN CLASSROOM
1001A	RESTROOM
1002	KINDERGARTEN CLASSROOM
1002A	RESTROOM
1003	KINDERGARTEN CLASSROOM
1004	PRE-K CLASSROOM
1005	GRADE 1 CLASSROOM
1006	PRE-K CLASSROOM
1006A	RESTROOM
1007	GRADE 1 CLASSROOM
1008	PRE-K CLASSROOM
1009	GRADE 1 CLASSROOM
1010	TEACHER CENTER
1010A	STORAGE
1032	BUILDING SUPPORT
C1001	CORRIDOR
E1003	ELEC
M1001	MECHANICAL
M1002	MECHANICAL
M1005	MECHANICAL
M1006	MECHANICAL
M1007	MECHANICAL
M1009	MECHANICAL
S101	STAIR

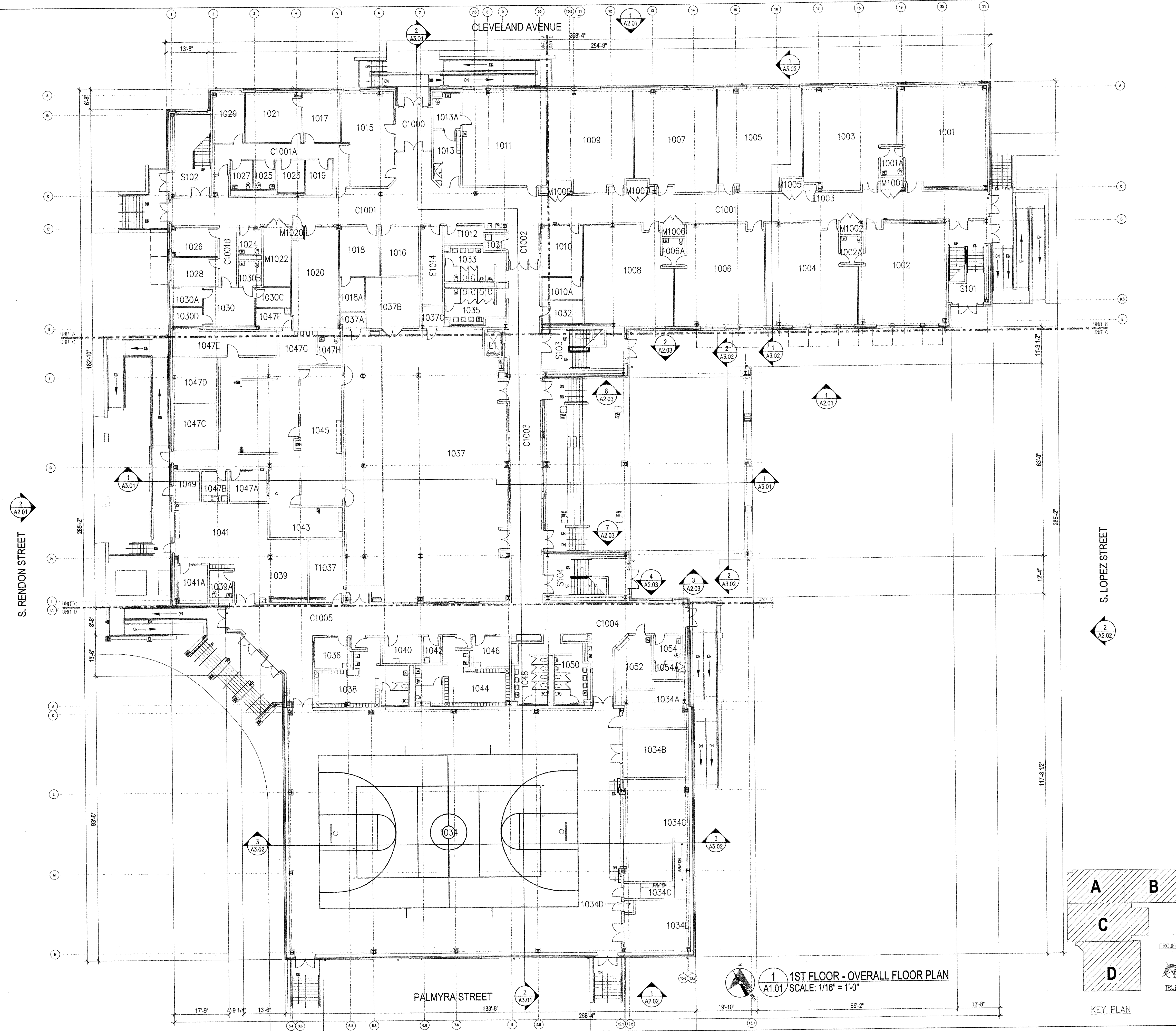

**1 1ST FLOOR - OVERALL FLOOR PLAN**  
A1.01 SCALE: 1/16" = 1'-0"

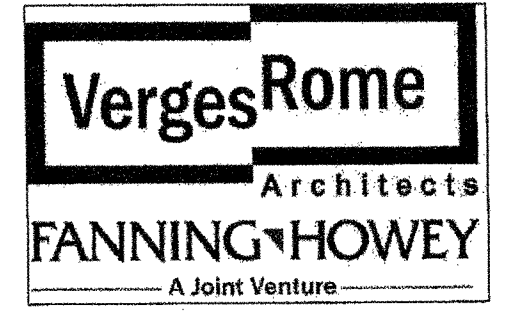
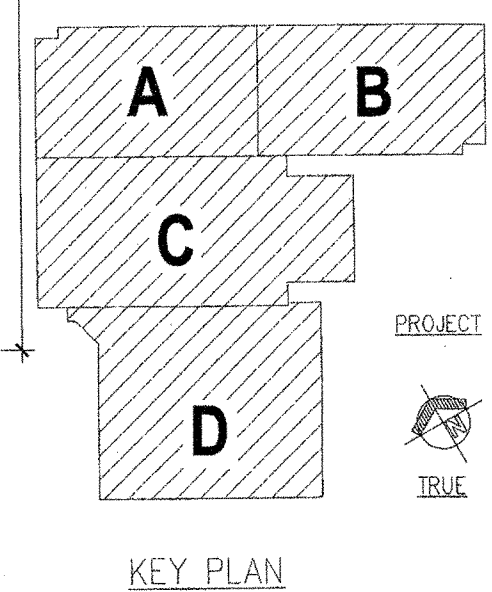

320 N. Carrollton Avenue, Suite 100  
New Orleans, Louisiana 70119  
t. 504.488.7739 f. 504.488.7743

© copyright 2012

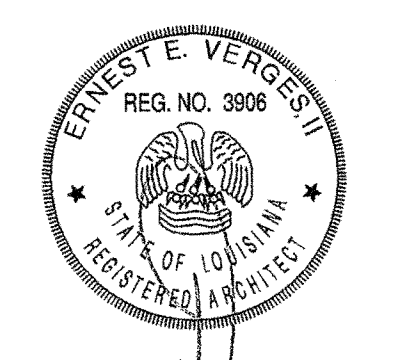

**NEW 3 SECTION ELEMENTARY SCHOOL  
AT FISK-HOWARD SCHOOL  
RECOVERY SCHOOL DISTRICT**

211 S. LOPEZ STREET NEW ORLEANS, LOUISIANA 70119

DATE ISSUED: 7 DECEMBER, 2012  
REVISED:  
REVISED:  
REVISED:  
DRAWN BY: CMB  
CHECKED BY: DGR, JFM  
PHASE:

BID DOCUMENTS

**11085**

TITLE:  
**1ST FLOOR  
OVERALL FLOOR PLAN**

SHEET:

**A1.01**