

ROOM LEGEND		UNIT A 1ST FLOOR		ROOM LEGEND		UNIT C 1ST FLOOR	
ROOM NO.	ROOM NAME	AREA	CLNG HT	ROOM NO.	ROOM NAME	AREA	CLNG HT
1011	SPECIAL NEEDS CLASSROOM	848 SF	10'-0"	1037	STUDENT DINING/COMMONS	4541 SF	VARIES
1013	CHANGING ROOM	147 SF	10'-0"	1039	MAINTENANCE & REPAIR AREA	467 SF	EXPOSED
1013A	RESTROOM	97 SF	10'-0"	1039A	RESTROOM	66 SF	10'-0"
1015	RECEPTION	484 SF	10'-0"	1041	RECEIVING	517 SF	EXPOSED
1016	SPEECH	205 SF	10'-0"	1041A	OFF. A	118 SF	10'-0"
1017	PRINCIPAL (OFFICE C)	200 SF	10'-0"	1043	DISHWASHING	231 SF	10'-0"
1018	OP/PT	209 SF	10'-0"	1045	SERVING	607 SF	10'-0"
1018A	STORAGE	91 SF	10'-0"	1047	KITCHEN	1213 SF	10'-0"
1019	S.R.T.	100 SF	10'-0"	1047A	KIT. OFF.	121 SF	10'-0"
1020	FACULTY/LOUNGE	491 SF	10'-0"	1047B	LAUNDRY	83 SF	10'-0"
1021	CONFERENCE	300 SF	10'-0"	1047C	COOLER	225 SF	-
1023	S.R.T.	93 SF	10'-0"	1047D	FREEZER	215 SF	-
1024	RESTROOM	65 SF	10'-0"	1047E	DRY STORAGE	252 SF	10'-0"
1025	WOMEN	67 SF	10'-0"	1047G	LOCKERS	65 SF	10'-0"
1026	OFFICE A	141 SF	10'-0"	1047H	RESTROOM	70 SF	10'-0"
1027	MEN	68 SF	10'-0"	1049	SPRINKLER	83 SF	EXPOSED
1028	OFFICE A	144 SF	10'-0"	C1003	CORRIDOR	1175 SF	10'-0"
1029	OFFICE A	170 SF	10'-0"	E1	ELEVATOR	48 SF	-
1030	HEALTH CLINIC	205 SF	10'-0"	S103	STAIR	342 SF	VARIES
1030A	COT/EXAM RM	60 SF	10'-0"	S104	STAIR	315 SF	VARIES
1030B	RESTROOM	60 SF	10'-0"	T1037	TECHNOLOGY	219 SF	10'-0"
1030C	STORAGE	75 SF	10'-0"				
1030D	COT/EXAM RM	60 SF	10'-0"				
1031	CUSTODIAL	37 SF	EXPOSED				
1033	BOYS RESTROOM	215 SF	10'-0"				
1035	GIRLS RESTROOM	215 SF	10'-0"				
1037A	SOUND	40 SF	10'-0"				
1037B	STORAGE	290 SF	10'-0"				
1037C	ELEVATOR EQUIPMENT	51 SF	10'-0"				
1047F	STORAGE	78 SF	10'-0"				
C1000	VESTIBULE	160 SF	10'-0"				
C1001	CORRIDOR	1402 SF	12'-0"				
C1001A	CORRIDOR	321 SF	10'-0"				
C1001B	CORRIDOR	107 SF	10'-0"				
C1002	CORRIDOR	119 SF	10'-0"				
E1014	ELECTRICAL	181 SF	10'-0"				
M1020	MECHANICAL	16 SF	EXPOSED				
M1022	MECHANICAL	171 SF	EXPOSED				
S102	STAIR	324 SF	VARIES				
T1012	TECHNOLOGY	76 SF	10'-0"				

ROOM LEGEND		UNIT D 1ST FLOOR	
ROOM NO.	ROOM NAME	AREA	CLNG HT
1034	GYMNASIUM	8613 SF	EXPOSED
1034A	CHAIR STORAGE	288 SF	10'-0"
1034B	PE STORAGE	336 SF	10'-0"
1034C	PLATFORM	651 SF	EXPOSED
1034D	SOUND	12 SF	10'-0"
1034E	PE STORAGE	344 SF	10'-0"
1036	PE OFFICE (TYPE A)	115 SF	10'-0"
1038	GIRLS LOCKER ROOM	435 SF	10'-0"
1040	LAUNDRY	112 SF	10'-0"
1042	CUSTODIAL	48 SF	10'-0"
1044	BOYS LOCKER ROOM	433 SF	10'-0"
1046	PE OFFICE (TYPE A)	119 SF	10'-0"
1048	GIRLS RESTROOM	210 SF	10'-0"
1050	BOYS RESTROOM	207 SF	10'-0"
1052	CONCESSIONS	199 SF	10'-0"
1054	FAMILY RESTROOM	73 SF	10'-0"
1054A	SHOWER	51 SF	10'-0"
C1004	CORRIDOR	784 SF	10'-0"
C1005	CORRIDOR	1252 SF	10'-0"

ROOM LEGEND		UNIT B 1ST FLOOR	
ROOM NO.	ROOM NAME	AREA	CLNG HT
1001	KINDERGARTEN CLASSROOM	902 SF	10'-0"
1001A	RESTROOM	69 SF	10'-0"
1002	KINDERGARTEN CLASSROOM	892 SF	10'-0"
1002A	RESTROOM	69 SF	10'-0"
1003	KINDERGARTEN CLASSROOM	900 SF	10'-0"
1004	PRE-K CLASSROOM	891 SF	10'-0"
1005	GRADE 1 CLASSROOM	863 SF	10'-0"
1006	PRE-K CLASSROOM	905 SF	10'-0"
1006A	RESTROOM	69 SF	10'-0"
1007	GRADE 1 CLASSROOM	854 SF	10'-0"
1008	PRE-K CLASSROOM	887 SF	10'-0"
1009	GRADE 1 CLASSROOM	863 SF	10'-0"
1010	TEACHER CENTER	228 SF	10'-0"
1010A	STORAGE	98 SF	10'-0"
1032	BUILDING SUPPORT	100 SF	10'-0"
C1001	CORRIDOR	1444 SF	10'-0"
E1003	ELEC	8 SF	EXPOSED
M1001	MECHANICAL	30 SF	EXPOSED
M1002	MECHANICAL	30 SF	EXPOSED
M1005	MECHANICAL	27 SF	EXPOSED
M1006	MECHANICAL	30 SF	EXPOSED
M1007	MECHANICAL	27 SF	EXPOSED
M1009	MECHANICAL	36 SF	EXPOSED
S101	STAIR	324 SF	VARIES

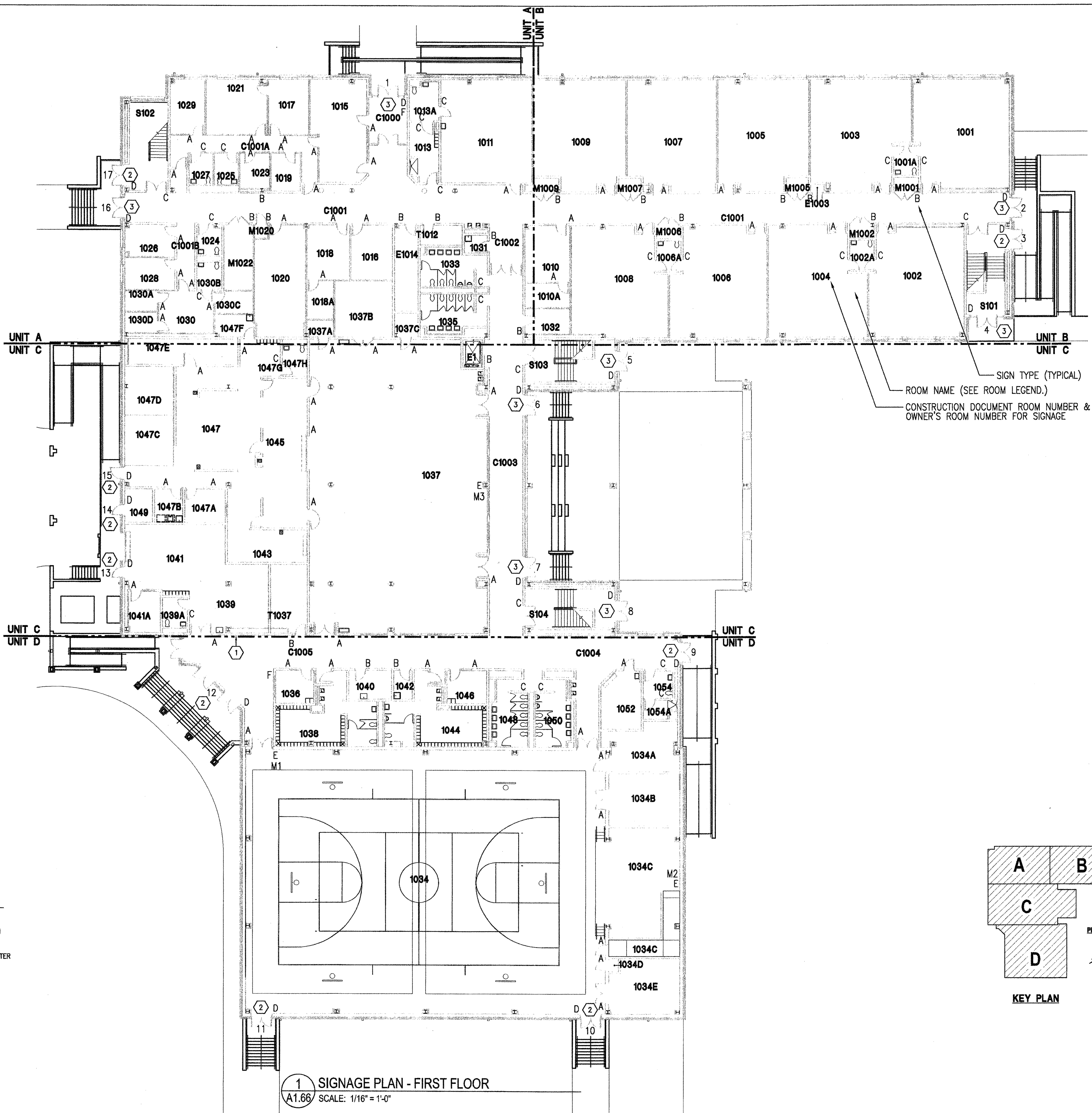

SIGNAGE GENERAL NOTES

A. RSD RESERVES THE RIGHT TO CHANGE THE ROOM NUMBERS DURING THE SHOP DRAWING REVIEW.

B. REFER TO SIGNAGE PLAN (A1.66 THRU A1.69) FOR SIGNAGE TEXT, LOCATIONS, QUANTITIES, SIGN TYPES, AND ADDITIONAL INFORMATION.

C. MAXIMUM CAPACITY SIGNS OCCUPANT LOAD WILL BE ESTABLISHED BY THE INSPECTING OFFICER UPON FINAL INSPECTION. THUS, PROVIDE (4) MAXIMUM CAPACITY SIGNS. SIGNS SHALL COMPLY WITH IBC 2009, SECTION 1004.3.

D. "T" REPRESENTS A NON-SMOKING SIGN (TOTAL OF 2). NON-SMOKING SIGNS ARE ONLY REFERENCED ON THE SIGNAGE PLAN.

E. SIGN TYPE "D" COPY SHALL BE "EXIT #1" AT EXTERIOR DOORS SHALL BE NUMBER 1 THRU 17.

F. REFER TO EXTERIOR BUILDING ELEVATIONS FOR BUILDING LETTERS.

H. REFER TO MOUNTING HEIGHTS (A4.00) FOR ADDITIONAL INFORMATION ABOUT INSTALLATION/LOCATIONS.

MAXIMUM CAPACITY LEGEND

SIGN TEXT	CAPACITY	LOCATION
M1	MAXIMUM CAPACITY	T.B.D. 1032: GYMNASIUM
M2	MAXIMUM CAPACITY	T.B.D. 1032B: STAGE
M3	MAXIMUM CAPACITY	T.B.D. 1037: CAFETERIA
M4	MAXIMUM CAPACITY	T.B.D. 2028: MEDIA CENTER

- SIGNAGE PLAN KEY NOTES**
- INSTALL NEW DEDICATION PLAQUE AT THIS LOCATION, REFER TO DRAWING SHEET A1.69 (TOP OF PLAQUE AT 6'-0" AFF)
 - PROVIDE 12" HIGH EXTERIOR NUMBERS (COORDINATE WITH # AT DOOR LOCATION) ON THE MASONRY.
 - PROVIDE 12" HIGH VINYL NUMBERS (COORDINATE WITH # AT DOOR LOCATION) ON THE INTERIOR TRANSOM OF STOREFRONT.



320 N. Carrollton Avenue, Suite 100
New Orleans, Louisiana 70119
t. 504.488.7739 f. 504.488.7743

© copyright 2012

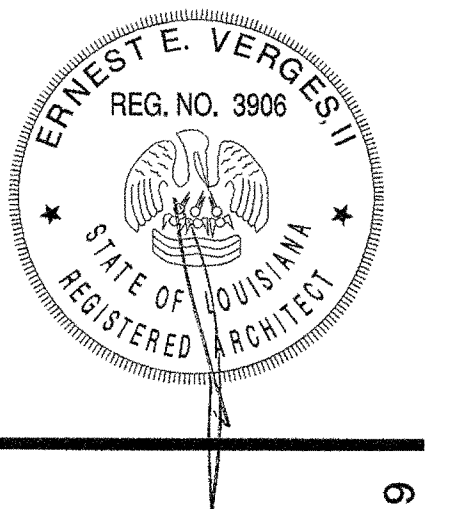

**NEW 3 SECTION ELEMENTARY SCHOOL
AT FISK-HOWARD SCHOOL
RECOVERY SCHOOL DISTRICT**
 211 S. LOPEZ STREET
 NEW ORLEANS, LOUISIANA 70119

DATE ISSUED: 7 DECEMBER, 2012
 REVISED:
 REVISED:
 REVISED:
 DRAWN BY: MKS
 CHECKED BY:
 PHASE:

BID DOCUMENTS
11085
 TITLE:
**1ST FLOOR
SIGNAGE PLAN**
 SHEET:
A1.66