

ROOM LEGEND			
UNIT A 3RD FLOOR			
ROOM NO.	ROOM NAME	AREA	CLNG HT
3011	SPECIAL NEEDS	823 SF	10'-0"
3011A	CHANGING	134 SF	10'-0"
3011B	RESTROOM	98 SF	10'-0"
3011C	STORAGE	53 SF	10'-0"
3013	RESOURCE CLASSROOM	850 SF	10'-0"
3015	RESOURCE CLASSROOM	849 SF	10'-0"
3017	GRADE 8 CLASSROOM	841 SF	10'-0"
3018	PROFESSIONAL DEVELOPMENT	851 SF	10'-0"
3019	CUSTODIAL	37 SF	EXPOSED
3020	GRADE 8 CLASSROOM	847 SF	10'-0"
3021	BOYS RESTROOM	215 SF	10'-0"
3022	GRADE 8 CLASSROOM	851 SF	10'-0"
3023	GIRLS RESTROOM	215 SF	10'-0"
C3001	CORRIDOR	1169 SF	10'-0"
C3002	CORRIDOR	350 SF	10'-0"
E3016	ELECTRICAL	181 SF	EXPOSED
M3011	MECHANICAL	28 SF	EXPOSED
M3015	MECHANICAL	35 SF	EXPOSED
M3018	MECHANICAL	21 SF	EXPOSED
M3020	MECHANICAL	35 SF	EXPOSED
S302	STAIR	316 SF	10'-0"
T3014	TECHNOLOGY	76 SF	10'-0"

ROOM LEGEND			
UNIT B 3RD FLOOR			
ROOM NO.	ROOM NAME	AREA	CLNG HT
3001	GRADE 6 CLASSROOM	856 SF	10'-0"
3002	GRADE 6 CLASSROOM	855 SF	10'-0"
3003	GRADE 6 CLASSROOM	835 SF	10'-0"
3004	SCIENCE CLASSROOM	945 SF	10'-0"
3005	GRADE 7 CLASSROOM	857 SF	10'-0"
3006	TEACHER CENTER	247 SF	10'-0"
3006A	STORAGE	133 SF	10'-0"
3007	GRADE 7 CLASSROOM	836 SF	10'-0"
3008	SUCCESS CENTER	462 SF	10'-0"
3009	GRADE 7 CLASSROOM	857 SF	10'-0"
3010	OFFICE B	160 SF	10'-0"
3012	LOCKERS	957 SF	10'-0"
3012A	CLOSET	39 SF	10'-0"
3024	MEN	50 SF	10'-0"
3026	WOMEN	54 SF	10'-0"
3028	OFFICE A	121 SF	10'-0"
3028A	CHASE	17 SF	10'-0"
C3001	CORRIDOR	1430 SF	10'-0"
E3004	ELECTRICAL	3 SF	EXPOSED
M3001	MECHANICAL	35 SF	EXPOSED
M3002	MECHANICAL	35 SF	EXPOSED
M3004	MECHANICAL	22 SF	EXPOSED
M3005	MECHANICAL	35 SF	EXPOSED
M3009	MECHANICAL	35 SF	EXPOSED
S301	STAIR	316 SF	10'-0"

ROOM LEGEND			
UNIT C 3RD FLOOR			
ROOM NO.	ROOM NAME	AREA	CLNG HT
3025	SCIENCE LAB	1206 SF	10'-0"
3027	SCIENCE PREP	292 SF	10'-0"
3029	SCIENCE CLASSROOM	894 SF	10'-0"
C3003	CORRIDOR	933 SF	10'-0"
M3030	MECHANICAL	999 SF	EXPOSED
S303	STAIR	342 SF	10'-0"
S304	STAIR	315 SF	10'-0"

**SIGNAGE GENERAL NOTES**

- A. RSD RESERVES THE RIGHT TO CHANGE THE ROOM NUMBERS DURING THE SHOP DRAWING REVIEW.
- B. REFER TO SIGNAGE PLAN (A1.66 THRU A1.69) FOR SIGNAGE TEXT, LOCATIONS, QUANTITIES, SIGN TYPES, AND ADDITIONAL INFORMATION.
- C. MAXIMUM CAPACITY SIGNS OCCUPANT LOAD WILL BE ESTABLISHED BY THE INSPECTING OFFICER UPON FINAL INSPECTION. THUS, PROVIDE (4) MAXIMUM CAPACITY SIGNS. SIGNS SHALL COMPLY WITH IBC 2009, SECTION 1004.3.
- D. "N" REPRESENTS A NON-SMOKING SIGN (TOTAL OF 2). NON-SMOKING SIGNS ARE ONLY REFERENCED ON THE SIGNAGE PLAN.
- E. SIGN TYPE "D" COPY SHALL BE "EXIT #1" AT EXTERIOR DOORS SHALL BE NUMBER 1 THRU 17.
- F. REFER TO EXTERIOR BUILDING ELEVATIONS FOR BUILDING LETTERS.
- H. REFER TO MOUNTING HEIGHTS (A4.00) FOR ADDITIONAL INFORMATION ABOUT INSTALLATION/LOCATIONS.

**MAXIMUM CAPACITY LEGEND**

SIGN TEXT	CAPACITY	LOCATION
M1	MAXIMUM CAPACITY	T.B.D 1032: GYMNASIUM
M2	MAXIMUM CAPACITY	T.B.D 1032B: STAGE
M3	MAXIMUM CAPACITY	T.B.D 1037: CAFETERIA
M4	MAXIMUM CAPACITY	T.B.D 2028: MEDIA CENTER

UNIT A  
UNIT B  
UNIT C  
UNIT D

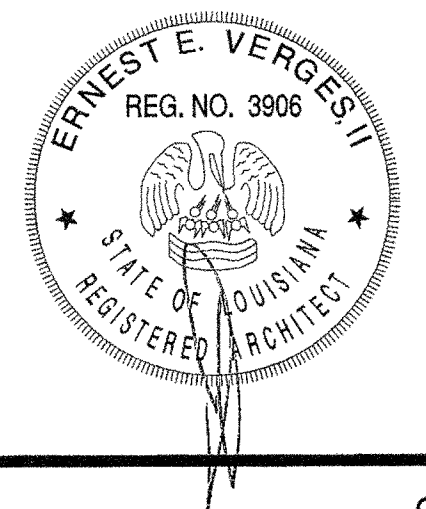
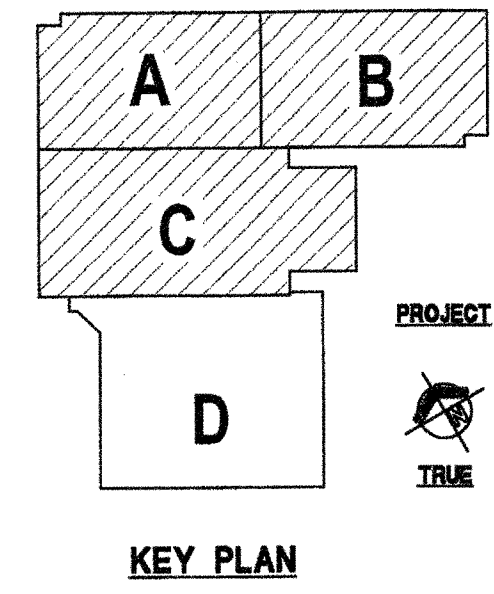
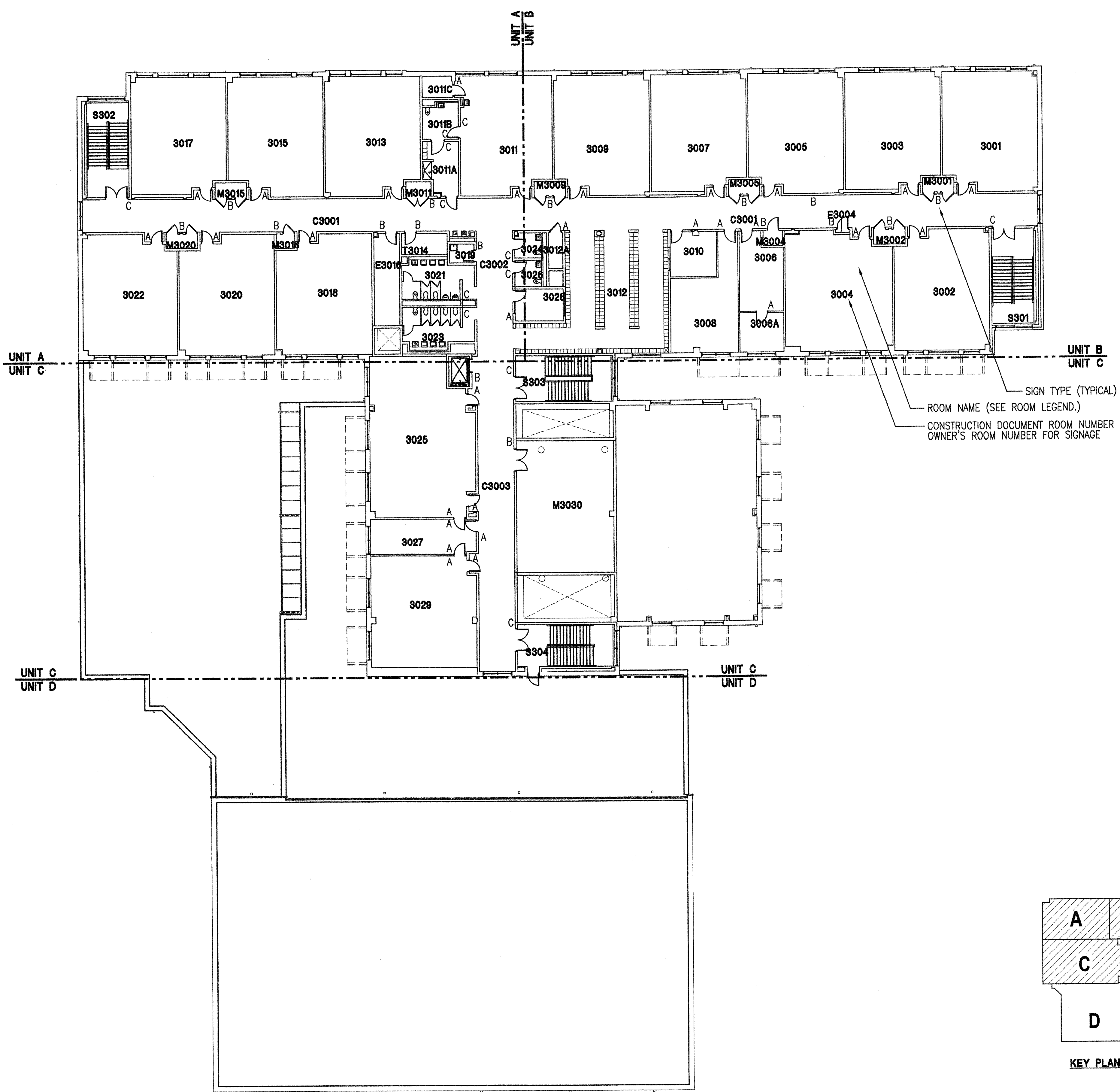

**NEW 3 SECTION ELEMENTARY SCHOOL  
AT FISK-HOWARD SCHOOL  
RECOVERY SCHOOL DISTRICT**  
 211 S. SLOPEZ STREET  
 NEW ORLEANS, LOUISIANA 70119

DATE ISSUED: 7 DECEMBER, 2012  
 REVISED:  
 REVISED:  
 REVISED:  
 REVISED:  
 DRAWN BY: MKS  
 CHECKED BY:  
 PHASE:

BID DOCUMENTS  
**11085**  
 TITLE:  
**3RD FLOOR  
SIGNAGE PLAN**  
 SHEET: