

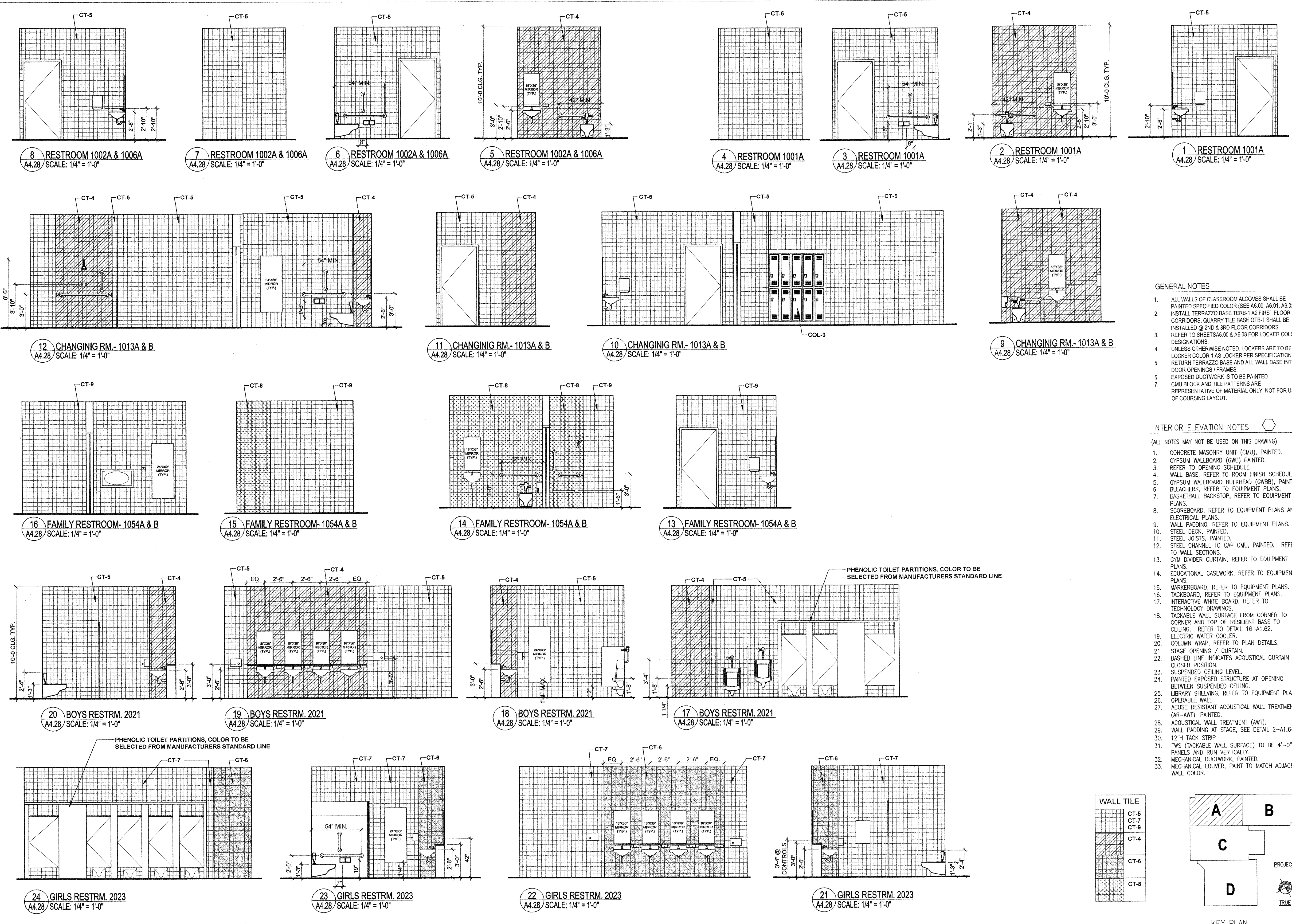

**NEW 3 SECTION ELEMENTARY SCHOOL
AT FISK-HOWARD SCHOOL
RECOVERY SCHOOL DISTRICT**

211 S. LOPEZ STREET NEW ORLEANS, LOUISIANA 70119



- GENERAL NOTES**
- ALL WALLS OF CLASSROOM ALCOVES SHALL BE PAINTED SPECIFIED COLOR (SEE A6.00, A6.01, A6.02).
 - INSTALL TERRAZZO BASE TERB-1 A2 FIRST FLOOR CORRIDORS. QUARRY TILE BASE QTB-1 SHALL BE INSTALLED @ 2ND & 3RD FLOOR CORRIDORS.
 - REFER TO SHEETS A6.00 & A6.08 FOR LOCKER COLOR DESIGNATIONS.
 - UNLESS OTHERWISE NOTED, LOCKERS ARE TO BE LOCKER COLOR 1 AS LOCKER PER SPECIFICATIONS.
 - RETURN TERRAZZO BASE AND ALL WALL BASE INTO DOOR OPENINGS / FRAMES.
 - EXPOSED DUCTWORK IS TO BE PAINTED
 - CMU BLOCK AND TILE PATTERNS ARE REPRESENTATIVE OF MATERIAL ONLY, NOT FOR USE OF COURSING LAYOUT.

- INTERIOR ELEVATION NOTES**
- (ALL NOTES MAY NOT BE USED ON THIS DRAWING)
- CONCRETE MASONRY UNIT (CMU), PAINTED.
 - GYPSUM WALLBOARD (GWB), PAINTED.
 - REFER TO OPENING SCHEDULE.
 - WALL BASE, REFER TO ROOM FINISH SCHEDULE.
 - GYPSUM WALLBOARD BULKHEAD (GWBH), PAINTED.
 - BLEACHERS, REFER TO EQUIPMENT PLANS.
 - BASKETBALL BACKSTOP, REFER TO EQUIPMENT PLANS.
 - SCOREBOARD, REFER TO EQUIPMENT PLANS AND ELECTRICAL PLANS.
 - WALL PADDING, REFER TO EQUIPMENT PLANS.
 - STEEL DECK, PAINTED.
 - STEEL JOISTS, PAINTED.
 - STEEL CHANNEL TO CAP CMU, PAINTED. REFER TO WALL SECTIONS.
 - GYM DIVIDER CURTAIN, REFER TO EQUIPMENT PLANS.
 - EDUCATIONAL CASEWORK, REFER TO EQUIPMENT PLANS.
 - MARKERBOARD, REFER TO EQUIPMENT PLANS.
 - TACKBOARD, REFER TO EQUIPMENT PLANS.
 - INTERACTIVE WHITE BOARD, REFER TO TECHNOLOGY DRAWINGS.
 - TACKABLE WALL SURFACE FROM CORNER TO CORNER AND TOP OF RESILIENT BASE TO CEILING. REFER TO DETAIL 16-A1.62.
 - ELECTRIC WATER COOLER.
 - COLUMN WRAP, REFER TO PLAN DETAILS.
 - STAGE OPENING / CURTAIN.
 - DASHED LINE INDICATES ACOUSTICAL CURTAIN IN CLOSED POSITION.
 - SUSPENDED CEILING LEVEL.
 - PAINTED EXPOSED STRUCTURE AT OPENING BETWEEN SUSPENDED CEILING.
 - LIBRARY SHELVING, REFER TO EQUIPMENT PLANS.
 - OPERABLE WALL.
 - ABUSE RESISTANT ACOUSTICAL WALL TREATMENT (AR-AWT), PAINTED.
 - ACOUSTICAL WALL TREATMENT (AWT).
 - WALL PADDING AT STAGE, SEE DETAIL 2-A1.64.
 - 12" TACK STRIP
 - TWS (TACKABLE WALL SURFACE) TO BE 4'-0" W PANELS AND RUN VERTICALLY.
 - MECHANICAL DUCTWORK, PAINTED.
 - MECHANICAL LOUVER, PAINT TO MATCH ADJACENT WALL COLOR.

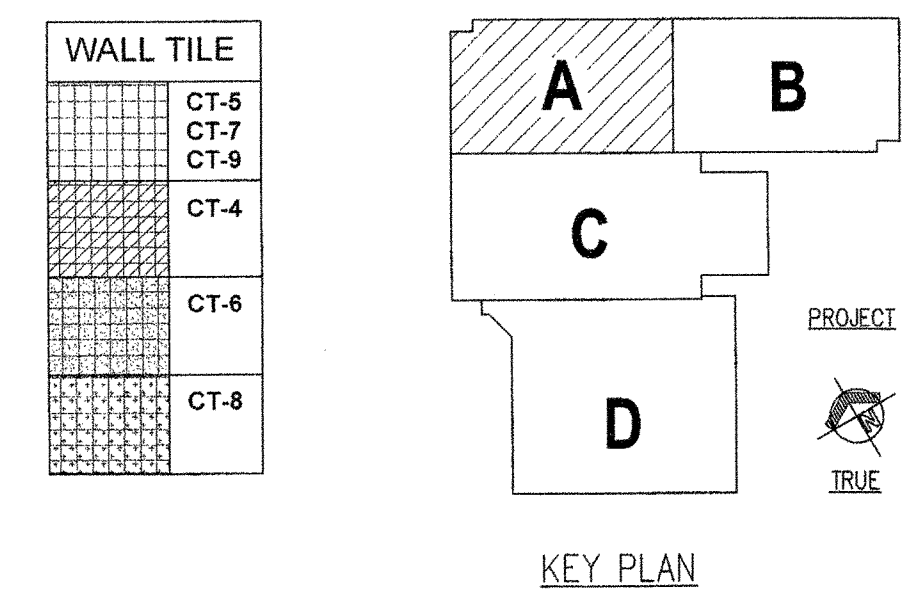

DATE ISSUED: 7 DECEMBER, 2012
 REVISED: _____
 REVISED: _____
 REVISED: _____
 REVISED: _____
 DRAWN BY: HML
 CHECKED BY: DGR, JFM
 PHASE: _____

BID DOCUMENTS

11085

TITLE: INTERIOR ELEVATIONS

SHEET: **A4.28**