

**NEW 3 SECTION ELEMENTARY SCHOOL  
AT FISK-HOWARD SCHOOL  
RECOVERY SCHOOL DISTRICT**

NEW ORLEANS, LOUISIANA 70119  
211 S. LOPEZ STREET

DATE ISSUED: 7 DECEMBER, 2012  
REVISED:  
REVISED:  
REVISED:  
DRAWN BY: MKS  
CHECKED BY:  
PHASE:

**BID DOCUMENTS**

**11085**

TITLE:  
**UNIT C SECOND FLOOR REFLECTED CEILING**

SHEET:

**A7.07**

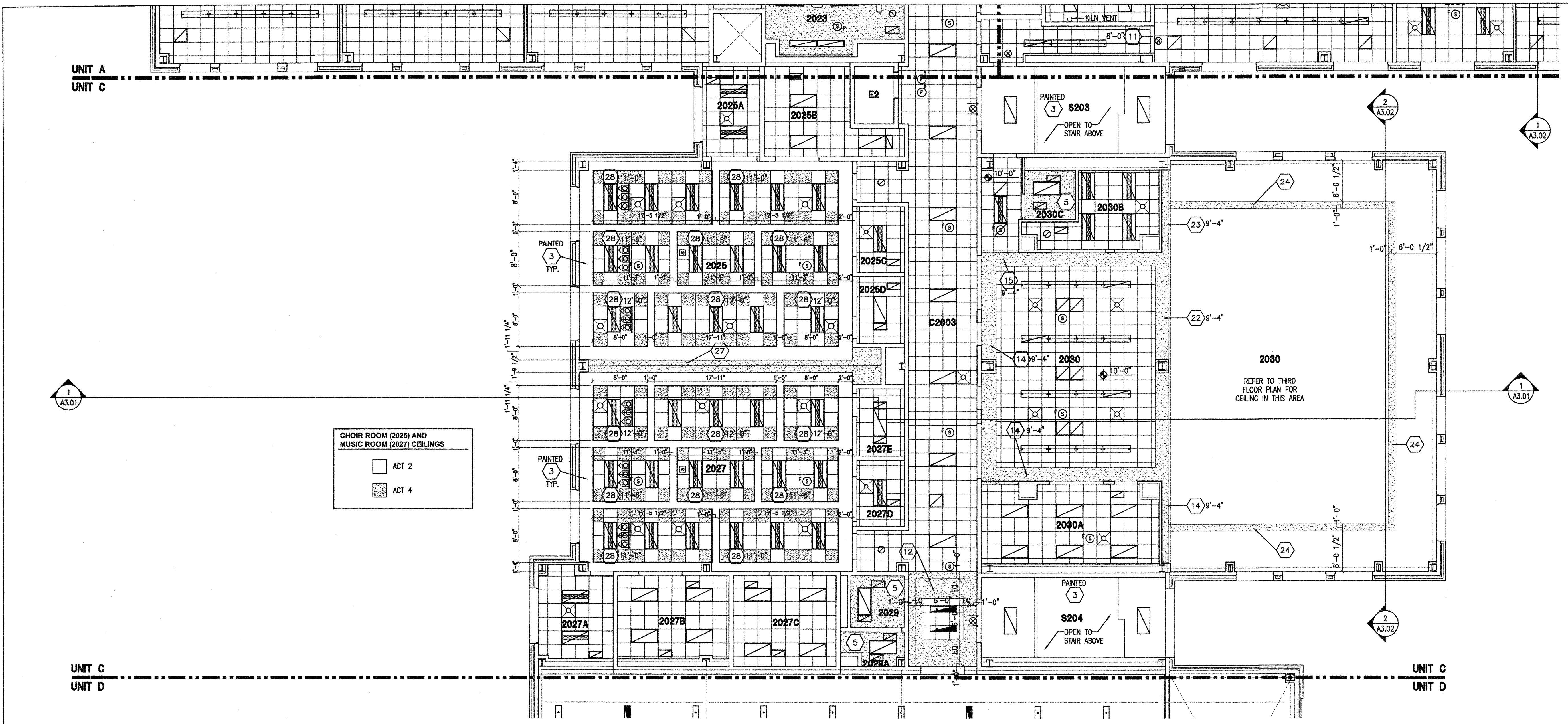

**CHOIR ROOM (2025) AND  
MUSIC ROOM (2027) CEILINGS**

□ ACT 2  
▨ ACT 4

**REFLECTED CEILING PLAN LEGEND**

- 2x4 OR 2x2 ACOUSTICAL CEILING - REFER TO ROOM FINISH SCHEDULE FOR TYPE
- LIGHT FIXTURE - REFER TO ELECTRICAL DRAWINGS
- LIGHT FIXTURE - REFER TO ELECTRICAL DRAWINGS
- LIGHT FIXTURE - REFER TO ELECTRICAL DRAWINGS
- DIFFUSER - REFER TO MECHANICAL DRAWINGS
- DIFFUSER - REFER TO MECHANICAL DRAWINGS
- RETURN AIR GRILL - REFER TO MECHANICAL DRAWINGS
- SPEAKER - REFER TO ELECTRICAL DRAWINGS
- OCCUPANCY SENSOR - REFER TO ELECTRICAL DRAWINGS
- SMOKE DETECTOR - REFER TO ELECTRICAL DRAWINGS
- HEAT DETECTOR - REFER TO ELECTRICAL DRAWINGS
- CEILING MOUNTED EXIT LIGHT
- CEILING MOUNTED PROJECTOR - COORDINATE INSTALLATION OF VIDEO PROJECTOR WITH TECHNOLOGY CONTRACTOR
- CEILING MOUNTED WIRELESS ACCESS POINT
- CEILING MOUNTED INTERCOMMUNICATIONS LOUDSPEAKER
- CEILING MOUNTED SPECIALTY SOUND REINFORCEMENT SPEAKER
- CEILING MOUNTED MICROPHONE
- CEILING MOUNTED VIDEO SURVEILLANCE CAMERA
- CEILING MOUNTED MOTION DETECTOR
- CEILING MOUNTED DOOR ACCESS CONTROLLER JUNCTION BOX
- CABINET HEATER - REFER TO MECHANICAL DRAWINGS
- INDICATES GWB BULKHEAD/CEILING
- INDICATES PLASTER CEILING/SOFFIT
- INDICATES PROJECTION SCREEN - REFER TO EQUIPMENT DRAWINGS
- 2" SOFFIT VENT (CONT). TERMINATE 6" FROM FACE OF WALL CONSTRUCTION

**GENERAL NOTES**

- A. THE ARCHITECTURAL REFLECTED CEILING PLANS GOVERN THE LAYOUT OF ALL CEILING ELEMENTS/PENETRATIONS.
- B. REFER TO MASTER PLANS/CODE PLANS FOR THE LOCATION OF RATED WALL CONSTRUCTION AND WALLS THAT EXTEND TO ROOF DECK OR FLOOR STRUCTURE ABOVE.
- C. REFER TO ROOM FINISH SCHEDULE FOR SPECIFIC CEILING TYPES.
- D. BULKHEAD FRAMING SHALL BE ATTACHED TO STRUCTURAL FRAMING AND NOT TO ROOF DECK. PROVIDE REVEAL DRYWALL TRIM AT ALL LOCATIONS WHERE GYPSUM WALL BOARD (GWB) ABUTS A DISSIMILAR MATERIAL, TYPICAL UNLESS NOTED OTHERWISE. REFER TO DETAIL 1-A7.12.
- E.

**REFLECTED PLAN KEY NOTES**

1. REFER TO SECOND FLOOR FOR CEILING.
2. SLOPED GLAZING SKYLIGHT - REFER TO ROOF PLAN AND WALL SECTIONS.
3. EXPOSED STRUCTURE IN THIS ROOM.
4. NO NEW CEILING FINISH REQUIRED AT FREEZER/COOLER AREA.
5. 5/8" GWB CEILING ON 3 5/8" STEEL STUDS AT 16" O.C. SUSPEND FROM STRUCTURE AS REQUIRED.
6. LINE INDICATES CANOPY AND STRUCTURE REFER TO SITE PLAN CANOPY DRAWINGS.
7. TUBULAR DAYLIGHTING DIFFUSER - REFER TO ROOF PLAN AND PROJECT MANUAL.
8. SUSPENDED PLASTER SOFFIT - 3/4" PORTLAND CEMENT STUCCO ON METAL LATH ON RUNNERS SUSPENDED FROM STRUCTURE ABOVE. HEIGHT AS INDICATED.
9. CONTROL JOINT AT SUSPENDED PLASTER SOFFIT REFER TO PROJECT MANUAL.
10. CONTINUOUS EXPANSION JOINT AT CEILING - SEE DETAIL 2-A7.13.
11. CMU LINTEL (PAINT) BOTTOM OF LINTEL HEIGHT AS INDICATED - REFER TO STRUCTURAL DRAWINGS.
12. LUMINOUS CEILING SYSTEM AND GWB BULKHEAD REFER TO PROJECT MANUAL AND DETAIL 10-A7.12.
13. ACRYLIC EGGRATE CEILING AT DISPLAY CASE REFER TO DETAIL 7-A1.64.
14. GWB BULKHEAD - REFER TO DETAIL 2-A7.12.
15. GWB BULKHEAD - REFER TO DETAIL 3-A7.12.
16. GWB BULKHEAD - REFER TO DETAIL 4-A7.12.
17. GWB BULKHEAD - REFER TO DETAIL 5-A7.12.
18. GWB BULKHEAD - REFER TO DETAIL 6-A7.12.
19. GWB BULKHEAD - REFER TO DETAIL 7-A7.12.
20. GWB BULKHEAD - REFER TO DETAIL 8-A7.12.
21. GWB BULKHEAD - REFER TO DETAIL 9-A7.12.
22. GWB BULKHEAD - REFER TO DETAIL 11-A7.12.
23. GWB BULKHEAD - REFER TO DETAIL 12-A7.12.
24. GWB BULKHEAD - REFER TO DETAIL 13-A7.12.
25. FORWARD FOLDING BASKETBALL BACKSTOP REFER TO EQUIPMENT DRAWINGS.
26. GYMNASIUM DIVIDER CURTAIN - REFER TO EQUIPMENT DRAWINGS.
27. OPERABLE PARTITION WALL - REFER TO PROJECT MANUAL AND DETAIL 1-A7.13.
28. SUSPENDED ACOUSTICAL CEILING. HEIGHT AS INDICATED - PROVIDE 8" SUSPENSION (PERIMETER) TRIM AROUND EACH SUSPENDED GROUPING OF PANELS. PROVIDE 6" ACOUSTICAL INSULATION LAYING ON TOP OF PANELS AND EXTENDING TO PERIMETER TRIM.
29. COORDINATE CEILING TERMINATION WITH COOLER/FREEZER CONTR.
30. GWB BULKHEAD - REFER TO DETAIL 3-A7.13.
31. PROVIDE 1 HOUR RATED CEILING IN THIS ROOM. (2) LAYERS OF 5/8" TYPE "X" GWB CEILING ON 6" STEEL STUDS AT 16" O.C. AND SECURED TO WALLS AS REQUIRED.

**ROOM LEGEND**

ROOM NO.	ROOM NAME	UNIT C 2ND FLOOR	
		AREA	CLNG HT
2025	CHOIR (VOCAL)	1199 SF	VARIES
2025A	DIRECTOR'S OFFICE	110 SF	10'-0"
2025B	CHAIR STORAGE	199 SF	10'-0"
2025C	PRACTICE	67 SF	10'-0"
2025D	STORAGE	69 SF	10'-0"
2027	MUSIC (INSTRUMENTAL)	1199 SF	VARIES
2027A	DIRECTOR'S OFFICE	137 SF	10'-0"
2027B	RISER STORAGE	195 SF	10'-0"
2027C	INSTRUMENT STORAGE	198 SF	10'-0"
2027D	PRACTICE	67 SF	10'-0"
2027E	STORAGE	68 SF	10'-0"
2029	FAMILY RESTROOM	58 SF	10'-0"
2029A	SHOWER	39 SF	10'-0"
2030	MEDIA CENTER	3379 SF	VARIES
2030A	WORKROOM/OFFICE	298 SF	10'-0"
2030B	TEACHER REFERENCE ROOM	161 SF	10'-0"
2030C	RESTROOM	53 SF	10'-0"
C2003	CORRIDOR	1194 SF	10'-0"
E2	ELEVATOR	48 SF	-
S203	STAIR	342 SF	VARIES
S204	STAIR	315 SF	VARIES

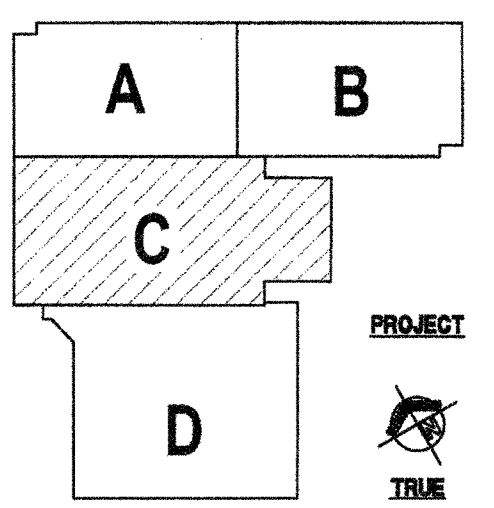

**KEY PLAN**

**VERIFICATION NOTE**

CONTRACTOR SHALL VERIFY ALL DIMENSIONS AND CLEARANCES AND ALL EXISTING FIELD CONDITIONS BEFORE STARTING CONSTRUCTION. COMMENCEMENT OF WORK CONSTITUTES ACCEPTANCE OF CONDITIONS. SHOULD DIFFERENT CONDITIONS BE ENCOUNTERED, CONTACT THE ARCHITECT BEFORE PROCEEDING WITH WORK.

**1** UNIT C - SECOND FLOOR REFLECTED CEILING PLAN  
A7.07 SCALE: 1/8" = 1'-0"