

1 1ST FLOOR PLAN - OVERALL
 A6.03 SCALE: 1/16" = 1'-0"

GENERAL NOTES

1. ALL MECHANICAL AND ELECTRICAL ROOMS SHALL BE UNFINISHED.
2. ALL AREAS WITH CERAMIC TILE FLOORS SHALL HAVE CERAMIC TILE CORNER BASE @ THE SAME SIZE AND FINISH AS THE CERAMIC WALL TILES.
3. ALL ROOMS/AREAS WITH CERAMIC TILE WALLS AND FLOORS SHALL HAVE MARBLE TRIMMERS AND SHALL BE INSTALLED UNDER DOORS AND SCORED TO FRAME PROFILE.
4. PROVIDE METAL TRANSITION STRIPS UNDER DOORS AT ROOMS THAT DO NOT HAVE CERAMIC TILE.
5. ALL QUARRY AND CERAMIC TILE AT RESTROOMS AND FOOD SERVICE AREAS TO HAVE NON-SLIP GRAY CONVENTIONAL GROUT AT ALL OTHER AREAS.
6. SEALED CONCRETE AT COOLER/FREEZER LOCATION IS A BASE FOR PREFABRICATED UNIT FLOORING. SEE STRUCTURAL FOR KITCHEN.
7. FINISHES SHOWN IN ONE AREA OF A ROOM OR CORRIDOR SHALL APPLY TO THE ENTIRE ROOM UNLESS OTHERWISE NOTED.
8. FIELD CARPET TILES (CPT 1-3) ARE TO BE INSTALLED MECHANICALLY WITH THE UNDER PATTERN RUNNING PARALLEL WITH THE DIRECTION OF THE SOLID COLOR CARPET TILES (CPT 4-6).
9. ALL SOLID COLORED CARPET TILES (CPT 4-6) ARE TO BE INSTALLED QUARTER TURNED.
10. RECESSED SLABS ARE DIMENSIONED FROM INSIDE WALL TO INSIDE WALL WITH ALL CURB WALL COURSE(S) STARTING AT FINISH FLOOR. POURED STEEL WALLS OR CURB WALLS ARE ACCEPTABLE. SPACERS, REFER TO STRUCTURAL DRAWINGS FOR ADDITIONAL INFORMATION. FIELD VERIFY ALL DIMENSIONS.
11. ALL INTERIOR WALL PAINT SHALL BE AN EGGSHELL FINISH UNLESS NOTED OTHERWISE.
12. ALL CLASSROOM DOOR ENTRANCE ALCOVES TO BE PAINTED - P13 4 OR 5. REFER TO FINISH PLANS.
13. RETURN TERRAZZO BASE AND ALL WALL BASE INTO FLOOR OR CHANGES FRAMES.
14. ALL TRANSITIONS FROM TILE, TERRAZZO, QUARRY TILE AND CONCRETE FLOORING TO EACH OTHER AND TO OTHER FLOORING FINISH MATERIALS SHALL BE MADE LEVEL BY FEATHERING GROUT BED. NON-LEVEL FINISHED SURFACES WILL NOT BE ACCEPTED.

FLOOR FINISH LEGEND	
[Pattern]	TER-1
[Pattern]	TER-2
[Pattern]	TER-3
[Pattern]	TER-4
[Pattern]	VCT-1
[Pattern]	VCT-2
[Pattern]	VCT-3
[Pattern]	CT-1
[Pattern]	CT-2
[Pattern]	CT-3
[Pattern]	CPT-1
[Pattern]	CPT-2
[Pattern]	CPT-3
[Pattern]	CPT-4
[Pattern]	CPT-5
[Pattern]	CPT-6
[Pattern]	CPT-7
[Pattern]	RUB-1
[Pattern]	RUB-2
[Pattern]	RUB-3
[Pattern]	LIN-1

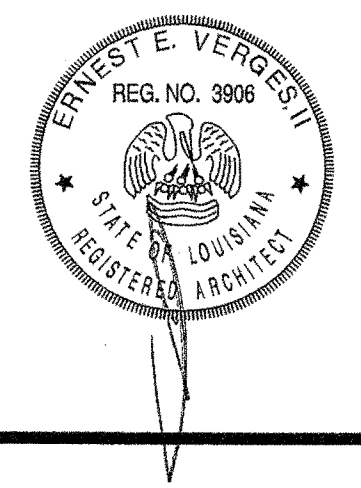
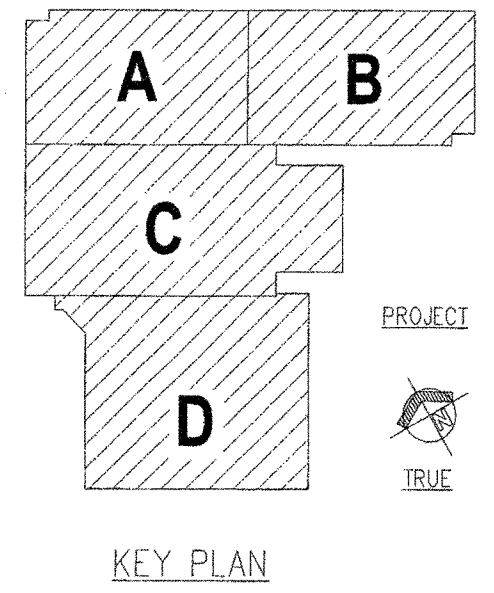

**NEW 3 SECTION ELEMENTARY SCHOOL
 AT FISK-HOWARD SCHOOL
 RECOVERY SCHOOL DISTRICT**
 211 S. LOPEZ STREET
 NEW ORLEANS, LOUISIANA 70119

DATE ISSUED: 7 DECEMBER, 2012
 REVISED:
 REVISED:
 REVISED:
 REVISED:
 DRAWN BY: HML
 CHECKED BY: DGR, JFM
 PHASE:

BID
 DOCUMENTS

11085

TITLE:
 1ST FLOOR
 FLOOR FINISHES

SHEET:

A6.03