

1 2ND FLOOR FINISH PLAN - OVERALL  
A6.04 SCALE: 1/16" = 1'-0"

**GENERAL NOTES**

1. ALL MECHANICAL AND ELECTRICAL ROOMS SHALL BE UNFINISHED.
2. ALL AREAS WITH CERAMIC TILE FLOORS/ WALLS SHALL HAVE CERAMIC TILE CODE BASE @ THE SAME SIZE AND FINISH AS THE CERAMIC WALL TILES.
3. ALL ROOMS/ AREAS WITH CERAMIC TILE WALLS AND FLOORS SHALL HAVE HANDLE THRESHOLD, AND SHALL BE INSTALLED UNDER DOORS AND Scribed TO FRAME PROFILE.
4. PROVIDE METAL TRANSITION STRIPS UNDER DOORS AT ROOMS THAT DO NOT HAVE CERAMIC TILE.
5. ALL QUARRY AND CERAMIC TILE AT RESTROOMS AND FOOD SERVICE AREAS TO HAVE NON-SLIP GROUT. CONVENTIONAL GROUT AT ALL OTHER AREAS.
6. SEALLY/CONCRETE AT COOLER/ FREEZER LOCATION IS A BASE FOR PRE-FABRICATED UNIT FLOORING. SEE STRUCTURALS FOR KITCHEN.
7. FINISHES SHOWN IN ONE AREA OF A ROOM OR CORRIDOR SHALL APPLY TO THE ENTIRE ROOM UNLESS OTHERWISE NOTED.
8. FIELD CARPET TILES (CPT 1-5) ARE TO BE INSTALLED CONTIGUOUSLY WITH THE LINEAR PATTERN RUNNING PARALLEL WITH THE DIRECTION OF THE SOLID COLOR CARPET TILE JOINTS (CPT 6).
9. ALL SOLID COLORED CARPET TILES (CPT 6) ARE TO BE INSTALLED QUARTER TURNED.
10. RECESSED SLABS ARE DIMENSIONED FROM INSIDE WALL TO INSIDE WALL WITH ALL CHAIR WALL CEILING/STAIRWAYS AT FINISH FLOOR. POLYRED STEEL WALLS OR CUT CHAIR ARE ACCEPTABLE SPACERS. REFER TO STRUCTURAL DRAWINGS FOR ADDITIONAL INFORMATION. FIELD VERIFY ALL DIMENSIONS.
11. ALL INTERIOR WALL PAINT SHALL BE AN EGG-SHELL FINISH UNLESS NOTED OTHERWISE.
12. ALL CLASSROOM DOOR ENTRANCE KNOCKERS TO BE PAINTED - #13.4 OR 5. REFER TO FINISH PLANS FOR DETAILS.
13. RETURN TERRAZZO BASE AND ALL WALL BASE INTO DOOR OPENINGS/ FRAMES.
14. ALL TRANSITIONS FROM TILE, TERRAZZO, QUARRY TILE, AND CONCRETE FLOORING TO EACH OTHER AND TO OTHER FLOORING FINISH MATERIALS SHALL BE MADE USING 1/2" FRAMING GROUT BED. NON-LEVEL FINISHED SURFACES WILL NOT BE ACCEPTED.

FLOOR FINISH LEGEND	
[Pattern]	TER-1
[Pattern]	TER-2
[Pattern]	TER-3
[Pattern]	TER-4
[Pattern]	VCT-1
[Pattern]	VCT-2
[Pattern]	VCT-3
[Pattern]	CT-1
[Pattern]	CT-2
[Pattern]	CT-3
[Pattern]	CPT-1
[Pattern]	CPT-2
[Pattern]	CPT-3
[Pattern]	CPT-4
[Pattern]	CPT-5
[Pattern]	CPT-6
[Pattern]	CPT-7
[Pattern]	RUB-1
[Pattern]	RUB-2
[Pattern]	RUB-3
[Pattern]	LIN-1

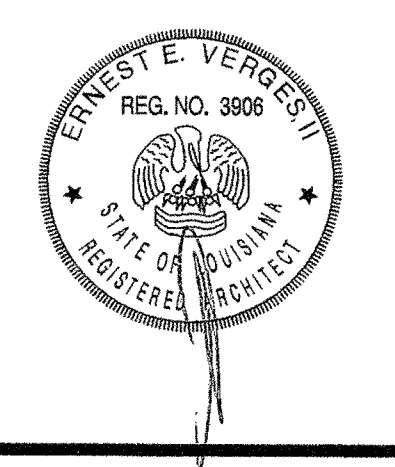
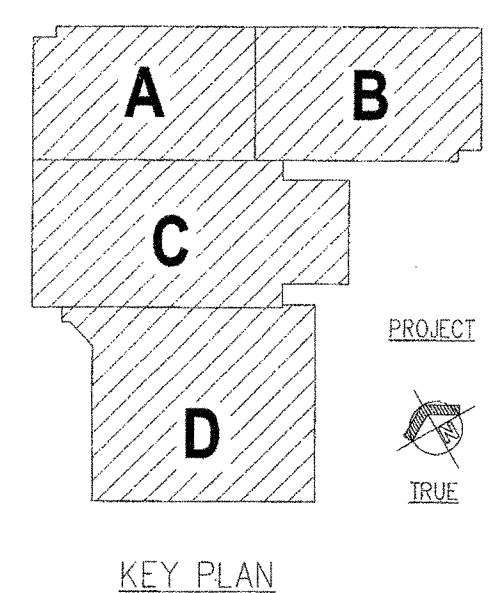

**NEW 3 SECTION ELEMENTARY SCHOOL  
AT FISK-HOWARD SCHOOL  
RECOVERY SCHOOL DISTRICT**

211 SLOPEZ STREET  
NEW ORLEANS, LOUISIANA 70119

DATE ISSUED: 7 DECEMBER, 2012  
REVISED:  
REVISED:  
REVISED:  
DRAWN BY: HML  
CHECKED BY: DGR, JFM  
PHASE:

BID  
DOCUMENTS

11085

TITLE:  
2ND FLOOR  
FLOOR FINISHES

SHEET:  
A6.04