

- PLAN NOTES: UNLESS NOTED OTHERWISE:**
1. SEE SHEET S1.09.
 2. BOTTOM CHORD OF JOIST ORDERS TO BE DESIGNED TO CARRY A 3 KIP LOAD IN BENDING BTWN. PANEL POINTS.
 3. 72G15N7.OK () - INDICATES SLOPING TOP CHORD. SEE 2/S1.12.
 4. W14x30() - INDICATES CONTINUOUS BEAM BENT OVER ROOF RIDGE. PROVIDE FULL-PEN MOMENT CONNECTION.
 5. [Hatched Area] - INDICATES ROOF SYSTEM TO CONSIST OF 1/2" DEEP TYPE "BA" 20 GAGE GALVANIZED ACOUSTICAL METAL ROOF DECKING. SEE ARCHITECTURAL DRAWINGS FOR INSULATION & ROOFING ON TOP OF DECKING.
 6. PROVIDE ADDIT'L ROW OF 3/8" PUDDLE WELDS AT 6" O.C. AT DECK TO BEAM OR DECK TO JOIST ATTACHMENT.

1 PARTIAL 3RD FLOOR & GYMNASIUM
ROOF FRAMING PLAN
1/8"=1'-0"

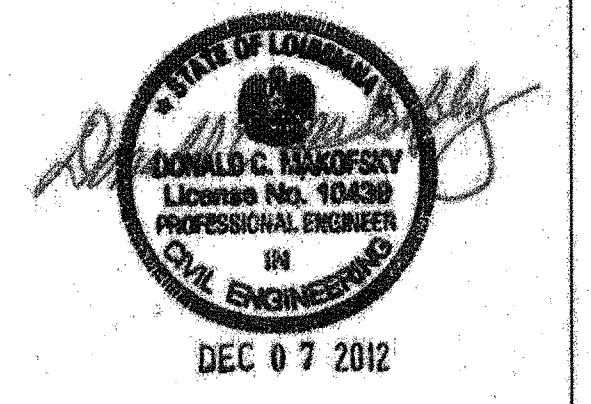
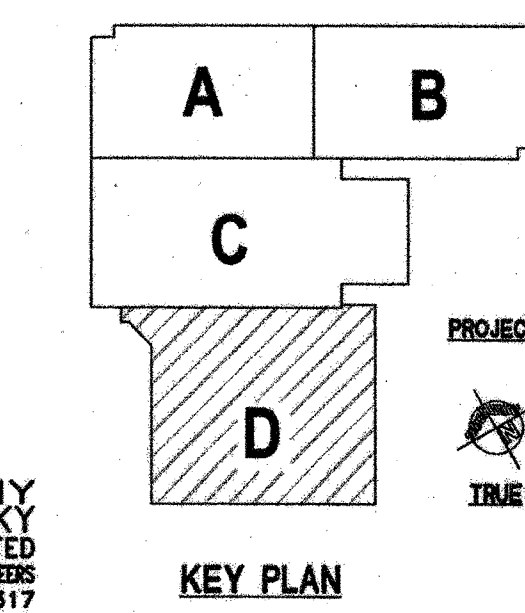

**NEW 3 SECTION ELEMENTARY SCHOOL
AT FISK-HOWARD SCHOOL
RECOVERY SCHOOL DISTRICT**

211 S. LOPEZ STREET NEW ORLEANS, LOUISIANA 70119

DATE ISSUED:	7 DECEMBER, 2012
REVISED:	
REVISED:	
REVISED:	
REVISED:	
DRAWN BY:	WFD
CHECKED BY:	JAS
PHASE:	

BID DOCUMENTS

11085

TITLE:
3RD FLR. UNIT D & LOW ROOF FRAMING PLAN

SHEET:

S1.12

