

NOTE: UNLESS NOTED OTHERWISE:  
1. ELEVATIONS ARE TO TOP OF STEEL.

**1** ELEVATION-BRACING AT  
COLUMN LINE C  $1/8"=1'-0"$

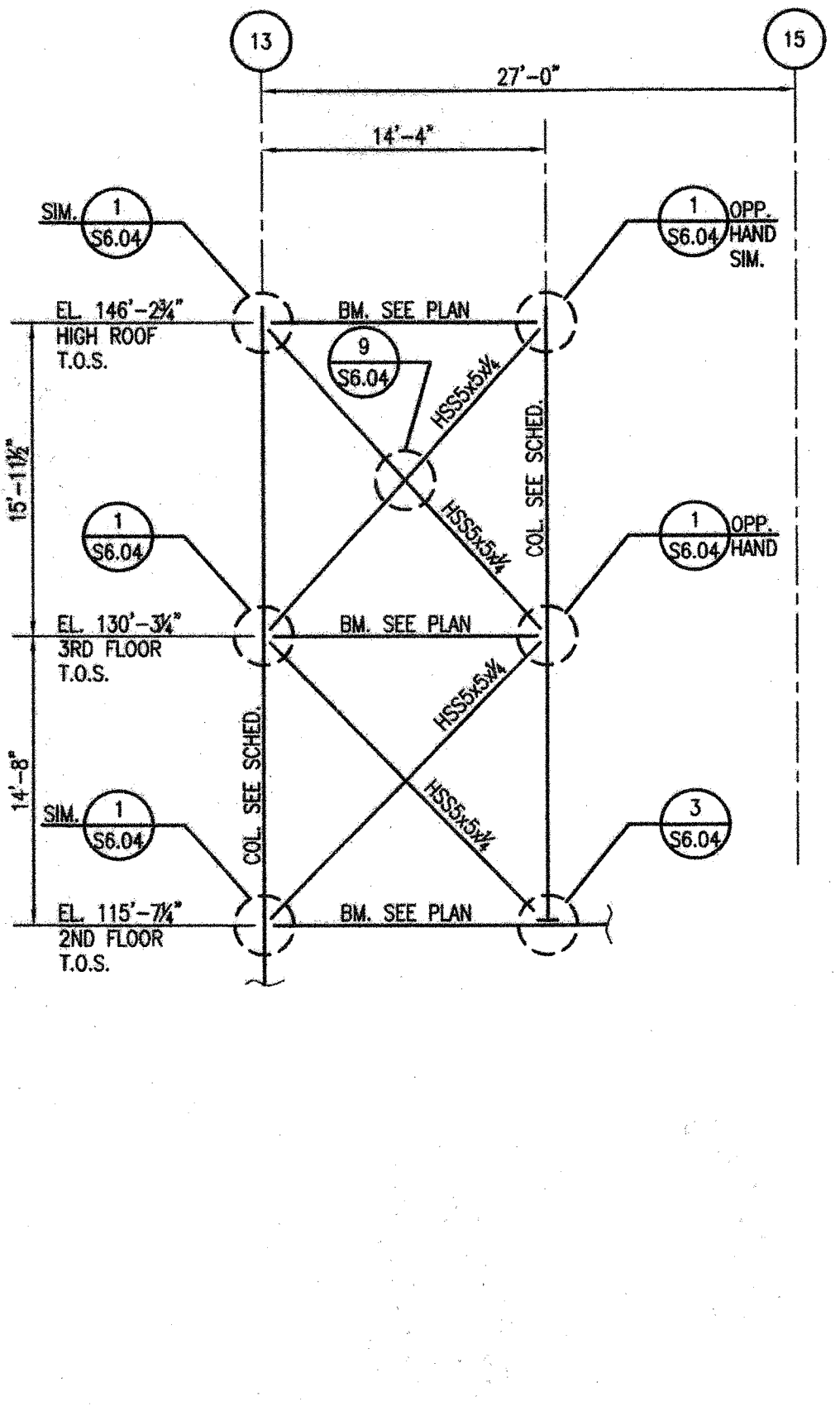

NOTE: UNLESS NOTED OTHERWISE:  
1. ELEVATIONS ARE TO TOP OF STEEL.

**2** ELEVATION-BRACING AT  
COLUMN LINE C  $1/8"=1'-0"$

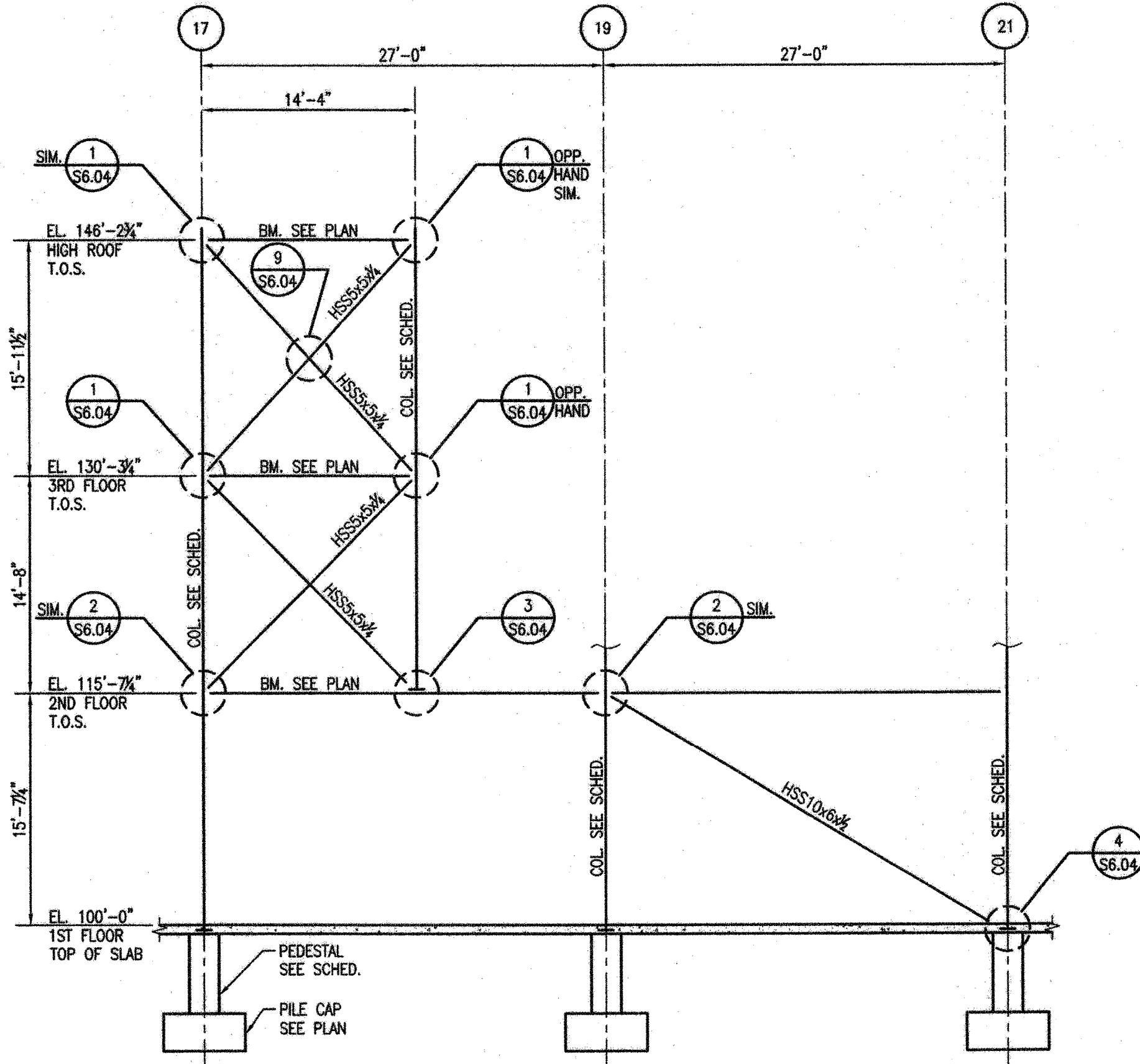

NOTE: UNLESS NOTED OTHERWISE:  
1. ELEVATIONS ARE TO TOP OF STEEL.

**3** ELEVATION-BRACING AT  
COLUMN LINE C  $1/8"=1'-0"$

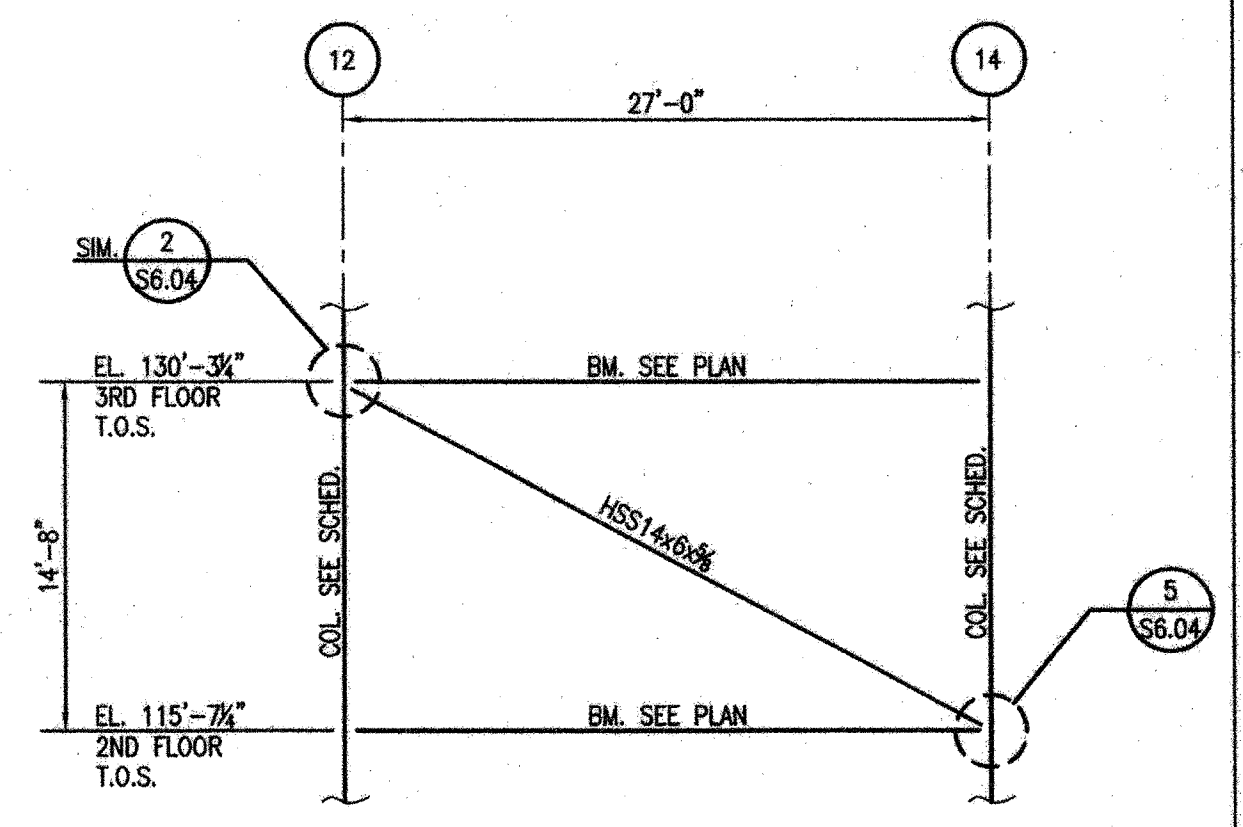

NOTE: UNLESS NOTED OTHERWISE:  
1. ELEVATIONS ARE TO TOP OF STEEL.

**4** ELEVATION-BRACING AT  
COLUMN LINE D  $1/8"=1'-0"$

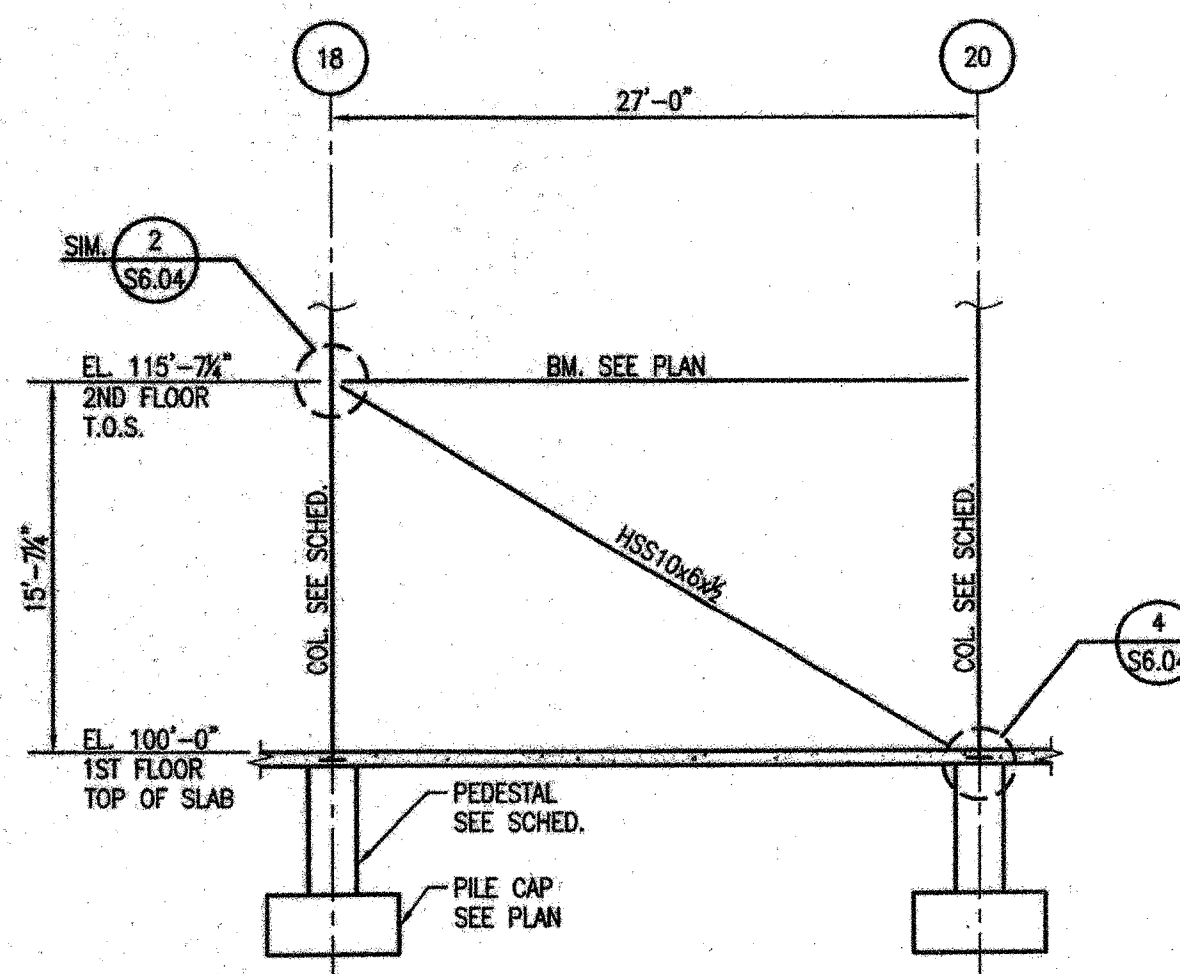

NOTE: UNLESS NOTED OTHERWISE:  
1. ELEVATIONS ARE TO TOP OF STEEL.

**5** ELEVATION-BRACING AT  
COLUMN LINE D  $1/8"=1'-0"$

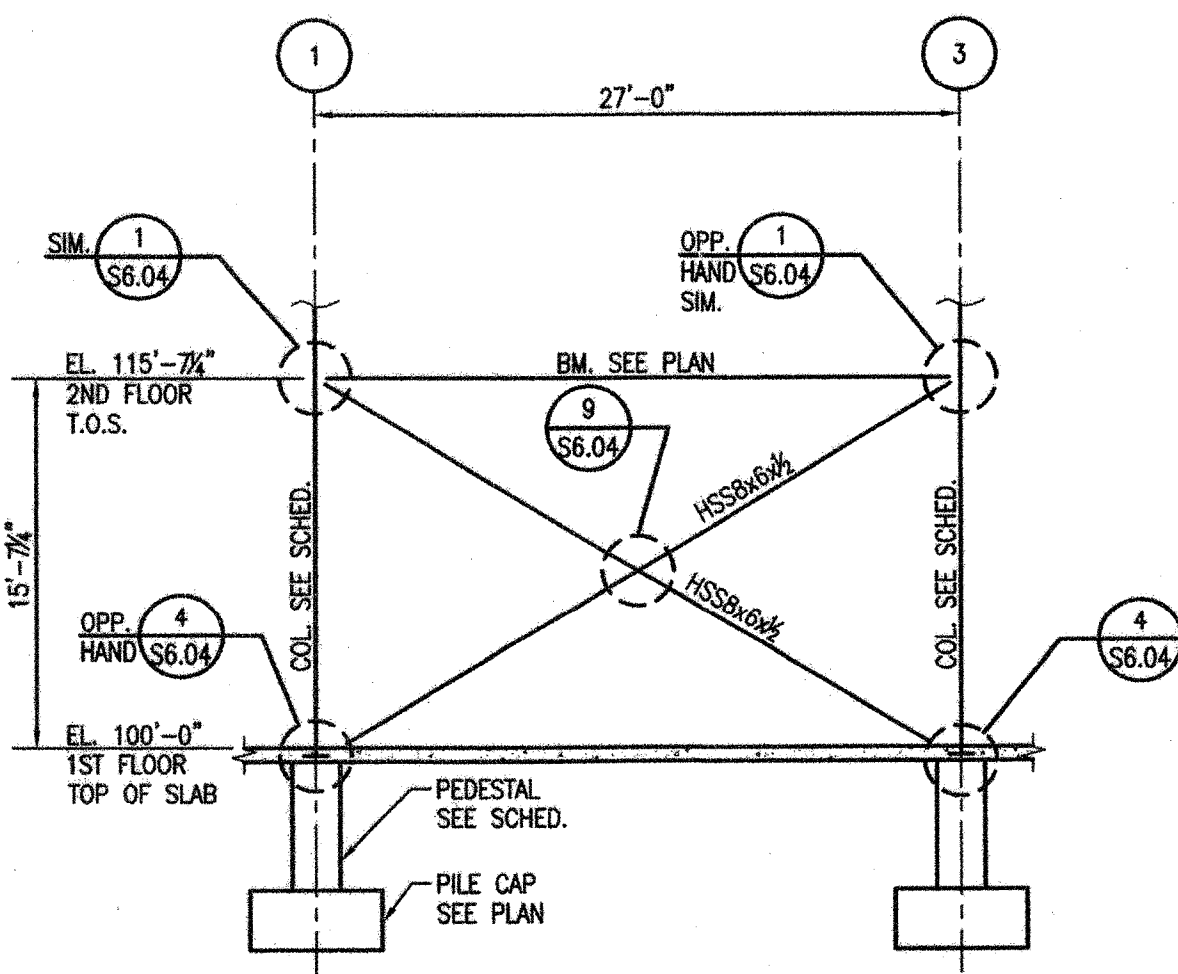

NOTE: UNLESS NOTED OTHERWISE:  
1. ELEVATIONS ARE TO TOP OF STEEL.

**6** ELEVATION-BRACING AT  
COLUMN LINE E  $1/8"=1'-0"$

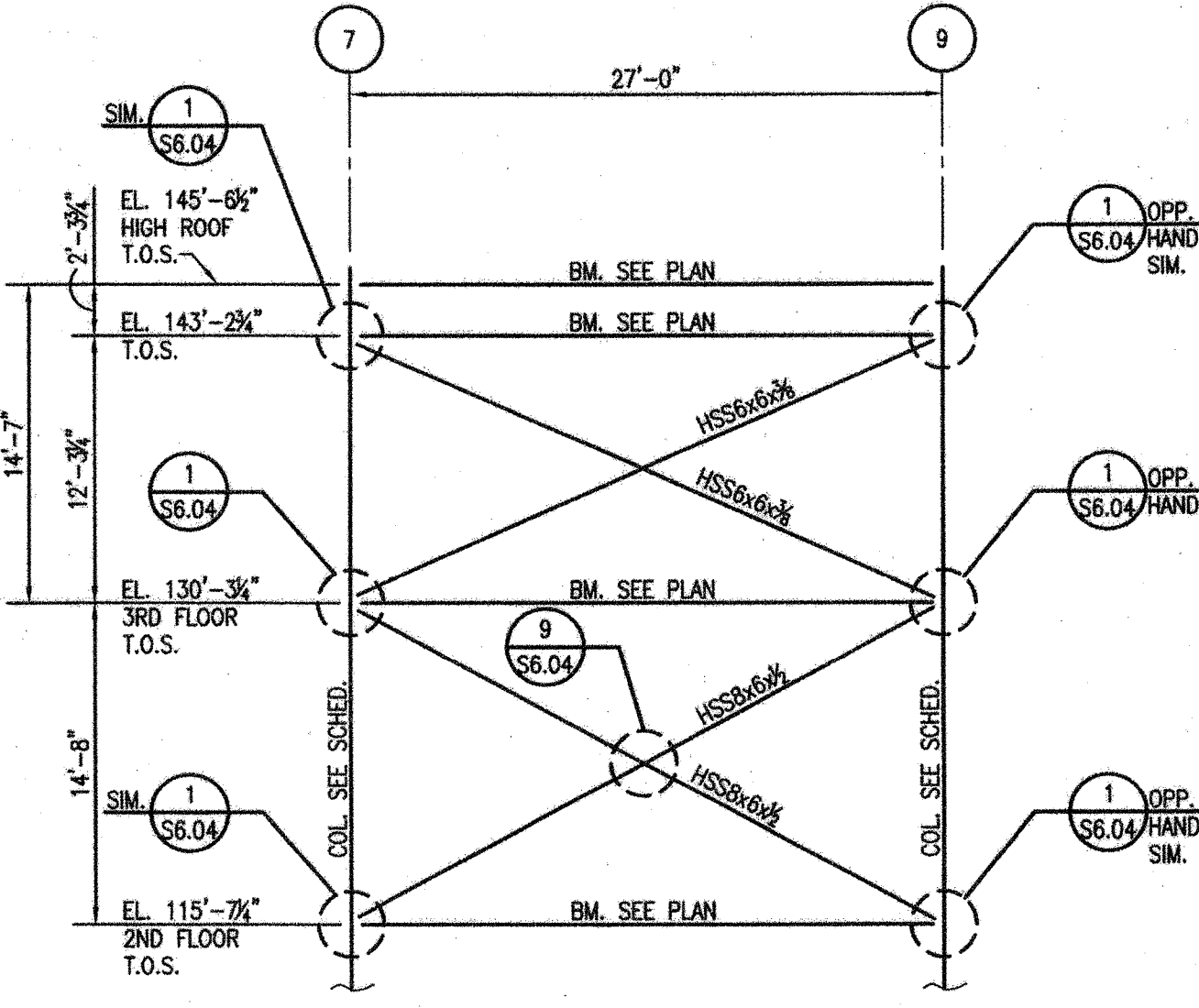

NOTE: UNLESS NOTED OTHERWISE:  
1. ELEVATIONS ARE TO TOP OF STEEL.

**7** ELEVATION-BRACING AT  
COLUMN LINE E  $1/8"=1'-0"$

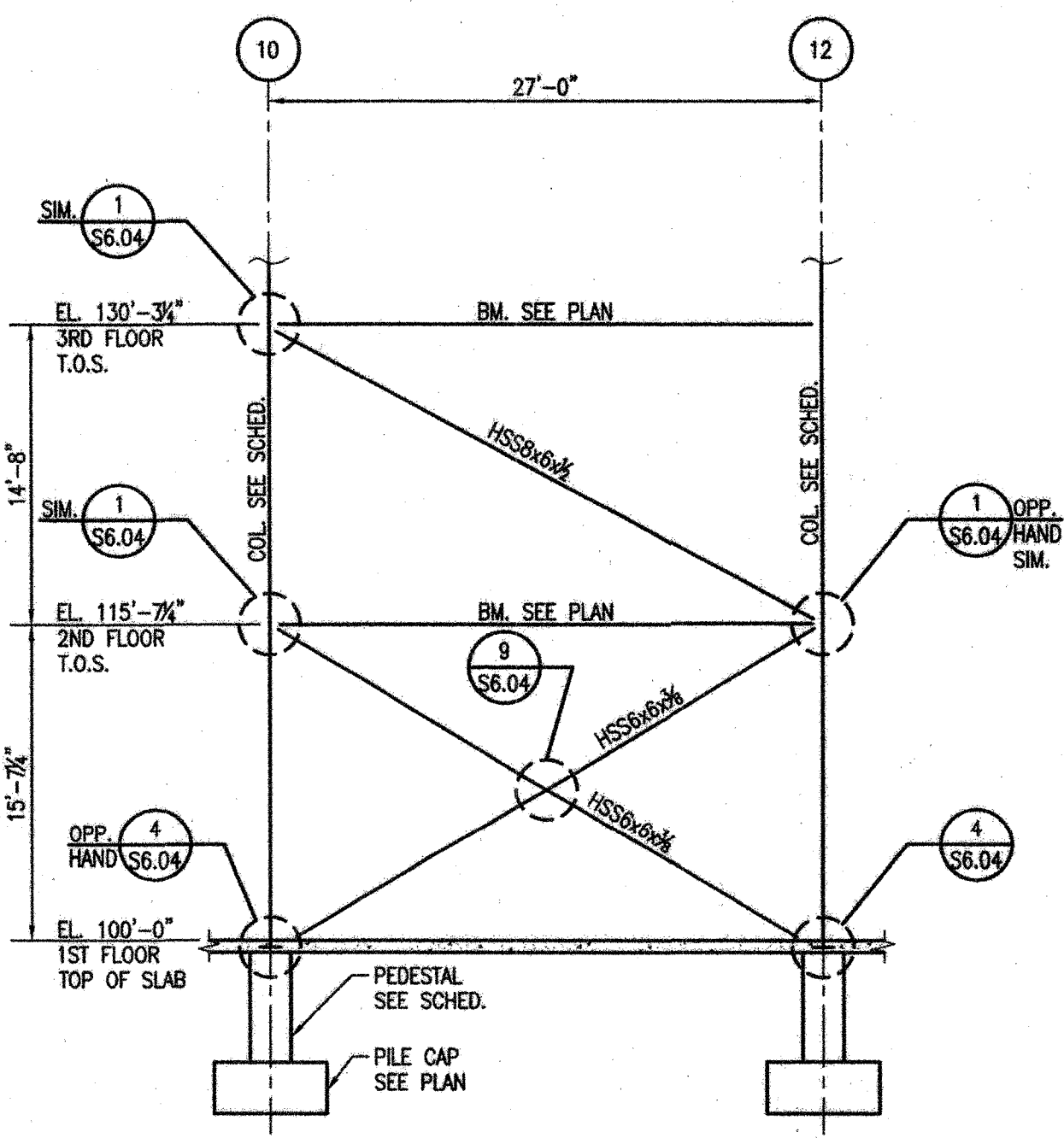

NOTE: UNLESS NOTED OTHERWISE:  
1. ELEVATIONS ARE TO TOP OF STEEL.

**8** ELEVATION-BRACING AT  
COLUMN LINE E  $1/8"=1'-0"$

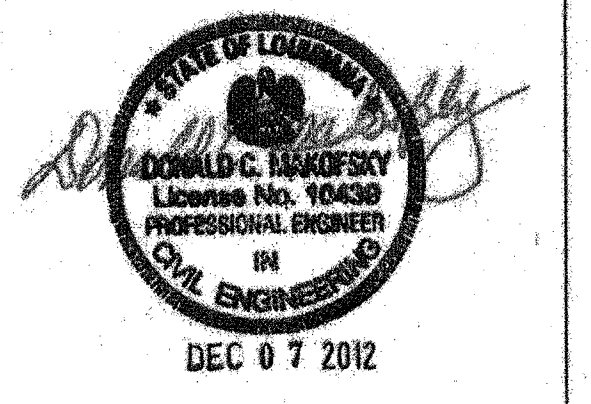

**NEW 3 SECTION ELEMENTARY SCHOOL  
AT FISK-HOWARD SCHOOL  
RECOVERY SCHOOL DISTRICT**

NEW ORLEANS, LOUISIANA 70119  
211 S. LOPEZ STREET

DATE ISSUED: 7 DECEMBER, 2012

REVISED:

REVISED:

REVISED:

REVISED:

DRAWN BY: WFD

CHECKED BY: JAS

PHASE: