

A/C = Mrs. ~~Hand~~ C and Davis
 N/C = new climate controlled

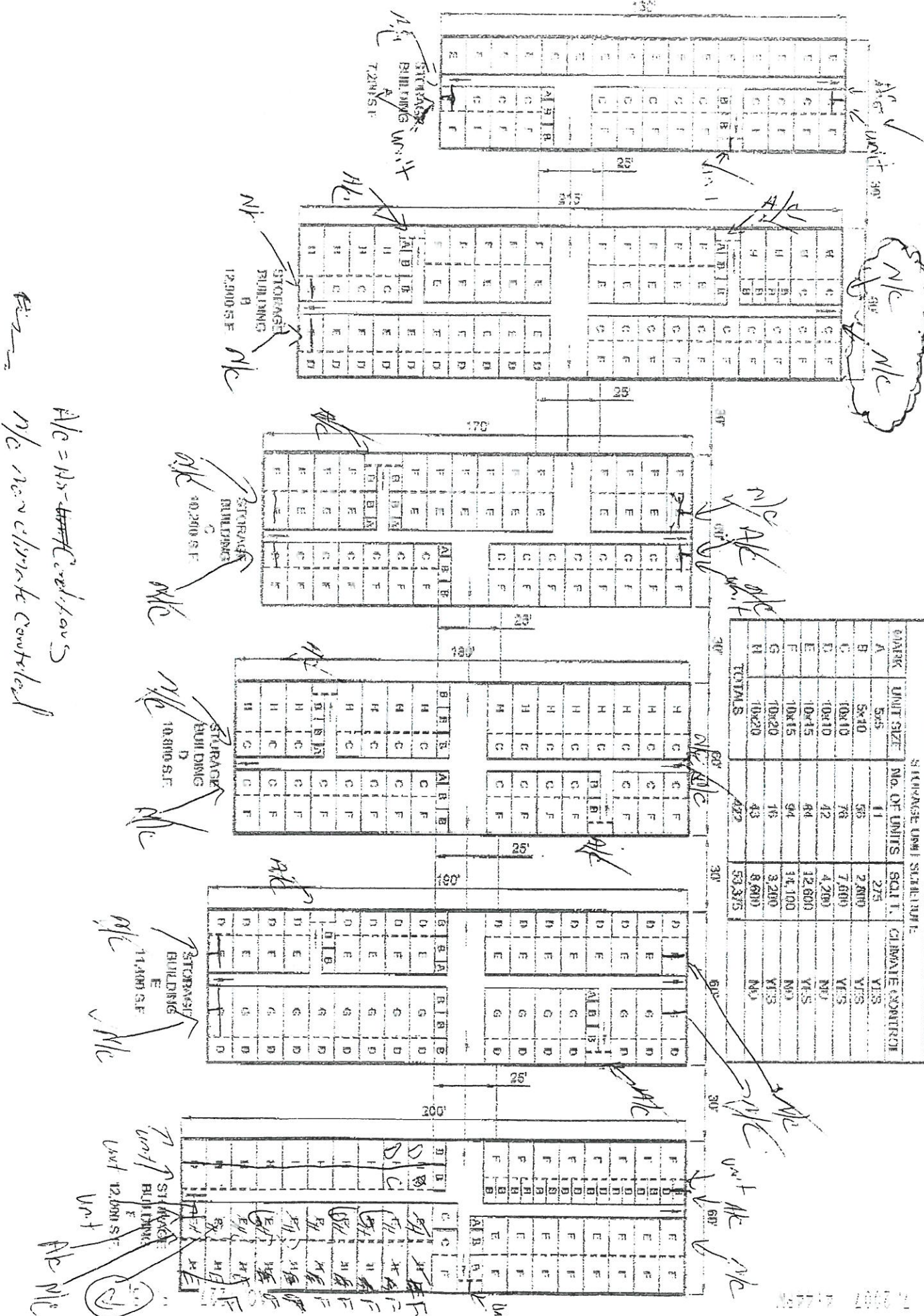

APPROXIMATE USM/STABLE UNIT

MARK	UNIT SIZE	NO. OF UNITS	SCOTT	CLIMATE CONTROL
A	5x5	11	275	YES
B	5x10	38	2,800	YES
C	10x10	78	7,600	YES
D	10x10	42	4,200	NO
E	10x15	44	12,600	YES
F	10x15	94	14,100	NO
G	10x20	19	3,200	YES
H	10x20	43	8,600	NO
TOTALS		432	53,375	

SCOTT
 201.0735