

BUILDING CODE INFORMATION

APPLICABLE CODE(S)
IBC 2009

OCCUPANCY TYPE OF GROUP(S) (IBC 2009 CHAPTER 3)
FACTORY F-1

CONSTRUCTION TYPE(S) (TABLE 503)
IB UNLIMITED AREA BUILDING (SECTION 507)

ALLOWABLE HEIGHT AND BUILDING AREA LIMITED BY TYPE OF CONSTRUCTION

MAXIMUM HEIGHT IN STORIES (SECTION 503 & 504, TABLE 503) - 1
MAXIMUM AREA IN SQUARE FEET (SECTION 503, 506 & 507, TABLE 503) - UNLIMITED PER SECTION 507)

MIXED USE AND OCCUPANCY
SECTION 508
INCIDENTAL ACCESSORY OCCUPANCIES (HR) (TABLE 508.2.5)
ROOM OR AREA SEPARATION
N/A
REQUIRED SEPARATION OR OCCUPANCIES (HR) (TABLE 508.4)
N/A

FIRE RESISTANCE RATING REQUIREMENTS FOR BUILDING ELEMENTS
CHAPTER 6, TABLE 601

STRUCTURAL FRAMES - 0 HOURS
EXTERIOR BEARING WALLS - 0 HOURS
INTERIOR BEARING WALLS - 0 HOURS
EXTERIOR NON-BEARING WALLS - 0 HOURS
INTERIOR NON-BEARING WALLS - 0 HOURS
FLOOR CONSTRUCTION (INCLUDING SUPPORTING BEAMS AND JOISTS) - 0 HOURS
ROOF CONSTRUCTION (INCLUDING SUPPORTING BEAMS AND JOISTS) - 0 HOURS
FIRE RESISTANCE RATING FOR EXTERIOR WALLS BASED ON FIRE SEPARATION DISTANCE (TABLE 602) - 0 HOURS

MAXIMUM AREA OF EXTERIOR WALL OPENINGS
TABLE 105.8

NOTES ON SPECIFIC, PERTINENT PLAN ISSUES
15' SEPARATION UNLIMITED, SPRINKLERED)

FIRE WALLS
SECTION 706, TABLE 706.4
REQUIRED? NO
IF YES THEN NOTE REQUIRED RATING - N/A

FIRE BARRIERS
SECTION 707
SHAFT ENCLOSURE(S) - NOTE REQUIRED RATING (SECTION 708.4) - NO - PER 708.2.1.1
EXIT ENCLOSURE - NOTE REQUIRED RATING (SECTION 1022.1) - 1 HOUR
EXIT PASSAGEWAY - NOTE REQUIRED RATING (SECTION 1023.3) - 1 HOUR
HORIZONTAL EXIT - NOTE REQUIRED RATING (SECTION 1025.2) - 2 HOURS
ATRIUMS - NOTE REQUIRED RATING (SECTION 404.6) - N/A
SEPARATION FROM STAGE (SECTION 410.5) - N/A

OCCUPANT LOADS
(IBC 2009 SECTION 1004, TABLE 1004.1.1)
FIRST FLOOR
OCCUPANCY/FUNCTION OF SPACE FLOOR AREA PER OCCUPANT (SF) X ACTUAL SF OCCUPANT LOAD
F-1 100 S.F. PER OCCUPANT, 350 S.F. 34

EXIT REQUIREMENTS
(IBC 2009 SECTION 1025)
NUMBER OF ACCESSIBLE MEANS OF EGRESS REQUIRED PER FLOOR (TABLE 1015.1 & 1021.1)
FLOOR # MEANS OF EGRESS REQUIRED
FIRST FLOOR 1

TOTAL WIDTH OF EXITS
(OCCUPANT LOAD * OF MEANS OF EGRESS) X (FACTOR IN SECTION 1005)
OCCUPANT LOAD # OF EXITS PROVIDED MULTIPLIER (SECTION 1005.1) MINIMUM EXIT WIDTH
34 42 0.2 34

MAXIMUM EXIT ACCESS TRAVEL DISTANCE (TABLE 1016.1) - 250'
MINIMUM CORRIDOR WIDTH (SECTION 1018.1 & SECTION 1005.1) - 44'
MAXIMUM DEAD END CORRIDOR (1018.4) - 50'
MAXIMUM COMMON PATH OF TRAVEL (1014.3) - 100'

LIFE-SAFETY INFORMATION

APPLICABLE CODE(S)
NFPA 101 LIFE SAFETY CODE 2009
OCCUPANCY TYPE(S) AND CHAPTER(S)
INDUSTRIAL (CHAPTER 40)
MULTIPLE, MIXED, OR SEPARATED OCCUPANCY (REFERENCE: CHAPTER 6)
N/A
REQUIRED SEPARATION OF OCCUPANCIES (REFERENCE: CHAPTER 6, TABLE 6.1.1.4.1)
N/A
CLASSIFICATION OF HAZARD OF CONTENTS (REFERENCE: OCCUPANCY CHAPTER AND 6.2.2; SPECIFY LOW, ORDINARY, OR HIGH)
ORDINARY
CONSTRUCTION TYPE(S) (REFERENCE: CHAPTER 5, TABLE A.5.2.1.2 AND COMMENTARY TABLE 5.1 IN HANDBOOK)
II (OOO)
MINIMUM CONSTRUCTION REQUIREMENTS (REFERENCE: OCCUPANCY CHAPTER)
SPRINKLERED
APPLICABLE DEFINITIONS (REFERENCE: CHAPTER 3)
N/A

OCCUPANCY
OCCUPANT LOAD CALCULATIONS (REFERENCE: TABLE 7.3.1.2)
FIRST FLOOR
OCCUPANCY/FUNCTION OF SPACE FLOOR AREA PER OCCUPANT (SF) X ACTUAL SF OCCUPANT LOAD
INDUSTRIAL 100 S.F. 3,350 S.F. 34
TOTAL OCCUPANT LOAD - FIRST FLOOR

INCIDENTAL USE AREAS AND REQUIRED SEPARATION
ROOM OR AREA SEPARATION
N/A

MEANS OF EGRESS
NUMBER OF EXITS (REFERENCE: OCCUPANCY CHAPTER AND CHAPTER 7)
2
MINIMUM EXIT SEPARATION DISTANCE FOR REMOTELY LOCATED EXITS (REFERENCE: SECTION 7.5; SPECIFY 1/2 OR 1/3 DIAGONAL DISTANCE OF AREA SERVED)
1/3 DIAGONAL = 33'-0"
MAXIMUM DEAD-END CORRIDORS (REFERENCE: OCCUPANCY CHAPTER AND TABLE A.7.6)
50'
MAXIMUM COMMON PATH OF TRAVEL DISTANCE (REFERENCE: OCCUPANCY CHAPTER AND TABLE A.7.6)
75'
MAXIMUM TRAVEL DISTANCE TO EXITS (REFERENCE: OCCUPANCY CHAPTER AND TABLE A.7.6)
150'
AREA OF REFUGE REQUIREMENTS (REFERENCE: OCCUPANCY CHAPTER AND 7.2.12)
N/A
CORRIDOR OR PASSAGEWAY WIDTH REQUIREMENTS (REFERENCE: OCCUPANCY CHAPTER, TABLE 7.2.2.1.1(A) OR (B), AND TABLE 7.2.2.1.2(B))
N/A
STAR WIDTH REQUIREMENTS (REFERENCE: OCCUPANCY CHAPTER, TABLE 7.2.2.1.1(A) OR (B), AND TABLE 7.2.2.1.2(B))
44"
ACCESSIBILITY REQUIREMENTS FOR EGRESS COMPONENTS (7.5.4)
XXX
CAPACITY OF MEANS OF EGRESS (REFERENCE: 7.5 AND TABLE 7.3.3.1)
COMPONENT OCCUPANT LOAD X CAPACITY FACTOR MINIMUM WIDTH
EXITS 34 0.2 34
*MAIN ENTRANCE MUST BE SIZED TO ACCOMMODATE 1/2 OCCUPANT LOAD OF BUILDING.

FIRE RESISTANCE RATING REQUIREMENTS
CHAPTER 6
EXTERIOR BEARING WALLS (REFERENCE TABLE A.5.2.1.2 BASED ON CONSTRUCTION TYPE) - 0 HOURS
INTERIOR BEARING WALLS (REFERENCE TABLE A.5.2.1.2 BASED ON CONSTRUCTION TYPE) - 0 HOURS
COLUMNS (REFERENCE TABLE A.5.2.1.2 BASED ON CONSTRUCTION TYPE) - 0 HOURS
BEAMS, GIRDER, TRUSSES, AND ARCHES (REFERENCE TABLE A.5.2.1.2 BASED ON CONSTRUCTION TYPE) - 0 HOURS
FLOOR - CEILING ASSEMBLIES (REFERENCE TABLE A.5.2.1.2 BASED ON CONSTRUCTION TYPE) - 0 HOURS
ROOF - CEILING ASSEMBLIES (REFERENCE TABLE A.5.2.1.2 BASED ON CONSTRUCTION TYPE) - N/A
INTERIOR NON-BEARING WALLS (REFERENCE TABLE A.5.2.1.2 BASED ON CONSTRUCTION TYPE) - 0 HOURS
EXTERIOR NON-BEARING WALLS (REFERENCE TABLE A.5.2.1.2 BASED ON CONSTRUCTION TYPE) - 0 HOURS
SHAFT ENCLOSURE (SECTION 6.6.5) - 0 HOURS
EXIT ENCLOSURE - 1 HOUR
EXIT PASSAGEWAY / EXIT ACCESS CORRIDORS - N/A
HORIZONTAL EXIT - 2 HOURS
ATRIUMS - N/A
MEZZANINES - N/A
CONCEALED SPACES AND DRAFTSTOPS - N/A
STORAGE, BOILER, OR FURNACE ROOMS - N/A
COMMUNICATING SPACES (SECTION 6.6.6) - N/A

OPENING PROTECTIVES
CHAPTER 8, TABLE 8.3.4.2
COMPONENT WALLS & PARTITIONS FIRE RATING (HR) FIRE DOOR ASSEMBLIES FIRE WINDOW ASSEMBLIES (HR)
ELEVATOR: 1 HR 1 HR
STAIRWAYS: 1 HR 1 HR
SMOKE BARRIERS: 1 HR 1/3 HR

ADDITIONAL CODE REQUIREMENTS
OCCUPANCY CHAPTER 36
EXTINGUISHMENT REQUIREMENTS - SPRINKLER (REQUIRED)
SUBDIVISION OF BUILDING SPACE - N/A
DETECTION, ALARM, AND COMMUNICATIONS SYSTEMS - NO
EMERGENCY LIGHTING - PER 308.2.6
SPECIAL PROVISIONS - STAGES AND PLATFORMS: N/A
OTHER - N/A
EMERGENCY LIGHTING - XXX

ALLOWABLE HEIGHT AND BUILDING AREA
PER IBC EQUIVALENT CONSTRUCTION TYPE (REFERENCE COMMENTARY TABLE 5.1 IN THE HANDBOOK)
CONSTRUCTION TYPE (NFPA) - II (OOO)
CONSTRUCTION TYPE (IBC) - IIB (UNLIMITED AREA BUILDING - SECTION 507)
MAXIMUM HEIGHT IN STORIES (REFERENCE: IBC TABLE 503) - 1 PER IBC SECTION 507
MAXIMUM HEIGHT IN FEET (REFERENCE: IBC TABLE 503) - N/A
MAXIMUM AREA IN SQUARE FEET (REFERENCE: IBC TABLE 503) - IIB (UNLIMITED AREA BUILDING - SECTION 507)

LEGEND

- SYMBOLS
- EXIT
 - DOOR FIRE RATING (MINUTES)
 - DOOR WIDTH/EGRESS CAPACITY
 - EXIT LIGHT
 - FIRE EXTINGUISHER CABINET
 - FIRE EXTINGUISHER W/ WALL MOUNTED BRACKET
 - COMMON PATH OF TRAVEL/TRAVEL DISTANCE
 - TRAVEL DISTANCE
 - DECISION POINT

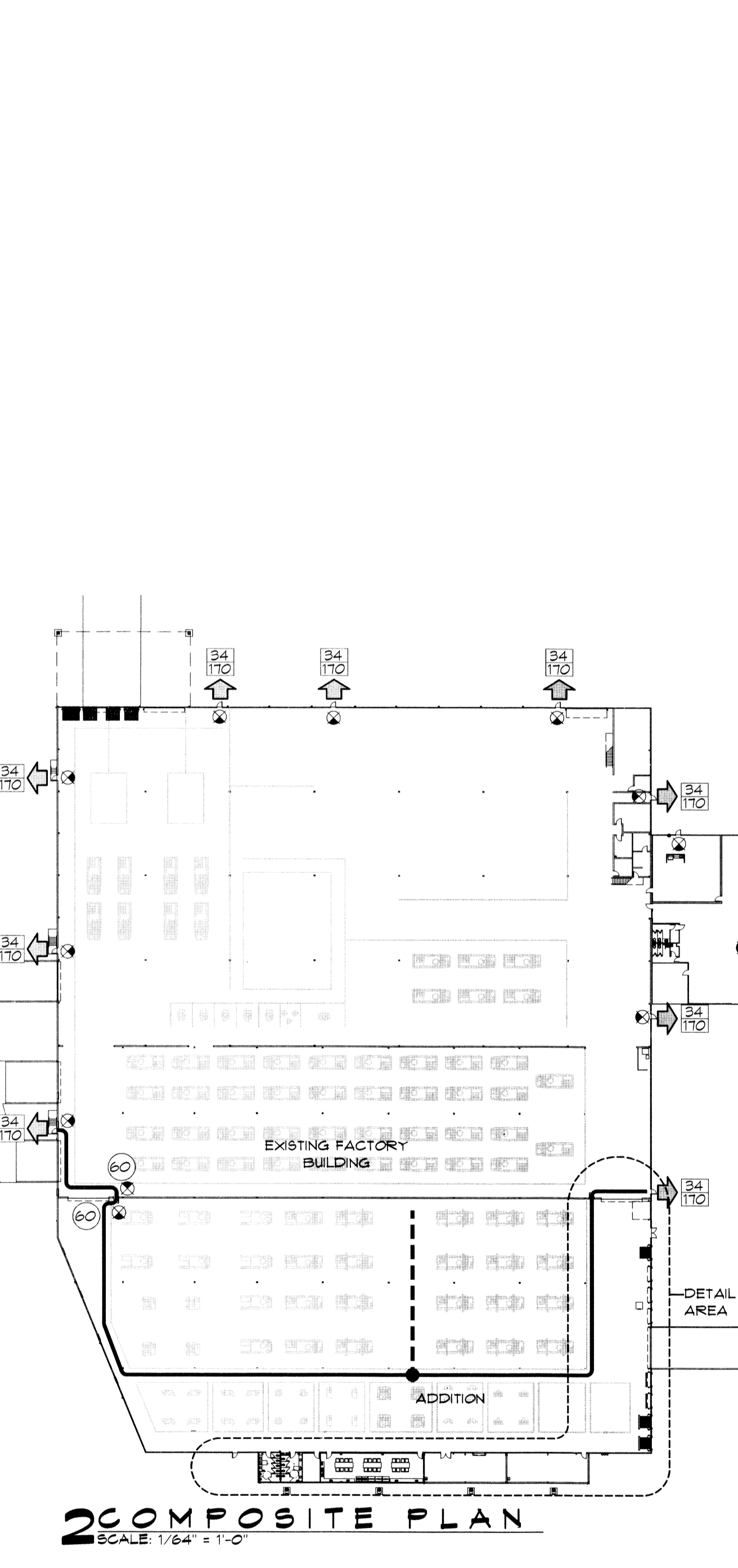

MWFRS WIND LOAD CALCS

ENCLOSED SIMPLE DIAPHRAM LOW-RISE BUILDINGS
RISK CATEGORY TABLE 15-1 CATEGORRY II
BASIC WIND SPEED 141 MPH
WIND LOAD PARAMETERS
A. SURFACE ROUGHNESS, SECTION 26.7.2: ROUGHNESS B
B. EXPOSURE CATEGORY, SECTION 26.7.3: EXPOSURE B
C. TOPOGRAPHIC FACTOR, SECTION 26.8.2: Kt = 1
WIND PRESSURES FIG 26.6-1 LOAD CASE 1 FOR ROOF SLOPE 30°

METAL BUILDING REQUIREMENTS

MAIN WIND FORCE RESISTING COMPONENTS
THE DESIGN, FABRICATION, AND ERECTION OF STRUCTURAL STEEL FOR BUILDINGS AND STRUCTURES SHALL BE IN ACCORDANCE WITH EITHER THE AISI LOAD AND RESISTANCE FACTOR DESIGN SPECIFICATION FOR STRUCTURAL BUILDINGS (AISC-LRFD), AISI SPECIFICATIONS FOR STRUCTURAL STEEL BUILDINGS-ALLOWABLE STRESS DESIGN (AISC-ASD) OR AISI SPECIFICATION FOR THE DESIGN OF STEEL HOLLOW STRUCTURAL SECTIONS (AISC-HSS). WIND LOAD DESIGN OF STEEL HOLLOW STRUCTURAL SECTIONS (AISC-HSS). WIND LOAD DESIGN OF 130 MPH.
ROOF COVERING HAS BEEN DESIGNED IN ACCORDANCE WITH THE REQUIREMENTS SET FORTH IN IBC SECTION 1501.
CONTRACTOR NOTE:
EACH CONTRACTOR RESPONSIBLE FOR THE CONSTRUCTION OF A MAIN WIND FORCE-RESISTING COMPONENT OF THIS BUILDING SHALL SUBMIT A WRITTEN CONTRACTOR'S STATEMENT OF RESPONSIBILITY TO THE BUILDING OFFICIAL AND OWNER PRIOR TO COMMENCEMENT OF THE WORK ON THAT COMPONENT. (IBC 1106.3)

OPENING PROTECTIVES

CHAPTER 8, TABLE 8.3.4.2
COMPONENT WALLS & PARTITIONS FIRE RATING (HR) FIRE DOOR ASSEMBLIES FIRE WINDOW ASSEMBLIES (HR)
ELEVATOR: 1 HR 1 HR
STAIRWAYS: 1 HR 1 HR
SMOKE BARRIERS: 1 HR 1/3 HR

ADDITIONAL CODE REQUIREMENTS
OCCUPANCY CHAPTER 36
EXTINGUISHMENT REQUIREMENTS - SPRINKLER (REQUIRED)
SUBDIVISION OF BUILDING SPACE - N/A
DETECTION, ALARM, AND COMMUNICATIONS SYSTEMS - NO
EMERGENCY LIGHTING - PER 308.2.6
SPECIAL PROVISIONS - STAGES AND PLATFORMS: N/A
OTHER - N/A
EMERGENCY LIGHTING - XXX

ALLOWABLE HEIGHT AND BUILDING AREA
PER IBC EQUIVALENT CONSTRUCTION TYPE (REFERENCE COMMENTARY TABLE 5.1 IN THE HANDBOOK)
CONSTRUCTION TYPE (NFPA) - II (OOO)
CONSTRUCTION TYPE (IBC) - IIB (UNLIMITED AREA BUILDING - SECTION 507)
MAXIMUM HEIGHT IN STORIES (REFERENCE: IBC TABLE 503) - 1 PER IBC SECTION 507
MAXIMUM HEIGHT IN FEET (REFERENCE: IBC TABLE 503) - N/A
MAXIMUM AREA IN SQUARE FEET (REFERENCE: IBC TABLE 503) - IIB (UNLIMITED AREA BUILDING - SECTION 507)

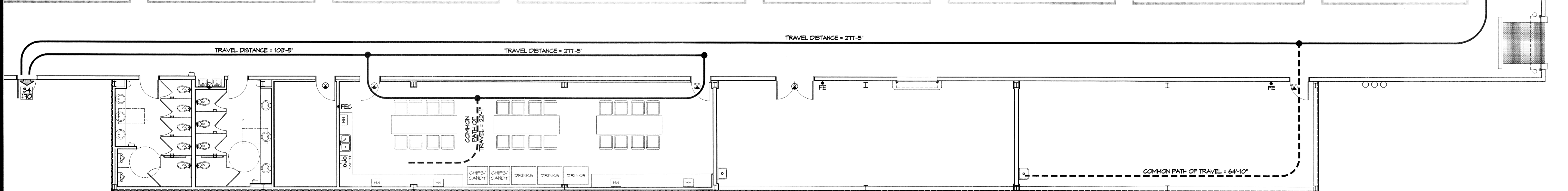

LIFE-SAFETY PLAN

SCALE: 1/8" = 1'-0"

DAMMON
ENGINEERING, INC.
Architects & Engineers

Chief Architect: Kevin J. Kitchin, N.CARB
dammoneng@bellsouth.net
554 Old Spanish Trail
Slidell, LA 70458
Ph: 985.649.5832
F: 985.641.9950

#	DESCRIPTION	DATE

ADDITIONS AND RENOVATIONS:
TEXTRON
Marine & Land Systems

252 STONE ROAD
SLIDELL, LOUISIANA

JOB NO: 11-27-2013
DATE: 11/27/2013
DRAWN BY: KJK
CHECKED BY: KJK

SHEET TITLE:
LIFE-SAFETY PLAN AND
CODE INFORMATION

DRAWING NUMBER:
G2

SHEET No: 3 of 25