

Components and Cladding

$h \leq 60$ ft.

Figure 30.4-6

External Pressure Coefficients, GC_p

Sawtooth Roofs

Enclosed, Partially Enclosed Buildings

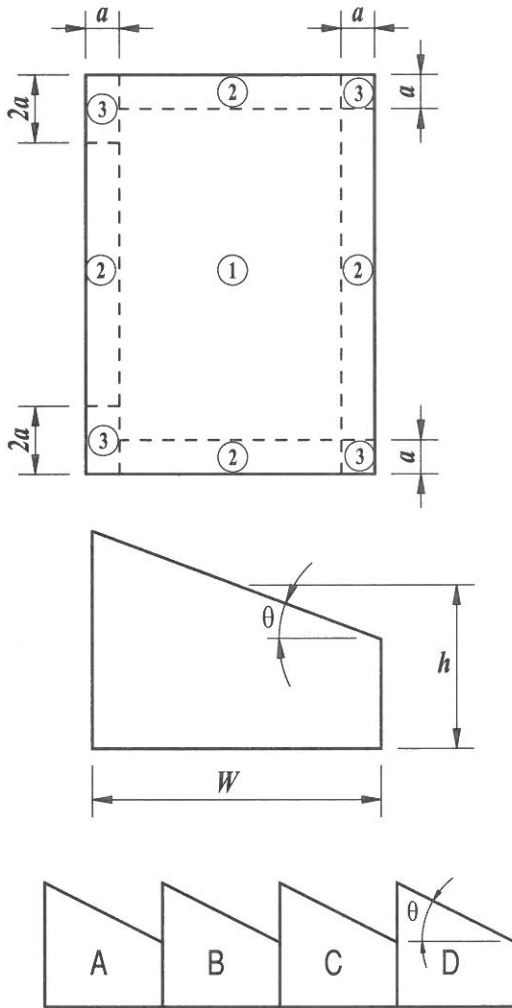

Elevation of Building
(2 or More Spans)

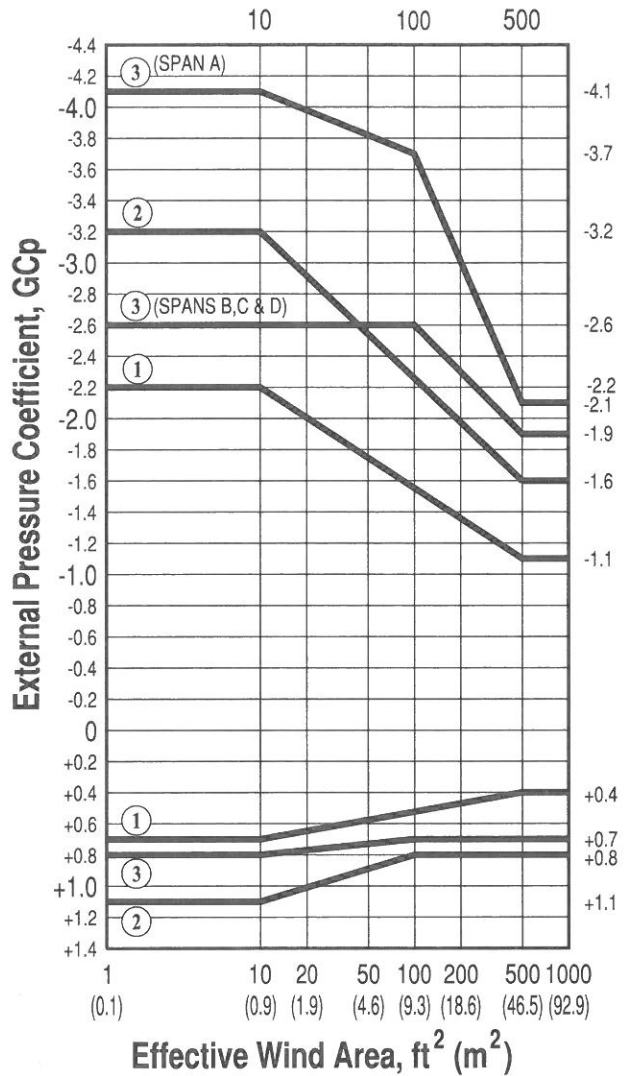

Notes:

1. Vertical scale denotes GC_p to be used with q_h .
2. Horizontal scale denotes effective wind area A , in square feet (square meters).
3. Plus and minus signs signify pressures acting toward and away from the surfaces, respectively.
4. Each component shall be designed for maximum positive and negative pressures.
5. For $\theta \leq 10^\circ$, values of GC_p from Fig. 30.4-2A shall be used.
6. Notation:
 - a : 10 percent of least horizontal dimension or $0.4h$, whichever is smaller, but not less than either 4 percent of least horizontal dimension or 3 ft (0.9 m).
 - h : Mean roof height, in feet (meters), except that eave height shall be used for $\theta \leq 10^\circ$.
 - W : Building module width, in feet (meters).
 - θ : Angle of plane of roof from horizontal, in degrees.