

FEATURES

OPTICAL SYSTEM

- Aluminum upper reflector coated with highly reflective white paint provides high efficiency and an evenly illuminated aperture appearance.
- Available with tempered prismatic lens (T73), flat Fresnel lens (FFL) or flat opal lens (FOL).
- Regressed white door (RW) or stepped black baffle (SB) are available with white painted flange provided.
- Door is retained by self-aligning, torsion support springs, preventing gaps between door and ceiling.

MECHANICAL SYSTEM

- 16-gauge galvanized steel mounting/plaster frame with integral brackets to retain optical system. Maximum 1-1/2" ceiling thickness.
- 16-gauge galvanized steel mounting bars with continuous 4" vertical adjustment are shipped pre-installed. Post installation adjustment possible without the use of tools from above or below ceiling.
- Galvanized steel junction box with hinged access covers and spring latch. Two combination 1/2"-3/4" and four 1/2" knockouts for straight-through conduit runs. Capacity: 8 (4 in, 4 out) No. 12 AWG conductors rated for 90°C.

ELECTRICAL SYSTEM

- Die-cast aluminum lampholder housing.
- Medium-base porcelain socket with nickel-plated screw shell.
- Prewired encased-and-potted, 120/277 or 120/347 ballast tray module. Module can be attached before or after mounting of mounting/plaster frame.
- Thermally-activated insulation detector.

LISTING

- Fixtures are UL Listed for thru-branch wiring, Non-IC recessed mounting and wet locations. Listed and labeled to comply with Canadian Standards.

Type Catalog number

.....

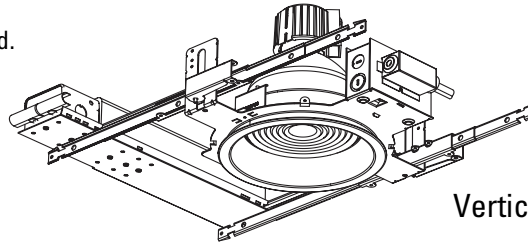

HID Downlights
8" LGH
 Round Lens
 Wet Location
 Vertical Metal Halide Lamp

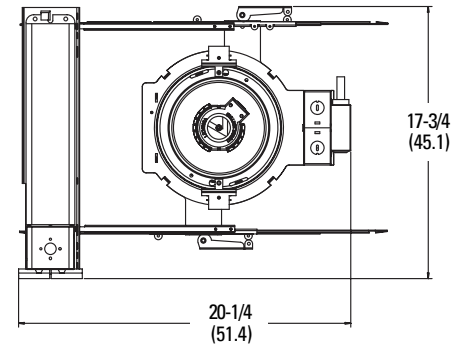

Aperture: 7-7/8 (20.1)
 Ceiling Opening: 8-7/8 (22.5)
 Overlap Trim: 9-1/4 (23.5)

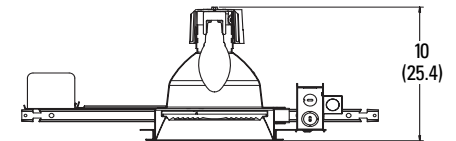

All dimensions are inches (centimeters).

ORDERING INFORMATION

Example: **LGH 150M 8RW T73 120**

Choose the boldface catalog nomenclature that best suits your needs and write it on the appropriate line. Order accessories as separate catalog numbers (shipped separately).

LGH

Series	Wattage/Lamp ¹	Door Frame	Shielding	Voltage	Options
LGH	Metal Halide	8RW Regressed white door	T73 Tempered prismatic lens	120	CP Chicago Plenum
	50M 50W ED17		FFL Flat Fresnel lens	277	TRDA Tamper-Resistant Door Assembly
	70M 70W ED17	8SB Stepped black baffle	FOL Flat opal lens	347	LRC ² Provides compatibility with Lithonia Reloc® System. Lithonia Reloc System can be installed less this option with connectors provided by others. Access above ceiling required
	100M 100W ED17				QRS ³ Quartz Restrike System.
	150M 150W ED17				QRSTD ⁴ Quartz Restrike System with time delay
	Color-Corrected Metal Halide				EC ⁵ Emergency Circuit
	50MHC 50W ED17				SF Single Fuse
	70MHC 70W ED17				WLP Lamp gasketing, ships uninstalled
	100MHC 100W ED17				
	150MHC 150W ED17				

Accessories

Order as separate catalog number.
SCA8 Sloped ceiling adapter
 Degree of slope must be specified (10D, 15D, 20D, 25D, 30D). Ex: SCA8 **10D**.

NOTES

- 1 Recommended for use with coated lamps.
- 2 For compatible Reloc systems, refer to Technical Bulletins tab.
- 3 Not available with QRSTD or EC.
- 4 Not available with QRS or EC.
- 5 Not available with QRS or QRSTD.

8" LGH Open Reflector

Distribution curve Distribution data Output data Coefficient of utilization Illuminance Data at 30" Above Floor for a Single Luminaire

LGH 100M 8RW T73, 100W ED17 lamp, 1.0 s/mh, 7900 rated lumens, Test no. LTL14368

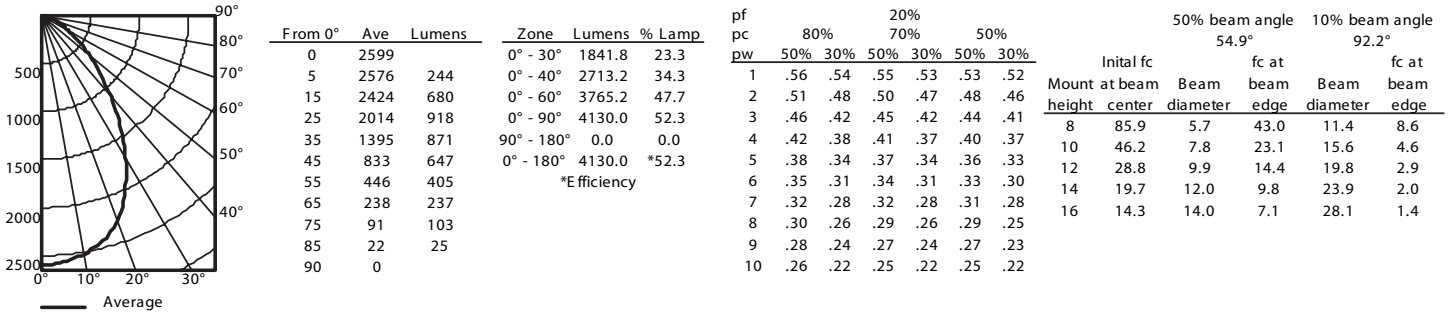

LGH 100M 8RW FFL, 100W ED17 lamp, 1.0 s/mh, 7900 rated lumens, Test no. LTL14369

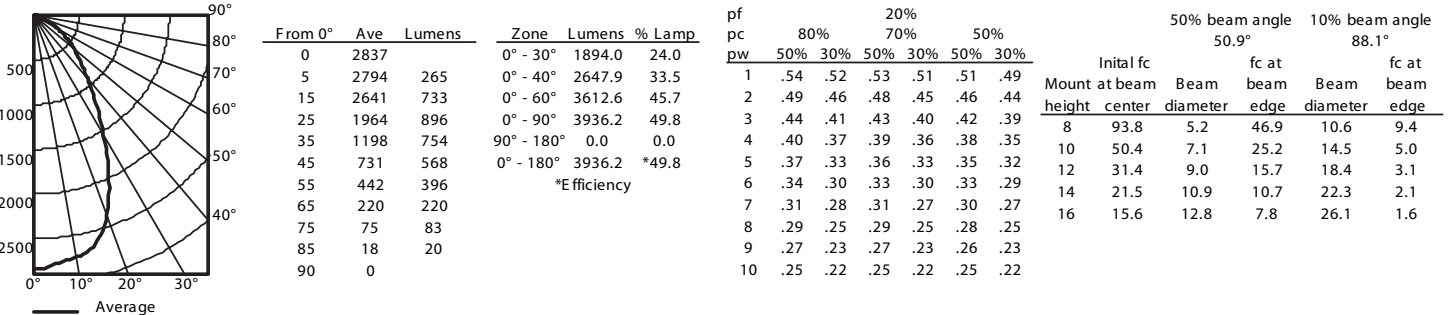

LGH 150M 8RW T73, 150W ED17 lamp, 1.1 s/mh, 12000 rated lumens, Test no. LTL14192

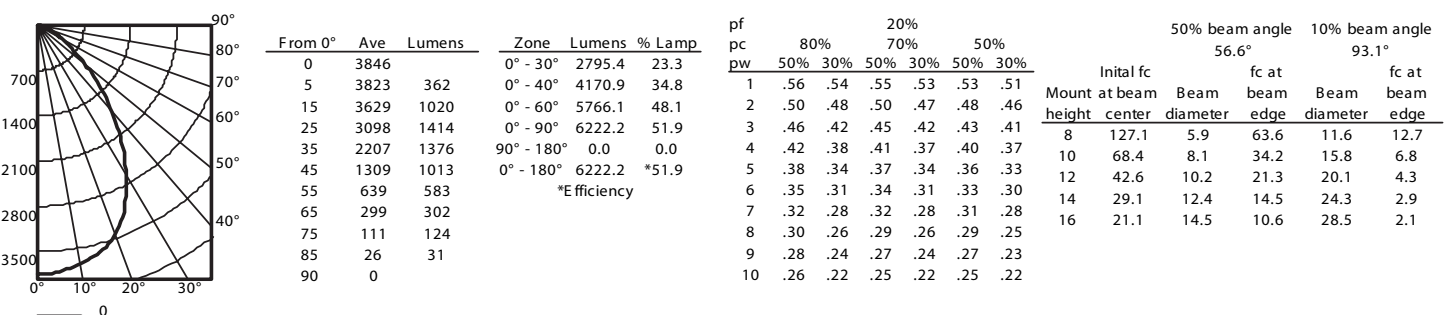

LGH 150M 8RW FFL, 150W ED17 lamp, 1.0 s/mh, 12000 rated lumens, Test no. LTL14193

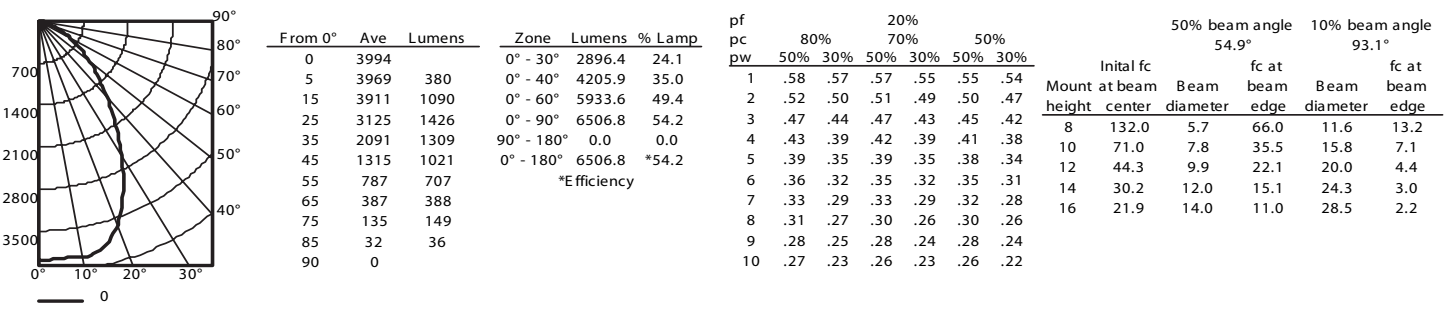

NOTES:
 1. For electrical characteristics consult Technical Bulletins tab.
 2. Tested to current IES and NEMA standards under stabilized laboratory conditions. Various operating factors can cause differences between laboratory data and actual field measurements. Dimensions and specifications are based on the most current available data and are subject to change without notice.