

Machine inserted corporation stops were developed by Hieronymus Mueller in conjunction with his development of the drilling and tapping machine used to make pressure taps in water mains. During the development of the machine inserted corporation stop, Mr. Mueller designed an inlet thread which became known as the MUELLER or “CC” thread. This thread form was eventually adopted by the American Water Works Association and is listed in ANSI/AWWA Standard C800 as the AWWA Taper thread.

MUELLER Co. pioneered other design concepts in the waterworks industry such as the copper flare connection, MUELLER 110® Compression Con-

nection and the MUELLER ORISEAL® Valves, which use O-ring seals to assure leak-tight performance.

MUELLER Co. offers corporation stops in three designs: machined key (commonly referred to as ground key), ORISEAL type (1-1/2" and 2" sizes only) and ball type.

All three designs are available with a wide range of inlet/outlet combinations including the MUELLER 110 Compression Connection and Pack Joint Connection. These three designs are all compatible with the MUELLER line of drilling and tapping machines, and small drilling machines.

MUELLER 300™ Ball Type Corporation Valves

- ❑ BLOW-OUT PROOF STEM DESIGN -prevents separation and assures dependable, safe operation.
- ❑ HEAVY BRASS COMPONENTS are constructed of 85-5-5-5 ASTM B62 brass for strength and durability.
- ❑ STRAIGHT-DESIGN allows maximum flow with minimum pressure loss.
- ❑ MANUFACTURED AND TESTED - to ANSI/AWWA C800 standard.
- ❑ DOUBLE O-RING STEM SEALS - are supported in precision machined grooves and provide secure, leak tight sealing.
- ❑ INLET THREADS - are either AWWA taper (MUELLER “CC”) or AWWA iron pipe.
- ❑ STAINLESS STEEL REINFORCED SEAT SEAL - assures reliable seal under full flow and pressure.
- ❑ END PIECE O-RING provides secondary seal to prevent leakage.
- ❑ 300 PSIG -maximum working pressure.
- ❑ EXTRA STRONG - key to ball connection provides strong, reliable performance and resists breakage.
- ❑ OUTLETS - include copper flare connection, MUELLER 110 Compression Connection, MUELLER INSTA-TITE, Pack Joint Connection and iron pipe thread connection.
- ❑ STEM ROTATION - full 360 degree.
- ❑ FLUOROCARBON COATED BALL - ensures smooth , easy turning operation.

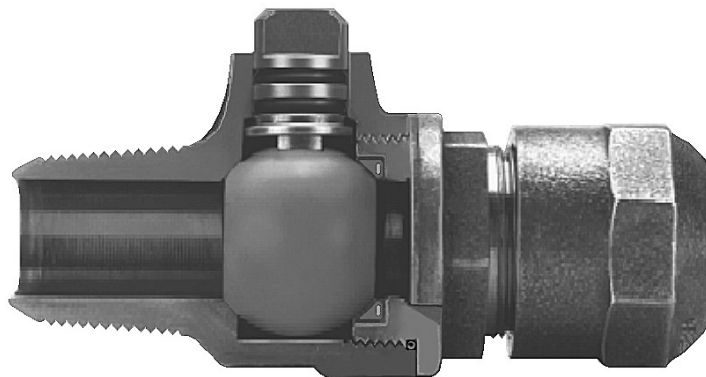

The MUELLER ORI-CORP® Corporation Valve is an easy turning, O-ring sealed, balanced pressure, plug type valve having a round, full open unobstructed flow way. These valves also feature a heavy one-piece bronze body with integral wrench flats.

The integral plug and key head construction provides maximum strength and positive operation. The large operating head provides more than adequate wrench gripping area for easy operation.

MUELLER ORI-CORP Corporation Valve

- ❑ **INTEGRAL WRENCH FLATS** on inlet and outlet of body provide generous wrench gripping area.
- ❑ **TOP SEALING O-RING** - seals valve from exterior leakage and adds to easy turning qualities.
- ❑ **LARGE OPERATING HEAD** - provides more than adequate wrench gripping area.
- ❑ **INTEGRAL ONE-PIECE PLUG AND OPERATING HEAD** provides strength and assures positive operation. Quarter turn in either direction activates valve. An integrally cast flange at the top of the plug functions as a dirt seal to protect the top O-ring.
- ❑ **INLET** - is available with either AWWA taper (MUELLER "CC") thread or AWWA iron pipe thread.
- ❑ **STRONG, ONE PIECE BODY** - has no cavities that could allow debris to collect and cause damage to the plug.
- ❑ **FULL FLOW** - round way plug opening provides straight through passage with no obstruction.
- ❑ **BRONZE RETAINING RING** secures plug in body and also functions as a dirt seal to protect bottom O-ring. Since this valve is a balanced pressure type, there is no force tending to eject the plug or load the retaining mechanism.
- ❑ **BOTTOM SEALING O-RING** - seals valve from leakage and adds to easy turning qualities.
- ❑ **OUTLET PORT SEALING O-RING** is totally confined in a machined groove to provide positive leak-tight shutoff.
- ❑ **INTEGRAL OUTLET** is available with either MUELLER 110® Conductive Compression Connection, outside iron pipe thread or inside iron pipe thread.
- ❑ **175 PSIG** - maximum working pressure.



MUELLER CO. has been manufacturing ground key corporation stops since 1870 and many features of the modern day stops were developed by MUELLER CO.

These features include a brass alloy, and inlet thread and outlet connections that were eventually adopted as American Water Works Association Standards.

MUELLER® Ground Key Design Corporation Valves

- ❑ BODY - is cast from 85-5-5-5 ASTM B62 brass alloy for strength and corrosion resistance.
- ❑ INTEGRAL OUTLET available with a wide variety of outlet end connections including the MUELLER 110® Compression Connection, MUELLER Pack Joint Connection, MUELLER INSTA-TITE® Connection, copper flare, inside iron pipe, outside iron pipe, increasing iron pipe, MUELLER Coupling Thread and other popular connections.
- ❑ STRAIGHT THROUGH DESIGN - allows maximum flow with minimum pressure loss.
- ❑ KEY AND BODY - are precision machined to assure sealing surfaces match.
- ❑ INLET THREADS are either AWWA taper thread (MUELLER "CC") or AWWA iron pipe thread.
- ❑ MANUFACTURED AND TESTED - to ANSI/AWWA C800 Standard.
- ❑ 100 PSIG - maximum working pressure for 1/2," 3/4" and 1" sizes. 80 PSIG - maximum working pressure for 1-1/4", 1-1/2" and 2" sizes.
- ❑ "D" SHAPED WASHER - turns with key to prevent loosening of key nut.
- ❑ KEY NUT - is designed so overtightening will strip stem threads instead of breaking stem.

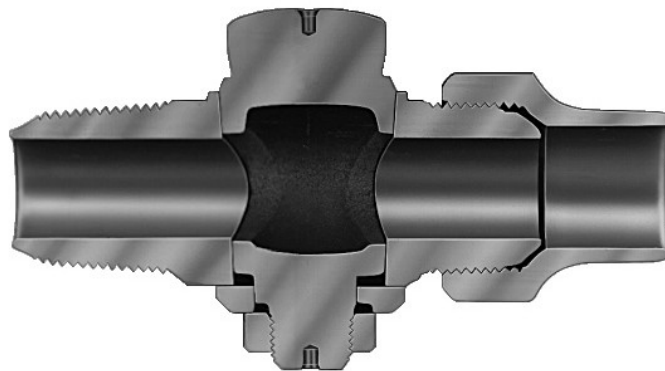

Corporation valve inlet threads

- ❑ AWWA taper (MUELLER "CC") thread.
- ❑ AWWA iron pipe thread.



MUELLER Screw plug thread

- ❑ Increasing I.P. thread is one size larger than inlet.
- ❑ Screw plug thread is same nominal size as inlet.



5.4



Rev. 9-09 Shaded area indicates changes

3/4" - 2" MUELLER® 300™ BALL CORPORATION VALVES

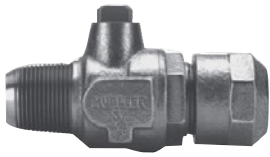

B-25008

MUELLER® 300™ Ball Corporation Valve
Inlet: AWWA taper (MUELLER "CC") thread
Outlet: MUELLER® 110® Conductive Compression Connection for CTS O.D.* tubing

3/4"	3/4" x 1"	1"	1-1/2"	1-1/2" x 2"	2"
------	-----------	----	--------	-------------	----



B-25028

MUELLER® 300™ Ball Corporation Valve
Inlet: AWWA I.P. thread
Outlet: MUELLER® 110® Conductive Compression Connection for CTS O.D. tubing

3/4"	3/4" x 1"	1"	1-1/2"	1-1/2" x 2"	2"
------	-----------	----	--------	-------------	----

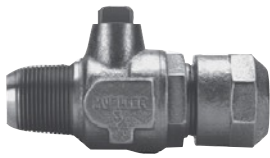

B-25009

MUELLER 300 Ball Corporation Valve
Inlet: AWWA taper (MUELLER "CC") thread
Outlet: MUELLER® 110® Compression Connection for IPS PE* pipe

3/4"	3/4" x 1"	1"
------	-----------	----



B-25029

MUELLER 300 Ball Corporation Valve
Inlet: AWWA I.P. thread
Outlet: MUELLER 110® Compression Connection for IPS PE* pipe

3/4"	3/4" x 1"	1"
------	-----------	----



E-25009

MUELLER 300 Ball Corporation Valve
Inlet: AWWA taper (MUELLER "CC") thread
Outlet: MUELLER Pack Joint for IPS PE* pipe
 **Note: 3/4" size only may also be used on PVC

3/4"***	1"	1-1/2"	2"
---------	----	--------	----

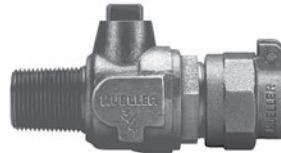

E-25029

MUELLER 300 Ball Corporation Valve
Inlet: AWWA I.P. thread
Outlet: MUELLER Pack Joint for IPS PE* pipe
 **Note: 3/4" size only may also be used on PVC

3/4"***	1"	1-1/2"	2"
---------	----	--------	----



V-25056

MUELLER 300 Ball Corporation Valve
Inlet: AWWA taper (MUELLER "CC") thread
Outlet: MUELLER Pack Joint for IPS PVC* pipe

1"	1-1/2"	2"
----	--------	----

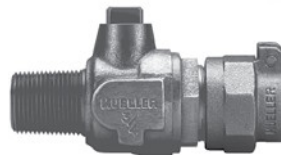

V-25058

MUELLER 300 Ball Corporation Valve
Inlet: AWWA I.P. thread
Outlet: MUELLER Pack Joint for IPS PVC* pipe

1"	1-1/2"	2"
----	--------	----



P-25008

MUELLER 300 Ball Corporation Valve
Inlet: AWWA taper (MUELLER "CC") thread
Outlet: MUELLER Pack Joint Connection for CTS O.D.* tubing

3/4"	3/4"x1"	1"	1-1/2"	1-1/2"x2"	2"
------	---------	----	--------	-----------	----

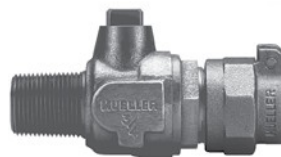

P-25028

MUELLER 300 Ball Corporation Valve
Inlet: AWWA I.P. thread
Outlet: MUELLER Pack Joint Connection for CTS O.D.* tubing

3/4"	3/4" x 1"	1"	1-1/2"	1-1/2" x 2"‡	2"
------	-----------	----	--------	--------------	----

*See charts on pages 5.12-5.16 for tubing and pipe that may be used with these connections.

NOTE: Sizes shown above represent nominal size of inlet and outlet connections. When two sizes are given, the first is size of inlet and the second is size of outlet.

‡ Requires minimum ordering quantity. Contact MUELLER Customer Service Center for minimum order requirements and availability.

MUELLER Corporation Valves are manufactured and tested in accordance with ANSI/AWWA C800.

3/4" - 2" MUELLER® 300™ BALL CORPORATION VALVES



B-25006

MUELLER® 300™ Ball Corporation Valve
AWWA taper (MUELLER “CC”) thread
MUELLER® INSTA-TITE® Connection for CTS PE* pipe

3/4"	1"
------	----



B-25024

MUELLER® 300™ Ball Corporation Valve
AWWA I.P. thread
MUELLER® INSTA-TITE® Connection for CTS PE* pipe

3/4"	1"
------	----



B-25005

MUELLER 300 Ball Corporation Valve
AWWA taper (MUELLER “CC”) thread
MUELLER® INSTA-TITE® Connection for IPS PE* pipe

3/4"	1"
------	----



B-25026

Corporation Valve
AWWA I.P. thread
MUELLER® INSTA-TITE® Connection for IPS PE* pipe

3/4"	1"
------	----



B-25000

MUELLER 300 Ball Corporation Valve
Inlet: AWWA taper (MUELLER “CC”) thread
Outlet: Copper flare straight connection

3/4"	3/4" x 1"	1"	1-1/2"	2"
------	-----------	----	--------	----



B-25025

MUELLER 300 Ball Corporation Valve
Inlet: AWWA I.P. thread
Outlet: Copper flare straight connection

3/4"	3/4" x 1"	1"	1-1/2"	2"
------	-----------	----	--------	----



B-25020

MUELLER 300 Ball Corporation Valve
Inlet: AWWA taper (MUELLER “CC”) thread
Outlet: Copper flare x 90 Bend CS

3/4"	1"	1-1/2"	2"
------	----	--------	----



B-25010

MUELLER 300 Ball Corporation Valve
Inlet: AWWA taper (MUELLER “CC”) thread
Outlet: Copper flare x 45 Bend

1-1/2"	2"
--------	----

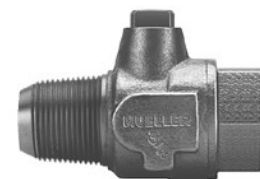

B-20045

MUELLER 300 Ball Corporation Valve
Inlet: AWWA taper (MUELLER “CC”) thread
Outlet: F.I.P. thread

3/4"	3/4"x1"	1"	1-1/2"	2"
------	---------	----	--------	----



B-20046

MUELLER 300 Ball Corporation Valve
Inlet: AWWA I.P. thread
Outlet: F.I.P. thread

3/4"	3/4"x1"	1"	1-1/2"	2"
------	---------	----	--------	----

*See charts on pages 5.12-5.16 for tubing and pipe that may be used with these connections.

NOTE: Sizes shown above represent nominal size of inlet and outlet connections. When two sizes are given, the first is size of inlet and the second is size of outlet.

For identification purposes MUELLER INSTA-TITE Connections for CTS O.D. PE tubing have red gripper rings, and the connections for IPS PE pipe have white gripper rings.

MUELLER® Corporation Valves are manufactured and tested in accordance with ANSI/AWWA C800.

5.6



Rev. 9-09 Shaded area indicates changes

3/4" - 2" MUELLER® 300™ BALL CORPORATION VALVES



B-2996

MUELLER 300 Ball Corporation Valve
Inlet: AWWA taper (MUELLER "CC") thread
Outlet: M.I.P. thread

3/4"	1"	1-1/2"	2"
------	----	--------	----



B-20013

MUELLER 300 Ball Corporation Valve
Inlet: AWWA I.P. thread
Outlet: M.I.P. thread (Full size diameter inlet to outlet)

3/4"	1"	1-1/2"	2"
------	----	--------	----



B-20003

MUELLER 300 Ball Corporation Valve
Inlet: AWWA taper (MUELLER "CC") thread
Outlet: Increasing M.I.P. thread

3/4"	1"	1-1/2"	2"
------	----	--------	----



B-2969

MUELLER 300 Ball Corporation Valve
Inlet: AWWA I.P. thread
Outlet: M.I.P. thread (Full size diameter inlet to outlet).

1-1/2"	2"
--------	----

OPTIONAL T-HEAD:

All ball corporation valves are available with a 360° turn T-head cap by adding "-10" to catalog number: Example: B-25008-10
 For a 3/4" or 1" detachable T-head caps for corporation valves add "-00" to catalog number. Example: B-25008-00

RECLAIMED WATER STYLE:

All ball corporation valves are available marked for "reclaimed water" by adding "-20" to the catalog number. Example: B-25008-20.

NOTE: Sizes shown above represent nominal size of inlet and outlet connections. When two sizes are given, the first is size of inlet and the second is size of outlet.