

FILE NAME: J:\Projects\2025\112813\112813.dwg
 DATE: 04/16/2025 11:28:13 AM
 USER: brian.mistich
 PLOT DATE: 04/16/2025 11:28:13 AM
 PLOT SCALE: 1/8"=1'-0"
 PLOT SHEET: 1 OF 2

PLANNING	PARKING REQUIREMENTS
ZONING - C-3 CENTRAL BUSINESS DISTRICT	EXISTING BUILDING = 2190 SQ. FT.
	FLOOR SPACE 89 SQ. FT.
	4.220 AUTOMOBILE REPAIR SHOP
	1 SPACE PER 200 SQUARE FOOT OF FLOOR SPACE.
	EXISTING FOUR PARKING SPACES + ONE NEW HANDICAP PARKING SPACE
	TOTAL OF 5 PARKING SPACES PROVIDED

DAMMON

ENGINEERING, INC.

LOUISIANA & MISSISSIPPI

Chief Engineer: Brian Mistich, PE
 www.dammonengineering.com
 554 Old Spanish Trail
 Slidell, LA 70468
 info@dammonengineering.com
 PH: 985.649.9832

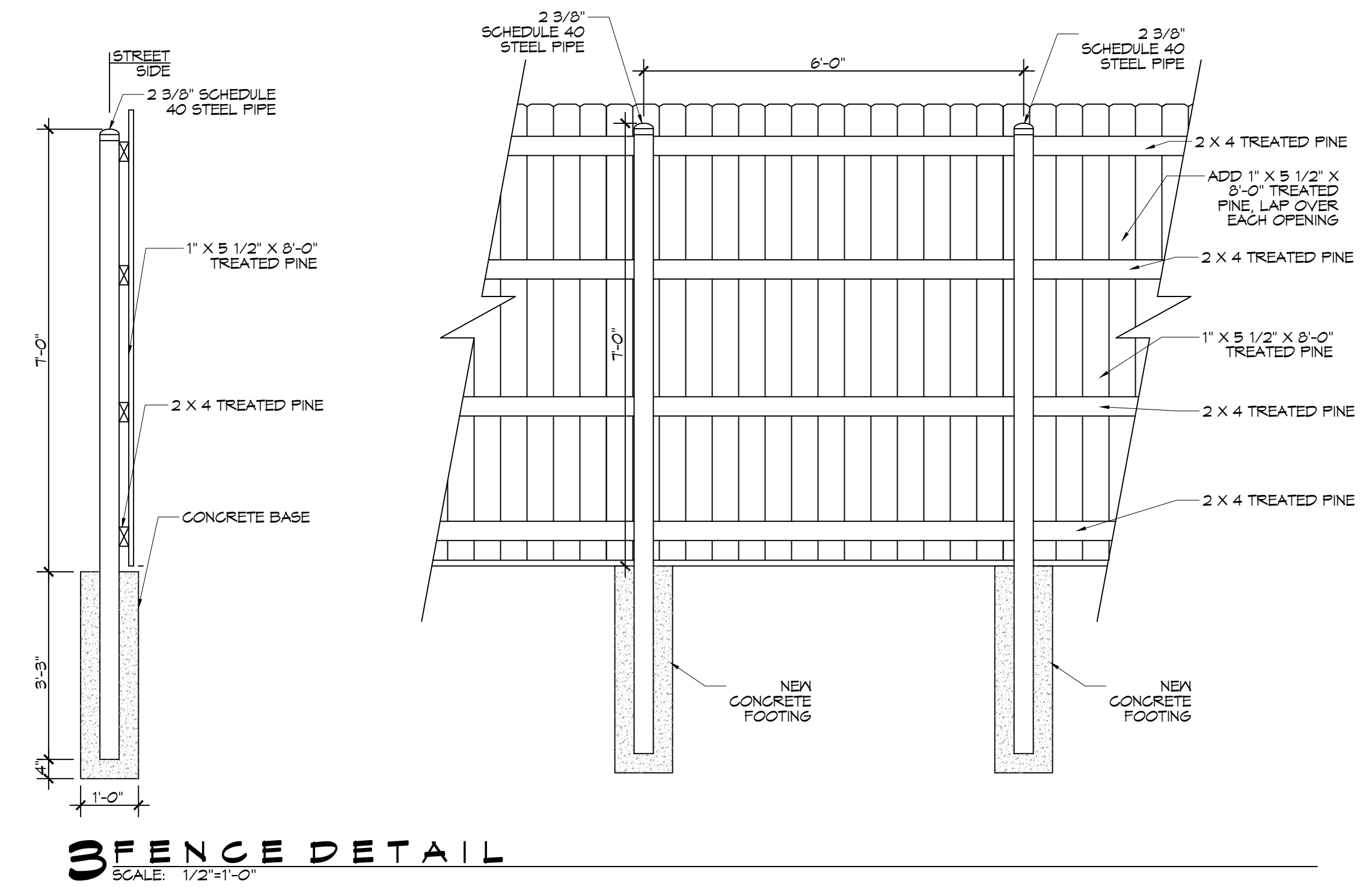
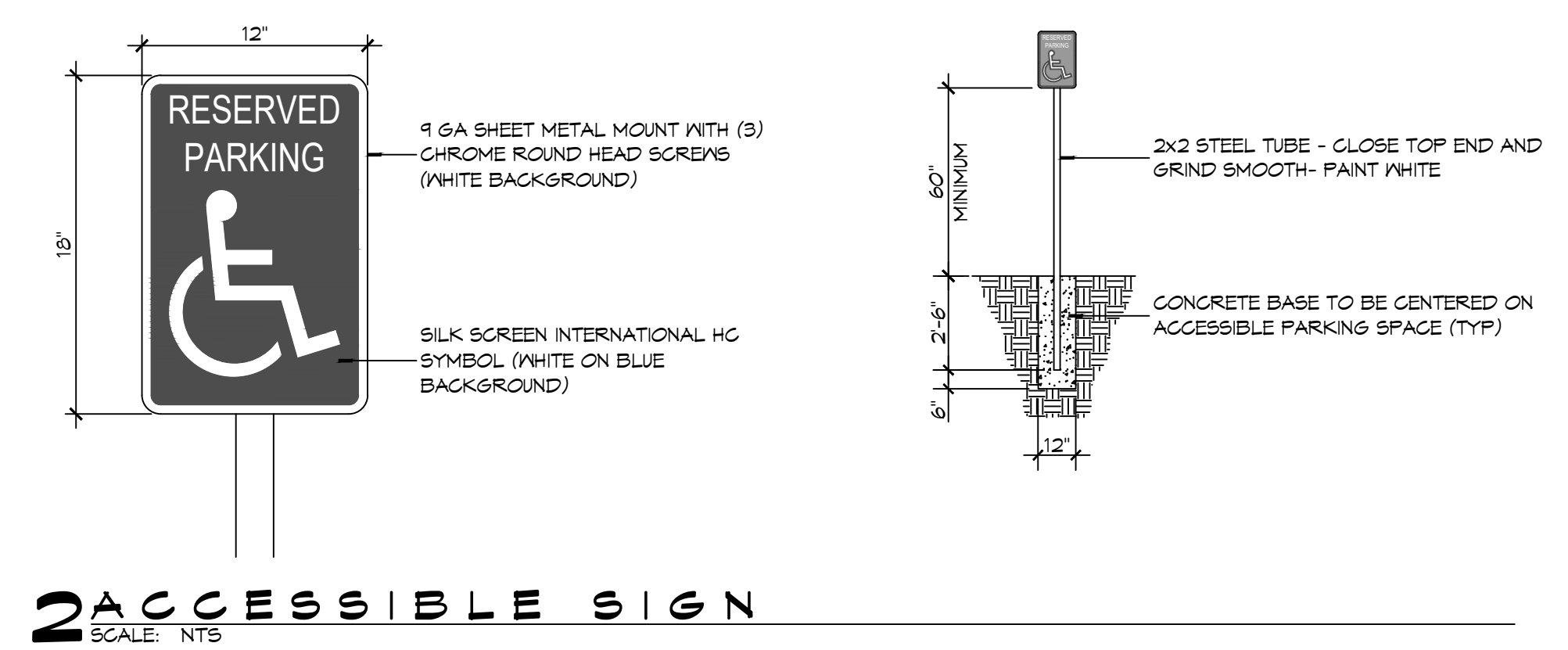
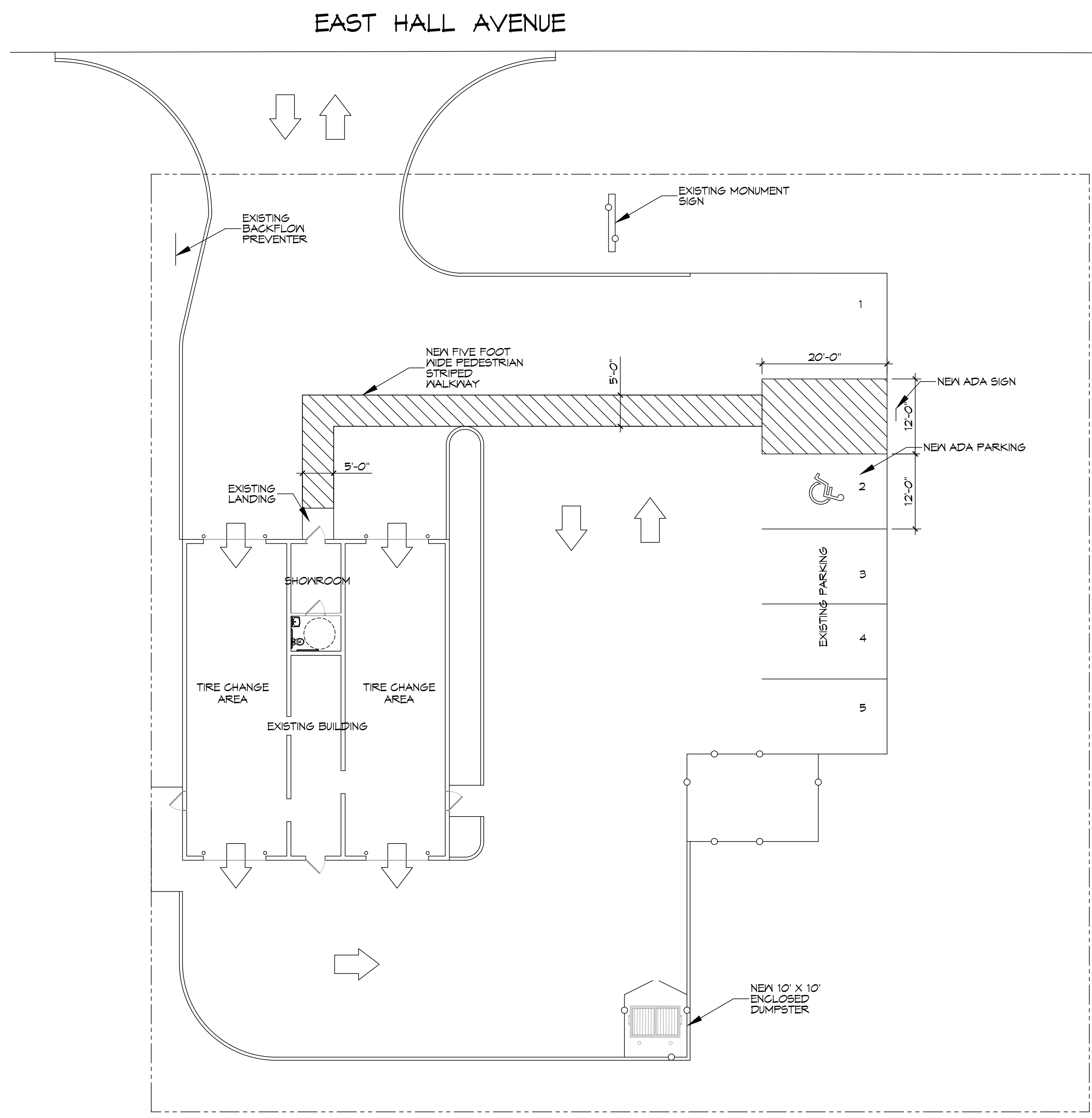

#	DESCRIPTION	DATE

SEAL:

TIRE REPAIR SHOP

SLIDELL TIRE SERVICE

155 EAST HALL AVENUE
 SLIDELL, LA 70468
 JOB No: _____
 DATE: 04-16-2025
 DRAWN BY: BMM
 CHECKED BY: CKD

SHEET TITLE:
EXISTING SITE PLAN

DRAWING NUMBER:
C101

SHEET No: 1 of 2

