

Congratulations on designing your shed! Our goal is to exceed your expectations of our service and product. If you have immediate questions or concerns, please call us at 601-303-3212 or 601-222-1197.



**Danco Buildings**  
 1259 Hwy 583 N  
 Jayess, MS 39641  
 601-303-3212 or 601-222-1197  
 chrisdaniels@dancobuildings.com

Customer Order - **Nov 11, 2024**

Ship To		
Customer Name _____	Order # <u>1731364870394805</u>	
Installation Address _____		
City _____	State <u>MS</u>	ZIP Code _____
Email _____	Phone _____	Mobile _____

Building Info	Size	Color
Style: Garden Shed Premium	<b>16x50</b> 93 1/2" Sidewall Height	Roof Charcoal <input checked="" type="checkbox"/>
Roof Overhang: Upgrade 6" Gable Ends		Trim Black <input checked="" type="checkbox"/>
Roof Material: Architectural Shingles		Siding Taupe <input checked="" type="checkbox"/>
Siding Premium Metal (Vertical)		

**Design Link & Notes**

Design Link <https://idearoom.dancobuildings.com/?lng=en-US#80d55b35d22ad46b4c49448e0984bcb1>

How did you hear about us?

Notes, Comments, Questions

**Images**

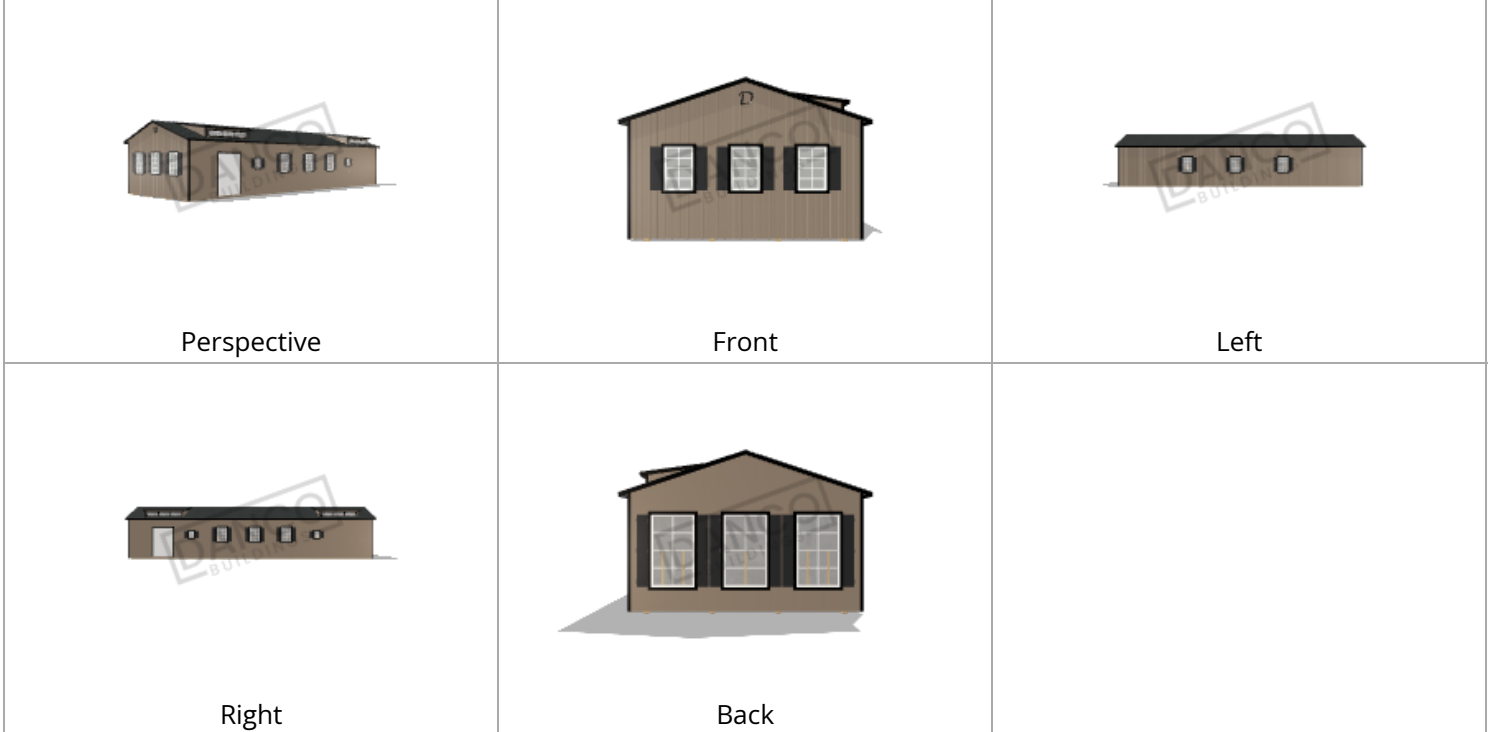

The information below is an estimate only. Final pricing - including pricing adjustments, discounts, delivery, and taxes - will be provided with final quote prior to purchase.

SKU	Description	Quantity	Amount
	<b>Structure Details</b>		
GSX	Style: Garden Shed Premium	1	\$21,921.74
	Size: 16x50	1	Included
	Roof Overhang: Upgrade 6" Gable Ends	1	\$400.00
	8' Shed Dormer	2	\$2,600.00
	Siding: Premium Metal (Vertical)	1	\$3,288.26
	Siding Color: Taupe		Included
	Trim Color: Black		Included
	Roof Color: Charcoal		Included
	Roof Material: Architectural Shingles	1	\$1,096.09
	<b>Doors &amp; Ramps</b>		
	48" Metal Walk-In Door	1	Included
	<b>Windows &amp; Accessories</b>		
	24"x36" Window	1	Included
	Shutters: 3 Board Shutter	14	\$1,400.00
	Shutters Color: Tricorn Black		Included
	24"x36" Window	8	\$760.00
	36"x60" Double Pane Window	3	\$945.00
	12"x18" Loft Window	2	\$150.00
	<b>Flooring &amp; Interior</b>		
	Flooring: 3/4" Plywood	1	\$800.00
	Floor Joist: 12" OC 2x6	1	\$600.00
	<b>Additional Options</b>		
	20 Drop Electrical Package (200 Amp Box)	1	\$2,150.00
	Radiant Barrier OSB	1	\$800.00
	Tyvek House Wrap	1	\$300.00
	Roof Underlayment	1	\$320.00
	Build On Site - \$500 fee paid directly to builder at time of build	1	Included
	Interior Walls	16	\$384.00
		Subtotal:	\$37,915.09
		Sales Tax:	-
		Total Order Amount:	\$37,915.09
		Final Balance Due at Installation:	\$37,915.09

#### Additional Information

\*Hurricane clips are included on all sheds.

#### Signatures

Customer Signature:

Date



# FLOORPLAN



Left

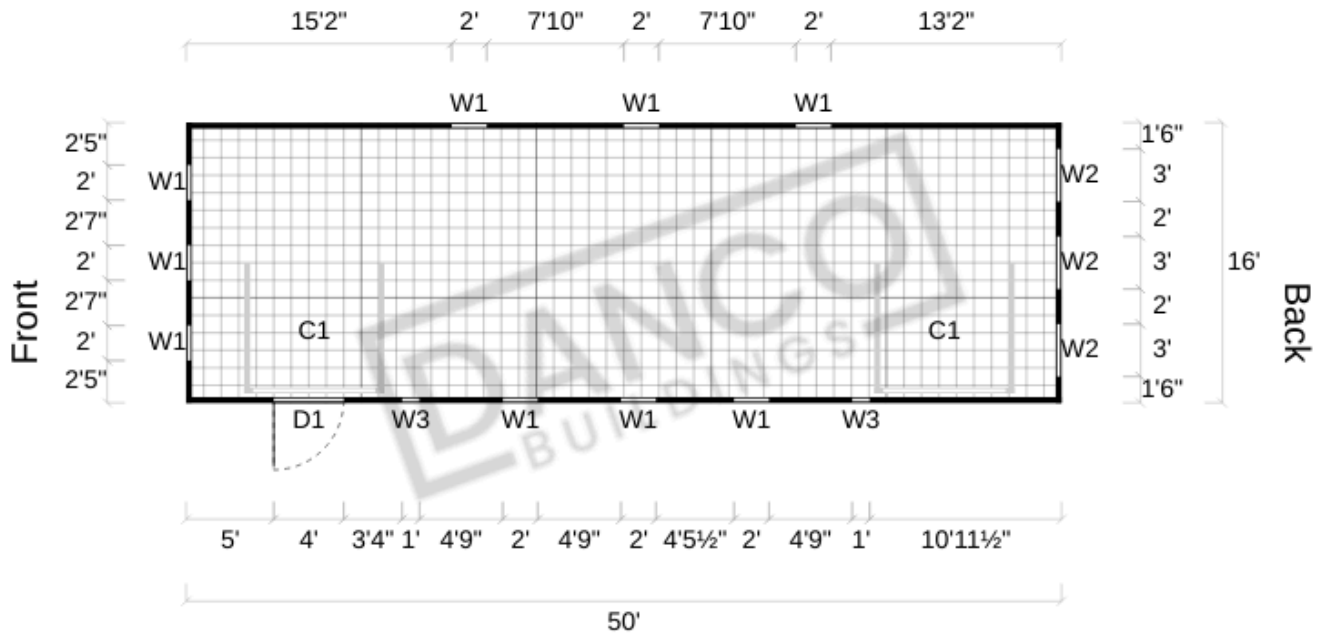

Right

## SYMBOL LEGEND

W1	24"x36" Window	W2	36"x60" Double Pane Window
D1	48" Metal Walk-In Door	W3	12"x18" Loft Window
C1	8' Shed Dormer		Closed Wall