

**CROSS-SECTION  
NOT TO SCALE**

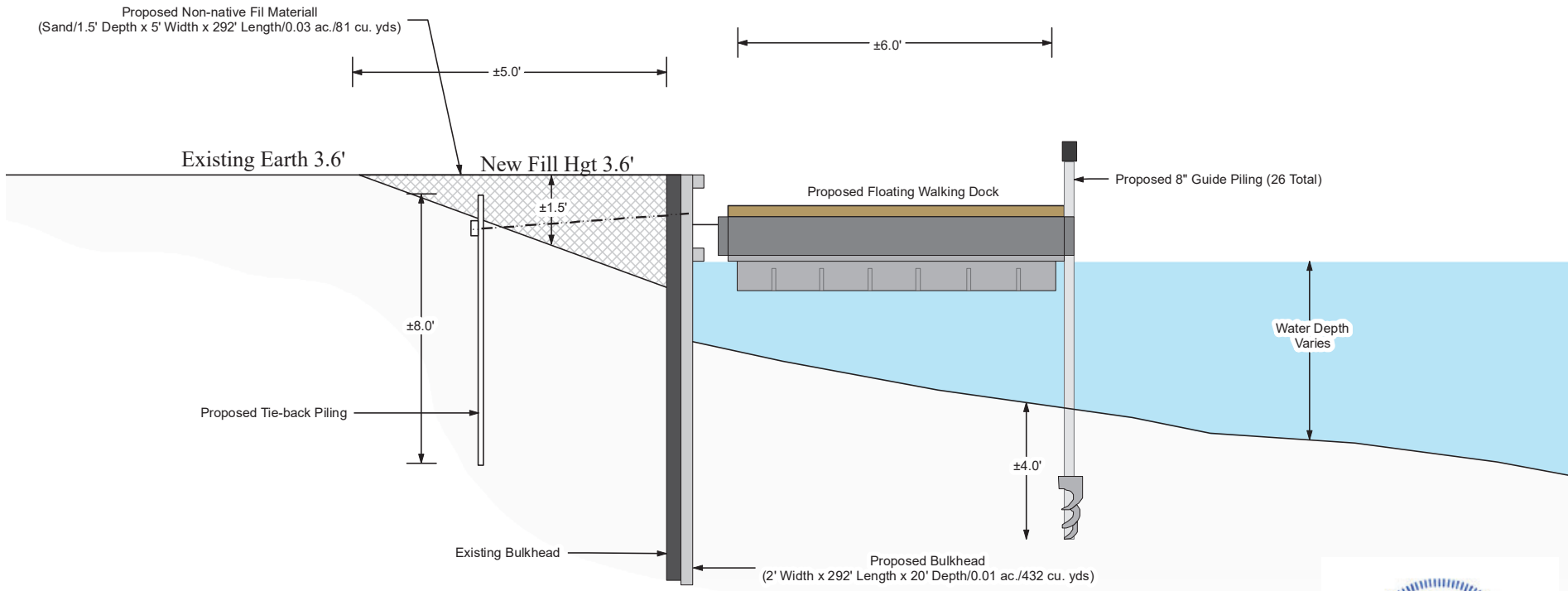

NOTE: EXISTING BULKHEAD IS DAMAGED AND DETERIORATING. CONTRACTOR PLANS TO LEAVE THE EXISTING BULKHEAD IN PLACE AND INSTALL PROPOSED BULKHEAD ADJACENT TO EXISTING BULKHEAD TO SHORE UP THE BANKLINE.

NOTE: NO ON-THE-GROUND EFFORT HAS BEEN MADE FOR THE PROJECT TO LOCATE AND INDICATE ALL CABLES, PIPELINES, ETC. CROSSED BY THE PROPOSED PROJECT. THEREFORE, MORRIS P. HEBERT, INC. IS NOT RESPONSIBLE FOR ANY LOCATED DURING THE COURSE OF THE PROJECT.

NOTE: THIS DRAWING WAS PREPARED FOR PERMITTING PURPOSES ONLY, AND IS NOT A PROPERTY BOUNDARY SURVEY AND AS SUCH DOES NOT COMPLY WITH THE "MINIMUM STANDARDS FOR PROPERTY BOUNDARY SURVEYS" AS ADOPTED BY THE LOUISIANA PROFESSIONAL ENGINEERING AND LAND SURVEYING BOARD.



F:\L DRIVE BACKUP\DRIVE15210 Foggy Waters Marina\Maps\15210 CROSS SECTION1.mxd



SURVEYING • ENGINEERING • ENVIRONMENTAL SERVICES • FIELD SERVICES • GIS  
116 VENTURE BLVD P.O. BOX 3106 HOUMA, LOUISIANA 70360 (985) 879-2731  
10101 SOUTHWEST FREEWAY • SUITE 620 • HOUSTON, TEXAS 77071 • (713) 219-1470

**FOGGY WATERS MARINA**

PROPOSED FOGGY WATERS MARINA RENOVATIONS  
ST. TAMMANY PARISH, LOUISIANA, CROSS-SECTION MAP

DRAWN BY: JLC	SHEET: 5
CHECKED BY: MC	SCALE: N.T.S.
APPROVED BY:	DATE: 2/27/2024
REVISION BY:	JOB NO.: 15210-00
MAP FILE: 15210_CROSS_SECTION1.MXD	