

F:\I: DRIVE BACKUP\DRIVE15210 Foggy Waters Marina\Maps\15210_VICINITY1.mxd

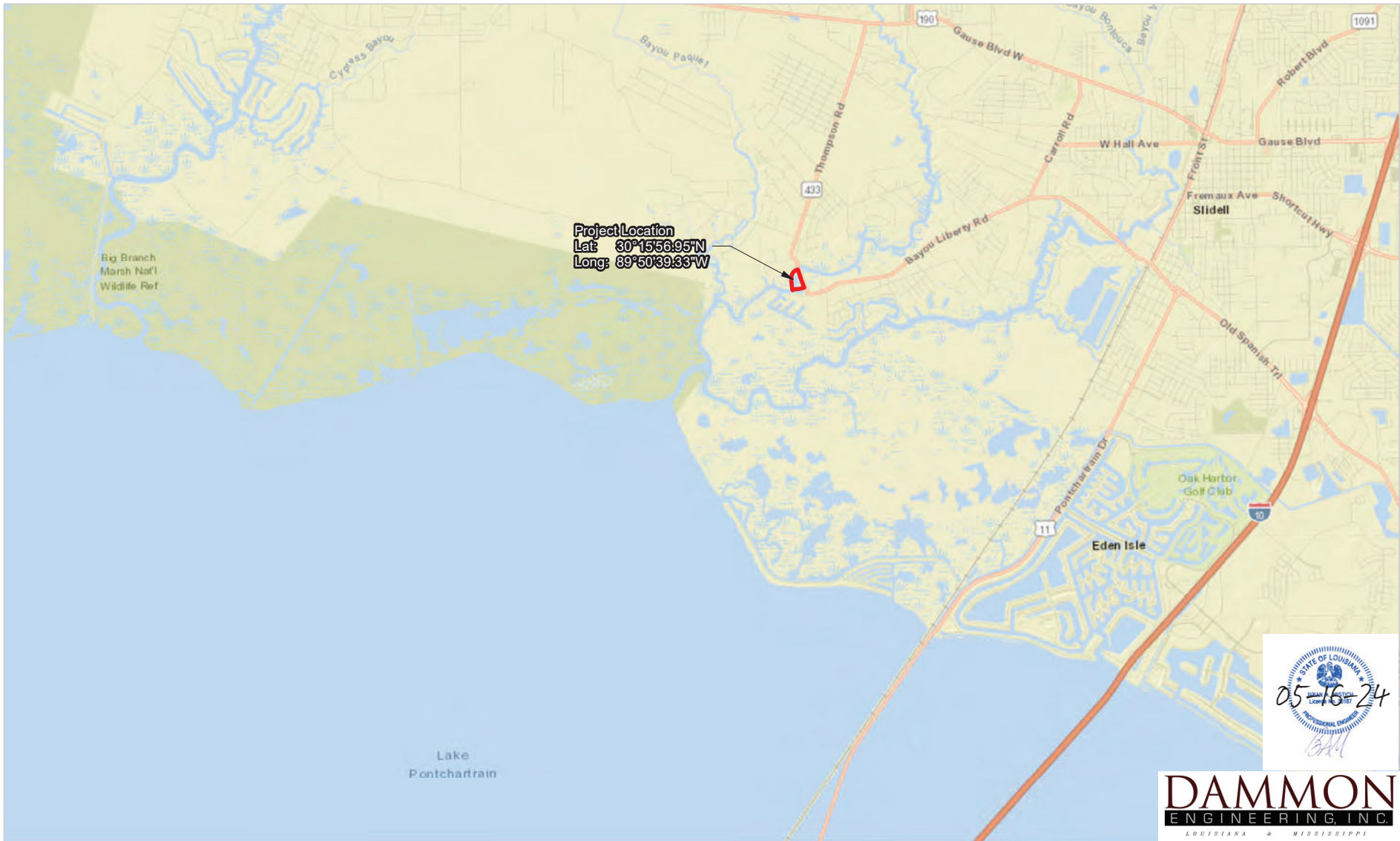

Project Location
 Lat: 30°15'56.95"N
 Long: 89°50'39.33"W

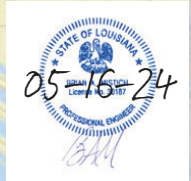

NOTE: NO ON-THE-GROUND EFFORT HAS BEEN MADE FOR THE PROJECT TO LOCATE AND INDICATE ALL CABLES, PIPELINES, ETC. CROSSED BY THE PROPOSED PROJECT. THEREFORE, MORRIS P. HEBERT, INC. IS NOT RESPONSIBLE FOR ANY LOCATED DURING THE COURSE OF THE PROJECT.

NOTE: THIS DRAWING WAS PREPARED FOR PERMITTING PURPOSES ONLY, AND IS NOT A PROPERTY BOUNDARY SURVEY AND AS SUCH DOES NOT COMPLY WITH THE "MINIMUM STANDARDS FOR PROPERTY BOUNDARY SURVEYS" AS ADOPTED BY THE LOUISIANA PROFESSIONAL ENGINEERING AND LAND SURVEYING BOARD.



Commercial Plans
 RECEIVED
 5/20/2024
 DEPARTMENT OF
 ENGINEERING
 ENGINEERING
 REVIEW COPY

Morris P. Hebert, Inc.
client focused solutions

SURVEYING • ENGINEERING • ENVIRONMENTAL SERVICES • FIELD SERVICES • GIS
 116 VENTURE BLVD P.O. BOX 3106 HOUMA, LOUISIANA 70360 (985) 879-2731
 10101 SOUTHWEST FREEWAY • SUITE 620 • HOUSTON, TEXAS 77071 • (713) 219-1470

FOGGY WATERS MARINA
PROPOSED FOGGY WATERS MARINA RENOVATIONS ST. TAMMANY PARISH, LOUISIANA, VICINITY MAP

DRAWN BY: JLC	SHEET: 1
CHECKED BY: MC	SCALE: 1 in = 1 miles
APPROVED BY:	DATE: 2/16/2024
REVISION BY:	JOB NO.: 15210-00
MAP FILE: 15210_VICINITY1.MXD	



Legend

- Existing Bankline
- Existing Bulkhead
- Existing Bulkhead
- Proposed Walking Dock
- Proposed Bulkhead
- Proposed Non-native Fill Material

NOTE: NO ON-THE-GROUND EFFORT HAS BEEN MADE FOR THE PROJECT TO LOCATE AND INDICATE ALL CABLES, PIPELINES, ETC. CROSSED BY THE PROPOSED PROJECT. THEREFORE, MORRIS P. HEBERT, INC. IS NOT RESPONSIBLE FOR ANY LOCATED DURING THE COURSE OF THE PROJECT.

NOTE: THIS DRAWING WAS PREPARED FOR PERMITTING PURPOSES ONLY, AND IS NOT A PROPERTY BOUNDARY SURVEY AND AS SUCH DOES NOT COMPLY WITH THE "MINIMUM STANDARDS FOR PROPERTY BOUNDARY SURVEYS" AS ADOPTED BY THE LOUISIANA PROFESSIONAL ENGINEERING AND LAND SURVEYING BOARD.



DAMMON
ENGINEERING, INC.
LOUISIANA & MISSISSIPPI

mph
Morris P. Hebert, Inc.
client focused solutions

SURVEYING • ENGINEERING • ENVIRONMENTAL SERVICES • FIELD SERVICES • GIS
116 VENTURE BLVD P.O. BOX 3106 HOUMA, LOUISIANA 70360 (985) 879-2731
10101 SOUTHWEST FREEWAY • SUITE 620 • HOUSTON, TEXAS 77071 • (713) 219-1470

FOGGY WATERS MARINA

PROPOSED FOGGY WATERS MARINA RENOVATIONS
ST. TAMMANY PARISH, LOUISIANA, OVERVIEW MAP

DRAWN BY: JLC	SHEET: 2
CHECKED BY: MC	SCALE: 1 in = 100 ft
APPROVED BY:	DATE: 2/26/2024
REVISION BY:	JOB NO.: 15210-00
MAP FILE: 15210_OVERVIEW1.MXD	

F:\I. DRIVE BACKUP\DRIVE15210 Foggy Waters Marina\Maps\15210_PLAN_VIEW2.mxd

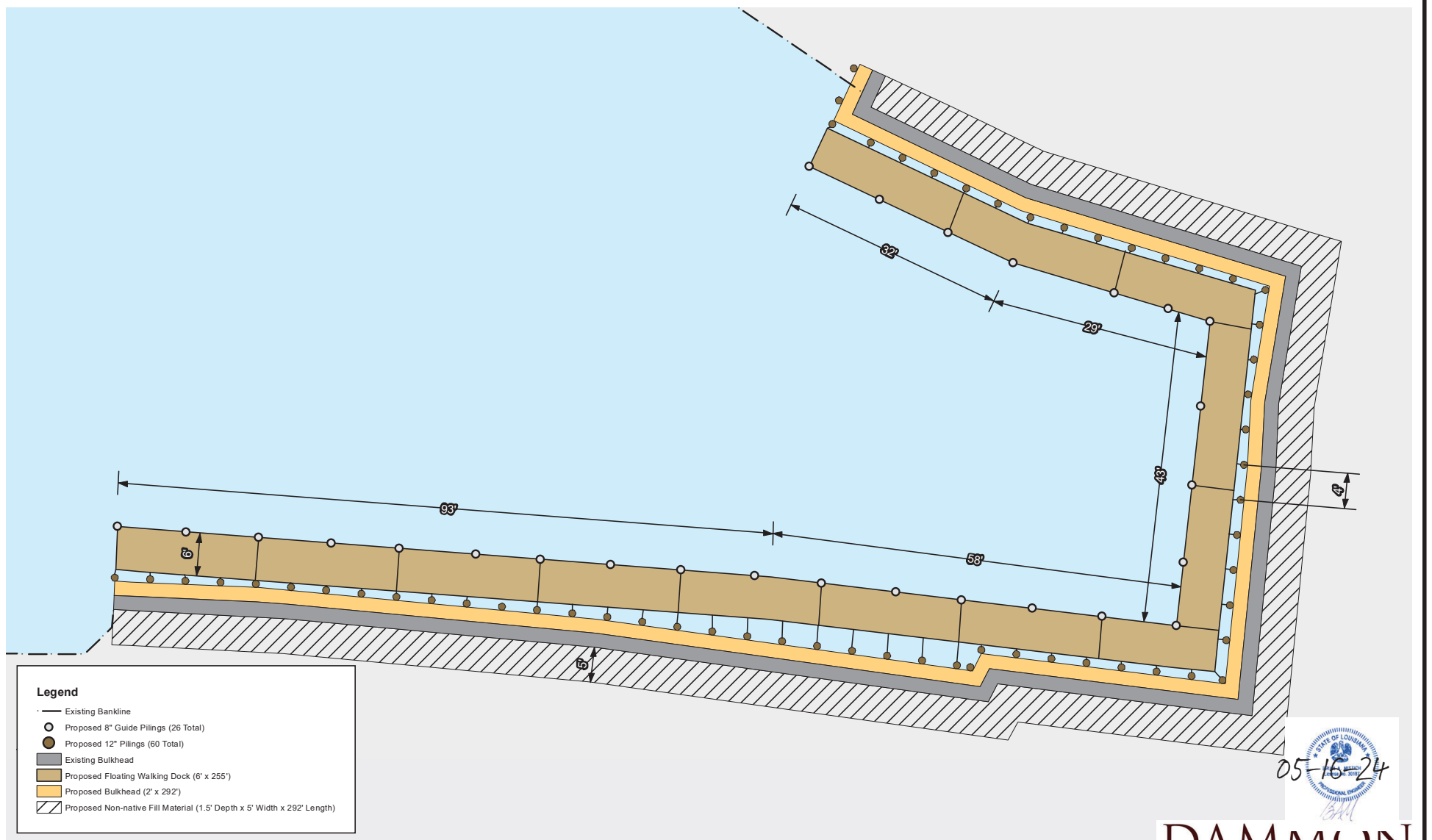

- Legend**
- Existing Bankline
 - Proposed 8" Guide Pilings (26 Total)
 - Proposed 12" Pilings (60 Total)
 - Existing Bulkhead
 - Proposed Floating Walking Dock (6' x 255')
 - Proposed Bulkhead (2' x 292')
 - Proposed Non-native Fill Material (1.5' Depth x 5' Width x 292' Length)

05-15-24

DAMMON
 ENGINEERING, INC.
 LOUISIANA & MISSISSIPPI

NOTE: NO ON-THE-GROUND EFFORT HAS BEEN MADE FOR THE PROJECT TO LOCATE AND INDICATE ALL CABLES, PIPELINES, ETC. CROSSED BY THE PROPOSED PROJECT. THEREFORE, MORRIS P. HEBERT, INC. IS NOT RESPONSIBLE FOR ANY LOCATED DURING THE COURSE OF THE PROJECT.

NOTE: THIS DRAWING WAS PREPARED FOR PERMITTING PURPOSES ONLY, AND IS NOT A PROPERTY BOUNDARY SURVEY AND AS SUCH DOES NOT COMPLY WITH THE "MINIMUM STANDARDS FOR PROPERTY BOUNDARY SURVEYS" AS ADOPTED BY THE LOUISIANA PROFESSIONAL ENGINEERING AND LAND SURVEYING BOARD.



mph
 Morris P. Hebert, Inc.
 client focused solutions

SURVEYING • ENGINEERING • ENVIRONMENTAL SERVICES • FIELD SERVICES • GIS
 116 VENTURE BLVD P.O. BOX 3106 HOUUMA, LOUISIANA 70360 (985) 879-2731
 10101 SOUTHWEST FREEWAY • SUITE 620 • HOUSTON, TEXAS 77071 • (713) 219-1470

FOGGY WATERS MARINA

PROPOSED FOGGY WATERS MARINA RENOVATIONS
 ST. TAMMANY PARISH, LOUISIANA, PLANVIEW MAP

DRAWN BY: JLC	SHEET: 3
CHECKED BY: MC	SCALE: 1 in = 20 ft
APPROVED BY:	DATE: 2/26/2024
REVISION BY:	JOB NO.: 15210-00
MAP FILE: 15210_PLAN_VIEW2.MXD	

F:\L DRIVE BACKUP\DRIVE15210 Foggy Waters Marina\Maps\15210_WATER_DEPTHS1.mxd

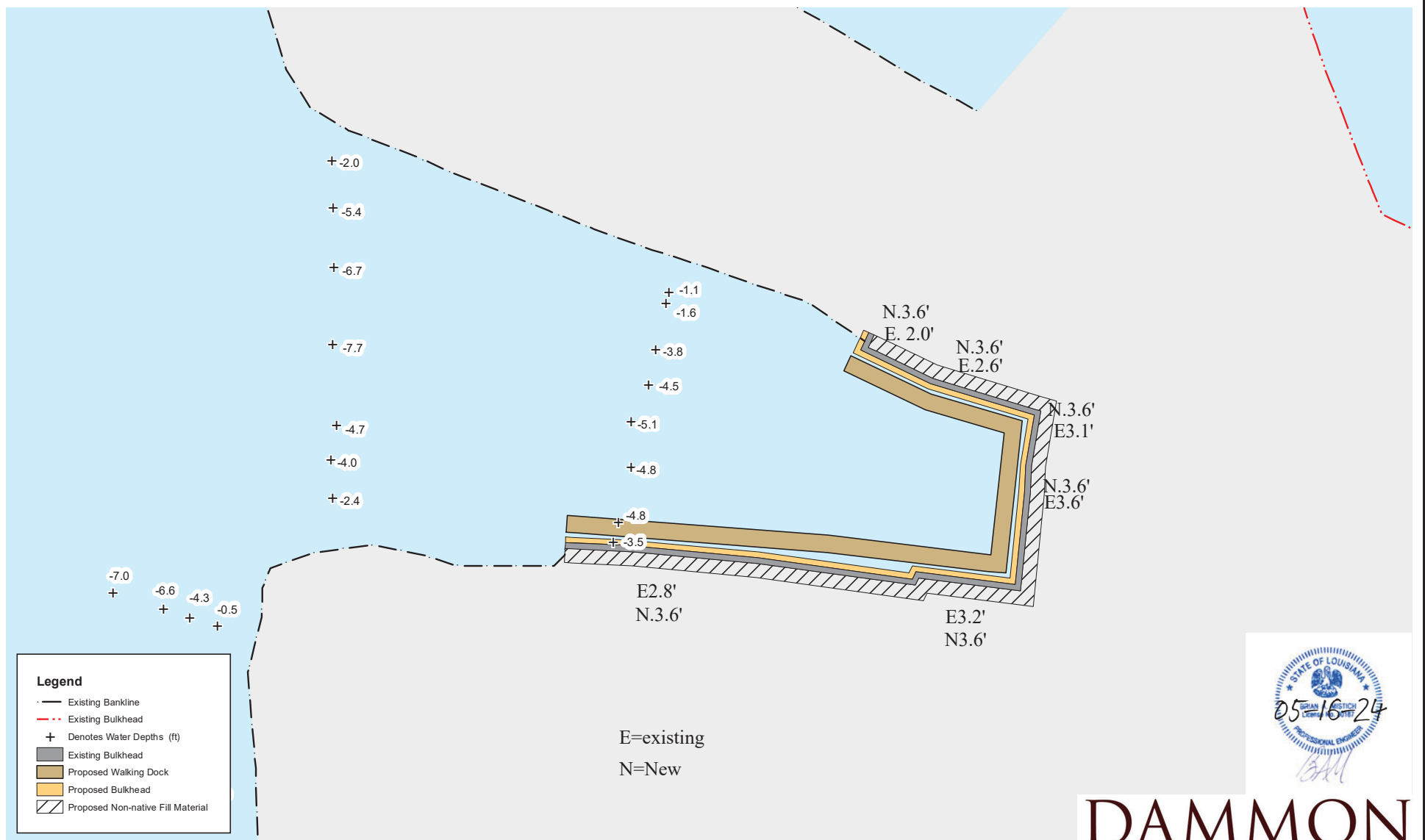

Legend

- - - Existing Bankline
- - - Existing Bulkhead
- + Denotes Water Depths (ft)
- Existing Bulkhead
- Proposed Walking Dock
- Proposed Bulkhead
- Proposed Non-native Fill Material

E=existing
N=New



DAMMON
ENGINEERING, INC.
LOUISIANA & MISSISSIPPI

NOTE: NO ON-THE-GROUND EFFORT HAS BEEN MADE FOR THE PROJECT TO LOCATE AND INDICATE ALL CABLES, PIPELINES, ETC. CROSSED BY THE PROPOSED PROJECT. THEREFORE, MORRIS P. HEBERT, INC. IS NOT RESPONSIBLE FOR ANY LOCATED DURING THE COURSE OF THE PROJECT.

NOTE: THIS DRAWING WAS PREPARED FOR PERMITTING PURPOSES ONLY, AND IS NOT A PROPERTY BOUNDARY SURVEY AND AS SUCH DOES NOT COMPLY WITH THE "MINIMUM STANDARDS FOR PROPERTY BOUNDARY SURVEYS" AS ADOPTED BY THE LOUISIANA PROFESSIONAL ENGINEERING AND LAND SURVEYING BOARD.



mp^h
Morris P. Hebert, Inc.
client focused solutions

SURVEYING • ENGINEERING • ENVIRONMENTAL SERVICES • FIELD SERVICES • GIS
116 VENTURE BLVD P.O. BOX 3106 HOUMA, LOUISIANA 70360 (985) 879-2731
10101 SOUTHWEST FREEWAY SUITE 620 HOUSTON, TEXAS 77071 (713) 219-1470

FOGGY WATERS MARINA

PROPOSED FOGGY WATERS MARINA RENOVATIONS
ST. TAMMANY PARISH, LOUISIANA, WATER DEPTH MAP

DRAWN BY: JLC	SHEET: 4
CHECKED BY: MC	SCALE: 1 in = 50 ft
APPROVED BY:	DATE: 2/16/2024
REVISION BY:	JOB NO.: 15210-00
MAP FILE: 15210_WATER_DEPTHS1.MXD	

CROSS-SECTION
NOT TO SCALE

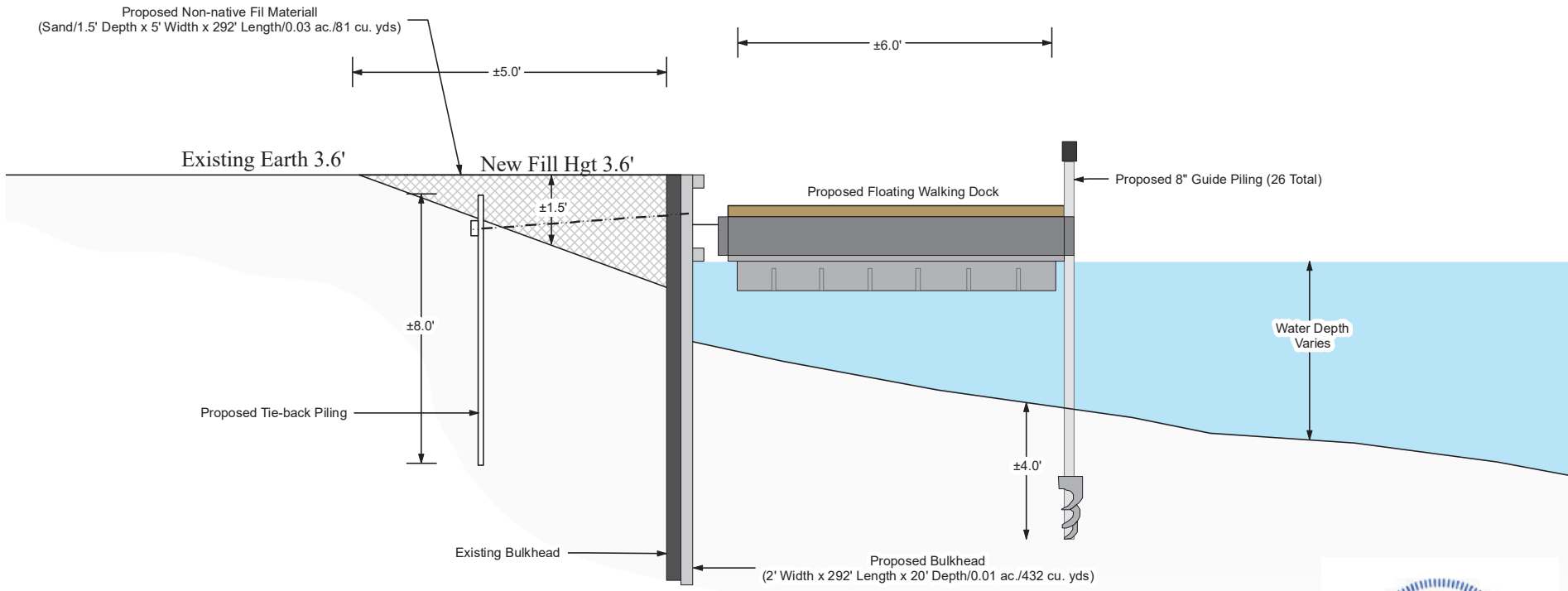

NOTE: EXISTING BULKHEAD IS DAMAGED AND DETERIORATING. CONTRACTOR PLANS TO LEAVE THE EXISTING BULKHEAD IN PLACE AND INSTALL PROPOSED BULKHEAD ADJACENT TO EXISTING BULKHEAD TO SHORE UP THE BANKLINE.

NOTE: NO ON-THE-GROUND EFFORT HAS BEEN MADE FOR THE PROJECT TO LOCATE AND INDICATE ALL CABLES, PIPELINES, ETC. CROSSED BY THE PROPOSED PROJECT. THEREFORE, MORRIS P. HEBERT, INC. IS NOT RESPONSIBLE FOR ANY LOCATED DURING THE COURSE OF THE PROJECT.

NOTE: THIS DRAWING WAS PREPARED FOR PERMITTING PURPOSES ONLY, AND IS NOT A PROPERTY BOUNDARY SURVEY AND AS SUCH DOES NOT COMPLY WITH THE "MINIMUM STANDARDS FOR PROPERTY BOUNDARY SURVEYS" AS ADOPTED BY THE LOUISIANA PROFESSIONAL ENGINEERING AND LAND SURVEYING BOARD.



DAMMON
ENGINEERING, INC.
LOUISIANA & MISSISSIPPI



SURVEYING • ENGINEERING • ENVIRONMENTAL SERVICES • FIELD SERVICES • GIS
116 VENTURE BLVD P.O. BOX 3106 HOUUMA, LOUISIANA 70360 (985) 879-2731
10101 SOUTHWEST FREEWAY • SUITE 620 • HOUSTON, TEXAS 77071 • (713) 219-1470

FOGGY WATERS MARINA

PROPOSED FOGGY WATERS MARINA RENOVATIONS
ST. TAMMANY PARISH, LOUISIANA, CROSS-SECTION MAP

DRAWN BY: JLC	SHEET: 5
CHECKED BY: MC	SCALE: N.T.S.
APPROVED BY:	DATE: 2/27/2024
REVISION BY:	JOB NO.: 15210-00
MAP FILE: 15210_CROSS_SECTION1.MXD	

F:\I. DRIVE BACKUP\DRIVE\15210 Foggy Waters Marina\Maps\15210 NOTES1.mxd

NOTES

1. A TOTAL OF 81 CUBIC YARDS/0.03 ACRES OF SAND WILL BE HAULED IN FOR THE CONSTRUCTION OF THE PROPOSED BULKHEAD.
2. APPROXIMATELY 60-12" PILINGS WILL BE INSTALLED FOR THE PROPOSED BULKHEAD. PILINGS WILL BE INSTALLED APPROXIMATELY 10-FEET BELOW MUDLINE. APPROXIMATELY 0.001 ACRES/22 CUBIC YARDS OF WATERBOTTOMS WILL BE IMPACTED BY THE INSTALLMENT OF THE PILINGS.
3. THE PROPOSED BULKHEAD TO BE INSTALLED WILL IMPACT APPROXIMATELY 0.01 ACRES/432 CUBIC YARDS OF WATERBOTTOMS.
4. NO WHEEL WASHING WILL BE REQUIRED FOR THE PROPOSED PROJECT.

CZM NOTES

1. ALL STRUCTURES, FACILITIES, WELL, AND PIPELINES/FLOWLINES OCCURRING IN OPEN WATER AREAS OR IN OILFIELD CANALS OR SLIPS SHALL BE REMOVED WITHIN 120 DAYS OF ABANDONMENT OF THE FACILITIES FOR THE HEREIN PERMITTED USE, UNLESS PRIOR WRITTEN APPROVAL TO LEAVE SUCH STRUCTURES IN PLACE IS RECEIVED FROM THE COASTAL MANAGEMENT DIVISION. THIS CONDITION DOES NOT PRECLUDE THE NECESSITY FOR REVISING THE CURRENT PERMIT OR OBTAINING A SEPARATE COASTAL USE PERMIT, SHOULD ONE BE REQUIRED, FOR SUCH REMOVAL ACTIVITIES.
2. STRUCTURES WILL BE MARKED/LIGHTED IN ACCORDANCE WITH U.S. COAST GUARD REGULATIONS.
3. IN ORDER TO ENSURE THE SAFETY OF ALL PARTIES, THE PERMITTEE SHALL CONTACT THE LOUISIANA ONE-CALL SYSTEM (1-800-272-3020) A MINIMUM OF 48 HOURS PRIOR TO THE COMMENCEMENT OF ANY EXCAVATION (DIGGING, DREDGING, JETTING, ETC.) OR DEMOLITION ACTIVITY.



DAMMON
ENGINEERING, INC.
 LOUISIANA & MISSISSIPPI



mph
 Morris P. Hebert, Inc.
 client focused solutions

SURVEYING • ENGINEERING • ENVIRONMENTAL SERVICES • FIELD SERVICES • GIS
 116 VENTURE BLVD P.O. BOX 3106 HOUMA, LOUISIANA 70360 (985) 879-2731
 10101 SOUTHWEST FREEWAY • SUITE 620 • HOUSTON, TEXAS 77071 • (713) 219-1470

FOGGY WATERS MARINA
PROPOSED FOGGY WATERS MARINA RENOVATIONS ST. TAMMANY PARISH, LOUISIANA, NOTES

DRAWN BY: JLC	SHEET: 6
CHECKED BY: MC	SCALE: N.T.S.
APPROVED BY:	DATE: 2/26/2024
REVISION BY:	JOB NO.: 15210-00
MAP FILE: 15210_NOTES1.MXD	