

**DESIGN CRITERIA**

THE CONSTRUCTION FOR SAID RESIDENCE, WHERE WIND SPEED IS 140 MILES PER HOUR AND VIBRANT WIND SPEED IS 130 MPH, WIND EXPOSURE ZONE C, IS DESIGNED IN ACCORDANCE WITH AMERICAN FOREST AND PAPER ASSOCIATION (AF&PA) WOOD FRAME CONSTRUCTION MANUAL FOR ONE AND TWO FAMILY DWELLINGS (WFCM) 2001 EDITION AS WELL AS THE INTERNATIONAL RESIDENTIAL CODE (IRC) 2021 EDITION. STRUCTURE SHALL BE BUILT TO THE 2021 INTERNATIONAL ENERGY CONSERVATION CODE (IECC) AND STATE AMENDMENTS ADOPTED JULY 1, 2023.

SQUARE FOOTAGE						WINDOW SCHEDULE						DOOR SCHEDULE						DOOR SCHEDULE					
NO	DESCRIPTION	AREA	UNIT	TYPE	NOTES	NO	WIDTH	HEIGHT	THK	DOOR MAT	FRAME MAT	NOTES	NO	WIDTH	HEIGHT	THK	DOOR MAT	FRAME MAT	NOTES				
1,828	LIVING					W01	3'-0"	6'-0"	VYNIL			WINDOW INSULATED	D01	3'-0"	8'-0"	1-3/4"	WOOD	WOOD	EXTERIOR DOOR WITH WINDOW				
91	FRONT PORCH					W02	3'-0"	4'-0"	VYNIL			WINDOW INSULATED	D02	2'-10"	8'-0"	1-3/4"	WOOD	WOOD	EXTERIOR DOOR WITH WINDOW				
314	REAR PORCH					W03	4'-0"	4'-0"	VYNIL			WINDOW FIXED INSULATED	D03	2'-8"	8'-0"	1-3/4"	WOOD	WOOD	INTERIOR DOOR				
160	STAIRS AND LANDINGS					W04	3'-0"	1'-0"	VYNIL			WINDOW FIXED INSULATED TRANSOM	D04	2'-6"	8'-0"	1-3/4"	WOOD	WOOD	INTERIOR DOOR				
2,398	TOTAL												D05	2'-6"	8'-0"	1-3/4"	WOOD	WOOD	INTERIOR DOOR WITH 6-1/2 INCH FRAME				
													D06	2'-0"	8'-0"	1-3/4"	WOOD	WOOD	INTERIOR DOOR				
													D07	(2)2'-6"	8'-0"	1-3/4"	WOOD	WOOD	INTERIOR DOUBLE DOOR				
													D08	2'-10"	8'-0"	1-3/4"	WOOD	WOOD	INTERIOR POCKET DOOR				
													D09	2'-6"	8'-0"	1-3/4"	WOOD	WOOD	INTERIOR HANGING BARN DOOR				
													D10	(2)2'-6"	8'-0"	1-3/4"	WOOD	WOOD	INTERIOR DOUBLE HANGING BARN DOOR				

NOTE: ALL EXTERIOR WINDOWS AND DOORS ASSEMBLES TO BE RATED FOR 140 MPH WINDS AND SHALL BE MISSILE IMPACT RESISTANT.

NOTE: OWNER TO PICK ALL DOOR STYLES AND COLORS

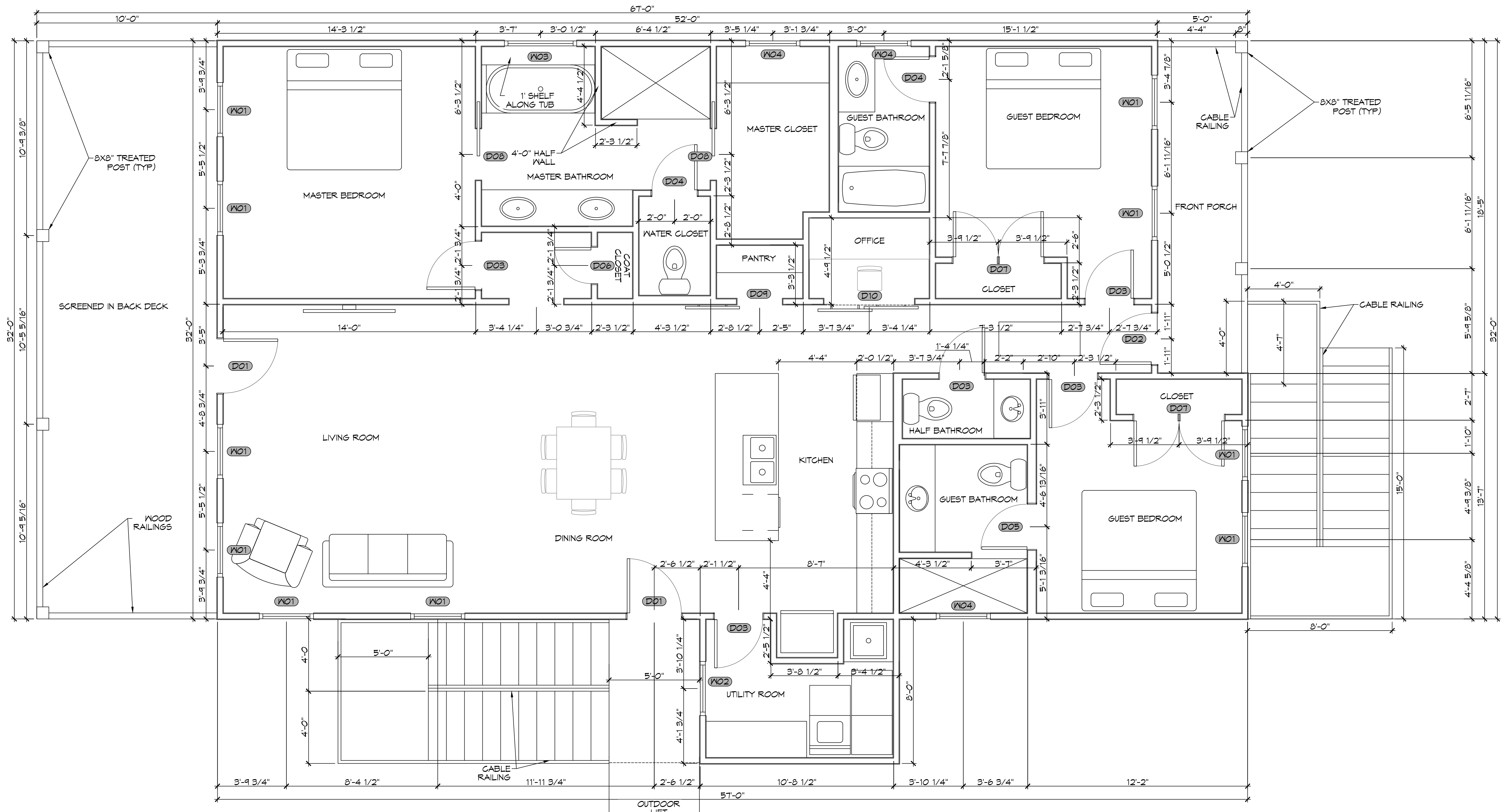

**1ST FLOOR PLAN**  
SCALE: 3/8" = 1'-0"

**DAMMON**  
ENGINEERING, INC.  
LOUISIANA & MISSISSIPPI  
www.dammonengineering.com  
554 Old Spanish Trail  
Sicilly, LA 70458  
PH: 985-649-5832

NO	DATE	REVISIONS



**NEW HOUSE PLAN**  
**JASON GUY**  
LOT 229  
MONGA DRIVE, LASKY RIVER ESTATES,  
CONVENTION, LOUISIANA 70335  
JOB No: 06-30-2025  
DATE: 06-30-2025  
DRAWN BY: CJD  
CHECKED BY: BAM

SHEET TITLE:  
FLOOR PLAN  
DRAWING NUMBER:  
**A101**  
SHEET No: 8 of 12