

**DESIGN CRITERIA**

THE CONSTRUCTION FOR SAID RESIDENCE, WHERE WIND SPEED IS 140 MILES PER HOUR AND VIBRANT WIND SPEED IS 130 MPH, WIND EXPOSURE ZONE C, IS DESIGNED IN ACCORDANCE WITH AMERICAN FOREST AND PAPER ASSOCIATION (AF&PA) WOOD FRAME CONSTRUCTION MANUAL FOR ONE AND TWO FAMILY DWELLINGS (WFCM) 2001 EDITION AS WELL AS THE INTERNATIONAL RESIDENTIAL CODE (IRC) 2021 EDITION. STRUCTURE SHALL BE BUILT TO THE 2021 INTERNATIONAL ENERGY CONSERVATION CODE (IECC) AND STATE AMENDMENTS ADOPTED JULY 1, 2023.

SQUARE FOOTAGE		WINDOW SCHEDULE				DOOR SCHEDULE						DOOR SCHEDULE									
NO	DESCRIPTION	MK	WIDTH	HEIGHT	FRAME MAT	NOTES	MK	WIDTH	HEIGHT	THK	DOOR MAT	FRAME MAT	NOTES	MK	WIDTH	HEIGHT	THK	DOOR MAT	FRAME MAT	NOTES	
1,828	LIVING																				
91	FRONT PORCH	W01	3'-0"	6'-0"	VYNIL	WINDOW INSULATED	D01	3'-0"	8'-0"	1-3/4"	WOOD	WOOD	EXTERIOR DOOR WITH WINDOW	D06	2'-0"	8'-0"	1-3/4"	WOOD	WOOD	INTERIOR DOOR	
314	REAR PORCH	W02	3'-0"	4'-0"	VYNIL	TEMPERED WINDOW INSULATED	D02	2'-10"	8'-0"	1-3/4"	WOOD	WOOD	EXTERIOR DOOR WITH WINDOW	D07	(2)2'-6"	8'-0"	1-3/4"	WOOD	WOOD	INTERIOR DOUBLE DOOR	
160	STAIRS AND LANDINGS	W03	4'-0"	4'-0"	VYNIL	TEMPERED WINDOW FIXED INSULATED	D03	2'-8"	8'-0"	1-3/4"	WOOD	WOOD	INTERIOR DOOR	D08	2'-10"	8'-0"	1-3/4"	WOOD	WOOD	INTERIOR POCKET DOOR	
2,348	TOTAL	W04	3'-0"	1'-0"	VYNIL	WINDOW FIXED INSULATED TRANSOM	D04	2'-6"	8'-0"	1-3/4"	WOOD	WOOD	INTERIOR DOOR	D09	2'-6"	8'-0"	1-3/4"	WOOD	WOOD	INTERIOR HANGING BARN DOOR	
		W05	3'-0"	6'-0"	VYNIL	TEMPERED WINDOW INSULATED	D05	2'-6"	8'-0"	1-3/4"	WOOD	WOOD	INTERIOR DOOR WITH 6-1/2 INCH FRAME	D10	(2)2'-6"	8'-0"	1-3/4"	WOOD	WOOD	INTERIOR DOUBLE HANGING BARN DOOR	

NOTE: ALL EXTERIOR WINDOWS AND DOORS ASSEMBLES TO BE RATED FOR 140 MPH WINDS AND SHALL BE MISSILE IMPACT RESISTANT.

NOTE: OWNER TO PICK ALL DOOR STYLES AND COLORS

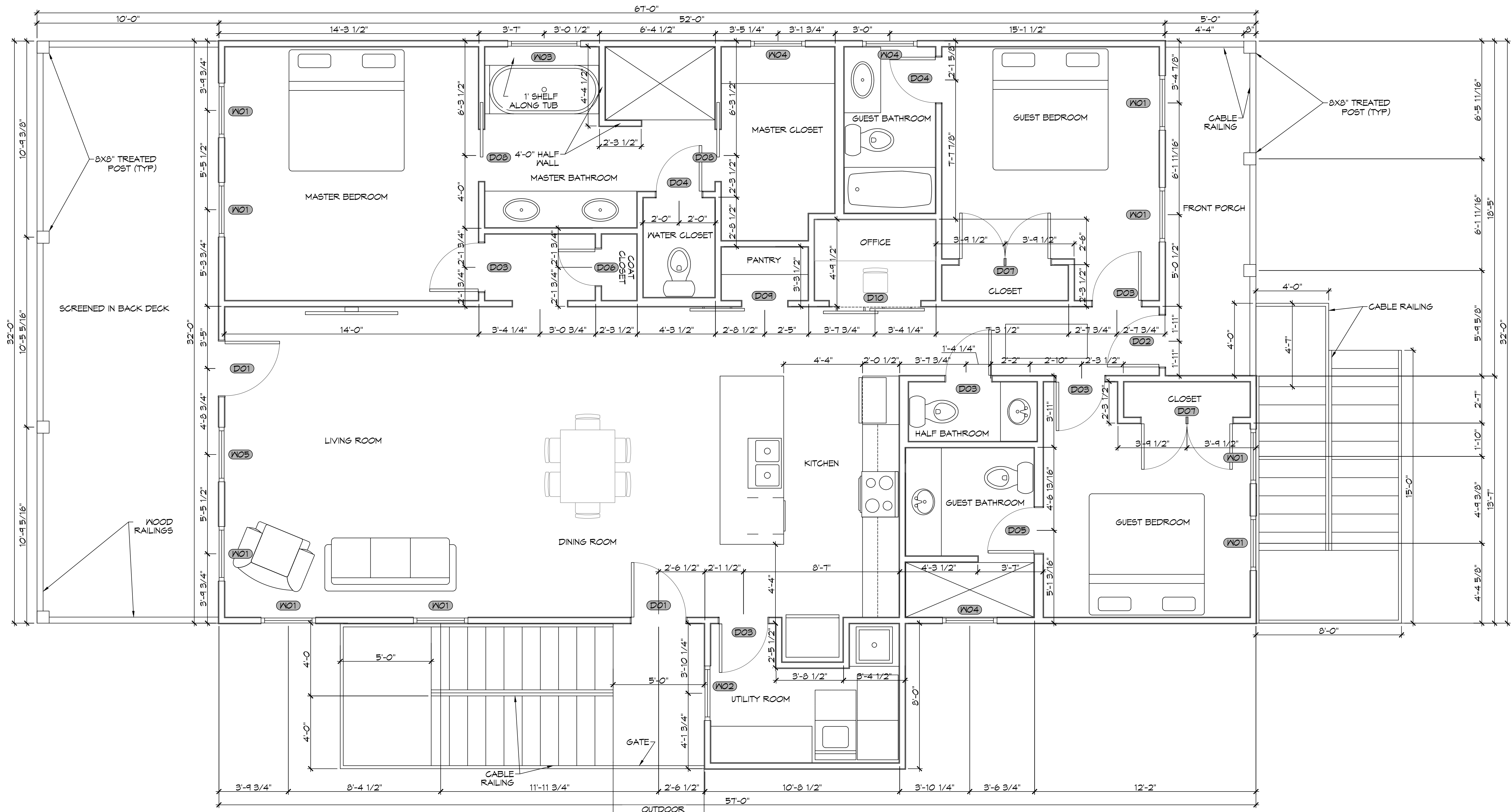

**1ST FLOOR PLAN**  
SCALE: 3/8" = 1'-0"

**DAMMON**  
ENGINEERING, INC.  
LOUISIANA & MISSISSIPPI

#	DESCRIPTION	DATE



**JASON GUY**  
NEW HOUSE PLAN  
SHEET TITLE: FLOOR PLAN  
DRAWING NUMBER: A101

LOT 229  
MONGA DRIVE, LASKY RIVER ESTATES,  
CONVINGTON, LOUISIANA 70338  
JOB No: 06-07-2025  
DATE: 06-07-2025  
DRAWN BY: CKD  
CHECKED BY: BAM

www.dammonengineering.com  
554 Old Spanish Trail  
Slidell, LA 70458  
PH: 985-649-5832

FILE NAME: A:\Projects\2025\06-07-2025\06-07-2025\06-07-2025.dwg