

1 RCP - LEVEL 1
SCALE: 1/8" = 1'-0"

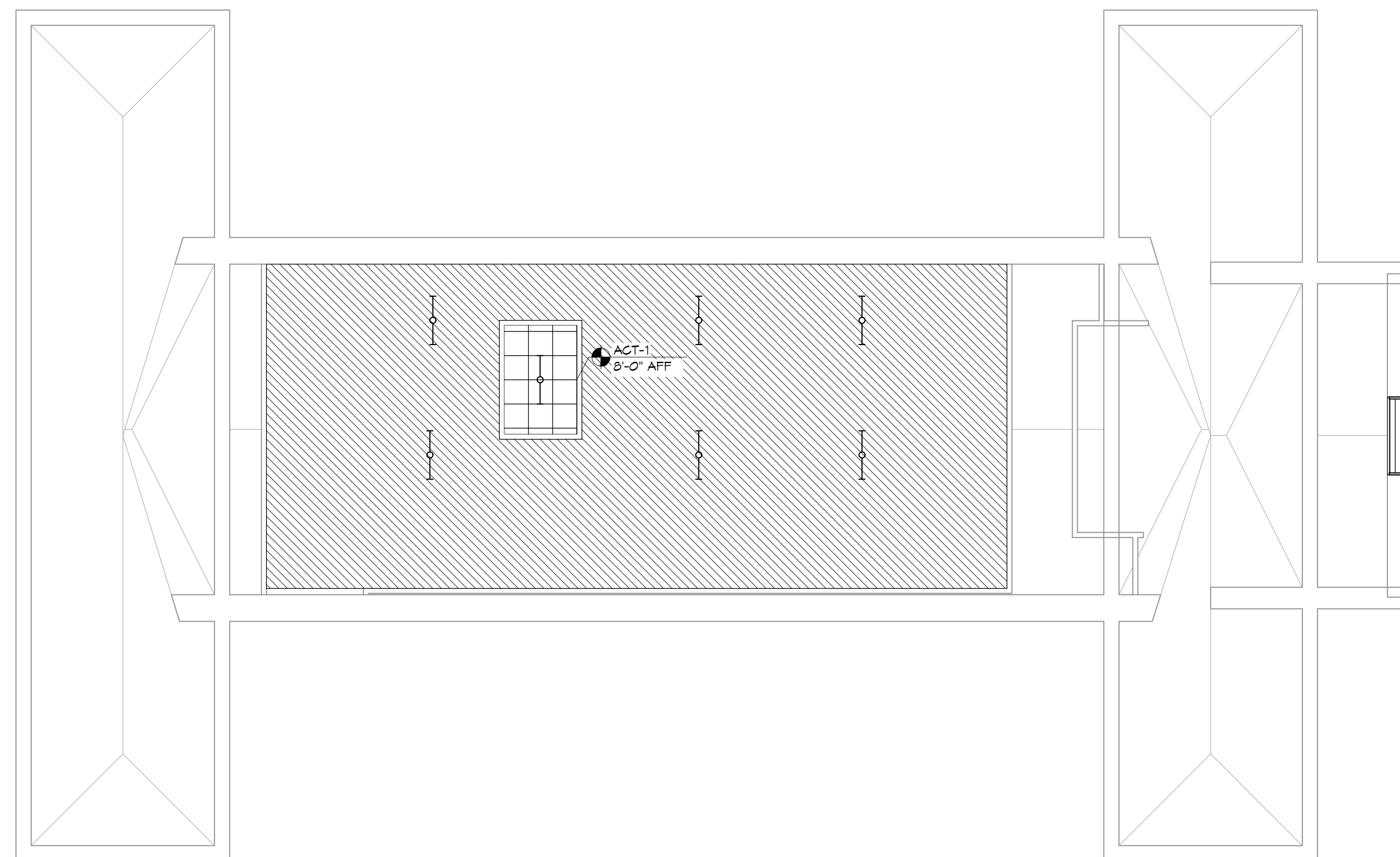

2 RCP - LEVEL 2
SCALE: 1/8" = 1'-0"

CEILING TYPES :

- GYP. BD. CLNG. ASSEMBLY RIGIDLY ATTACHED TO STRUCTURE
- SUSPENDED ACOUSTICAL PANEL CLNG ASSEMBLY
- EXPOSED STRUCTURE, NO CEILING

REFLECTED CEILING PLAN NOTES:

- REFER TO FIRE PROTECTION DRAWINGS FOR ALL AUTOMATIC FIRE SUPPRESSION SYSTEM REQUIREMENTS. S.C. TO COORDINATE SPRINKLER SYSTEM W/WORK OF ALL OTHER TRADES
- CONFIRM LIGHTING LAYOUT W/ ARCH. PRIOR TO INSTALLATION
- REFER TO MECHANICAL AND ELECTRICAL DRAWINGS FOR WALL-MOUNTED GRILLES & DIFFUSERS AND ALL OTHER ADDITIONAL FIXTURES, DEVICES & ITEMS NOT SHOWN
- INSTALL ALL CEILING FIXTURES AS DIMENSIONED ON RCPs. IN ROOMS/SPACES WITH ONLY ONE FIXTURE, CENTER EACH WAY.
- FOR TYPICAL CONDITIONS, FOLLOW INSTALLATION PARAMETERS AS SHOWN BELOW.
- FOR ALL ATYPICAL CONDITIONS, AND FOR ALL CONDITIONS WHERE CEILING COMPONENTS CANNOT BE INSTALLED AS SHOWN ON RCPs, COORDINATE EXACT LOCATIONS WITH ARCHITECT IN FIELD.
- REFER TO EXTERIOR ELEVATIONS FOR ADDITIONAL LIGHTING & MECHANICAL REQUIREMENTS.

CEILING FIXTURE LEGEND

- RECESSED 'CAN' FIXTURE
- PENDANT MOUNTED FIXTURE
- RECESSED FLUORESCENT FIXTURE
- SURFACE OR PENDANT MOUNTED LED FIXTURE
- SURFACE OR PENDANT MOUNTED LED FIXTURE
- HVAC SUPPLY REGISTER
- HVAC RETURN REGISTER
- HVAC EXHAUST REGISTER
- CEILING ACCESS PANEL
P: PANEL FOR PLUM. DEVICE ACCESS
M: PANEL FOR MECH. EQUIP ACCESS
- CIRCA REED HANGING SHADE
- TECH LIGHTIN - MULBERRY FLUSH MOUNT DRUM
- DECORATIVE VANITY FIXTURE
- CIRCA WALL SCOSCE - ASPECT LIBRARY SCOSCE

NOTE:
SEE ELECTRICAL DRAWINGS FOR LIGHT FIXTURE INFORMATION
SEE MECHANICAL DRAWINGS FOR HVAC INFORMATION

7. WHERE DIFFUSERS & GRILLES OCCUR TIGHT TO ROOM CORNERS, DIMENSION AS SHOWN IN ALL CONDITIONS WHERE POSSIBLE.

8. IN ALL CORRIDORS:
(a) ALIGN ALL RECESSED CAN LIGHT FIXTURES WITH CENTERLINE OF CORRIDOR AND DIMENSION AS SHOWN ON RCP.
(b) WHERE DIFFUSERS AND GRILLES OCCUR, ALIGN WITH CENTERLINE OF CORRIDOR AND CENTER BETWEEN LIGHT FIXTURES.
(c) WHERE ALL OTHER ELECTRICAL DEVICES OCCUR IN CEILINGS, CENTER BETWEEN ADJACENT LIGHT FIXTURES, DIFFUSERS, GRILLES, ETC. WHERE POSSIBLE.
(d) WHERE SPRINKLER HEADS OCCUR, ALIGN WITH CENTERLINE OF CORRIDOR AND SPACE AS NECESSARY TO ACHIEVE REQUIRED COVERAGE.

9. WHERE DIFFUSERS AND GRILLES OCCUR AT DOORWAYS, ALIGN AT CENTERLINE OF DOORWAY AS SHOWN. POSITION IN OTHER DIRECTION AS DIMENSIONED ON RCP. COORDINATE WITH ARCHITECT IN FIELD IF NOT OTHERWISE DIMENSIONED.

10. LOCATE ACCESS PANELS AS INDICATED ON DRAWINGS. FOR ACCESS PANELS NOT SHOWN BUT REQUIRED BY PROVISIONS OF THE CONTRACT DOCUMENTS, LOCATE IN ACCORDANCE WITH APPLICABLE CODES. SUBMIT PROPOSED LOCATIONS TO THE ARCHITECT FOR REVIEW AND ACCEPTANCE PRIOR TO INSTALLATION. ALL CEILING ACCESS PANELS ARE TO BE PROVIDED AND INSTALLED TO MAINTAIN ALL REQUIRED FIRE RATINGS.

11. CONTRACTOR IS TO SUBMIT PROPOSED LOCATIONS TO THE ARCHITECT FOR REVIEW AND ACCEPTANCE PRIOR TO INSTALLATION FOR ANY AND ALL CEILING MOUNTED FIXTURES OR DEVICES NOT SHOWN BUT REQUIRED BY PROVISIONS OF THE CONTRACT DOCUMENTS.

#	DESCRIPTION	DATE

SEAL: **PROGRESS SET**

NEW MEDICAL OFFICE
DIANA OAK HARBOR REAL ESTATE LLC
340 OAK HARBOR BLVD
SUITE 100
SUDBURY, LA 70458
JOB No: 2513 DATE: 06-03-2025
DRAWN BY: KCD CHECKED BY: JMS