



HVAC Equipment Submittal Data

For Review and Approval

05/30/2025

Project Info

Project Name: **covington**
Software version: **3.0**

Submitted By

Dealer Name: **Sammy Conzonere**
Email: **sammy.conzonere@jacksonsupplycompany.com**

Certifications:

Daikin brand heating and cooling units are certified as follows:

- AHRI Certified
- ETL & CETL Listed
- GAMA Certified

Limited Warranty:

- 5 year parts limited warranty
- 20 year heat exchanger limited warranty
- Complete warranty details attached

Daikin North America, LLC is not responsible for products installed outside the United States or its territories, or Canada.

Table of Contents

Model Number	Item	Description	Page
DSC0363D000001S	RTU	DSC0363DXXXAXADXXXXXXX Performance	3-4
DSC0603D000001S	RTU1	DSC0603DXXXAXADXXXXXXX Performance	5-6
Dimensional Drawings			
DSC0363D000001S	DSC 3-6 Ton Dimensions		7-7
DSC0363D000001S	Small Chassis Blower Curve Direct Drive R32		8-8
DSC0603D000001S	DSC 3-6 Ton Dimensions		7-7
DSC0603D000001S	Small Chassis Blower Curve Direct Drive R32		8-8
Field Install Accessories			
DSC0363D000001S, DSC0603D000001S	14 Roof Curb Small Chassis		9-9
DSC0363D000001S, DSC0603D000001S	Motorized Fresh Air Damper Small Chassis		10-10
	Limited Warranty		11-10

Design Requirements		Model Number:	DSC0363D000001S
Cooling Capacity	36,000 BTU/h	Code String:	DSC0363DXXXAXADXXXXXXXX
Configuration	Downflow	Tag:	RTU
Standard Features: DS Series Packaged Units		Cooling Performance	
- R-32 chlorine-free refrigerant		Total Capacity	35,283 BTU/h
- High-efficiency Copeland scroll compressor(s)		Sensible Capacity	26,911 BTU/h
- Copper tube / aluminum fin coils		Cooling Stages	One
- High-capacity, steel-cased filter dryer		Refrig Type	R-32
- High- and Low-pressure switches		Compressor Type	Copeland Scroll
- Lugged electrical contactor		Pressure Switches	High & Low Pressure (std)
- Single-point power		Outdoor Design Temp	95.00°F
- Color Coded Wiring		Entering Air Temp(db)	80.00°F
- Foil Faced Internal Insulation		Entering Air Temp(wb)	67.00°F
- Heavy-gauge, galvanized-steel cabinet		Leaving Air Temp(db)	60.10°F
- UV-resistant powder-paint finish		Leaving Air Temp(wb)	58.00°F
- Full perimeter base rail		Efficiency (M1)	14.0 SEER2/12.0 EER2
Unit Electrical Data		Heating Performance	
Power Supply	208-230/3/60 VOLT/PH	Heat Type	Electric
Total Unit MCA	33.1/37.1 A	Elect Htr KW	10kW Elect Htr
Total Unit MOP	35/40 A	Entering Air Temp	55.00 °F
Indoor Motor HP	0.75 HP	Leaving Air Temp	80.70 °F
Total Unit FLA	17.25/17.25 A	Supply Air Blower Performance	
• Compressor RLA	10.6	ACFM	1231 cfm
• Blower FLA	5.7	SCFM	1231 cfm
• Outdoor Fan FLA	0.95	Speed Tap	T4
• Heat Kit FLA	20.8/24.0	ESP	0.50 IWG
SCCR	5 kA	Motorized Fresh Air Damper	0.07 IWG
		Total ESP	0.57 IWG
		Blower Type	Direct Drive - Standard Static
		Elevation	0 ft
		Physical Attributes	
		Base Unit Oper. Weight (lbs)	482
		Filter(s)	20"X25"X2" Qty: 2

Outdoor sound (db) at 60 Hz									
Model	A-Weighted	63	125	250	500	1000	2000	4000	8000
036	72.1	N/A	60.2	63.4	65.4	66.0	65.2	62.0	57.0

db - decibel

Notes:

- 1 Outdoor sound data is measured in accordance with AHRI standard 270.
- 2 Measurements are expressed in terms of sound power. Do not compare these values to sound pressure values because sound pressure depends on specific environment factors which normally do not match individual applications. Sound power values are independent of the environment and therefore more accurate.
- 3 A-weighted sound ratings filter out high and very low frequencies, to better approximate the response of average human ear. A-weighted measurements for Daikin units are taken in accordance with AHRI standard 270.

LIST OF ACCESSORIES

Model Number: DSC0363D000001S; Code String: DSC0363DXXXAXADXXXXXXX; Tag: RTU;

Accessories					
Fld Inst	Fct Inst	Item #	Description	Dimensions	lbs
Y		0221L00014	14" Roof Curb		80
Y		0270L01165	Motorized Fresh Air Damper		40
Y		EHXD-3S10A	10kW Elect Htr		
			Base Unit Oper. Weight		482
			Total Weight		602

Design Requirements		Model Number:	DSC0603D000001S
Cooling Capacity	60,000 BTU/h	Code String:	DSC0603DXXXAXADXXXXXXXX
Configuration	Downflow	Tag:	RTU1
Standard Features: DS Series Packaged Units		Cooling Performance	
<ul style="list-style-type: none"> - R-32 chlorine-free refrigerant - High-efficiency Copeland scroll compressor(s) - Copper tube / aluminum fin coils - High-capacity, steel-cased filter dryer - High- and Low-pressure switches - Lugged electrical contactor - Single-point power - Color Coded Wiring - Foil Faced Internal Insulation - Heavy-gauge, galvanized-steel cabinet - UV-resistant powder-paint finish - Full perimeter base rail 		Total Capacity 58,279 BTU/h Sensible Capacity 44,497 BTU/h Cooling Stages One Refrig Type R-32 Compressor Type Copeland Scroll Pressure Switches High & Low Pressure (std) Outdoor Design Temp 95.00°F Entering Air Temp(db) 80.00°F Entering Air Temp(wb) 67.00°F Leaving Air Temp(db) 60.20°F Leaving Air Temp(wb) 58.00°F Efficiency (M1) 13.7 SEER2/11.8 EER2	
Unit Electrical Data		Heating Performance	
Power Supply	208-230/3/60 VOLT/PH	Heat Type	Electric
Total Unit MCA	47.7/53.7 A	Elect Htr KW	15kW Elect Htr
Total Unit MOP	50/60 A	Entering Air Temp	55.00 °F
Indoor Motor HP	1.0 HP	Leaving Air Temp	78.20 °F
Total Unit FLA	24.30/24.30 A	Supply Air Blower Performance	
• Compressor RLA	15.4	ACFM	2044 cfm
• Blower FLA	6.9	SCFM	2044 cfm
• Outdoor Fan FLA	2.0	Speed Tap	T5
• Heat Kit FLA	31.3/36.1	ESP	0.50 IWG
SCCR	5 kA	Motorized Fresh Air Damper	0.19 IWG
		Total ESP	0.69 IWG
		Blower Type	Direct Drive - Standard Static
		Elevation	0 ft
		Physical Attributes	
		Base Unit Oper. Weight (lbs)	508
		Filter(s)	20"X25"X2" Qty: 2

Outdoor sound (db) at 60 Hz									
Model	A-Weighted	63	125	250	500	1000	2000	4000	8000
060	76.9	N/A	66.6	65.1	70.4	72.0	69.7	66.6	57.4

db - decibel

Notes:

- 1 Outdoor sound data is measured in accordance with AHRI standard 270.
- 2 Measurements are expressed in terms of sound power. Do not compare these values to sound pressure values because sound pressure depends on specific environment factors which normally do not match individual applications. Sound power values are independent of the environment and therefore more accurate.
- 3 A-weighted sound ratings filter out high and very low frequencies, to better approximate the response of average human ear. A-weighted measurements for Daikin units are taken in accordance with AHRI standard 270.

LIST OF ACCESSORIES

Model Number: DSC0603D000001S; Code String: DSC0603DXXXAXADXXXXXXX; Tag: RTU1;

Accessories					
Fld Inst	Fct Inst	Item #	Description	Dimensions	lbs
Y		0270L01165	Motorized Fresh Air Damper		40
Y		0221L00014	14" Roof Curb		80
Y		EHXD-3S15A	15kW Elect Htr		
			Base Unit Oper. Weight		508
			Total Weight		628

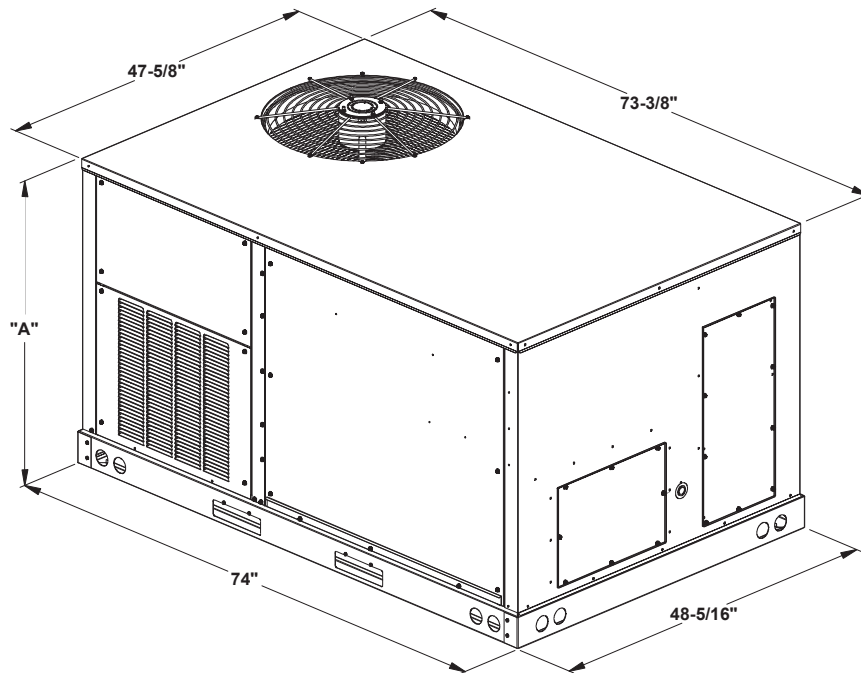

MODEL SIZE	DIM "A"
3 ton AC	39 7/8"
4 ton AC	39 7/8"
5 ton AC	39 7/8"
6 ton AC	43 1/2"

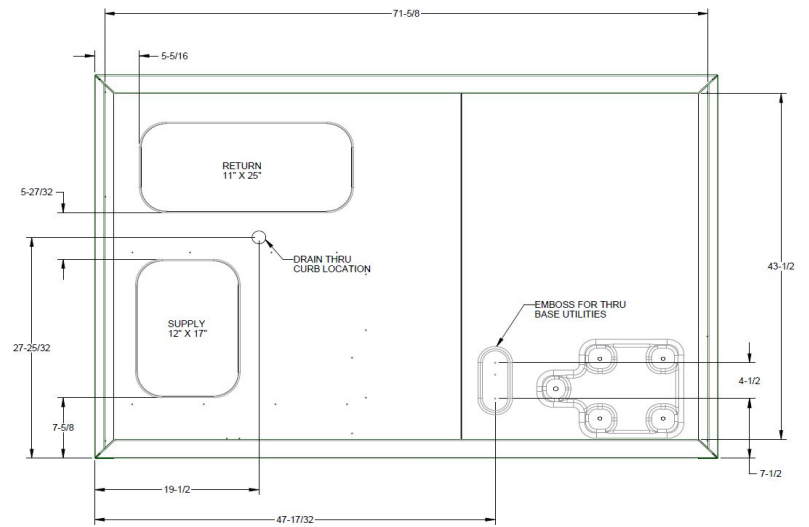
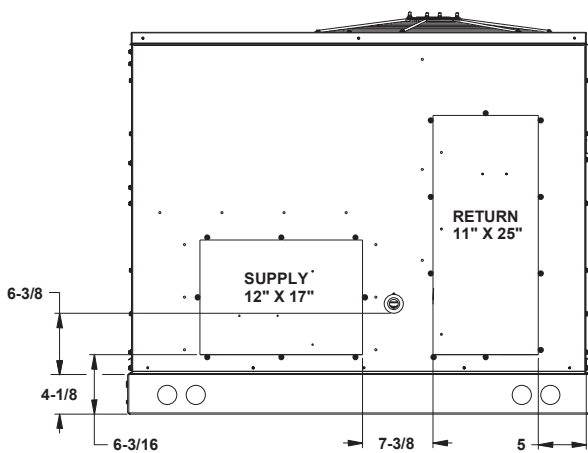

BOTTOM VIEW

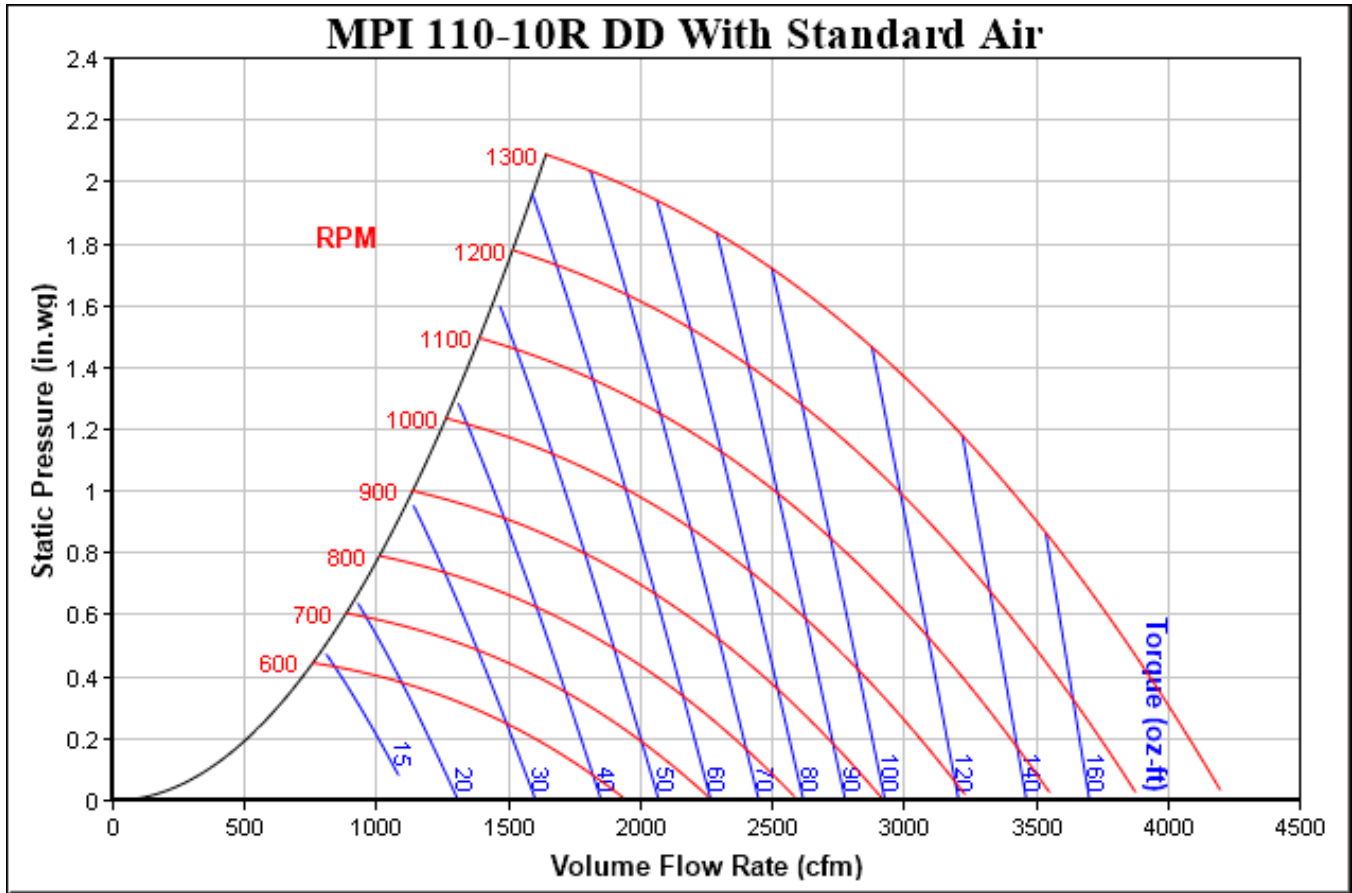



MicroMett

Date:

Specification Sheet for Daikin Small Cabinet 3 to 6 Ton
14" Roof Curb

Part Number:
Daikin PN: 0221L00014
MicroMett PN: CRBK-DKN12SA-1411

Submitted To:

Job:

Notes:

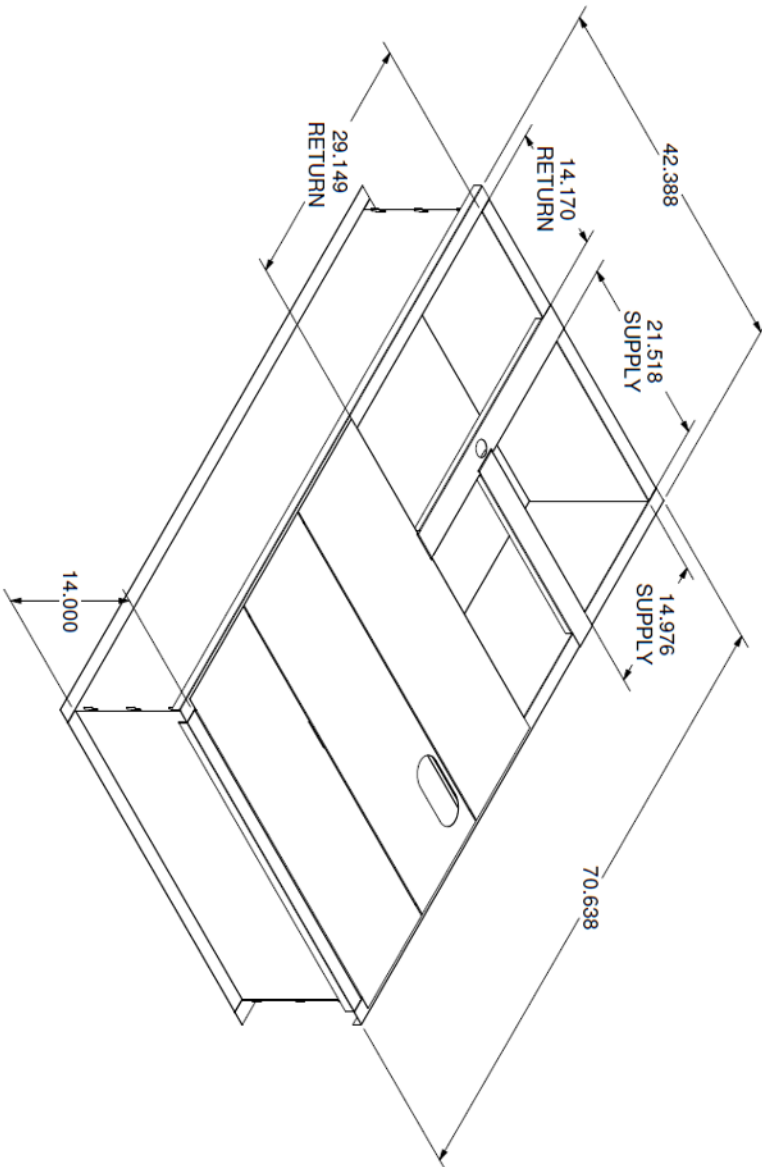

Notes:

1. Roof curb ships knocked down for field assembly. Package includes plastic corrugated end caps.
2. Curb includes wood nailer, attached to curb sides and ends, and gasket package shipped inside of curb package.
3. Deck pans include 1" – 1.5 lb. density insulation.
4. Curb sides and ends are constructed of 18 gauge galvanized steel.

Product Operating Weight:
80 Lbs

The information contained in this drawing is the sole property of MicroMett Corporation. Any reproduction in part or whole without the written permission of MicroMett Corporation is prohibited.

Indianapolis_3035 N. Shadeland Ave., Indianapolis, IN 46226_800.MMC.HVAC • Sparks_905 Southern Way, Sparks, NV 89431_800.884.4MMC • Longview_201 Kodak Blvd., Longview, TX 75602_903.248.4800



MicroMetl

Date:

Specification Sheet for Daikin Small Cabinet 3 to 6 Ton
Motorized Fresh Air Damper

Part Number:
Daikin PN: 0270L01165
MicroMetl PN: OAZ-DKN12CA-W00S

Submitted To:

Job:

Notes:

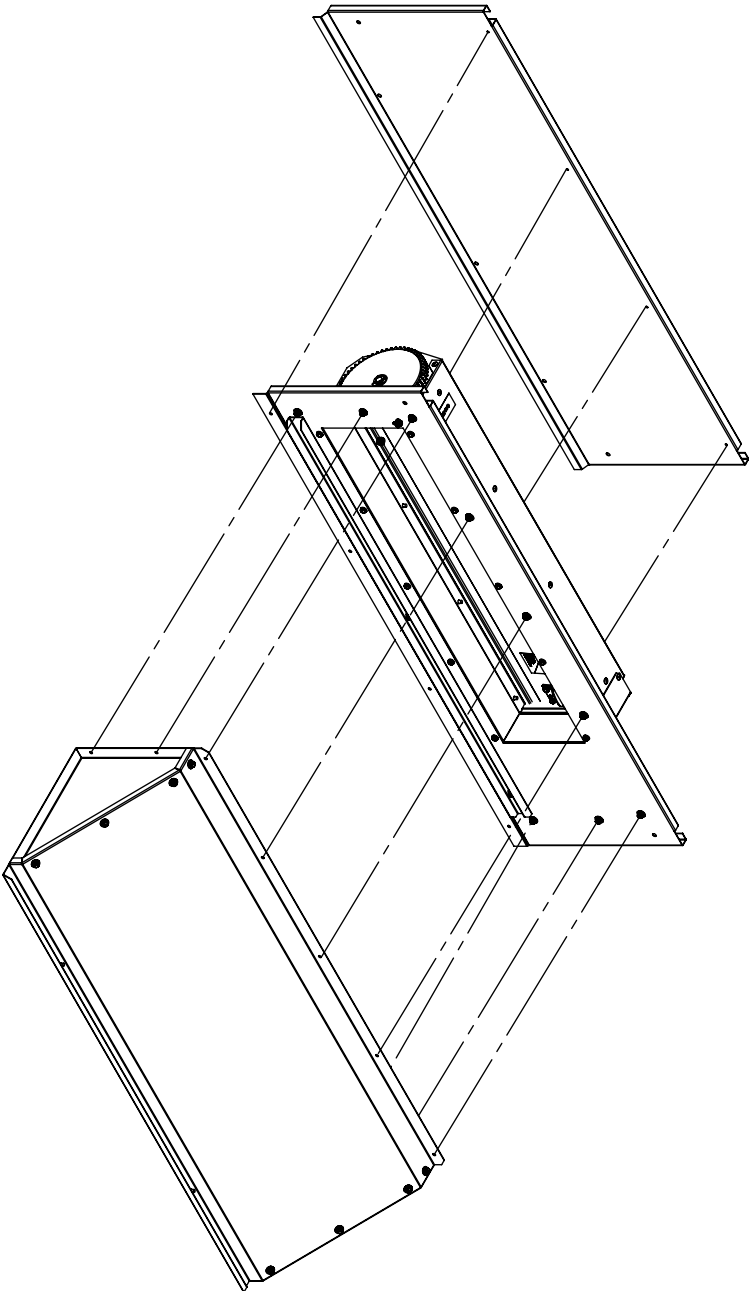

Notes:

1. Panel and hood are painted to match the unit.
2. 2 position actuator provided. Actuator open position is adjustable.
3. Kit can be used in horizontal or vertical application.
4. Panel is insulated with 1" - 1.5 lb. density insulation.

Product Operating Weight:
40 Lbs

The information contained in this drawing is the sole property of MicroMetl Corporation. Any reproduction in part or whole without the written permission of MicroMetl Corporation is prohibited.

Indianapolis_3035 N. Shadeland Ave., Indianapolis, IN 46226_800.MMC.HVAC • Sparks_905 Southern Way, Sparks, NV 89431_800.884.4MMC • Longview_201 Kodak Blvd., Longview, TX 75602_903.248.4800