

FILE NAME: A:\PROJECTS\2023\2309\230901\230901.dwg Plot Date: 10/26/2023 10:45:11 AM Plot Path: C:\Users\adammon\OneDrive\Documents\230901.dwg

SQUARE FEET		WINDOW SCHEDULE					DOOR SCHEDULE							
LIVING	1320	MK	WIDTH	HEIGHT	FRAME MAT	NOTES	MK	WIDTH	HEIGHT	THK	DOOR MAT	FRAME MAT	NOTES	
PORCH	825	W01	3'-0"	5'-0"	ALUM	SERIES 300 W/GRIDS SINGLE HUNG CLEAR	D01	(2)3'-0"	7'-0"	1-3/4"	WOOD	WOOD	EXTERIOR DOOR WITH GLASS PANE	
GARAGE	1080	W02	3'-0"	1'-0"	ALUM	FIXED WINDOW INSULATED TRANSOM	D02	3'-0"	7'-0"	1-3/4"	COMPOSITE	WOOD	EXTERIOR DOOR	
TOTAL SQ. FT.	3225	NOTE: OWNER TO PICK ALL WINDOW STYLES						D03	(2)3'-0"	7'-0"	1-3/4"	WOOD	WOOD	EXTERIOR FRENCH DOOR WITH GLASS PANES
		NOTE: FIELD VERIFY ALL DIMENSIONS, PAINT, FLOORING, LIGHTS, DOORS, ACCESSORIES, COLORS & STYLES WITH OWNER						D04	10'-0"	10'-0"	N/A	MTL	WOOD	GARAGE DOOR
		NOTE: FOR LOCATION OF WINDOWS, SEE P.M.I. DRAFTING & DESIGN DRAWINGS.						D05	(2)3'-0"	7'-0"	1-3/4"	WOOD	WOOD	INTERIOR FRENCH DOOR
							D06	(2)3'-0"	7'-0"	1-3/4"	WOOD	WOOD	INTERIOR FRENCH DOOR 1/2 HOUR FIRE RATED	
							D07	(2)2'-0"	7'-0"	1-3/4"	WOOD	WOOD	DOUBLE SLIDING BARN DOOR	
							D08	3'-0"	7'-0"	1-3/4"	WOOD	WOOD	INTERIOR DOOR	
							D09	4'-0"	7'-0"	-	-	-	CASED OPENING	

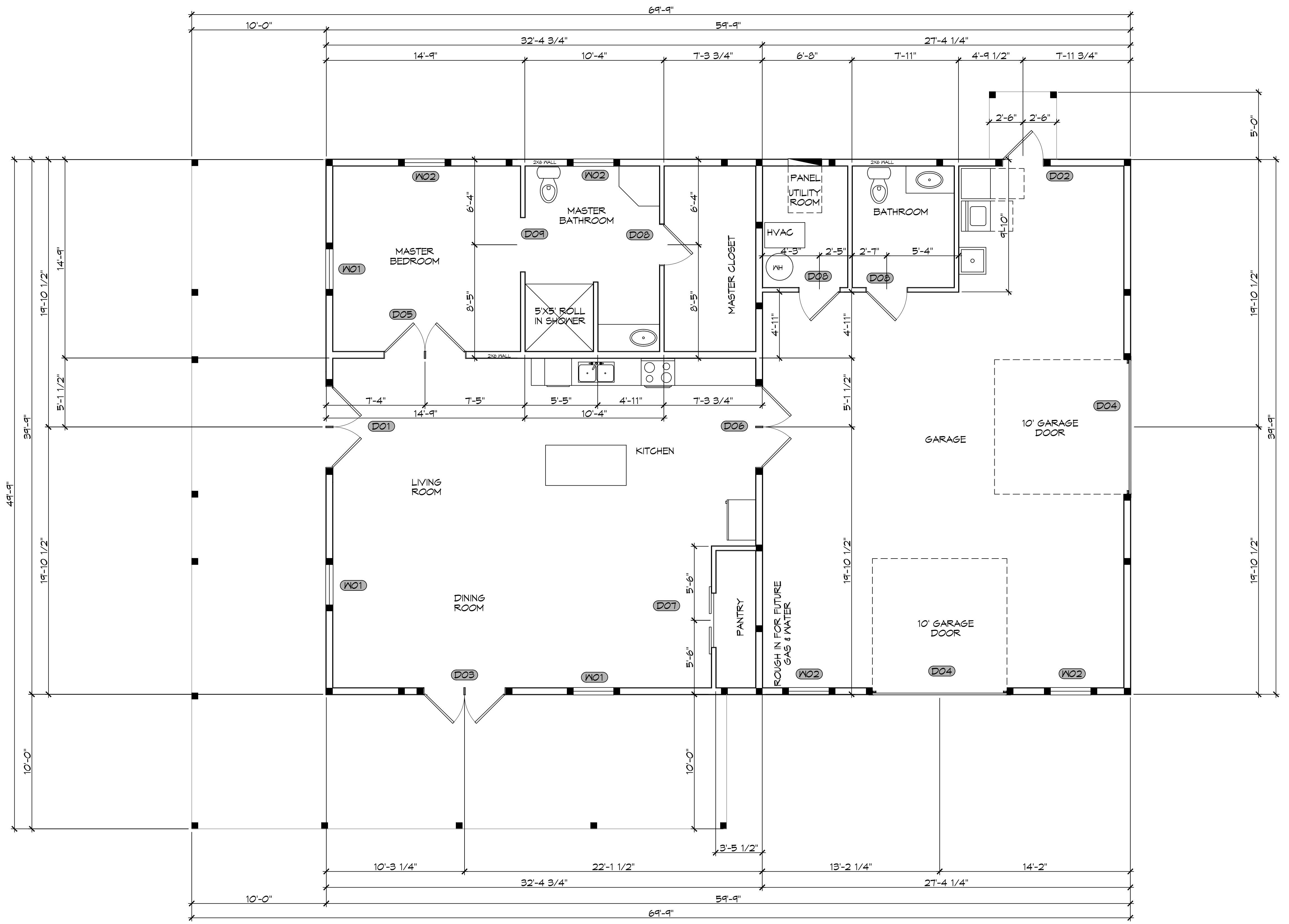

**3 FLOOR PLAN**  
SCALE: 1/4" = 1'-0"

**DAMMON ENGINEERING, INC.**  
 LOUISIANA & MISSISSIPPI  
 Chief Engineer: Brian Mistich, PE  
 554 Old Spanish Trail  
 Slidell, LA 70458  
 www.dammonengineering.com  
 info@dammonengineering.com  
 PH: 985-649-5832

#	DESCRIPTION	DATE



**HOUSE PLAN**  
**SARGELA FEHN**  
 35165  
 MOCKINGBIRD LOOP  
 PEARL RIVER, LA, 70452  
 JOB No: \_\_\_\_\_  
 DRAWN BY: \_\_\_\_\_  
 DATE: 10-26-2023  
 CHECKED BY: CKD

SHEET TITLE:  
**FLOOR PLAN**  
 DRAWING NUMBER:  
**A101**  
 SHEET No: 4 of 4