

DATE: 04-22-2025, 11:52 AM, PROJECT: 2500 CHURCHILL DOWNS DRIVE, BUSH, LA 70451, SHEET: C101, SCALE: 1"=20'

440.26

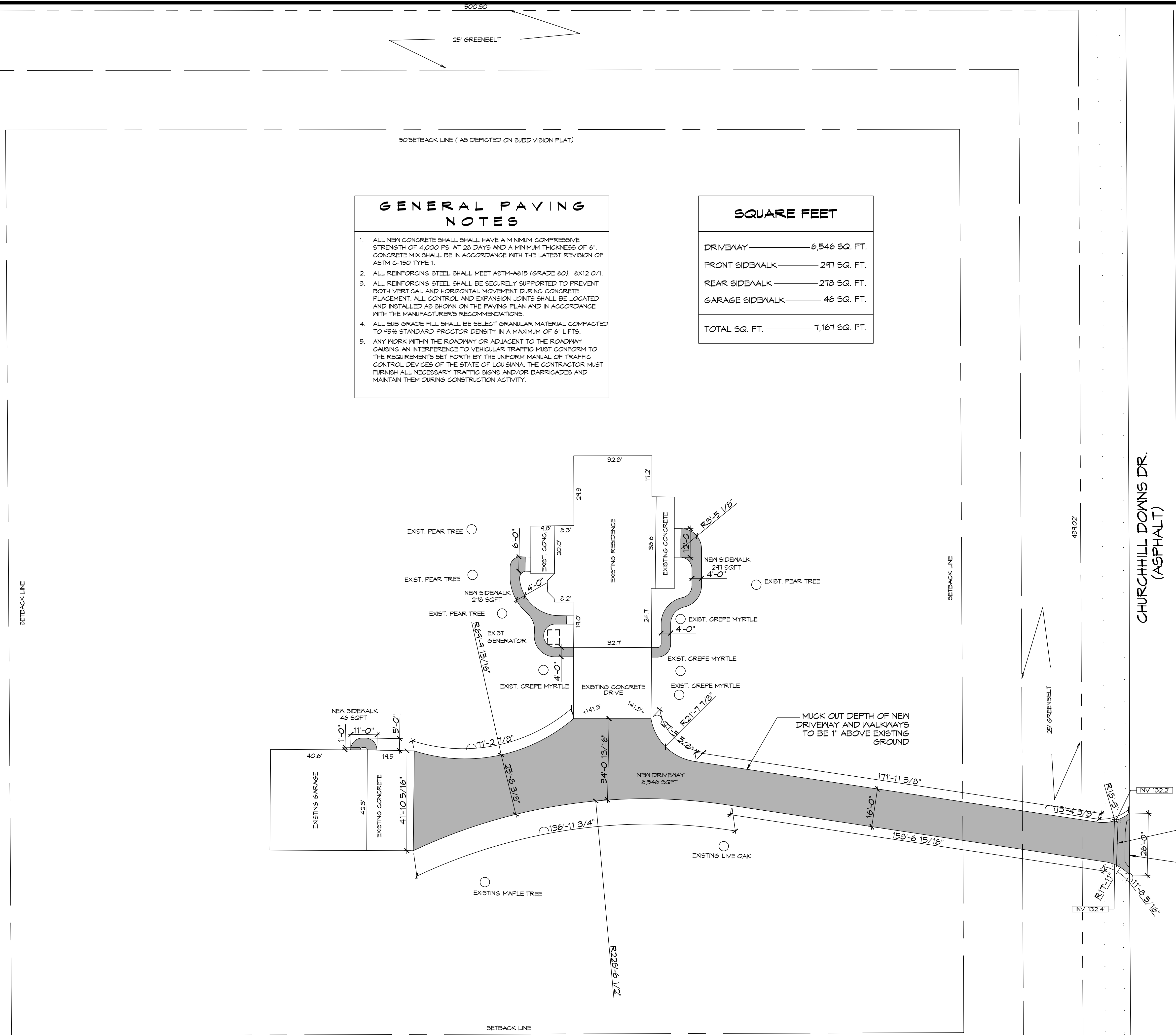

- GENERAL PAVING NOTES**
- ALL NEW CONCRETE SHALL HAVE A MINIMUM COMPRESSIVE STRENGTH OF 4,000 PSI AT 28 DAYS AND A MINIMUM THICKNESS OF 6". CONCRETE MIX SHALL BE IN ACCORDANCE WITH THE LATEST REVISION OF ASTM C-150 TYPE 1.
 - ALL REINFORCING STEEL SHALL MEET ASTM-A615 (GRADE 60), 6X12 O/1.
 - ALL REINFORCING STEEL SHALL BE SECURELY SUPPORTED TO PREVENT BOTH VERTICAL AND HORIZONTAL MOVEMENT DURING CONCRETE PLACEMENT. ALL CONTROL AND EXPANSION JOINTS SHALL BE LOCATED AND INSTALLED AS SHOWN ON THE PAVING PLAN AND IN ACCORDANCE WITH THE MANUFACTURER'S RECOMMENDATIONS.
 - ALL SUB GRADE FILL SHALL BE SELECT GRANULAR MATERIAL COMPACTED TO 95% STANDARD PROCTOR DENSITY IN A MAXIMUM OF 6" LIFTS.
 - ANY WORK WITHIN THE ROADWAY OR ADJACENT TO THE ROADWAY CAUSING AN INTERFERENCE TO VEHICULAR TRAFFIC MUST CONFORM TO THE REQUIREMENTS SET FORTH BY THE UNIFORM MANUAL OF TRAFFIC CONTROL DEVICES OF THE STATE OF LOUISIANA. THE CONTRACTOR MUST FURNISH ALL NECESSARY TRAFFIC SIGNS AND/OR BARRICADES AND MAINTAIN THEM DURING CONSTRUCTION ACTIVITY.

SQUARE FEET

DRIVEWAY	6,546 SQ. FT.
FRONT SIDEWALK	291 SQ. FT.
REAR SIDEWALK	278 SQ. FT.
GARAGE SIDEWALK	46 SQ. FT.
TOTAL SQ. FT.	7,161 SQ. FT.

CHURCHILL DOWNS DR.
(ASPHALT)

DAMMON ENGINEERING, INC.
LOUISIANA & MISSISSIPPI

www.dammonengineering.com
info@dammonengineering.com
Chief Engineer: Brian Misticich, PE
554 Old Spanish Trail
Slidell, LA 70458
PH: 985-649-5832

#	DESCRIPTION	DATE



NEW DRIVEWAY PLAN

LARRY AND GINA FISHER

200 CHURCHILL DOWNS DRIVE
BUSH, LA 70451

JOB No: DATE: 04-22-2025
DRAWN BY: SCG CHECKED BY: BAM

SHEET TITLE:
PROPOSED DRIVEWAY PLAN

DRAWING NUMBER:
C101

SHEET No: 1 of 1