

P.L.E. NAME: J.V. - 1/2" Scale: 1/2" = 1'-0" Date: 12/5/2025 11:00:00 AM
 P.L.E. NAME: J.V. - 1/2" Scale: 1/2" = 1'-0" Date: 12/5/2025 11:00:00 AM

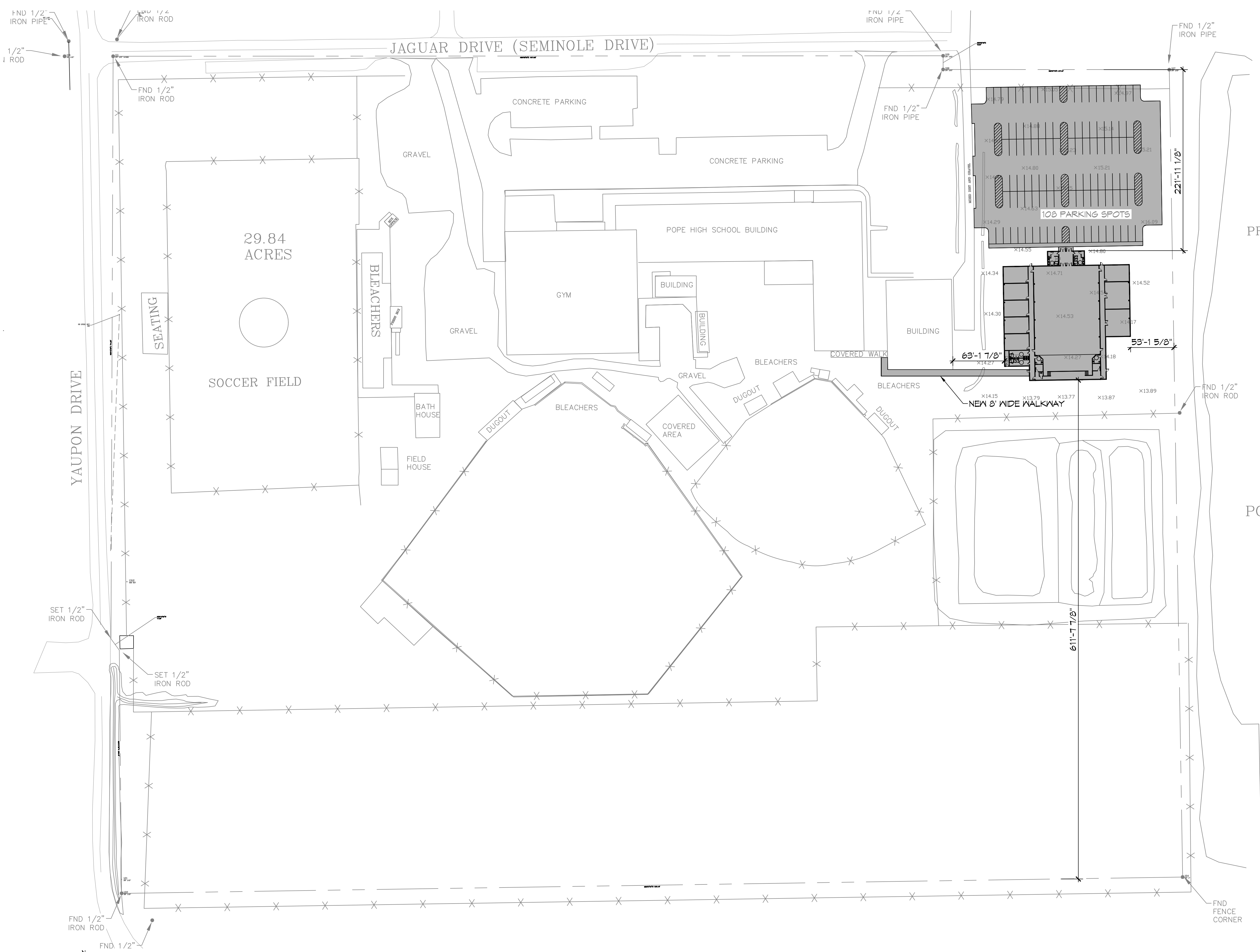

1 PROPOSED SITE PLAN
 SCALE: 1"=60'-0"

PLANNING
ZONED: NC-2 NEIGHBORHOOD COMMERCIAL
FLOOD ZONE
ZONE: 'C'
BUILDING ELEVATION
BASE FLOOD ELEVATION = N/A FINISHED FLOOR ELEVATION = N/A
BUILDING SQ. FT.
TOTAL BUILDING AREA = 20,545 SQ. FT.

DAMMON

ENGINEERING, INC.

LOUISIANA & MISSISSIPPI

Chief Engineer: Brian Mistich, PE
 554 Old Spanish Trail
 Slidell, LA 70468
 www.dammonengineering.com
 info@dammonengineering.com
 PH: 985.649.5832 F: 985.641.5950

#	DESCRIPTION	DATE

NEW AUDITORIUM
 POPE JOHN PAUL
 AUDITORIUM

1901 LAGUAR DR
 SLIDELL, LA 70461
 JOB No: 22B DATE: 12-5-2025
 DRAWN BY: BAK CHECKED BY: BAK

SHEET TITLE:
PROPOSED SITE PLAN

DRAWING NUMBER:
C101

SHEET No: 1 of 4