

FILE NAME: J:\1 - School Project\New Plan\2nd Floor\2nd Floor.dwg - Plot Date: 02/05/2025 10:05:15 AM - Plot Scale: 1/8"=1'-0"

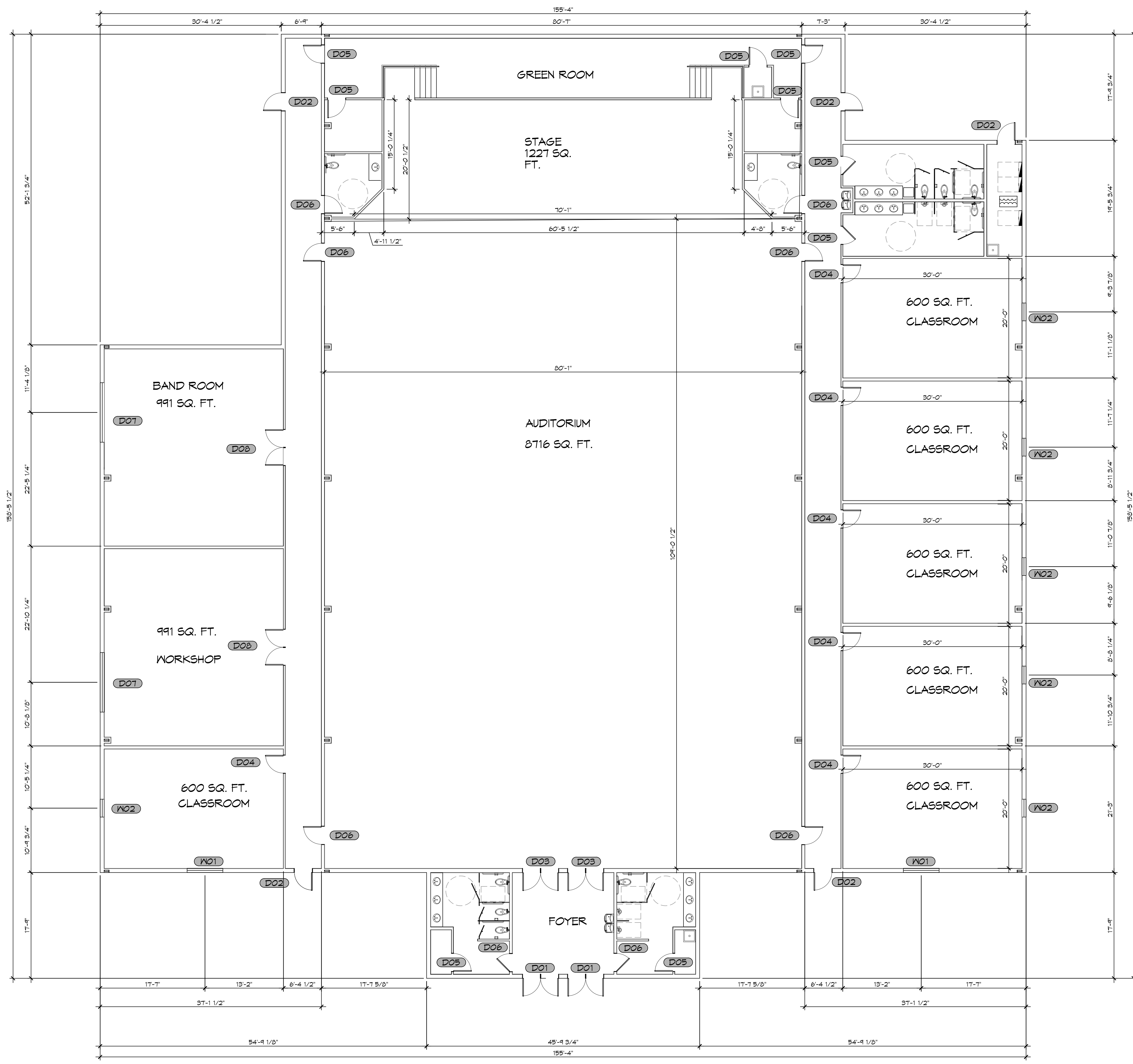

GENERAL NOTES

1. INSULATION AND INSULATION ASSEMBLIES SHALL MEET THE REQUIREMENTS OF IBC 2012 SECTION 711.
 - A. CONCEALED INSULATION SHALL HAVE A FLAME SPREAD OF 0-25 AND SMOKE DEVELOPED INDEX OF 0-450, EXCEPT THAT IN COMBUSTIBLE (WOOD FRAME) CONSTRUCTION.
 - B. FACING SHALL COMPLY WITH IBC 2012.
2. ALL MATERIALS SHALL BE NEW AND UL LISTED.
3. NO WORK SHALL BE CONCEALED UNTIL APPROVED BY LOCAL INSPECTORS.
4. CONSTRUCTION SHALL COMPLY WITH ALL PARISH, STATE, AND LOCAL CODES.
5. CONTRACTOR TO GUARANTEE WORK FOR ONE YEAR FROM DATE OF SUBSTANTIAL COMPLETION.
6. CONTRACTOR SHALL FURNISH WATER AND POWER FROM EXISTING SOURCES.
7. EXTERIOR CAULKING SHALL BE THICKAL CAULK.
8. PAINT SHALL BE SHERWIN WILLIAMS OR EQUIVALENT AND APPROPRIATE FOR THE SUBSTRATE TO WHICH IT IS APPLIED AS RECOMMENDED BY PAINT MANUFACTURER. ALL WORK TO RECEIVE THREE COATS (ONE PRIMER COAT, TWO FINISH COATS) UNLESS OTHERWISE RECOMMENDED BY PAINT MANUFACTURER. COLORS TO BE SELECTED BY OWNER.
9. PROVIDE CLEANUP ON A REGULAR BASIS. NO TRASH SHALL BE STORED INSIDE BUILDING PREMISES.
10. ALL BATT INSULATION SHALL HAVE A CLASS "A" (0-25) FLAME SPREAD IN COMPLIANCE WITH IBC 2012.
11. USE 2x6 STUDS, OR TWO 2x4 STAGGERED STUDS WITH 2x6 SILL PLATE AT ALL WALLS WHERE 4" PIPE IS INDICATED. SEE PLUMBING RISER DIAGRAM FOR PIPE SIZE.
12. PROVIDE GALVANIZED METAL PAN WITH DRAIN AT ALL WATER HEATERS.
13. ALL FLOORING SHALL MEET OR EXCEED ADA GUIDELINES REQUIREMENTS FOR SLIP RESISTANCE.
14. INTERIOR LOCKS ON DOORS IN MEANS OF EGRESS SHALL NOT REQUIRE THE USE OF A KEY, SPECIAL KNOWLEDGE, OR SPECIAL DEVICE TO OPEN IN THE DIRECTION OF EGRESS. ALL DOORS SHALL HAVE LEVER TYPE HANDLES.
15. INTERIOR WALLS AND CEILINGS SHALL HAVE A FLAME SPREAD OF 0-200 AND A SMOKE DEVELOPMENT RATING OF 0-450.
16. ALL WORK SHALL COMPLY WITH THE LATEST EDITION OF ALL LOCAL, STATE, AND NATIONAL CODES COVERING THE TYPE OF WORK BEING PERFORMED.
17. PROVIDE PORTABLE FIRE EXTINGUISHERS IN ACCORDANCE WITH NFPA 101. SEE APPENDIX 'E' OF NFPA 101 FOR DISTRIBUTION OF EXTINGUISHERS.
18. ALL FIRE WALLS SHALL EXTEND TIGHT TO ROOF DECK AND BE SEALED WITH AN APPROVED FIRE CAULK.
19. ALL ELECTRICAL, MECHANICAL, AND PLUMBING MATERIALS PENETRATING FIRE WALLS SHALL BE FIRE CAULKED. (PENETRATIONS THROUGH RATED CONSTRUCTION SHALL BE SEALED WITH A MATERIAL CAPABLE OF PREVENTING THE PASSAGE OF FLAMES AND HOT GASES WHEN TESTED IN ACCORDANCE WITH ASTM-E814.)
20. SERVICE COUNTERS SHALL HAVE AN ACCESSIBLE WRITING SURFACE IN COMPLIANCE WITH ADAAG ACCESSIBILITY GUIDELINES 2010, SECTION 902.3.

DOOR SCHEDULE

MK	WD	HT	THK	MAT	FRM	FR	NOTES
D01	(2) 3'-0"	8'-0"	1-3/4"	METAL	METAL	NR	EXTERIOR DOUBLE DOOR WITH WINDOW & CLOUSER
D02	3'-0"	7'-0"	1-3/4"	METAL	METAL	NR	EXTERIOR DOOR WITH CLOUSER
D03	(2) 3'-0"	8'-0"	1-3/4"	WOOD	METAL	45 MIN	INTERIOR DOUBLE DOOR WITH CLOUSER
D04	3'-0"	7'-0"	1-3/4"	WOOD	METAL	NR	INTERIOR DOOR WITH WINDOW & CLOUSER
D05	3'-0"	7'-0"	1-3/4"	WOOD	METAL	NR	INTERIOR DOOR
D06	3'-0"	7'-0"	1-3/4"	WOOD	METAL	45 MIN	INTERIOR DOOR WITH CLOUSER
D07	10'-0"	10'-0"	-	METAL	METAL	-	ROLL UP GARAGE DOOR
D08	(2) 3'-0"	7'-0"	1-3/4"	WOOD	METAL	NR	INTERIOR DOUBLE DOOR WITH WINDOW & CLOUSER

WINDOW SCHEDULE

MK	WD	HT	FRAME	TYPE	NOTES
W01	6'-0"	5'-0"	METAL	FIXED	TEMPERED
W02	3'-0"	5'-0"	METAL	FIXED	TEMPERED

NOTE: ALL EXTERIOR WINDOW ASSEMBLIES TO BE RATED FOR 140 MPH WINDS AND SHALL BE MISSILE IMPACT RESISTANT.

DAMMON ENGINEERING, INC.
 LOUISIANA & MISSISSIPPI
 Chief Engineer: Brian March, PE
 554 Old Spanish Trail
 Slidell, LA 70458
 www.dammonengineering.com
 info@dammonengineering.com
 PH: 985.649.5832 F: 985.641.5950

NO.	DESCRIPTION	DATE

NEW AUDITORIUM POPULATION

1801 JAGUAR DR
 SLIDELL, LA 70461
 JOB No: 2395
 DATE: 12-9-2025
 DRAWN BY: JMS
 CHECKED BY:

SHEET TITLE:
 FLOOR PLAN

DRAWING NUMBER:
A101