

X-plan

MATCH LINE MATCH LINE

PARTIAL PLAN OF WALL AT WINDOWS ABOVE

- SEQUENCE OF FLOOR CONSTRUCTION
1. DEMOLITION OF EXISTING HOOD FLOORING SYSTEM
 2. BEAD PLAST EXISTING CONG. SLAB
 3. TERMITE TREAT EXISTING CONCRETE SLAB CRACKS
 4. EPOXY TREAT CONCRETE SLAB CRACKS
 5. TOP EXISTING SLAB IN 1/2" CONCRETE WITH WIRE SHRINKAGE MESH

EXISTING PIPE COLUMNS TO BE STRIPPED PRIMED AND PAINTED TYPICAL

NEW CONCRETE SIDE WALK SLAB TO BE POURED AFTER TERMITE TREATMENT

NEW MASONRY VENEER TO MATCH EXISTING

LEGEND OF MATERIALS

- EXISTING PARTITION
- NEW METAL STUDS
- BRICK

WALL NOTES

1. ALL EXTERIOR METAL STUD WALLS ARE 4" WITH WALL INSULATION UNLESS DIMENSIONED OTHERWISE.
2. ALL INTERIOR METAL STUD WALLS ARE 3-5/8" WITH SOUND ATTENUATION INSULATION UNLESS DIMENSIONED OTHERWISE. SEE PARTITION TYPES FOR CONTINUATION OF METAL STUDS, INSULATION & GYPSUM WALL BOARD ABOVE FINISHED CEILING AND WALL INSULATION REQUIREMENTS.



FAULTEROY & LATHAM, INC. ARCHITECTS, ENGINEERS, PLANNERS

29 ST. JOHN LANE • COVINGTON, LA 70433 • (985) 893-4100 • www.fl-inc.com

PRODUCED OR USED IN ANY MANNER WITHOUT WRITTEN CONSENT OF FAULTEROY & LATHAM, INC.

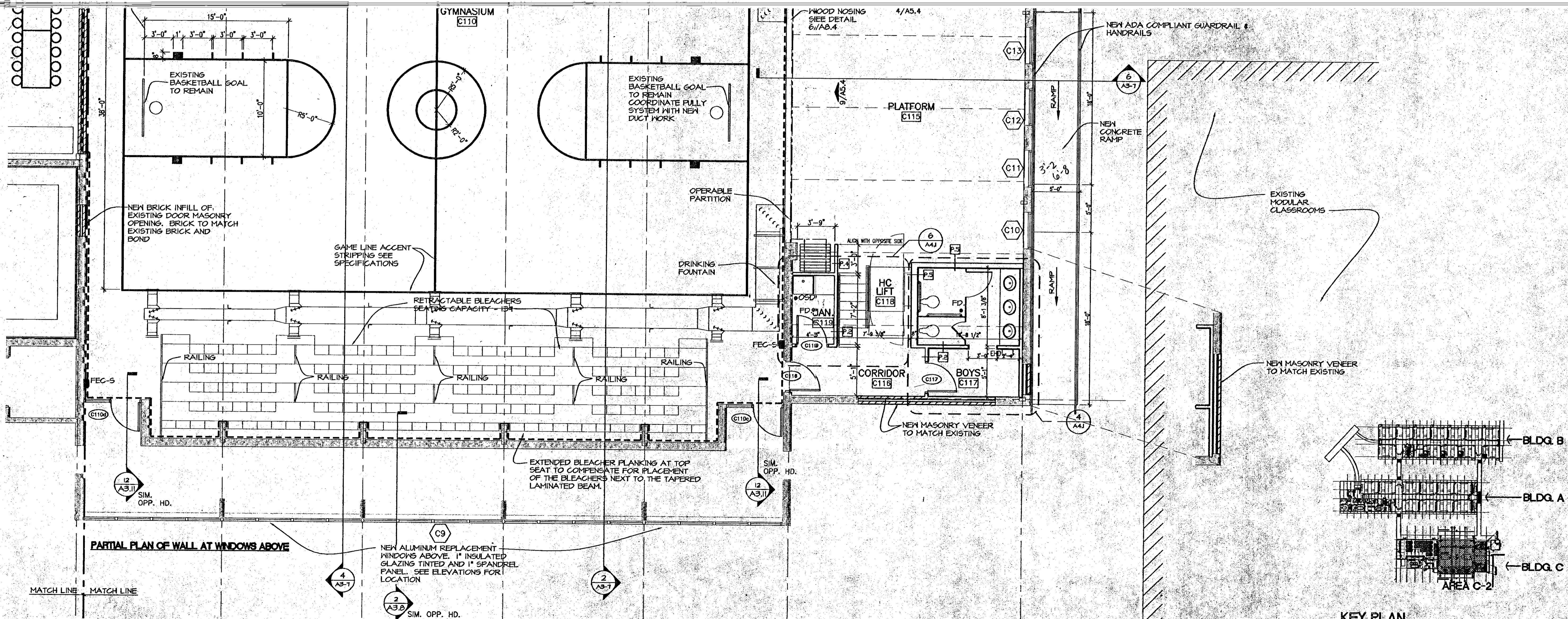

PARTIAL PLAN OF WALL AT WINDOWS ABOVE

NEW ALUMINUM REPLACEMENT WINDOWS ABOVE. 1" INSULATED GLAZING TINTED AND 1" SPANDREL PANEL. SEE ELEVATIONS FOR LOCATION

KEY PLAN

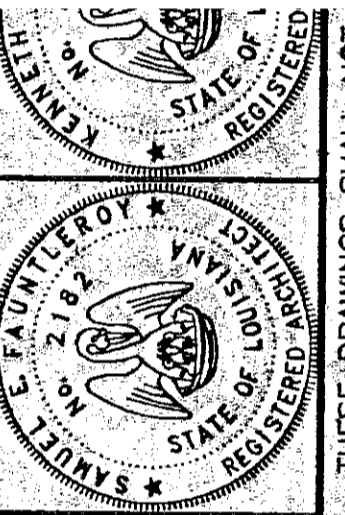
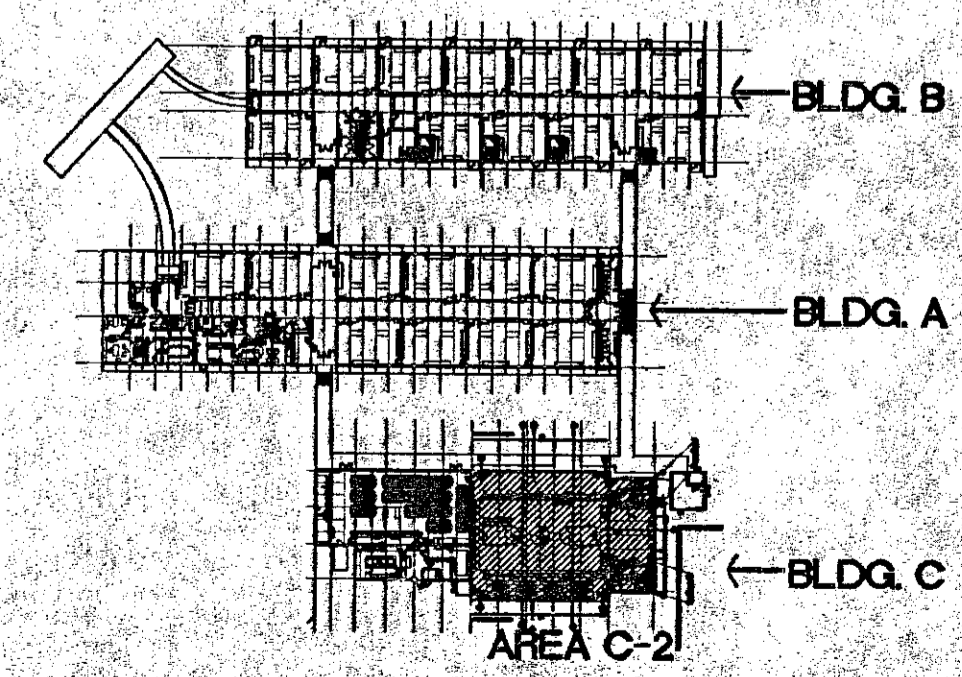

RENOVATION TO COVINGTON ELEMENTARY SCHOOL 325 S. JACKSON COVINGTON, LOUISIANA

FLOOR PLAN - AREA C-2 202032 Dwn. MAH, KPS Chk. KEL Date 17 SEP 02 Rev.

A2.6 Sheet 60

COPYRIGHT 2002, FAULTEROY & LATHAM, INC.

FLOOR PLAN - AREA C-2 SCALE: 3/16" = 1'-0"