

Roofing & Waterproofing Specialists

Insured: Charles Dammon
Property: 124 Eden Isles Blvd
Slidell, La 70458

Home: (985)640-7891
E-mail: chuckdammon@yahoo.com

Contractor: Will Cummings
Company: Allied Xteriors
Business: 1522 West Causeway Approach
Mandeville, LA 70471

Cellular: (985) 788-1614
E-mail: will@theroofgeek.com

Claim Number: 170100032755

Policy Number: 1020218

Type of Loss: Wind

Date of Loss: 4/7/2021
Date Inspected:

Date Received:
Date Entered:

Price List: LAMA8X_MAY21
Restoration/Service/
Estimate: Remodel JOB 4143285

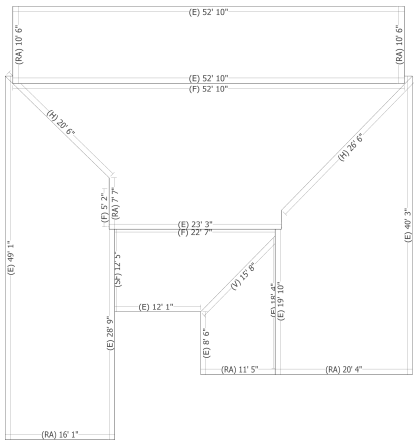

Roof1

**Property
Main Level**

2,972.00 Surface Area
369.70 Total Perimeter Length
47.10 Total Hip Length

34.33 Number of Squares
0.00 Total Ridge Length

DESCRIPTION	QTY	REMOVE	REPLACE	TAX	TOTAL
<i>Roof Measurements provided by HOVER.</i>					
1. Tear off, haul and dispose of comp. shingles - Laminated	30.00 SQ	61.43	0.00	0.00	1,842.90
The Contractor is not hiring a separate demolition crew for removal of damaged materials.					
2. Laminated - comp. shingle rfg. -w/ out felt	34.33 SQ	0.00	245.78	379.69	8,817.32
3. Drip edge/Gutter apron	369.70 LF	0.54	1.81	30.11	898.91
4. Valley metal	15.80 LF	0.00	5.56	3.95	91.80
5. Roofing felt - synthetic underlayment	30.00 SQ	0.00	33.03	44.59	1,035.49
6. Flashing - pipe jack	6.00 EA	11.71	57.46	15.51	430.53
7. Ridge cap - composition shingles	47.10 LF	0.00	3.31	7.02	162.92
Description of laminated shingles does not include hip and ridge caps.					
8. Asphalt starter - universal starter course	369.70 LF	0.00	1.72	28.61	664.49
9. Prime & paint roof jack	6.00 EA	0.00	36.09	0.00	216.54
Contractor will use starter course in compliance of manufacturing warranty specifications. Not included in description of laminated shingles.					
10. R&R Roof mount power attic vent-Large	1.00 EA	46.00	200.55	9.02	255.57
11. Chimney Flashing - small (24" x 24")	1.00 EA	17.76	221.50	20.80	260.06
12. Digital satellite system - Detach & reset	1.00 EA	15.03	33.04	0.00	48.07
Totals: Roof1				539.30	14,724.60

Roofing & Waterproofing Specialists

13. Flashing - cap	73.20 LF	3.36	6.63	21.84	753.11
14. Flashing - apron/step	53.40 LF	1.33	3.73	0.00	270.20
15. Xactimate preparation fee	1.00 EA	0.00	0.00	0.00	350.00
Total: Main Level				561.14	16,097.91
Line Item Totals: Property				561.14	16,097.91

Summary

Line Item Total	15,536.77
Material Sales Tax	561.14
Replacement Cost Value	\$16,097.91
Net Claim	\$16,097.91
