

## Ordering Information

Applicable product:		
Five-hole sink	K-5914-5	shown
Four-hole sink	K-5914-4	not shown
Accessories/hardware:		
Hardwood cutting board	K-5916	optional

## Product Information

Fixture*:		basin area	water depth
Sinks		16" x 14"	8"
Disposal		10" x 14"	3-1/2"
Outlets	3-5/8" D.		
Faucet holes	1-3/8" D.		

\* Approximate measurements for comparison only.

Included Components:	
Cutout template	100208

## Installation Notes

Refer to installation instructions included with fixture before beginning installation.

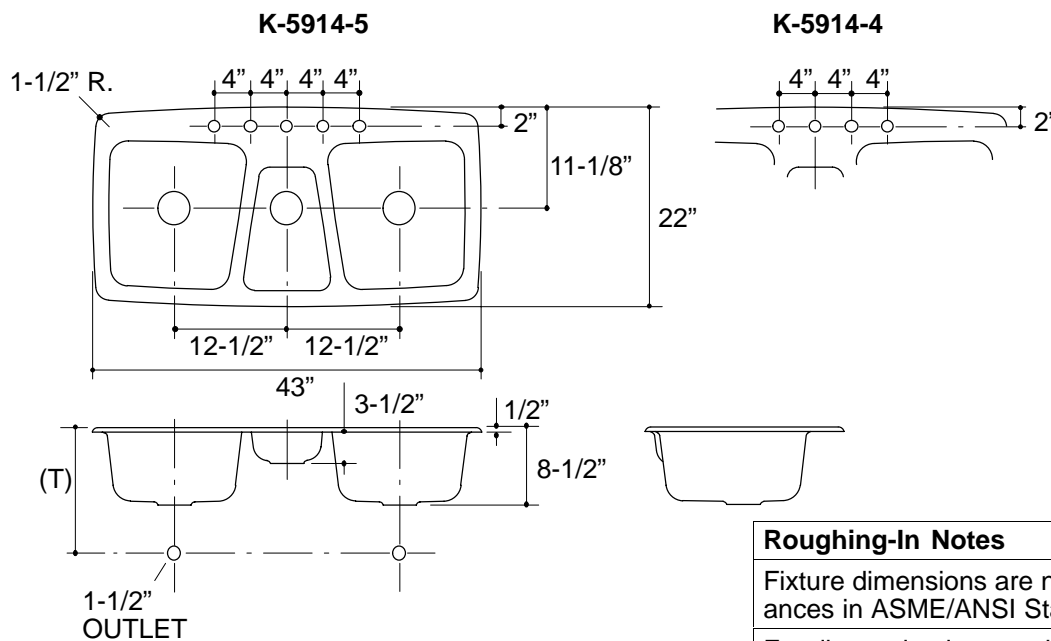

### Roughing-In Notes

Fixture dimensions are nominal and conform to tolerances in ASME/ANSI Standard A112.19.1M.

For disposal unit, consult local supplier for roughing-in measurements.

(T) Drain typically 13-7/8\".

.75<116

**K-5914 Trieste™ Sink**  
105129-1-BA (-)

**KOHLER®**