

FEATURES

- 60" x 32" x 18"
- Cast iron
- 1 hp variable flow pump, integral heater and suction housing
- Recirculating pump delivers flows up to 60 gallons per minute of powerful hydro-massage
- Order one Tower, Bath/Footbath, and Enclosure for each complete BodySpa installation

CODES/STANDARDS APPLICABLE

Specified model meets or exceeds the following:

- ASME/ANSI A112.19.1M
- ASME/ANSI A112.19.7M
- IAPMO/UPC
- Underwriters Laboratories (UL)

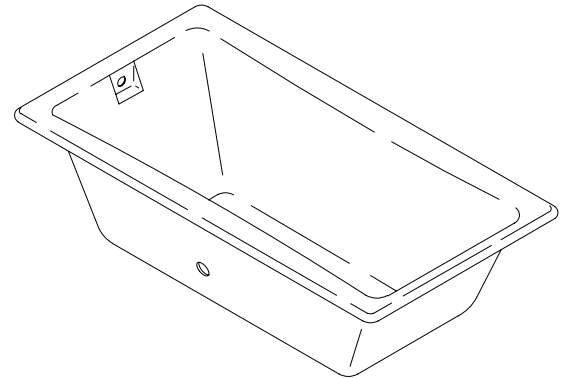

COLORS/FINISHES

- 0 White
- Other Refer to Fixtures Price Book for additional colors

Accessories:

- CP Polished Chrome
- PB Polished Brass
- SH Bright Silver
- BH Bright Brass
- Other Refer to Faucets Price Book for additional finishes

SPECIFIED MODEL:

Model	Description	Colors/Finishes	
K-854	5' bath	<input type="checkbox"/> 0 White	<input type="checkbox"/> Other_____

Required Accessories			
K-1040-CP	BodySpa 6-Jet Tower (Polished Chrome trim) OR	<input type="checkbox"/> 0 White	<input type="checkbox"/> Other_____
K-1040-PB	BodySpa 6-Jet Tower (Polished Brass trim)	<input type="checkbox"/> 0 White	<input type="checkbox"/> Other_____
K-9759-L	Bypass door	<input type="checkbox"/> SH	<input type="checkbox"/> BH
K-7169-AF	Drain	<input type="checkbox"/> CP	<input type="checkbox"/> PB
Recommended Accessories			
K-1097	Coralais Rite-Temp OR	<input type="checkbox"/> CP	<input type="checkbox"/> PB
K-1096	Coralais Two-handle	<input type="checkbox"/> CP	<input type="checkbox"/> PB

PRODUCT SPECIFICATION:

The bath shall be 60" in length, 32" in width, and 18" in height. Bath shall be made of enameled cast iron. Bath shall have 1 hp variable flow pump, integral heater, and suction housing. Bath recirculating pump shall deliver flows up to 60 gallons per minute of powerful hydro-massage. Bath shall be configured with BodySpa 6-Jet Tower, and BodySpa Bypass Door. Bath shall be Kohler Model K-854-_____.

BODYSIPA TEA-FOR-TWO™

REQUIRED ELECTRICAL SERVICE

Dedicated circuit required, protected with Class A Ground-Fault Circuit-Interrupter (GFCI):	
Pump/control, heater	120 V., 20 A, 60 Hz

PRODUCT INFORMATION

Fixture*:	basin area	top area	weight
Bathing well	41" x 20"	55" x 25"	280 lbs.
	water depth	capacity	
To overflow	13-5/8"	60 gal.**	

* Approximate measurements for comparison only.

** 45 gallon minimum required for BodySpa operation.

Pump:	HP	V	Hz	A
1-speed	1	120	60	16.5

INSTALLATION NOTES

Allow 82-1/4" to 82-3/4" from sub-floor to finished ceiling or header for proper enclosure installation.

Top of unit must be enclosed to retain heat and contain water spray.

Pump is supplied with a grounding type plug-in cord. Locate the outlet behind the whirlpool, and within 24" of the pump.

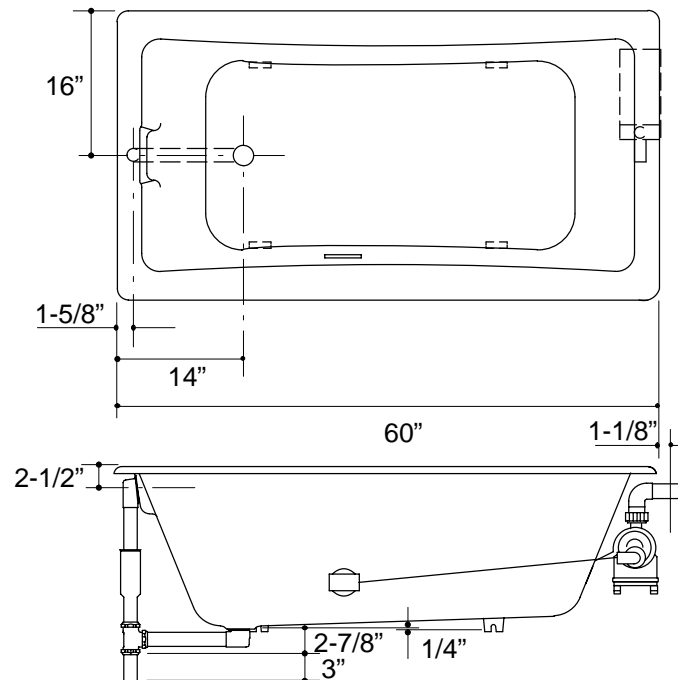

1.25>132

Roughing-In Notes		
No change in measurements if connected with drain illustrated.		
Pump extends 1-1/8" beyond the bath rim. Make provisions during rough-in or installation.		
Cut-out	58-1/2" x 30-1/2"	
Minimum access panel:		
Pump/control	20" W x 12" H	required

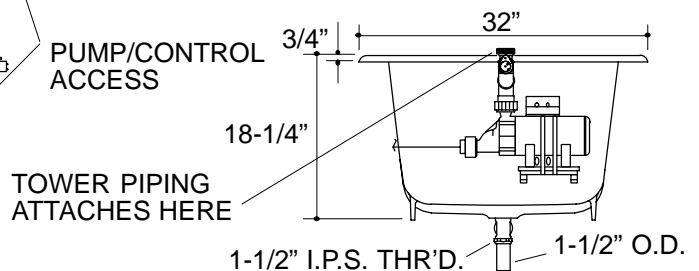

PRODUCT DIAGRAM