

**WASH SINK FAUCET  
K-8892**

**FEATURES**

- Brass construction
- Brass valve bodies
- Valvet® valves
- 4" spout with rosespray
- 8-3/8" wall-to-spout outlet
- Lever handles
- Adjustable flanges

ADA

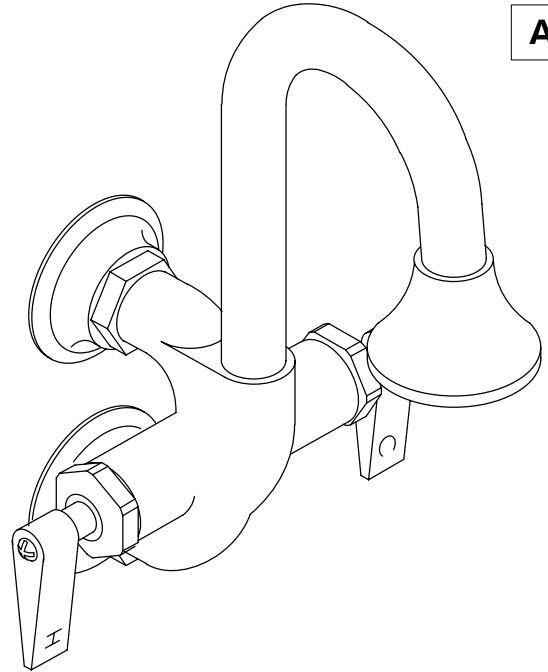

**CODES/STANDARDS APPLICABLE**

Specified model meets or exceeds the following:

- ASME/ANSI A112.18.1M
- CSA B125
- IAPMO/UPC

**COLORS/FINISHES**

- RP Rough Plate

**SPECIFIED MODEL:**

Model	Description	
K-8892	Cannock Wash Sink Faucet	<input type="checkbox"/> RP

**PRODUCT SPECIFICATION:**

Two-handle wash sink faucet shall be of brass construction. Faucet shall feature brass valve bodies. Faucet shall also feature Valvet valves. Product shall include 4" spout with rosespray, 8-3/8" wall-to-spout outlet, lever handles, adjustable flanges, and external N.P.T. connection. Faucet shall be Kohler Model K-8892-RP.

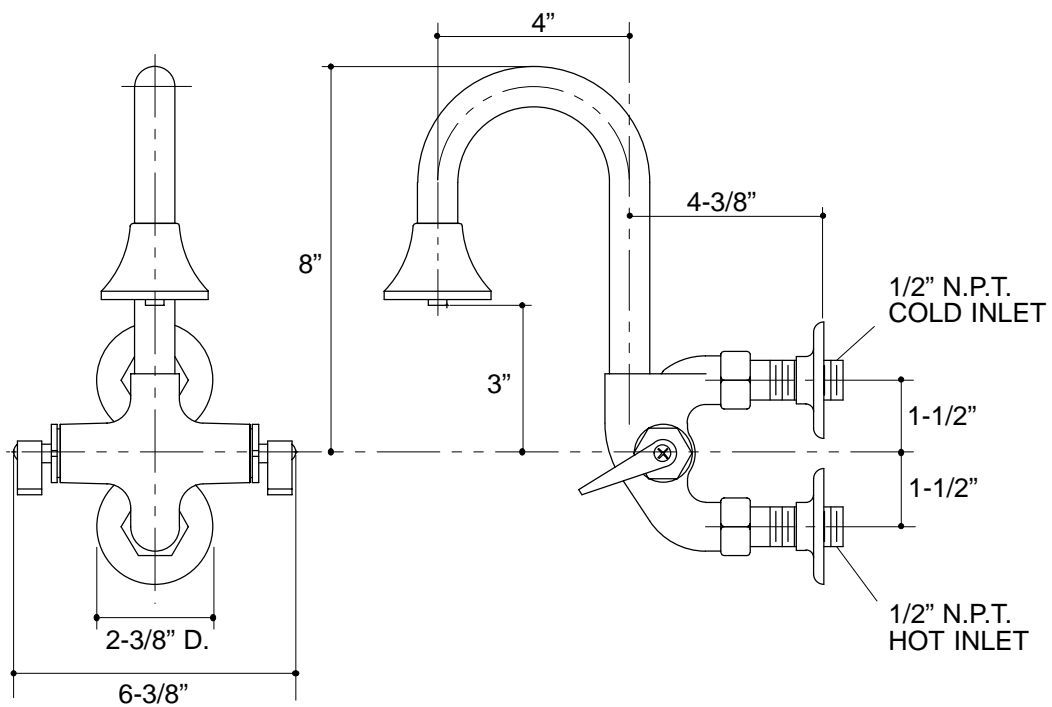

14

## PRODUCT DIAGRAM